



AZ

INDUSTRIAL SPRAY NOZZLES FLAT SPRAY - BROCHURE

FLAT SPRAY - AZ

SPRAY CHARACTERISTICS

- Uniform distribution of hard hitting flat spray with a minimum of atomization.
- No soft edges - no need for overlapping.
- Minimum flow deviation at varying pressures.
- Available spray angles of 0°, 15°, 25°, 40° and 50° @ 10 Bar.G.

CONSTRUCTION AND MATERIALS

- One piece construction with no internal shoulders or ledges causing unwanted liquid turbulence.
- Available with Male BSPT pipe thread design only.
- Hexagon body with wrench flats avoid distortion when tightening.
- Circular shaped orifice reduces wear, no feather edges.
- Nozzle filter is not needed, orifice will pass small amounts of foreign matter.
- Manufactured in Stainless Steel and Hardened Stainless Steel as standard.

DIMENSIONS & DRAWINGS

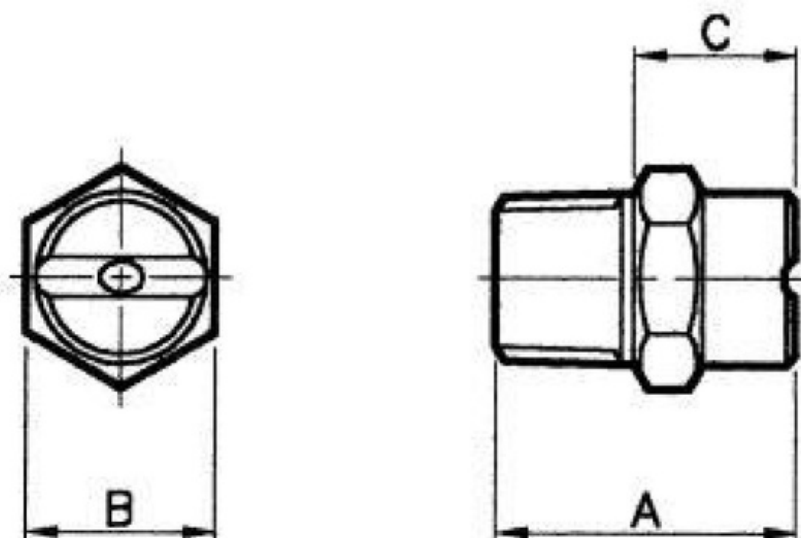

DIMENSIONS AND WEIGHTS

Thread Size	Nozzle Type	Dimensions (mm)			Weight (g)
		A	B Hex	C	
1/8	AZ	17,5	11,3	9,5	12
1/4	AZ	24,5	15,3	13,0	23
1/4	AZ (HSS)	22,2	15,3	12,0	19