



DD

**INDUSTRIAL SPRAY NOZZLES
FLAT SPRAY - BROCHURE**

FLAT SPRAY - DD

SPRAY CHARACTERISTICS

- Produces highly uniform flat spray at high pressures.
- Maximum impinging force is produced with a minimum loss of energy resulting in higher efficiency.
- Spray pattern has a knife-like cutting edge.
- Normal spray angles of 25° and 32°. Orifice is offset 15° to axis of dovetail.

CONSTRUCTION AND MATERIALS

- Dovetail connection nozzle/body for positive alignment.
- 3 piece design with Male BSPT thread or Welding Nipple body, available in: Stainless Steel bodies and cap.
- Mild Steel (Welding Nipple body only).
- Longer welding nipple bodies available to special order.
- Nozzle is 416 Hardened Stainless Steel.
- Tips, bodies and cap can be ordered separately in different materials.
- Threaded bodies are 3/4" or 1" Male BSPT only.

DIMENSIONS & DRAWINGS

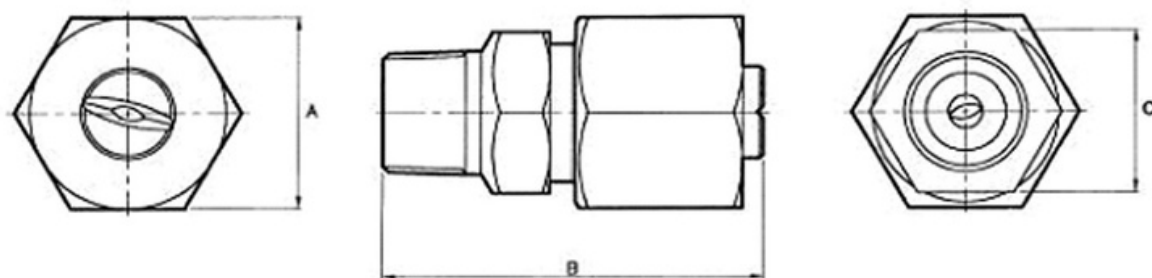

DIMENSIONS AND WEIGHTS

<i>Assembly Type</i>	<i>Dimensions (mm)</i>			<i>Weight (g)</i>
	<i>A Hex</i>	<i>B</i>	<i>C Hex</i>	
3/4" DDM	41,3	79,2	38,0	494
1" DDM	41,3	79,2	38,0	551
DDW	41,3	70,0	35,0 dia.	410