



DJ

**INDUSTRIAL SPRAY NOZZLES
FLAT SPRAY - BROCHURE**

FLAT SPRAY - DJ

SPRAY CHARACTERISTICS

- Wide flat spray of liquid with even distribution except for the edges which have heavier deposit.
- Wide spray angles, on water, for low pressure.
- Useful with steam or air for blow-off application.

CONSTRUCTION AND MATERIALS

- Straight through slot shaped orifice.
- One piece Male BSPT thread only.
- Hexagon body with wrench flats avoid distortion when tightening.
- Larger thread sizes are available on request. Brass and Stainless Steel are standard.

DIMENSIONS & DRAWINGS

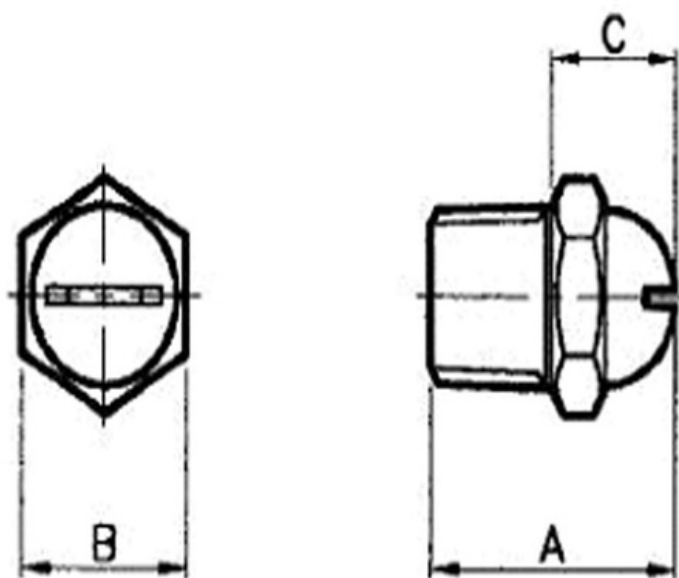

DIMENSIONS AND WEIGHTS

Thread Size	Dimensions (mm)			Weight (g)
	A	B Hex	C	
1/4	30,0	15,3	10,3	28
3/8	35,0	18,0	14,3	45