



LQ

**INDUSTRIAL SPRAY NOZZLES
FLAT SPRAY - BROCHURE**

FLAT SPRAY - LQ

SPRAY CHARACTERISTICS

- Produces a uniform flat fan shaped pattern.
- Requires minimal overlapping to produce an even distribution when used in multiple nozzle system.
- High pressure body design with replaceable insert.
- A wide range of flow rates and spray angles.
- 0° nozzle sizes available on request.
- Orifice offset -5° to axis of dovetail.

CONSTRUCTION AND MATERIALS

- Dovetail connection Nozzle/body for positive alignment.
- 3 piece construction. Body, tip and cap.
- The tip is dovetailed for self alignment.
- The orifice insert is manufactured in Tungsten Carbide for maximum wear resistance at higher pressures.
- The high pressure body, cap and orifice housing are manufactured in Stainless Steel as standard.
- Standard Male and Female thread bodies are available and also an optional welding body.

DIMENSIONS & DRAWINGS

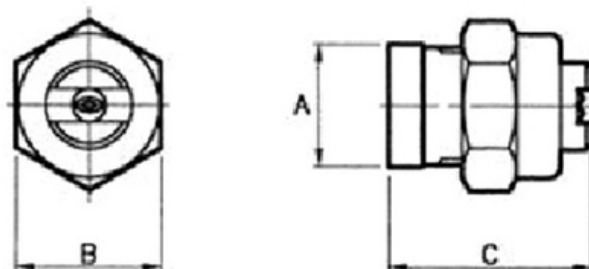

LQ (WELDING) ASSEMBLY

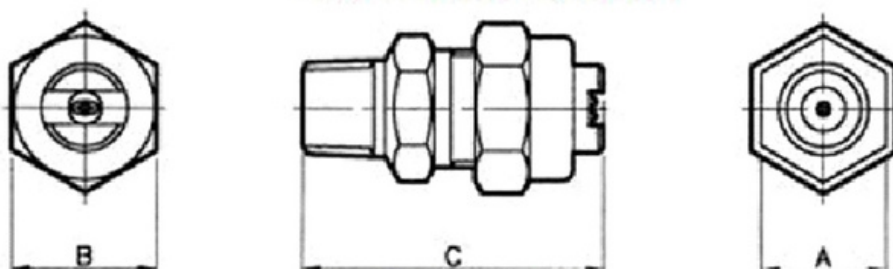

LQ (MALE) ASSEMBLY

DIMENSIONS AND WEIGHTS

Thread Size	Assembly Type	Dimensions (mm)			Weight (g)
		A Hex	B Hex	C	
1/8	LQF	18,0	20,8	43,0	65
1/4	LQF	18,0	20,8	43,0	64
1/4	LQM	18,0	20,8	43,0	57
3/8	LQF	20,8	20,8	43,0	65
3/8	LQM	18,0	20,8	43,0	59
-	LQW	17,5 dia.	20,8	29,2	46