

Grand Teton Series
MODEL A: GT 3412FLA (399 Sq. Ft.)

Specifications Subject to Change Without Notice or Obligation
3/30/2020

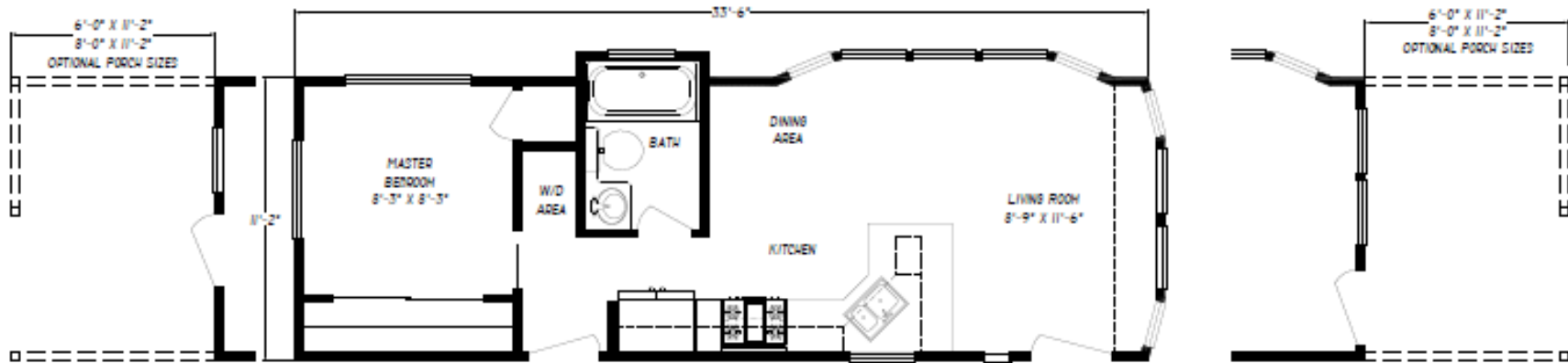

Grand Teton Series Standard Features

Specifications Subject to Change Without Notice or Obligation

3/30/2020

EXTERIOR

- 4" trim on all windows
- Allura Lap Siding per plan
- 12" front overhang
- 12" rear overhang
- 12" eaves on sides (not on 15' wide models)
- 90" – 2"x4" exterior walls
- R-24 floors, R-13 walls & R-25 roof

DOORS & WINDOWS

- Half Light doors w/internal mini blinds
- Side light windows in standard door location
- Vinyl framed low "E" dual glaze windows
- Residential style mortise door hinges

STRUCTURAL

- 1 Year "wall to wall" warranty
- 30 lb. Roof load
- 2" x 4" Exterior walls 16" o.c.
- 2"x 6" - 16" o.c. floor joist
- 3/4" OSB T&G floor decking
- Transverse floor system
- 9:12 Combination Roof pitch
- Class A fire rated fiberglass shingles
- Removable hitches

INTERIOR / FINISH WALLS

- Factory select décor throughout
- High vault ceilings T/O
- Tape and texture walls w/square corners
- Upgrade Laminate flooring T/O
- Closet Organizer
- 2- panel white passage doors
- Clean able Sherwin Williams Paint

BEDROOM

- Large Open Closet with multiple hanging rods
- Bi Pass closet doors
- TV/Phone Raceways installed
- Ceiling Fan (Loft over BR will get can light)

KITCHEN

- 20 cu.ft. Black frost-free refrigerator
- 30" Whirlpool Black free-standing gas range, w/clock, window & timer
- Soft close cabinets
- Microwave Rangehood
- Deep Stainless-Steel kitchen sink
- Goose neck single lever faucet & sprayer
- Bank of drawers
- Granite/Quartz countertops w/4" backsplash

BATHROOM

- 1 pc. fiberglass tub/shower per plan
- Granite/Quartz Countertop w/4" Backsplash
- Single lever tub/shower diverter
- Undermount Ceramic sink
- Exhaust fan
- 33" height lavy cabinet
- Elongated Quality Toilet
- Single Lever Faucet
- Towel bars and tissue holders (shipped Loose)

CABINETRY

- Quality painted or hardwood cabinet doors
- Hardwood stiles for cabinetry
- Crown molding on kitchen cabinets
- Granite/Granite w/4" backsplash
- Soft Close Drawers and Doors throughout
- Microwave Cabinet above Range
- Adjustable shelves in base & O/H Cabinets
- H/D Metal ball bearing drawer guides

ELECTRIC & PLUMBING

- 50 Amp service
- In-Floor PEX waterlines
- Water shut offs at toilet and kitchen sink
- Propane Tankless water heater
- Ductless Heat pumps, Heating & A/C
- Standard GFI
- Ceiling fan with light in M/Bed and L/R
- LED recessed lighting through-out
- Cast Aluminum Exterior Carriage light
- Fire extinguisher