

## Fiery Paper Rose

*The Chaldean Oracles* are a group of fragments from an ancient poem dating to the second century CE. The Hekate presented in these fragments is that of the World Soul, Savior, and even the Fiery Rose of Creation:

*... from there, a lightning-bolt, sweeping along, obscures the rose (flower) of fire as it leaps into the hollows of the worlds. For from there, all things begin to extend wonderful rays down below. (Fragment 34)*

- From *Keeping Her Keys: An Introduction to Hekate's Modern Witchcraft*.



The instructions and templates were purchased from [Cre8tive Files on Etsy](#). I've adapted them for this project.

I chose a seven sided figure as the base, symbolic of the Star of Seven, which is featured in many ways in *Keeping Her Keys* and *Covina*. Thus, every layer of our flower is a septagram (also called a heptagram). The petals are flames, representing the Sacred Fire of Hekate.

I used Neenah Astrobrights Premium Color Cardstock, 65 lb, 8.5 x 11 Inches, 250 Sheets, in Re-Entry Red and Eclipse Black.

1. **Print the petals, the base, and the center in the separate file.**
2. **Once you have the template printed, cut everything out.**

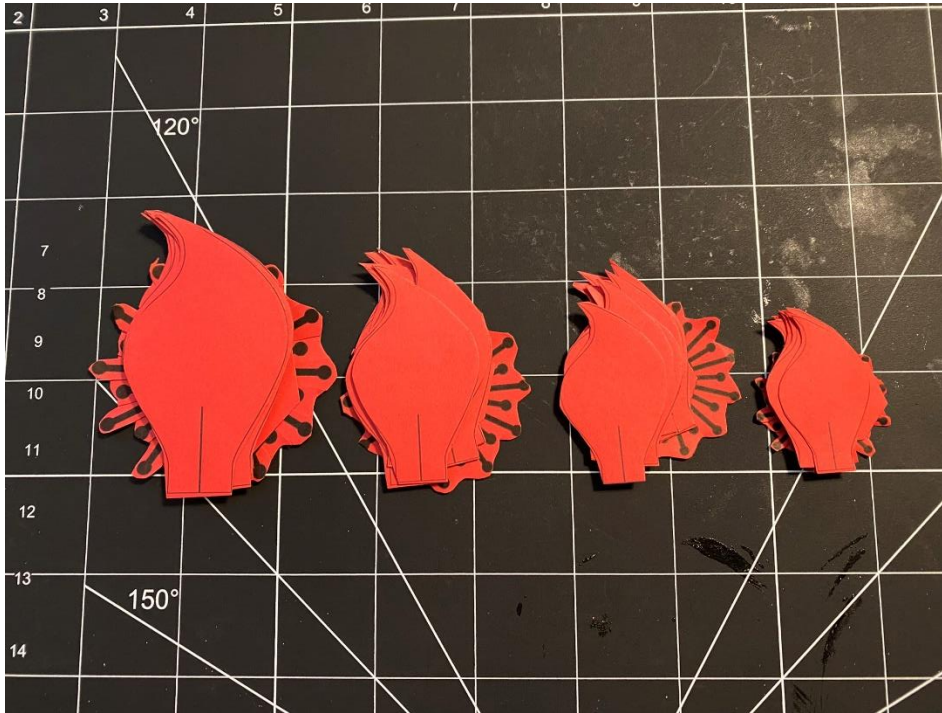

You don't need all the centers, but you can find other uses for them. I used the smallest center

Cut the midpoint line as well.



### 3. Curl the petals using a ruler.

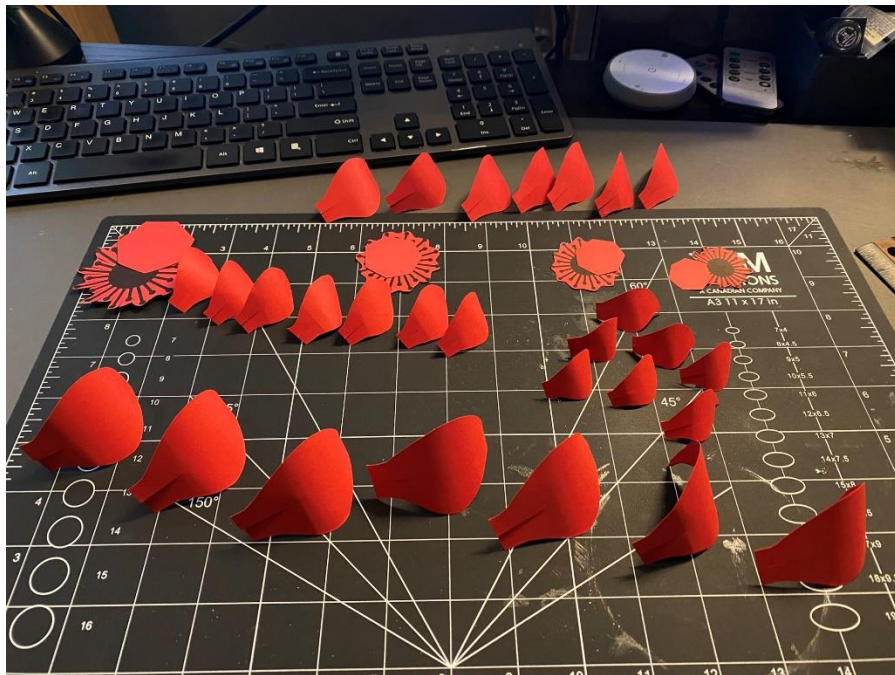

#### 4. Add real rose “dust,” to the glue.

I used Mod Podge, and dried wild roses. The original instructions said to use a glue gun.



**5. Overlap the two sides of the center cut and glue them together.**

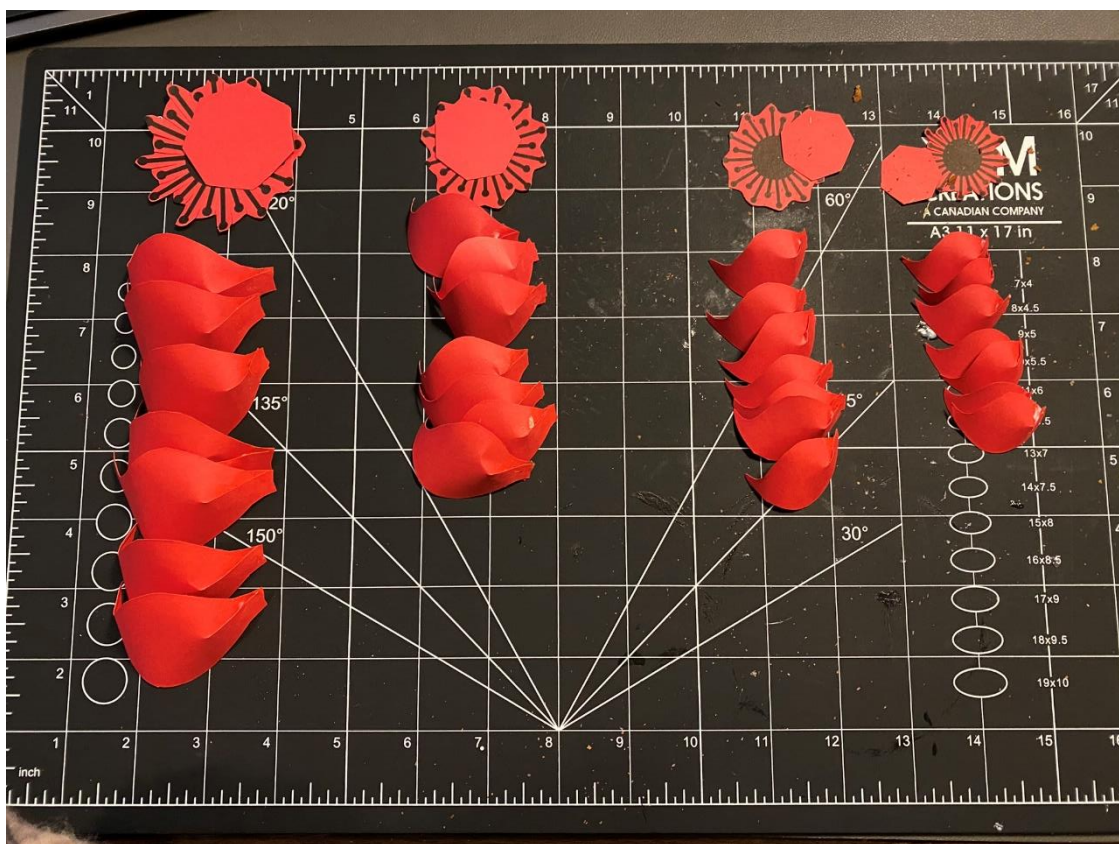
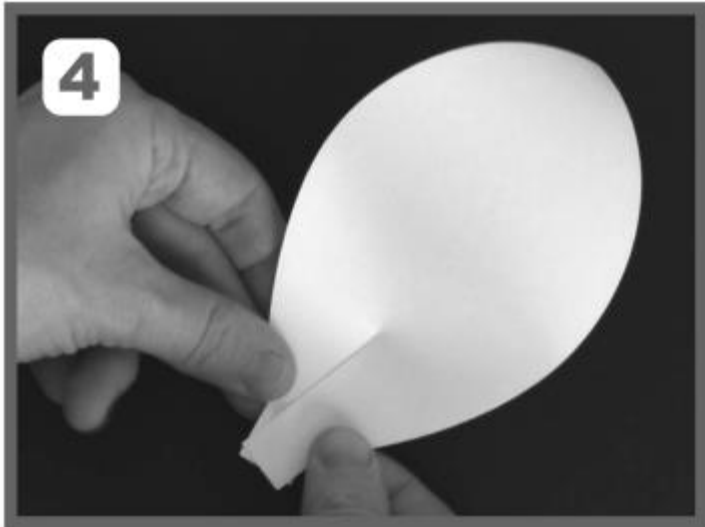

All glued.

## 6. Create the layers.

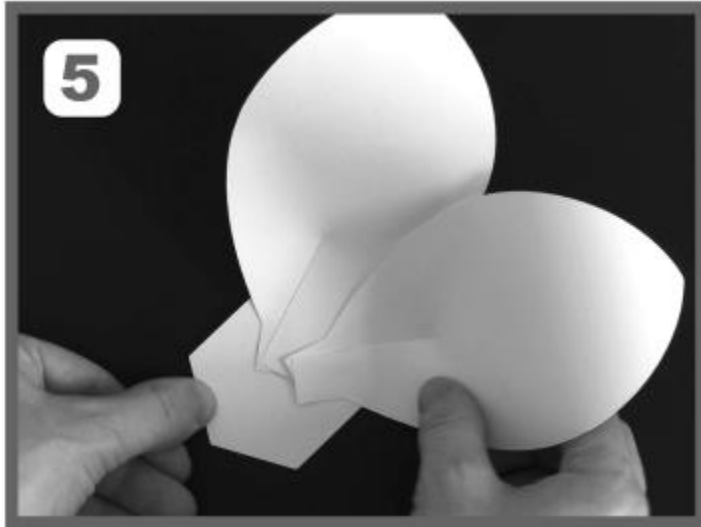

Note that I applied the petals facing down instead of up like in this picture. It's fine either way.

Layers ready to be combined. It was a bit tricky to get them glued on. Expect sticky fingers.

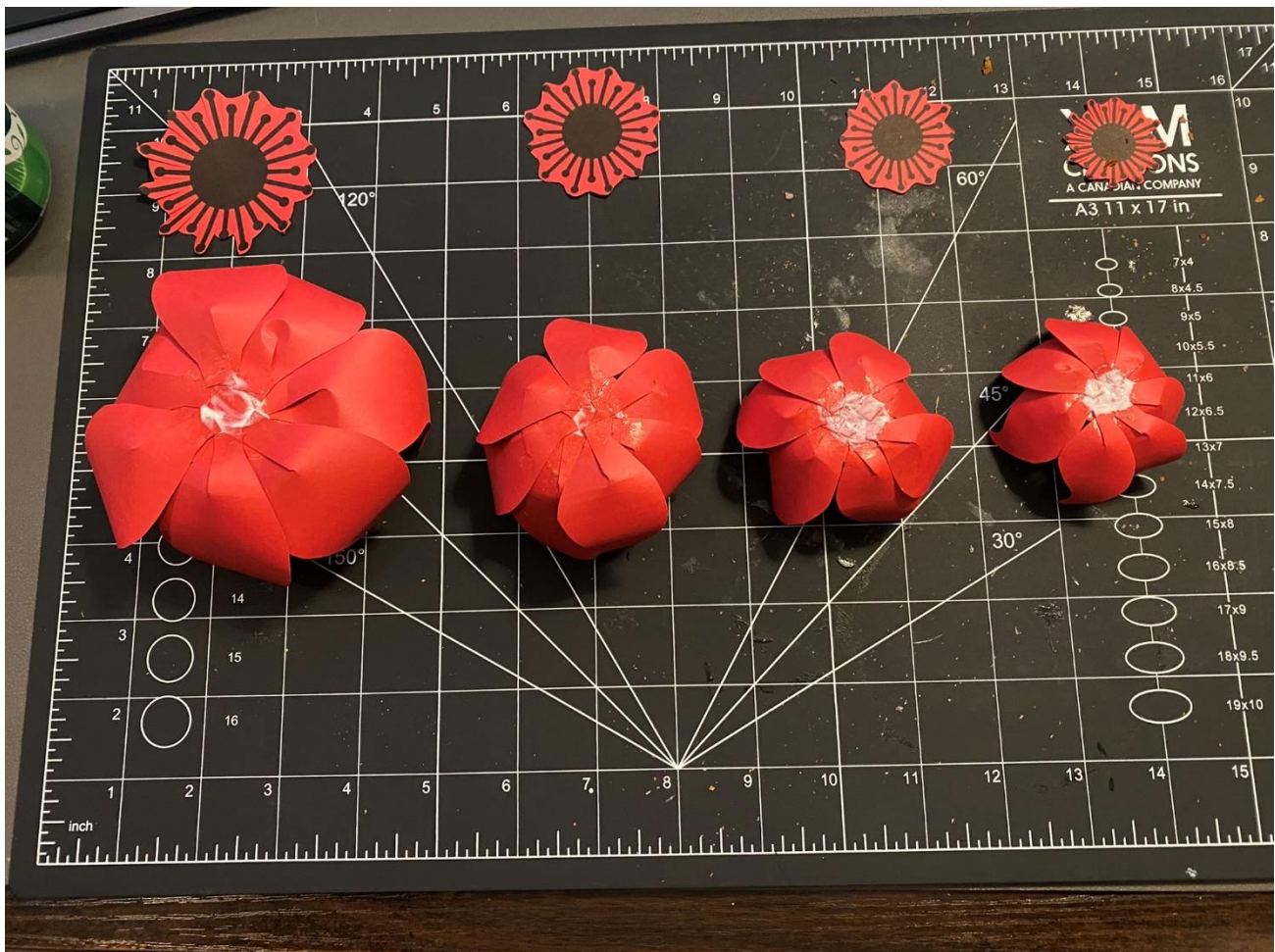

## 7. Glue the layers together.

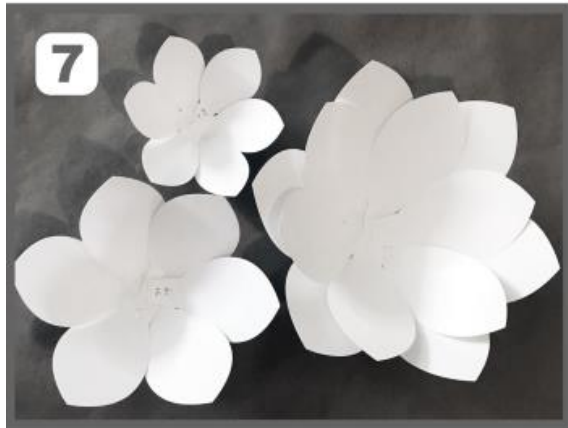

### ASSEMBLE YOUR FLOWER

**7.** Flower is assembled by stacking and gluing together all the layers of petals you created.

**8.** Stack and glue all petal layers together in order of size: largest on bottom and smallest on top. Make sure to rotate each layer slightly (have each petal pointing in-between the two petals from previous layer.)

I put an little disk over the glue. Tamping down the glued layers is important.



## 8. Add the center and leaves.

I put a tiny strophalos in the center of the center. I also cut the center, so each little stamen was cut out, which made it easier to shape into a little bowl.

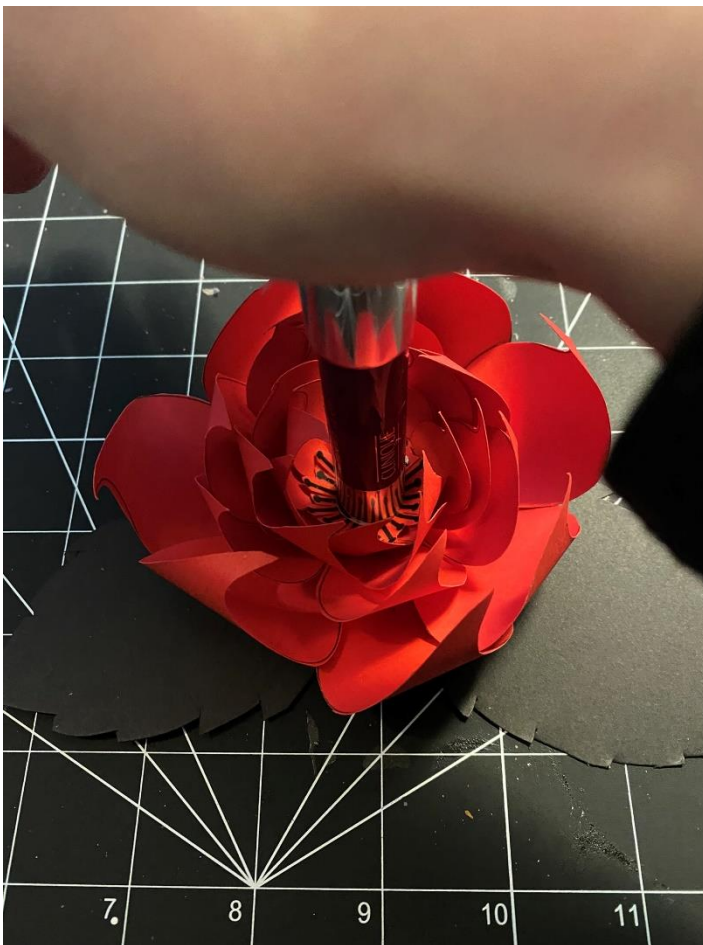

Make sure you tamp it all down good again.