

Call forward

1. Press Menu > Features > Call Forward.
2. Select the line, the type of forward, enter the destination number and status and press OK.

Call Mute

1. Press to Mute the microphone during the call.
2. Press again to un-mute the conversation.

Call list

1. Press key or Menu > Call Log > Local Call Logs
2. Scroll through the list using .
3. To dial an entry, press Dial soft key or pickup handset or press or .

Phonebook

Access phonebook:

1. Press Contact soft key or Menu > PhoneBook > Local Contacts.
2. Select All Contacts or other group.
3. To dial an entry, press Dial soft key or pickup handset or press or .

Add new entry:

1. Press Contact soft key, Press All Contacts or other group > Press Add.
2. Enter name and number and press OK soft key.

Programmable keys

DSS keys :

1. You can use the phone web interface to configure the keys of the main and secondary screen.
2. You can press any keys which is still blank or long press the key that have configured, select a type and value, press OK key.
3. Press Menu > Basic > Keyboard > DSS Key settings. Select the key, type and value, press OK key.

Other keys :

1. You can also configure shortcuts for the navigation keys, and which will be available in idle mode.
2. Press Menu > Basic > Keyboard, select among the configurable items, and select your desired type and value, press OK key.

Redial

1. Press , redial a call number.

Do not disturb

1. Press key > Move to the icon > OK key, or Menu > Features > DND.
2. Select the Mode, and press OK soft key.

Voice message

1. To access your voice mailbox, press Voice message or Menu > Message > Voice Message, number of messages will be indicated if provided by your server or PBX.
2. Select the line and press Play to call.

Bluetooth

1. Press Menu > Basic > Bluetooth
2. Press ok to enter the bluetooth open interface. After opening, press scan to display the list of bluetooth scanned. Select any device and press connect.

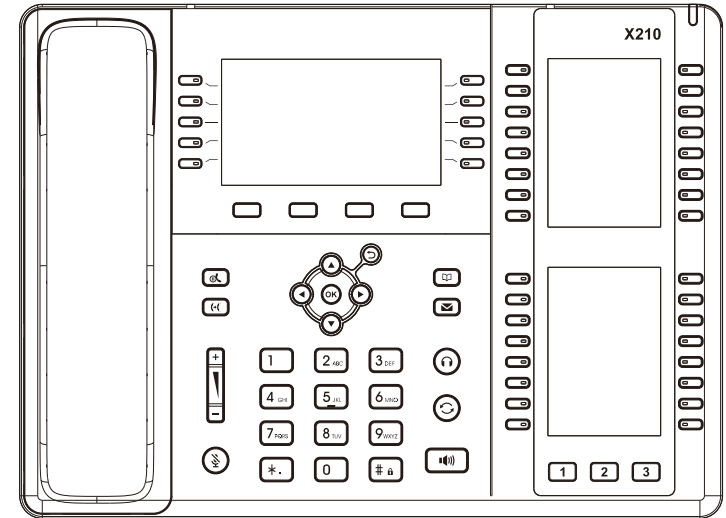

X210

Quick Reference Guide

Packaging list

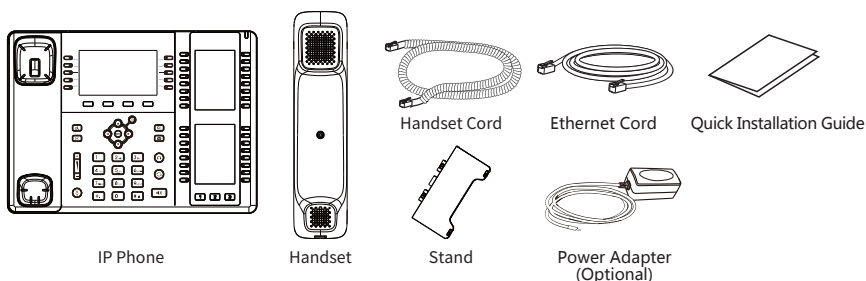

Screen icon

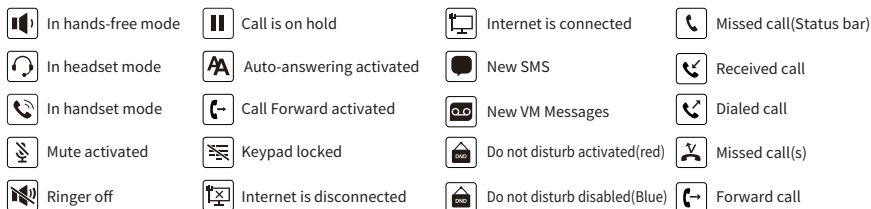

Keys features



Soft keys



Message waiting indicator



Left and right navigation keys,
Return key
Up navigation key, Shortcut to call log
Down navigation key, Shortcut to Status
OK key, Shortcut to Menu
Return key, Go back to the
previous directory



Hold key, Hold/Resume the call



Call transfer key



Phonebook key



In idle mode: ringer off
In communication mode:
mute/un-mute a call



In idle mode or during ringing:
increase or decrease ringer volume
In communication: increase or decrease
earpiece, headset or hands-free volume



Voice message key



Headset key,
Activate/deactivate Headset



Redial key, Access to redial the last record

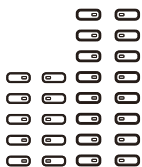

DSS keys, It can be set as line
key/function key/speed dial
key, etc.



Hands-free key,
Activate/deactivate hands free

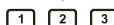

Page-Jump key, It can switch
the vice screen DSS pages



Long press to lock keypad.
Enter PIN to unlock keypad
(default 123)

Installation the device

Bracket desktop installation

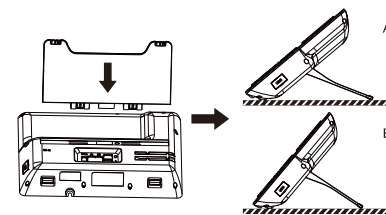

Connecting to the Device

Please connect power adapter, network, PC, handset, and headset to the corresponding ports as described in below picture.

- ① USB port: connect USB device (U disk, WIFI adapter)
- ② Power port: connect the power adapter.
- ③ Network port: connecting local area network or internet.
- ④ PC port: the network port connect to the computer.
- ⑤ Headset port: connect headset.
- ⑥ Handset port: connect IP Phone handset.

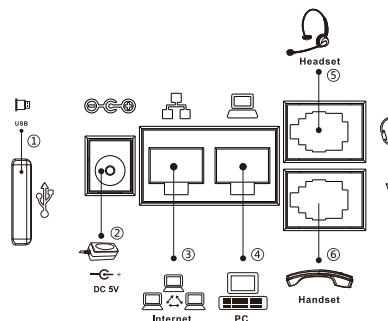

Configuration

Configuration via Phone

1. Press Menu > Advanced (Default password 123)
2. Select Network: To configure the Network Settings (IPv4/IPv6/IPv4&IPv6, DHCP/Static/PPPoE)
3. Select Accounts: To configure enable the account, fill the SIP server address, port, user name, password etc.

Configuration via Web

1. Get the IP address from the phone: Press key, or Menu > Status > IP.
- 2.2. Login: Input the IP address in the web browser. The PC and phone should be in the same IP address segment (The default username and password are both 'admin').
3. Configure: Select network/Account etc, and fill the relevant content.

Language setting

1. Press Menu key > Basic > Language.
2. Select the desired language and press OK soft key.

Making a call

1. **Pre-dialing:** enter the phone number and pick up the handset.
2. **Direct dialing:** lift the handset and enter the phone number.
3. **Handsfree:** enter phone number and press or vice versa.
4. **Headset:** enter phone number and press or vice versa.
5. **Designated line:** press line key, enter phone number and press dial key.

Accepting a call

1. **With the handset:** pick up the handset.
2. **With a headset:** press .
3. **With the handsfree:** press .

Putting a call on hold

1. Press key or Hold soft key, caller is put on hold
 2. To retrieve the call press key or Resume soft key.
- Note:** with more than one active call, select desired call with the navigator keys and use the corresponding soft key to hold or resume.

3-party conference

1. Once in line with 1st caller, press Conference soft key, 1st caller is put on hold.
2. Then call the 2nd number.
3. After, 2nd call is established, press Conference soft key to set up the conference.

Call transfer

Attended transfer:

1. Press key or Xfer soft key during the active conversation, the call is put on hold.
2. Dial the second telephone number.
3. When the call is answered, then press key or Xfer soft key to complete the operation.

Blind transfer:

1. Press key or Xfer soft key during the active conversation, the call will be on hold.
2. Then enter the 2nd telephone number and press key or Xfer soft key.