



PRIDE[®]
M O B I L I T Y

TRAVEL/SCOOTER COLLECTION

4-5

Go Go Elite Traveller® 2

• • •

6-7

PX4

• • •

8-9

Pursuit 2

• • •

10-11

Zero Turn 8 / Zero Turn 10

• • •

12-13

iRIDE® 2 / i-Go™

• • •

14-15

Go Go Elite Traveller® / Endurance Li

• • •

16-17

Go Go® Sport / Go Go® ES 2

• • •

18-19

Go Go® Ultra X / Maxima

• • •

20-21

Revo® 2.0 / Victory® LX Sport

• • •

22-23

Victory® 10 / Victory® 10.2

• • •

24

Victory® 9



“

MY PRIDE SCOOTER HAS
BEEN A LIFESAVER
FOR ME. I COULD NOT
DO LIFE WITHOUT IT.

— Etta G.,
White Plains, NY

NEW!



GO GO
ELITE TRAVELLER® 2

Go Go Elite Traveller® 2

No four-wheel scooter can turn like the 4-wheel Go Go Elite Traveller® 2. Thanks to Pride's patented, intelligent-turning EZ Turn Technology, it boasts the tightest turning radius of any available 4-wheel scooter at just 37", which means you have 3-wheel scooter agility without compromising 4-wheel scooter stability.



FDA Class II Medical Device¹

Up To
13.8

Miles Per Charge
with 18Ah battery at 200 lbs.

37"
Turning Radius

Up To
4.2mph
Maximum Speed

300lbs.
Weight Capacity

Matte Cardinal Red (included)

Matte Black (included)

Interchangeable Shrouds

Additional shroud colors can be ordered separately. Ask your provider for details.

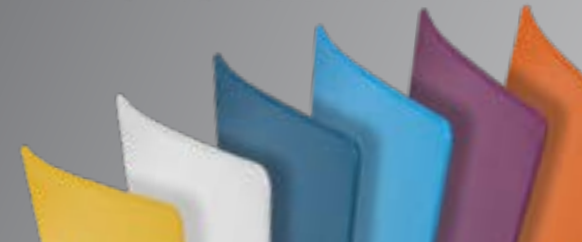

EZ Turn Technology provides unrivaled tight turning!



TURNING LIKE A 3-WHEEL • STABLE LIKE A 4-WHEEL



PX4

The PX4 features an impressive 500-lb. weight capacity, a top speed of 9.3 mph, water-resistant user interface, enhanced lighting package, and a remarkable 23.4 mile battery range.

The ignition system also offers an extra layer of security with its innovative NFC technology. Simply tap or place the NFC key fob near the receiver to start the scooter.



Up To
23.4
Miles per Charge

82.3"
Turning Radius

Up To
9.2mph
Maximum Speed

500lbs.
Weight Capacity

FDA Class II Medical Device¹

Forest Camo (Limited Edition)

Satin Aluminum

Dark Violet

Red

Peacock Blue

Sunflower



MORE ROOM TO ROAM



PURSUIT²

Pursuit 2

Built to thrill and designed to go the distance, the Pursuit 2 never backs down from an off-road detour or long-distance excursion. With a fast top cruising speed of 9.3 mph and the ability to make it 40 miles on a single charge, this agile unit offers swift, efficient transport and endurance you can count on.

You were born to roam. The Pursuit 2 was built to ride.



Up To
40
Miles Per Charge*

69.3"
Turning Radius

Up To
9.3mph
Maximum Speed

400lbs.
Weight Capacity

FDA Class II Medical Device¹

* Requires dual lithium battery upgrade

Grey (matte)

Orange

Black



INSERT YOURSELF: ANYWHERE





ZERO TURN8

Zero Turn 8

Your mobility has turned a corner with the Zero Turn 8, an innovative scooter equipped with EZ Turn Technology, enabling you to maneuver this scooter through small spaces and around tight corners! Plus, enjoy full lighting, plenty of storage and a USB charger.



Up To
13.1
Miles Per Charge at 200 lbs.

37.25"
Turning Radius

Up To
5.9mph
Maximum Speed

325lbs.
Weight Capacity

FDA Class II Medical Device¹

Sapphire Blue

Pewter

Pearl White

Black Onyx

Green Moonstone

Fire Opal



Up To
21.2
Miles Per Charge at 200 lbs.

43"
Turning Radius

Up To
7.3mph
Maximum Speed

400lbs.
Weight Capacity

**ZERO
TURN10**



Zero Turn 10

The Zero Turn 10 can traverse the most beautiful, out-of-reach places and move seamlessly through doors and hallways in your home. This scooter combines powerful dual motors and two-wheel drive with revolutionary turning technology. Let the Zero Turn 10 carry you to places unknown.



FDA Class II Medical Device¹

Candy Apple Red

Ocean Blue (Matte)

Pearl White

Black¹¹ (Matte)



iRIDE²

iRide[®] 2

Journey far and wide with the iRIDE[®] 2! This ultra-lightweight scooter is super portable and perfect for traveling. Equipped with both a manual handbrake and supplemental foot brake, the iRIDE[®]2 delivers a safe and comfortable ride. A folding back has been added for increased comfort, along with an upgraded LCD display for increased functionality.



Non-Medical Device

Up To

12

Miles Per Charge at 200 lbs.

33.5"

Turning Radius

Up To

5.8mph

Maximum Speed

250lbs.

Weight Capacity

Raspberry

Mango

Blackberry



iGo™

Up To
9.3
Miles Per Charge at 220 lbs.

45.9"
Turning Radius

Up To
4mph
Maximum Speed

275lbs.
Weight Capacity



Non-Medical Device

i-Go™

The i-Go™ Folding Scooter supports you when you refuse to compromise. So, when you're dreaming of a cruise vacation, know that i-Go™ comes with the all-day power, speed and versatility to take you there and back again. When disassembled, the heaviest piece weighs less than 32 lbs. and has a height of less than 12" for easy storage.

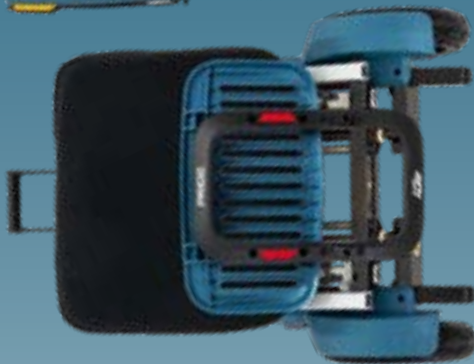

Iceberg Blue (matte)

Sugar Plum (matte)

White (matte)

Black (matte)

FLIP-UP ARMRESTS
(OPTIONAL ACCESSORY)



PHONE HOLDER
(OPTIONAL ACCESSORY)



REMOVABLE
STORAGE
(STANDARD)



ACCESSORIES:

- Armrests
- Phone holder
- Cup holder
- Rearview mirror
- Spare battery
- Travel kit

GO GO
ELITE TRAVELLER®

Go Go Elite Traveller®

Every day is a new adventure with the Go Go Elite Traveller®, an exceptionally stable and maneuverable travel scooter. With easy disassembly and a convenient storage basket, the Go Go Elite Traveller keeps up with your active life!



Up To
9.75
Miles Per Charge

44"
Turning Radius

Up To
4mph
Maximum Speed

300lbs.
Weight Capacity

FDA Class II Medical Device¹

Also available in 3-wheel. Please see back of catalog for specifications.

Red

Blue

Interchangeable Shrouds



Up To
14.4
Miles Per Charge
(16AH* MAXX Battery Pack)

48.25"
Turning Radius

Up To
4.2mph
Maximum Speed

325lbs.
Weight Capacity

GO GO
ENDURANCE Li



Go Go® Endurance Li

With the Go Go® Endurance Li, traveling has never been easier! This 4-wheel scooter has everything you need for a safe and convenient trip. With the standard 8AH airline-compliant lithium battery pack, the Go Go Endurance is perfect for air travel. Feather-touch disassembly provides the portability you need.

*16 AH battery pack does not meet airline requirements.

FDA Class II Medical Device¹

Garnet Red (matte)

Euro Grey

Interchangeable Shrouds



GO GO
SPORT

Go Go® Sport

It's time to make your mark on this world! The Go Go® Sport offers simple disassembly and an ergonomic delta tiller, perfect for one-handed operation. Enjoy the versatility of this sporty scooter, as well as bright LED lighting.



Up To
12
Miles Per Charge

50.5"
Turning Radius

Up To
4.7 mph
Maximum Speed

325 lbs.
Weight Capacity

FDA Class II Medical Device¹

Also available in 3-wheel. Please see back of catalog for specifications.

Red

Blue



GO•GO[®]
*es*2

Up To
6.24
Miles Per Charge

31"
Turning Radius

Up To
4mph
Maximum Speed

250lbs.
Weight Capacity



Go Go[®] ES 2

Get ready to go with the Go Go[®] ES 2 Scooter! Compact and lightweight, this scooter has two speed settings for ultimate versatility, whether you are indoors or outdoors. It's perfect for errands and quick trips! Plus, a front basket provides plenty of storage space.

FDA Class II Medical Device¹

Black



GO GO®
ULTRA X

Go Go® Ultra X

Enjoy worry-free travel with the Go Go® Ultra X, an ultra-compact scooter that is simple to disassemble. Ride in comfort and style with the foldable swivel seat and keep your personal items handy with the front basket.



Up To
8.9
Miles Per Charge at 200 lbs.

52.25"
Turning Radius

Up To
4.1mph
Maximum Speed

300lbs.
Weight Capacity

FDA Class II Medical Device¹

Also available in 3-wheel. Please see back of catalog for specifications.

Black



MAXIMA

Up To
19.5
Miles Per Charge

53"
Turning Radius

Up To
5.8mph
Maximum Speed

500lbs.
Weight Capacity



Also available in 3-wheel. Please see back of catalog for specifications.

FDA Class II Medical Device¹

Maxima

Experience the comfort of a new high-back, depth adjustable limited recline seat that swivels for easier access.

The Maxima scooter comes standard with front and side bumpers, a USB charger and full LED lighting!

Garnet Red (Matte)

Ocean Blue (Matte)



REVO® 2.0

Revo® 2.0

Robustly rugged meets brilliant convenience. With the Revo® 2.0, there is nothing you can't handle! This tough and dependable scooter has powerful suspension for a smooth ride, yet easily disassembles for full portability.



Up To
17.8
Miles Per Charge at 200 lbs.

52"
Turning Radius

Up To
5.2mph
Maximum Speed

400lbs.
Weight Capacity

FDA Class II Medical Device¹

Also available in 3-wheel. Please see back of catalog for specifications.

Grey Street

True Blue



VICTORY[®] LX^{SPORT}

Up To
19.7
Miles Per Charge at 200 lbs.

61.25"
Turning Radius

Up To
8.6mph
Maximum Speed

400lbs.
Weight Capacity



FDA Class II Medical Device¹

Victory[®] LX Sport

You're active and always on the go. You need a scooter that is up to the task! Appeal to your sporty side with the Victory[®] LX Sport. Enjoy premium suspension, bright lighting and other sophisticated features, all in one sporty package.

Candy Apple Red

True Blue



Victory® 10

Versatility knows no bounds with the Victory® 10. Enjoy simple disassembly with one hand and drive up to 16 miles on a single charge. You won't miss a beat with this scooter, which includes a bright LED headlight. Anything is possible with the Victory 10!

VICTORY 10



Up To
15.5
Miles Per Charge

54"
Turning Radius

Up To
5.3mph
Maximum Speed

400lbs.
Weight Capacity

FDA Class II Medical Device¹

Also available in 3-wheel. Please see back of catalog for specifications.

Candy Apple Red

Viper Blue



VICTORY 10.2

Up To
13
Miles Per Charge

45"
Turning Radius

Up To
5.2mph
Maximum Speed

400lbs.
Weight Capacity



Victory® 10.2

Embrace your potential! The Victory® 10.2 is fully loaded with style and advanced features, including frosted LED headlights and an integrated storage space with cup holder. Drive at speeds up to 5.2 mph and see what life has in store for you!

ONLY available in 3-wheel. Please see back of catalog for specifications.

FDA Class II Medical Device¹

Candy Apple Red



VICTORY® 9

Victory® 9

Sophisticated and stylish, the Victory® 9 is everything you could want in a scooter. The delta tiller lets you operate the scooter with a single hand. Enjoy easy disassembly and plenty of lighting with the LED headlight.



Up To
13
Miles Per Charge

51.5"
Turning Radius

Up To
5.3mph
Maximum Speed

300lbs.
Weight Capacity

FDA Class II Medical Device¹

Also available in 3-wheel. Please see back of catalog for specifications.

Candy Apple Red



ACCESSORIES

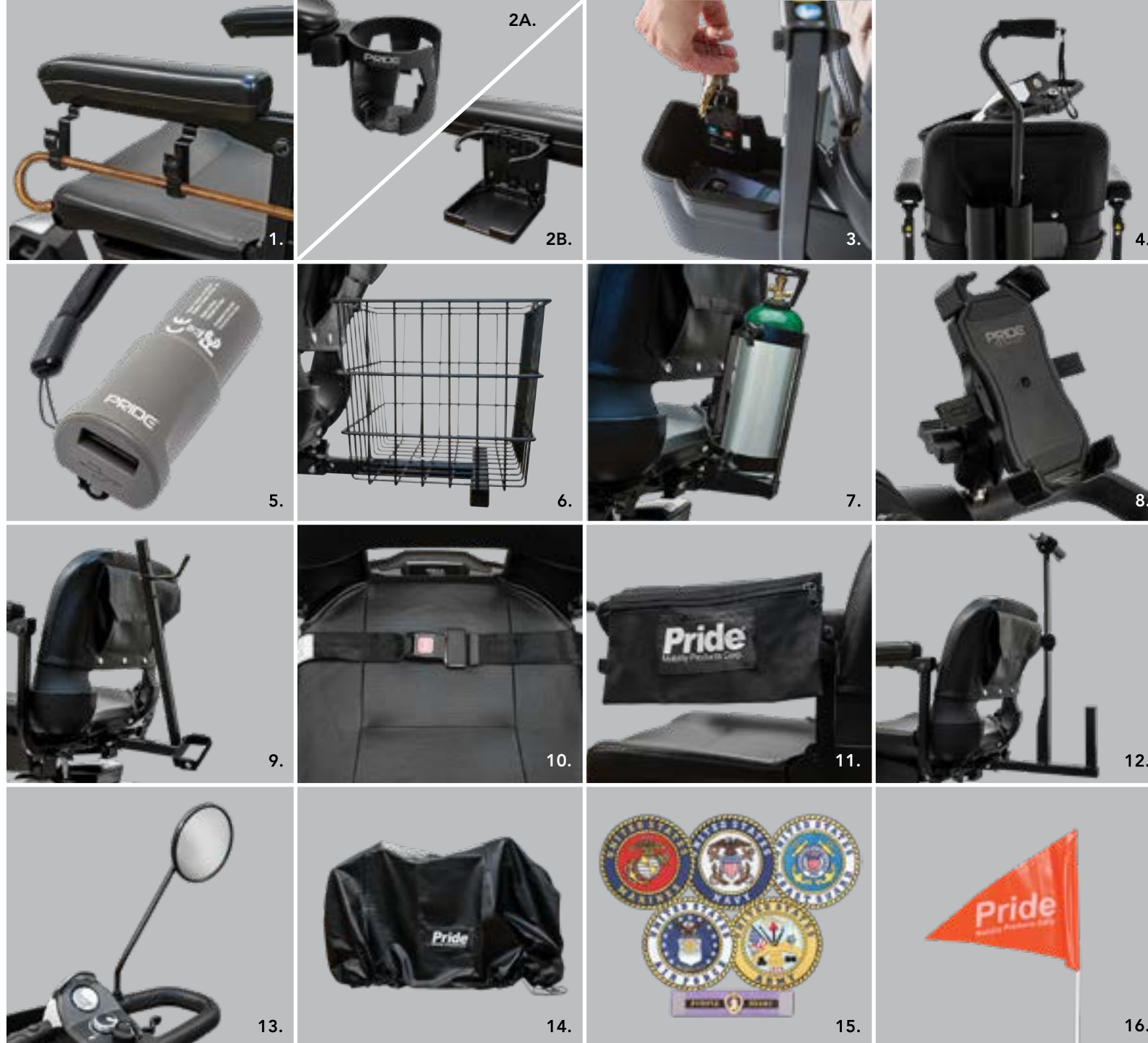

1. Cane Clip Attachment | 2A. New Cup Holder | 2B. Old Cup Holder | 3. Under Seat Storage | 4. Single or Double Cane Holder
 5. XLR USB Charger | 6. Rear Basket | 7. Oxygen Holder | 8. New Cell Phone Holder | 9. Wishbone Crutch Holder | 10. Lap Belt
 11. Saddlebag | 12. Walker Holder | 13. Rearview Mirror | 14. Weather Cover | 15. Military Patches | 16. Safety Flag







MODEL NAME / NUMBER	GO GO ELITE TRAVELLER® 2 SC442E (4W)	PX4 SC134	PURSUIT 2 SC7132	ZERO TURN 8 JAZZYZTS	ZERO TURN 10 S710ZT
WEIGHT CAPACITY	300 lbs.	500 lbs.	400 lbs.	325 lbs.	400 lbs.
MAXIMUM SPEED ²	Up to 4.23 mph	Up to 9.2 mph	Up to 9.3 mph	Up to 5.9 mph	Up to 7.3 mph
GROUND CLEARANCE ^{3,8,9}	1.34" at motor, 3.15" at mid-deck	3.5" at motor frame, 4.4" at mid-frame	3.78" at transaxle, 4.6" at mid-frame	1.3" at motor, 1.5" at anti-tip, 3.5" (side deck)	2" at motor 3" at mid-frame
TURNING RADIUS ³	37"	82.3"	69.3"	37.25"	43"
LENGTH / WIDTH ^{3,7}	39.37" / 19.45"	56" / 27-27.8"	57.5" / 29.7"	45.75" / 20.75"	48" / 24.25"
SEAT-TO-GROUND HEIGHT	18.25"-20.25"	24.17-25.29"	28.74"	22" - 23.5"	23.25" - 24.75"
SEAT-TO-DECK HEIGHT	16.38"-17.83"	16.54-18.39"	176.9-20.9"	17" - 18.5"	17.75"-19.25"
FRONT WHEELS (TIRES)	2" x 7" solid	13" pneumatic	13" pneumatic	2"x7" solid	9" solid
REAR WHEELS (TIRES)	2.5" x 8" solid	13" pneumatic	13" pneumatic	2.5"x9" solid	10.75" solid
SUSPENSION	N/A	Front & Rear	Front & Rear	Front and rear (CTS)	Front and rear (CTS)
RANGE PER CHARGE ⁵	12 Ah Battery Pack: Up to 6.6 miles at 300 lbs.; Up to 8.8 miles at 220 lbs. 18 Ah Battery Pack: Up to 10.4 miles at 300 lbs.; Up to 13.8 miles at 220 lbs.	Up to 23.4 miles (220 lbs.) Up to 14 miles at (500 lbs.)	Single Battery: Up to 17.4 miles (220 lbs.) Up to 13.8 miles (400 lbs.) Dual Battery: Up to 34.8 miles (220 lbs.) Up to 30.9 miles (350 lbs.)	Up to 11 miles (at 325 lbs.) Up to 13.1 miles (at 200 lbs.)	Up to 15.9 miles (at 400 lbs.) Up to 21.2 miles (at 200 lbs.)
HEAVIEST PIECE ³	35 lbs. (front section)	201.2 lbs. (base)	163 lbs. (base)	48 lbs. (rear section)	75 lbs. (front section)
STANDARD SEATING	Type: Mesh Back Weight: 23 lbs. Material: Black Vinyl Dimensions: 17" (W) x 17" (D)	Limited Recline High Back Dimensions: 18" (W) x 18" (D)	Limited Recline High Back with Sliders Dimensions: 18" (W) x 18" (D)	Type: Compact, foldable Weight: 27 lbs. Material: Black vinyl Dimensions: 17" (W) x 17" (D) Back height: 14"	Type: Foldable, deluxe contour Weight: 34 lbs. or Foldable, compact Weight: 30 lbs. Material: Black vinyl Dimensions: 18" (W) x 17" (D)
BATTERIES ^{4,13}	(Two) 12-volt, sealed lead-acid, non-spillable deep-cycle	(2) 12V 75Ah (SLA/AGM)	(1) or (2) 24V, 50Ah Lithium-ion	(2) 22 AH	(2) 40 AH
BATTERY WEIGHT ^{5,6}	12 Ah: 19.5 lbs. (standard) 18 Ah: 29.6 lbs.	48.8 lbs. each	23.8 lbs. each	32 lbs. (battery box), 13.5 lbs. each	30.25 lbs. each
BATTERY CHARGER	Off-board, 2A	Off-board, 8A	Off-board, 8A	Off-board, 3.5A	Off-board, 3.5A
HCPCS CODES	K0800 (Group 1, Standard)	K0899*	K0899*	K0899*	K0899*
WARRANTY	Frame: Lifetime limited Drivetrain: 2-year limited Electronics: 2-year limited Batteries: 6-month limited	Frame: Lifetime limited Drivetrain: 2-year limited Electronics: 2-year limited Batteries: 6-month limited	Frame: Lifetime limited Drivetrain: 2-year limited Electronics: 2-year limited Batteries: 3-year limited	Frame: Lifetime limited Drivetrain: 2-year limited Electronics: 2-year limited Batteries: 6-month limited	Frame: Lifetime limited Drive motors: 2-year limited Electronics: 2-year limited Batteries: 6-month limited

MODEL NAME / NUMBER	iRIDE® 2 S25	i-GO™ SC20	GO GO ELITE TRAVELLER® SC40E (3W), SC44E (4W)	GO GO® ENDURANCE Li S54LXLIT	GO GO® SPORT S73 (3W), S74 (4W)
WEIGHT CAPACITY	250 lbs.	275 lbs.	300 lbs.	325 lbs.	325 lbs.
MAXIMUM SPEED ²	Up to 5.8 mph	Up to 4 mph	Up to 4 mph	Up to 4.2 mph	Up to 4.7 mph
GROUND CLEARANCE ^{3,8,9}	1.3" at mid-frame	4.2" at mid-frame	1.38" at motor, 0.75" at anti-tip, 2.25" at mid frame	1.5" at motor 3.23" at deck	1.5" at motor, 0.75" at anti-tip
TURNING RADIUS ³	33.5"	45.9"	3W: 33" 4W: 44"	48.25"	3W: 36" 4W: 50.5"
LENGTH / WIDTH ^{3,7}	38"/ 19.25"	44"/ 20.3"	3W: 37" 4-W: 39.5" / 19.5"	42"/20.5"	3W: 42" 4W: 43" / 21.25"
SEAT-TO-GROUND HEIGHT	19" – 20"	22.25"	18.25"-20.25"	21.25"-22.75"	20.5" - 22"
SEAT-TO-DECK HEIGHT	11.5" – 12.5"	14.6"	15.75"-17.25"	16.25"-17.75"	17" - 18"
FRONT WHEELS (TIRES)	6.5" solid	8" hub motor	3W: 2" x 8" (4W: 2" x 7") solid	2" x 8" solid	3W: 3" x 8" (4W: 3" x 9") solid
REAR WHEELS (TIRES)	6.75" solid	9" perforated	2.5" x 8" solid	2" x 8" solid	3" x 9" solid
SUSPENSION	N/A	N/A	N/A	Front and rear (CTS)	N/A
RANGE PER CHARGE ⁵	Up to 10 miles at 250 lbs. Up to 12 miles at 200 lbs.	Up to 7 miles at 275 lbs. Up to 9.3 miles at 220 lbs.	3W: Up to 7.25 miles (12 AH) 4W: Up to 6 miles (12 AH) 3W: Up to 10.5 miles (18 AH) 4W: Up to 9.75 miles (18 AH)	8 AH: Up to 7.2 miles 16 AH: Up to 14.4 miles at 200 lbs.	3W: Up to 12.75 miles 4W: Up to 12 miles
HEAVIEST PIECE ³	32 lbs. (base only)	32.8 lbs. (rear base with seat back)	3W: 29.5 lbs. (front section) 4W: 34 lbs. (front section)	40.75 lbs. (front section)	3W: 35.75 lbs.(front section) 4W: 44 lbs. (front section)
STANDARD SEATING	Type: Compact, removable with folding back Weight: 10 lbs. Material: Molded plastic Dimensions: 14.75" x 13.5"	Type: Compact, folding (back is removable) Material: Molded plastic Dimensions: 16" x 16"	Type: Compact, foldable Weight: 23 lbs. Material: Black vinyl Dimensions: Width: 17", Depth: 17"	Type: Compact, mesh, foldable Weight: 23 lbs. Material: Black vinyl Dimensions: 17"x17", 20"x18"	Type: Compact, foldable Weight: 23 lbs. Material: Black vinyl Dimensions: Width: 17", Depth: 17"
BATTERIES ^{4,13}	(1) 36 volt, 5.2 AH lithium ion ¹³	(1) 25.2V 9.6 Ah Rechargeable Lithium-Ion	(2) 12 AH (standard) or (2) 18 AH (optional)	8 AH ¹³ lithium ion battery pack or 16 AH ¹² lithium ion battery pack (optional)	(2) 18 AH
BATTERY WEIGHT ^{5,6}	4.5 lbs.	4.8 lbs.	9 lbs. each (12 AH), 20 lbs. per battery pack 14 lbs. each (18 AH), 29.5 lbs. per battery pack	8 lbs. (8 AH); 12 lbs. (16 AH)	14 lbs. each 29.5 lbs. per battery pack
BATTERY CHARGER	36 volt lithium, off-board	Off-board, 3.5 amp (lithium-ion)	Off-board, 2 amp	Off-board, 3.5 amp (lithium ion) ¹³	Off-board, 2 amp
HCPCS CODES	N/M (non-medical)	N/M (non-medical)	K0800 (Group 1, Standard)	K0899*	K0801 (Group 1, Heavy Duty)
WARRANTY	Frame: 3-year limited Electronics: 2-year limited Drivetrain, motor, battery and charger: 1-year limited	Frame: 3 years Electronics: 2 years (does not include charger) 1 year on motor, battery and charger	Frame: Lifetime limited Drivetrain: 2-year limited Electronics: 2-year limited Batteries: 6-month limited	Frame: Lifetime limited Drivetrain: 2-year limited Electronics: 2-year limited Batteries: 2-year limited	Frame: Lifetime limited Drivetrain: 2-year limited Electronics: 2-year limited Batteries: 6-month limited

MODEL NAME / NUMBER	GO GO® ULTRA X¹ S39 (3W), S49 (4W)	GO GO® ES 2¹ S81	REVO® 2.0¹ S66 (3W), S67 (4W)	VICTORY® LX SPORT¹ S710LXW
WEIGHT CAPACITY	300 lbs.	250 lbs.	400 lbs.	400 lbs.
MAXIMUM SPEED²	3W: Up to 4.3 mph 4W: Up to 4.1 mph	Up to 4 mph	Up to 5.2 mph	Up to 8.6 mph at 200 lbs.
GROUND CLEARANCE³,⁸,⁹	1.25" at motor 3.23" at deck	1.5" at motor 0.75" at anti-tip	3W: 3.25" at side deck 4W: 3.5" at side deck	2.2" at motor 3.15" at mid-frame
TURNING RADIUS³	3W: 36.5" 4W: 52.25"	31"	3W: 40" 4W: 52"	61.25"
LENGTH / WIDTH³,⁷	40.25" / 19.25"	36.75" / 19.5"	3W: 46" 4W: 47" / 20.75"	47" / 25.5"
SEAT-TO-GROUND HEIGHT	21.5 -23"	20"-21"	22" - 23.5"	23" - 25"
SEAT-TO-DECK HEIGHT	16.5" -18"	16.25" -17.25"	15" -16.5"	16.5" -18.5"
FRONT WHEELS (TIRES)	2" x 8" solid	2" x 7.5" solid	3W: 3" x 8" solid 4W: 3" x 9" solid	3.5" x 10" solid
REAR WHEELS (TIRES)	2.5" x 8" solid	3" x 7.5" solid	3" x 9" solid	3.5" x 10" solid
SUSPENSION	N/A	N/A	Front and rear (CTS)	Front and rear (CTS)
RANGE PER CHARGE⁵	3W: Up to 8 miles (200 lbs.) 3W: Up to 6.2 miles (300 lbs.) 4W: Up to 8.9 miles (200 lbs.) 4W: Up to 6.6 miles (300 lbs.)	Up to 6.24 miles	3-Wheel: Up to 17.4 miles (at 200 lbs.) Up to 12.8 miles (at 400 lbs.) 4-Wheel: Up to 17.8 miles (200 lbs.) Up to 14.8 miles (at 400 lbs.)	Up to 19.7 miles (at 200 lbs.) Up to 13 miles (at 400 lbs.)
HEAVIEST PIECE³	3W: 29.5 lbs. (front section) 4W: 34.5 lbs. (front section)	41.4 lbs. (scooter base)	3W: 48 lbs. (rear section) 4W: 57 lbs. (front section)	77 lbs. (front section)
STANDARD SEATING	Type: Compact, foldable Weight: 23 lbs. Material: Black vinyl Dimensions: 17" (W) x 17" (D)	Type: Compact, foldable Weight: 17 lbs. Material: Black vinyl Dimensions: 17" (W) x 15" (D)	Type: Compact, foldable Material: Black vinyl Dimensions: 20" (W) x 18" (D)	Type: Limited reclining high-back Weight: 43 lbs. Material: Black vinyl Dimensions: 18" (W) x 18" (D)
BATTERIES⁴	(2) 12 AH	(2) 12 AH	(2) U-1	(2) 50 AH
BATTERY WEIGHT⁵,⁶	9 lbs. each 20 lbs. per battery pack	9 lbs. each	25 lbs. each	30.2 lbs. each
BATTERY CHARGER	Off-board, 2 amp	Off-board, 2 amp	Off-board, 3.5-amp	Off-board, 5 amp
HCPCS CODES	K0800 (Group 1, Standard)	K0800 (Group 1, Standard)	K0899*	K0899*
WARRANTY	Frame: Lifetime limited Drivetrain: 2-year limited Electronics: 2-year limited Batteries: 6-month limited	Frame: Lifetime limited Drivetrain: 2-year limited Electronics: 2-year limited Batteries: 6-months	Frame: Lifetime limited Drivetrain: 2-year limited Electronics: 2-year limited Batteries: 6-months	Frame: Lifetime limited Drivetrain: 2-year limited Electronics: 2-year limited Batteries: 6-months

MODEL NAME / NUMBER	VICTORY® 10.2¹ S6102	VICTORY® 10¹ SC610 (3W), SC710 (4W)	VICTORY® 9¹ SC609 (3W), SC709 (4W)	MAXIMA¹ SC901 (3W), SC941 (4W)
WEIGHT CAPACITY	400 lbs.	400 lbs.	300 lbs.	500 lbs.
MAXIMUM SPEED ²	Up to 5.2 mph	Up to 5.3 mph	Up to 5.3 mph	Up to 5.8 mph
GROUND CLEARANCE ^{3,8,9}	2.4" at transaxle, 2.1" at anti-tip, 3" at side deck	3W: 2.2" at motor, 1.26" at anti-tip 4W: 2" at motor, 1.5" at anti-tip	3W: 1.8" at transaxle, 1.4" at anti-tip 4W: 1.8" at transaxle, 1.4" at anti-tip	3W: 2.5" at motor, 3" at mid-frame 4W: 2.25" at motor
TURNING RADIUS ³	42"	3W: 42" 4W: 54"	3W: 40.25" 4W: 51.5"	3W: 49" 4W: 53"
LENGTH / WIDTH ^{3,7}	45"	3W: 45.25" 4W: 47" / 22.5"	3W: 43.5" 4W: 45.5" / 22.5"	3W: 47.5" 4W: 47.5" / 27"
SEAT-TO-GROUND HEIGHT	22" – 24"	23.5"-25"	22.5"-24"	22.1" - 24.1" 22.32"-28.57" (with power elevating seat)
SEAT-TO-DECK HEIGHT	15.25" – 17.25"	17.5"-19"	17.25"-18.75"	17.13" - 19.13" 17.36" - 23.61" (with power elevating seat)
FRONT WHEELS (TIRES)	3.5" x 10" solid	3.5" x 10" solid	3W: 3" x 8" solid 4W: 3" x 9" solid	3W: 10.5"x 3.6" solid 4W: 10"x 3.6" solid
REAR WHEELS (TIRES)	3.5" x 10" solid	3.5" x 10" solid	3" x 9" solid	10.75"x 3.6" solid
SUSPENSION	N/A	N/A	N/A	N/A
RANGE PER CHARGE ⁵	Up to 11 miles (U-1) Up to 13 miles (40 AH)	Up to 15.5 miles	Up to 13 miles	3W: Up to 19.8 miles 4W: Up to 19.5 miles
HEAVIEST PIECE ³	3W: 56.5 lbs. (front section)	3W: 54 lbs. (front section) 4W: 63 lbs. (front section)	3W: 48.5 lbs. (front section) 4W: 59 lbs. (front section)	N/A (unit does not disassemble)
STANDARD SEATING	Type: Compact, foldable Weight: 28.5 lbs. Material: Black vinyl Dimensions: Width: 18", Depth: 17"	Type: Compact, foldable Weight: 28 lbs. Material: Black vinyl Dimensions: Width: 18", Depth: 17"	Type: Compact, foldable Weight: 28 lbs. Material: Black vinyl Dimensions: Width: 18", Depth: 17"	Type: Depth-adjustable, limited recline high back Weight: 53.2 lbs. Material: Black vinyl Dimensions: 22" x 18"-20"
BATTERIES ⁴	(2) U-1 (standard) (2) 40 AH (optional)	(2) U-1 (standard) (2) 40 AH (optional)	(2) U-1	(2) GEL, 58AH, NF-22
BATTERY WEIGHT ^{5,6}	24 lbs. each (standard) 32 lbs. each (optional)	24.5 lbs. each (standard) 32.5 lbs. each (optional)	24 lbs. each	36.5 lbs. each
BATTERY CHARGER	Off-board, 3.5 amp (U-1) Off-board, 5 amp (40 AH)	Off-board, 3.5 amp (U-1) Off-board, 5 amp (40 AH)	Off-board, 3.5 amp	Off-board, 5 amp
HCPSC CODES	K0801 (Group 1, Heavy Duty)	K0801 (Group 1, Heavy Duty)	K0800 (Group 1, Standard)	3W: K0802 (Group 1; Very Heavy Duty) 4W: K0808 (Group 2; Very Heavy Duty)
WARRANTY	Frame: Lifetime limited Drivetrain: 2-year limited Electronics: 2-year limited Batteries: 6-months	Frame: Lifetime limited Drivetrain: 2-year limited Electronics: 2-year limited Batteries: 6-months	Frame: Lifetime limited Drivetrain: 2-year limited Electronics: 2-year limited Batteries: 6-months	Frame: Lifetime limited Drivetrain: 2-year limited Electronics: 2-year limited Batteries: 6-months



(US) 800-800-8586 | (CAN) 888-570-1113 | pridemobility.com |      

1. Pride® FDA Class II Medical Devices are designed to aid individuals with mobility impairments.
2. Varies with user weight, terrain type, battery amp- hour (AH), battery charge, battery condition and tire condition.
This specification can be subject to a variance of (+ or -) 10%.
3. Varies with user weight, terrain type, battery amp- hour (AH), battery charge, battery condition and tire condition.
This specification can be subject to a variance of (+ or -) 10%.
4. Due to manufacturing tolerances and continual product improvement, this specification can be subject to variance of + or - 3%.
5. Deep cycle (AGM or gel cell type recommended).
6. Tested in accordance with ANSI/RESNA, WC Vol 2, Section 4 and ISO 7176-4 standards. Results derived from theoretical calculations based on battery specifications and drive system performance. Test conducted at maximum weight capacity.
7. Battery weight may vary based on manufacturer.
8. Width of base (not including seat).
9. Does not account for anti-tip clearance.
10. At midframe.
11. Product is available exclusively to Authorized Pride Brick & Mortar Providers. No internet sales are permitted. Available in store only.
Other conditions apply.
12. Does not meet airline requirements.
13. Transport of this item on commercial aircraft is subject to federal regulations and airline policy. Please consult your airline prior to your flight to ensure your item and its lithium ion battery are permitted.

NOTE: All specifications subject to change without notice.

The information contained herein is correct at the time of publication; we reserve the right to alter specifications without prior notice. Speed and range vary with user weight, terrain type, battery charge, battery condition and tire pressure. Due to manufacturing tolerances and continual product improvement, length, width, turning radius and ground clearance can be subject to variance of + or - 3 %. Dimensions listed are for scooter only. Overall measurements will vary based on seating and accessory selections.

N/M: This product is not a medical device and is not intended to assist, treat, diagnose, or alleviate any medical condition or disability.

*K0899 – power mobility device, not coded by DME PDAC.

**Not all accessories are available for all products. Please speak with your Provider for details and availability.

HCPCS codes provided should not be considered as legal advice and do not guarantee reimbursement. DME providers are responsible for determining appropriate billing codes when submitting for insurance reimbursement.

