

THE COTTONWOOD

2120sf, 3 bed, 2.5 bath



TOWNHOME MIDDLE UNIT

Buyer's purchased floorplan

	TILE
	CARPET
	HARDWOOD
	LAMINATE FLOORING LVP
	SHEET VINYL
	SLAB CTOP
	LAMINATE CTOP

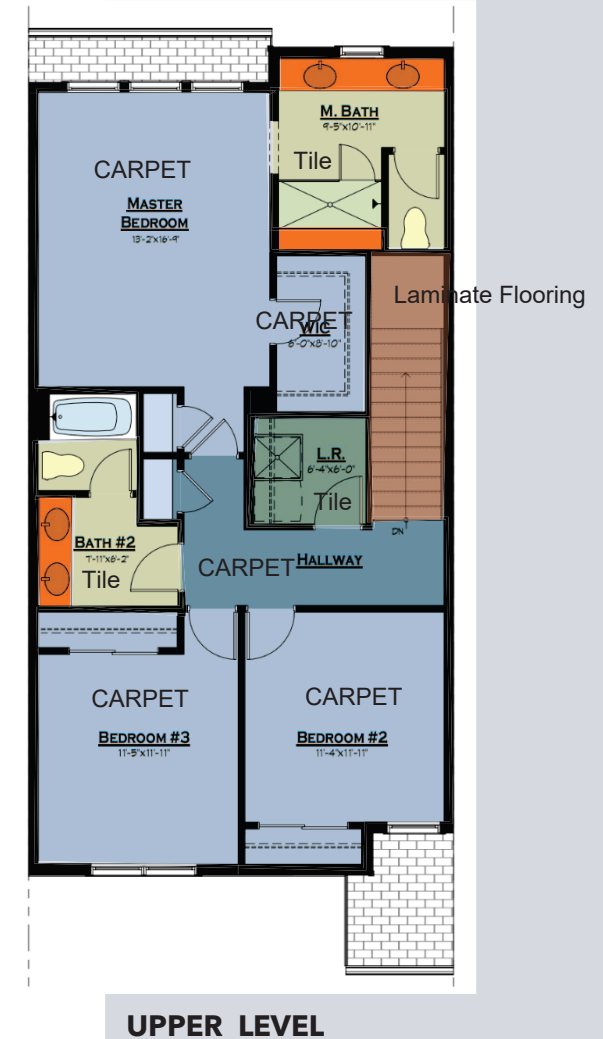
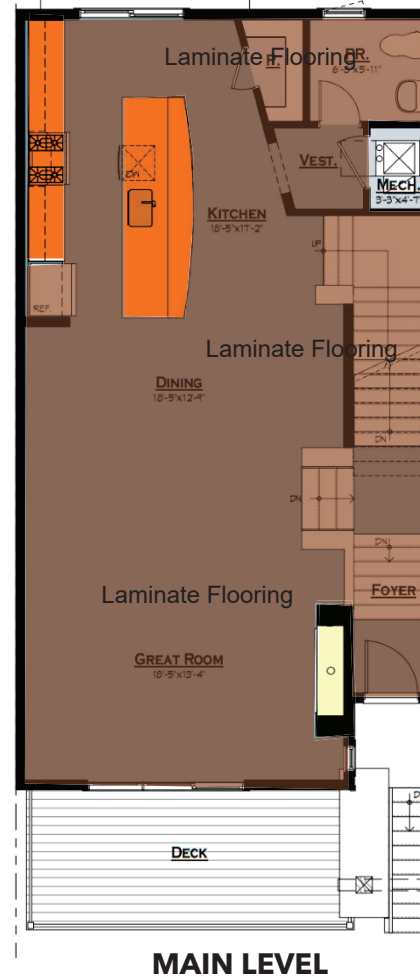
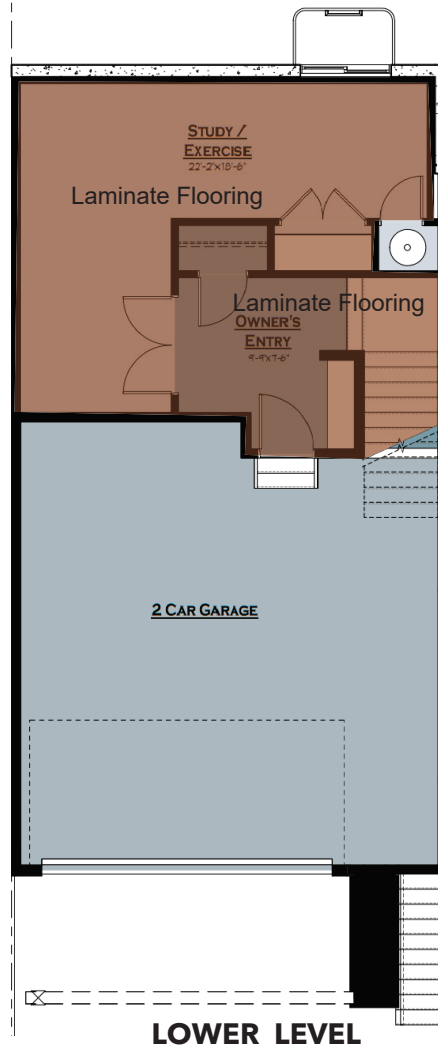

DS
GE



SPEC 3833 WHISPERING SAGE ST

KITCHEN

BACKSPLASH

BATH 2 WALL TILE

MST WALL & FLOOR

BATH 2 & LAUNDRY
FLOOR

KITCHEN CTOPS

LAMINATE

BATH CTOPS

CARPET

FIREPLACE TILE



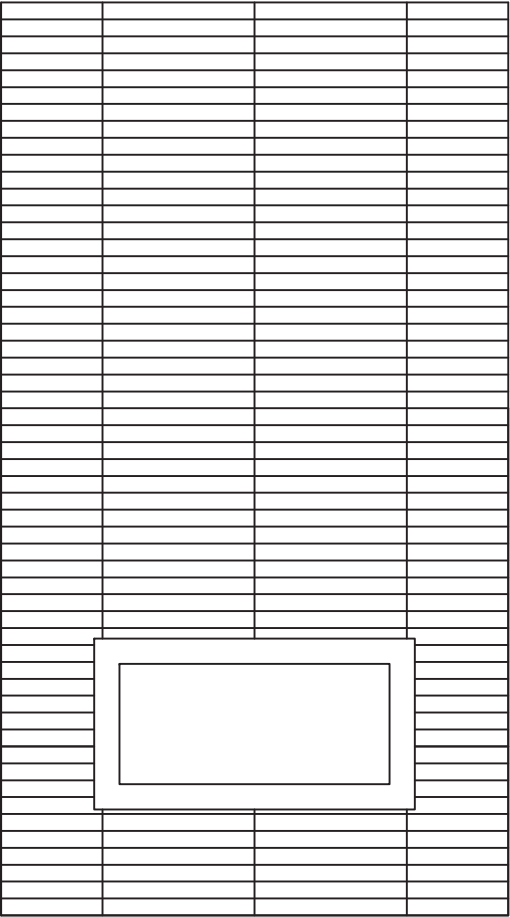

MSI; BRICKSTONE MATTE, 2X18 TAUPE
HORIZONTAL STACK STRAIGHT TO 9' CEILING
WITH SIDES
*TSSG STONE GRAY SCHLUTER
GROUT #543 DRIFTWOOD



GREAT ROOM FIREPLACE

DATE: 1.23.25

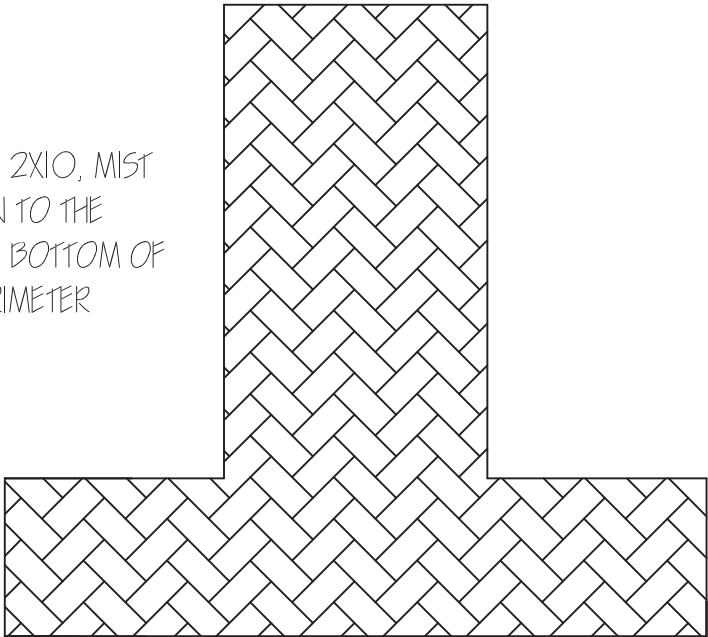

 SADDLEBACK DESIGN Flooring  Finishes	Homeowner: SPEC Address: 3833 WHISPERING SAGE ST.	DRAWINGS ARE NOT TO SCALE AND FOR DESIGN INTENT ONLY
	Community: PINECREST RIDGE Builder: ASCENT BUILDERS	

DAL: ARTISTIC REFLECTIONS WALL TILE, 2X10, MIST GLOSS SET IN A HERRINGBONE PATTERN TO THE CEILING BEHIND THE HOOD AND TO THE BOTTOM OF THE CABINETS ON THE REST OF THE PERIMETER
POINTS UP
NO RETURNS
TSI IVORIE ON EDGES
GROUT #640 ARTIC WHITE



KITCHEN BACKSPLASH

DATE: 1.23.25

 <div>SADDLEBACK DESIGN Flooring  Finishes</div> <div>515 W MISSISSIPPI AVE Denver, CO 80223 303.940.3932</div>	<div>Homeowner: SPEC Address: 3833 WHISPERING SAGE ST.</div> <div>Community: PINECREST RIDGE Builder: ASCENT BUILDERS</div>	<div>DRAWINGS ARE NOT TO SCALE AND FOR DESIGN INTENT ONLY</div> <div>APPROVAL</div> <div>INITIAL: ^{DS} _ DATE: 1/27/2025</div>
---	---	--

DALTILE; RIGID CLAY RIDGE, 12X24 , ROCK SET
STRAIGHT - VERTICAL TO CEILING
*TSI IVORIE ON EDGES
*GROUT #545 BLEACHED WOOD

NO SOAP

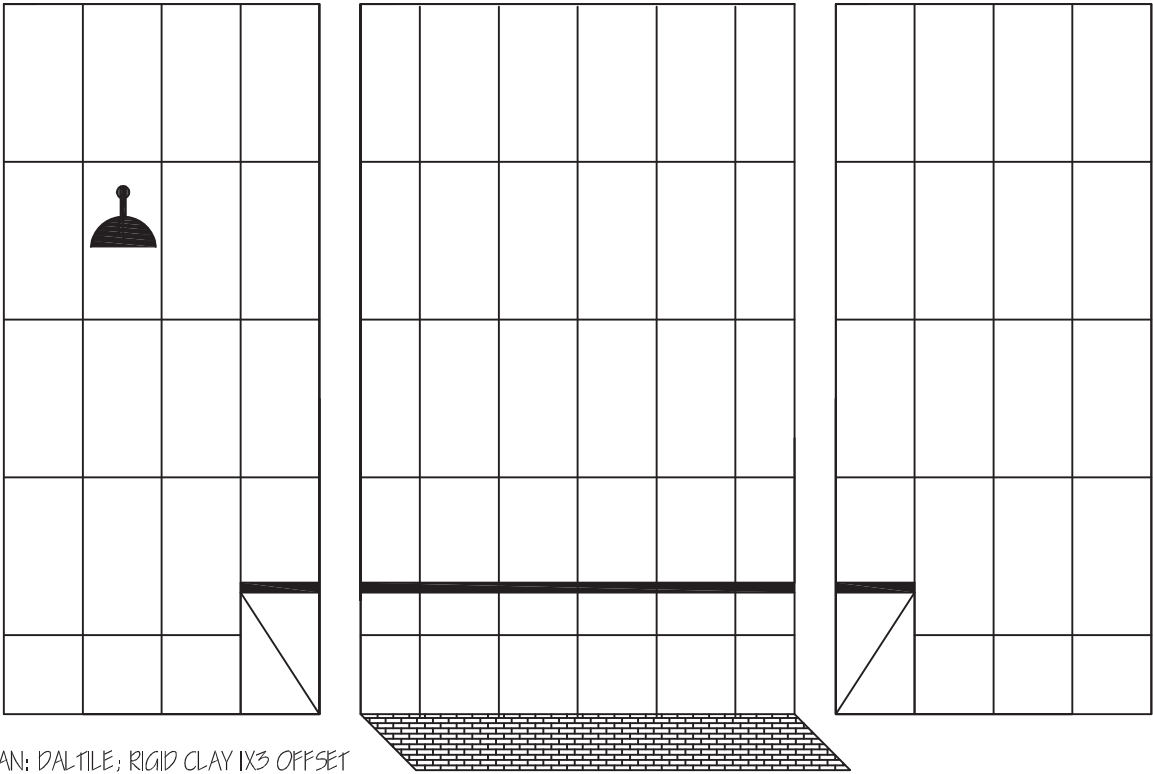

BENCH-CURB: WHITE STARON



SHOWER PAN: DALTILE; RIGID CLAY 12X24, ROCK SET
MOSAIC MESH, ROCK
GROUT #545 BLEACHED WOOD

MASTER BATHROOM

DATE: 1.23.25

 SADDLEBACK DESIGN Flooring & Finishes	Homeowner: SPEC	DRAWINGS ARE NOT TO SCALE AND FOR DESIGN INTENT ONLY
	Address: 3833 WHISPERING SAGE ST.	
515 W MISSISSIPPI AVE Denver, CO 80223 303.940.3932	Community: PINECREST RIDGE Builder: ASCENT BUILDERS	DS APPROVAL  1/27/2025 INIT _____ DATE: _____

EMSER, CATCH WALL, 6X6 ICE GLOSS SET STRAIGHT
WITH BN EDGES TO STD HEIGHT

*GROUT #640 ARTIC WHITE

NO SOAP

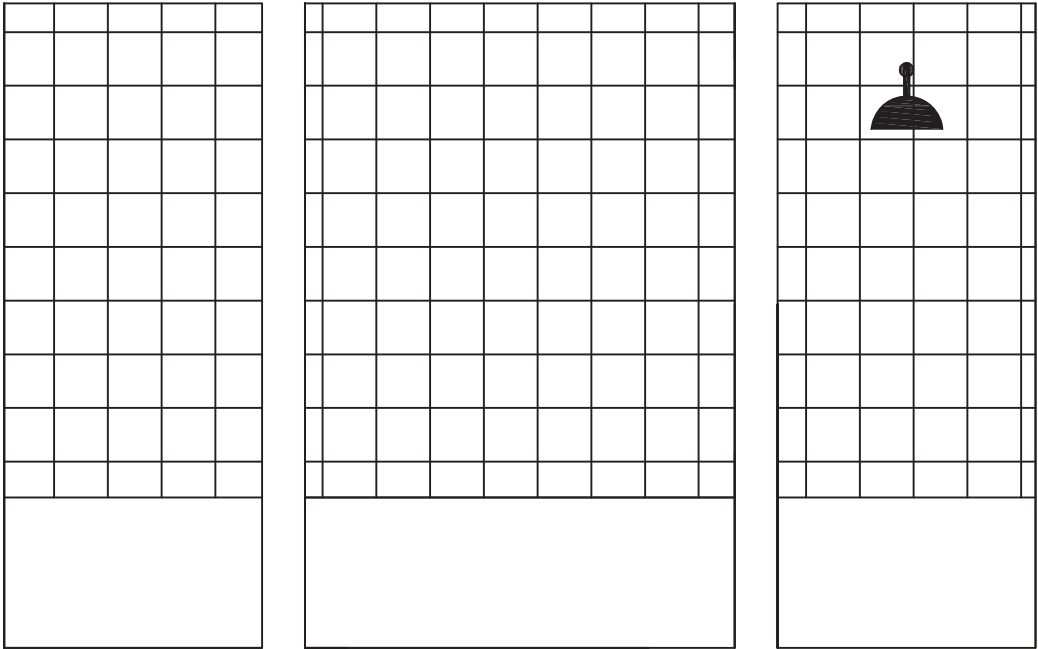

BATHROOM 2

DATE: 1.23.25

 SADDLEBACK DESIGN Flooring & Finishes	Homeowner: SPEC	DRAWINGS ARE NOT TO SCALE AND FOR DESIGN INTENT ONLY
	Address: 3833 WHISPERING SAGE ST.	
515 W MISSISSIPPI AVE Denver, CO 80223 303.940.3932	Community: PINECREST RIDGE Builder: ASCENT BUILDERS	APPROVAL
		INITIAL ^{DS} <u>GE</u> - DATE: 1/27/2025