

INDUSTRIAL BOX SCRAPER

2C2 INDUSTRIAL BOX SCRAPER

EXPANDED PARTS INDEX

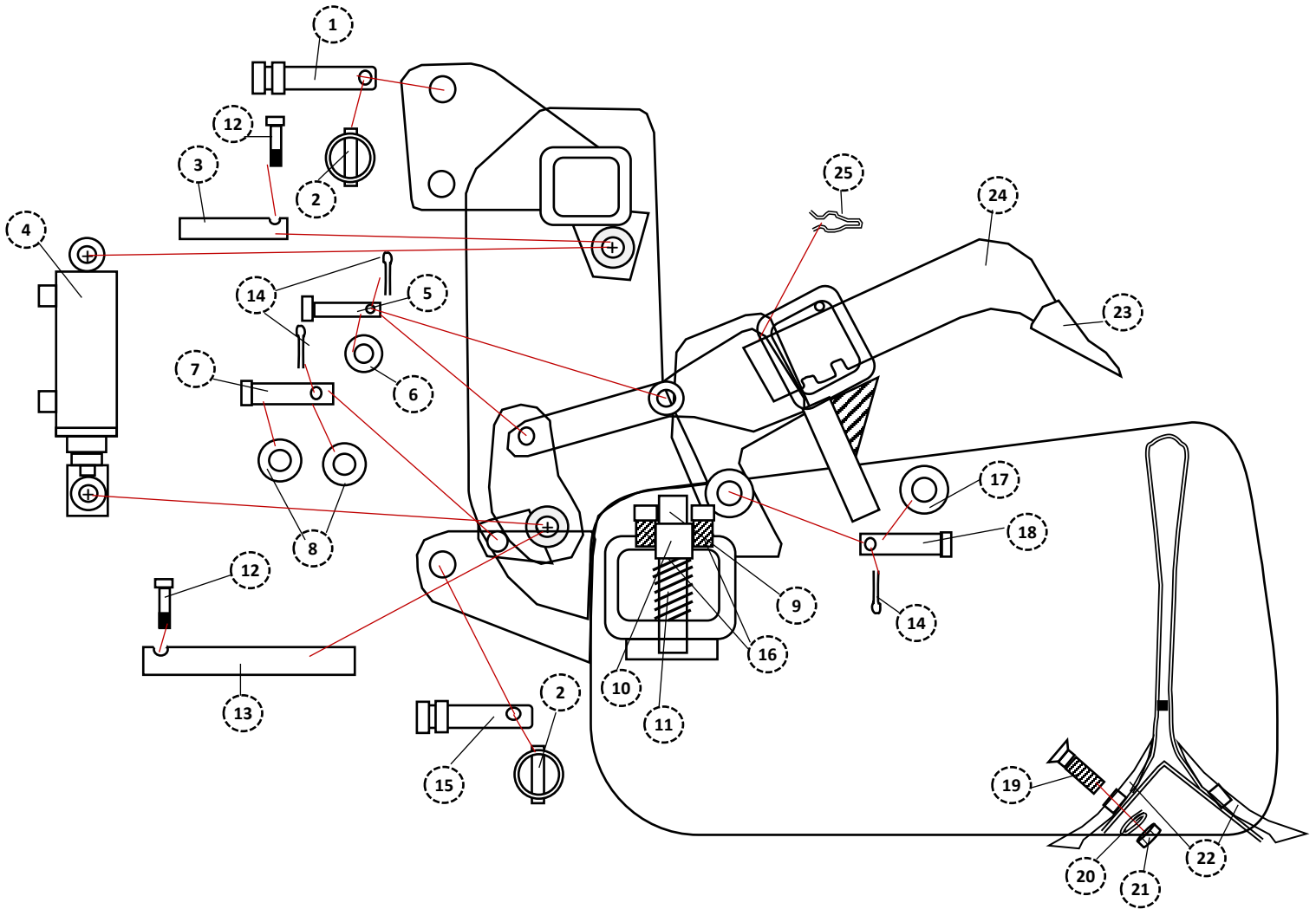

		60	66	72	76	
1	P075500C1TL	CAT I TOP LINK	1	1	1	1
2	P716175LY	7/16 X 1 1/2" LYNCH PIN	3	3	3	3
3	R04AB001	TOP CYLINDER ROD	1	1	1	1
4	CIS2X4-9	CYLINDER	1	1	1	1
5	P050200CL	1/2 X 2" CLEVIS PIN	2	2	2	2
6	W050SAEF	1/2" SAEF FLAT WASHER	6	6	6	6
7	P075300CL	CYLINDER/ TAILBOARD LOCK PIN	1	1	1	1
8	W075SAEF	BOTTOM CYLINDER PIN WASHER	1	1	1	1
9	R08A001	MAIN LOCK PIN	1	1	1	1
10	X17A32	LATCH PIN COLLAR	1	1	1	1
11	S151632SC0M	LOCK PIN SPRING	1	1	1	1
12	SS516075	5/16 X 3/4" SQUARE HEAD SET	2	2	2	2
13	R05A09	BELL CRANK SHAFT	1	1	1	1

		60	66	72	76	
14	P532125C0T	5/32 X 1 1/4" COTTER PIN	5	5	5	5
15	P078375C1D	7/8 X 3 3/4" CAT I DRAW PIN	2	2	2	2
16	B038100H	3/8 X 1" HEX BOLT	2	2	2	2
17	W100SAEF	PIVOT EAR WASHER	4	4	4	4
18	P100258CLP	1 X 2 15/16" PLATED CLEVIS PIN	2	2	2	2
*19	B058200P	5/8 X 2" PLOW BOLTS	10	10	12	12
*20	N058H	5/8" HEX NUT	10	10	12	12
*21	W058L	5/8" LOCK WASHER	10	10	12	12
*	B058200PA	PLOW BOLT ASSEMBLY (3 Parts)	10	10	12	12
22	CE	CUTTING EDGE	2	2	2	2
23	H434T	REPLACEABLE SHANK TIP				
24	G163	4 X 4 SHANK	5	6	7	7
25	SR100	SHANK RETAINER	5	6	7	7

PLEASE NOTE: The illustrations above are for reference only. SUPERIOR IMPLEMENTS reserves the right to change or correct part numbers, descriptions or dimensions at any time. If you have specific questions about parts not specified in the illustration above, please contact your SUPERIOR IMPLEMENTS authorized dealer.