

REAR BLADE

CAT II REAR BLADE

EXPANDED PARTS INDEX

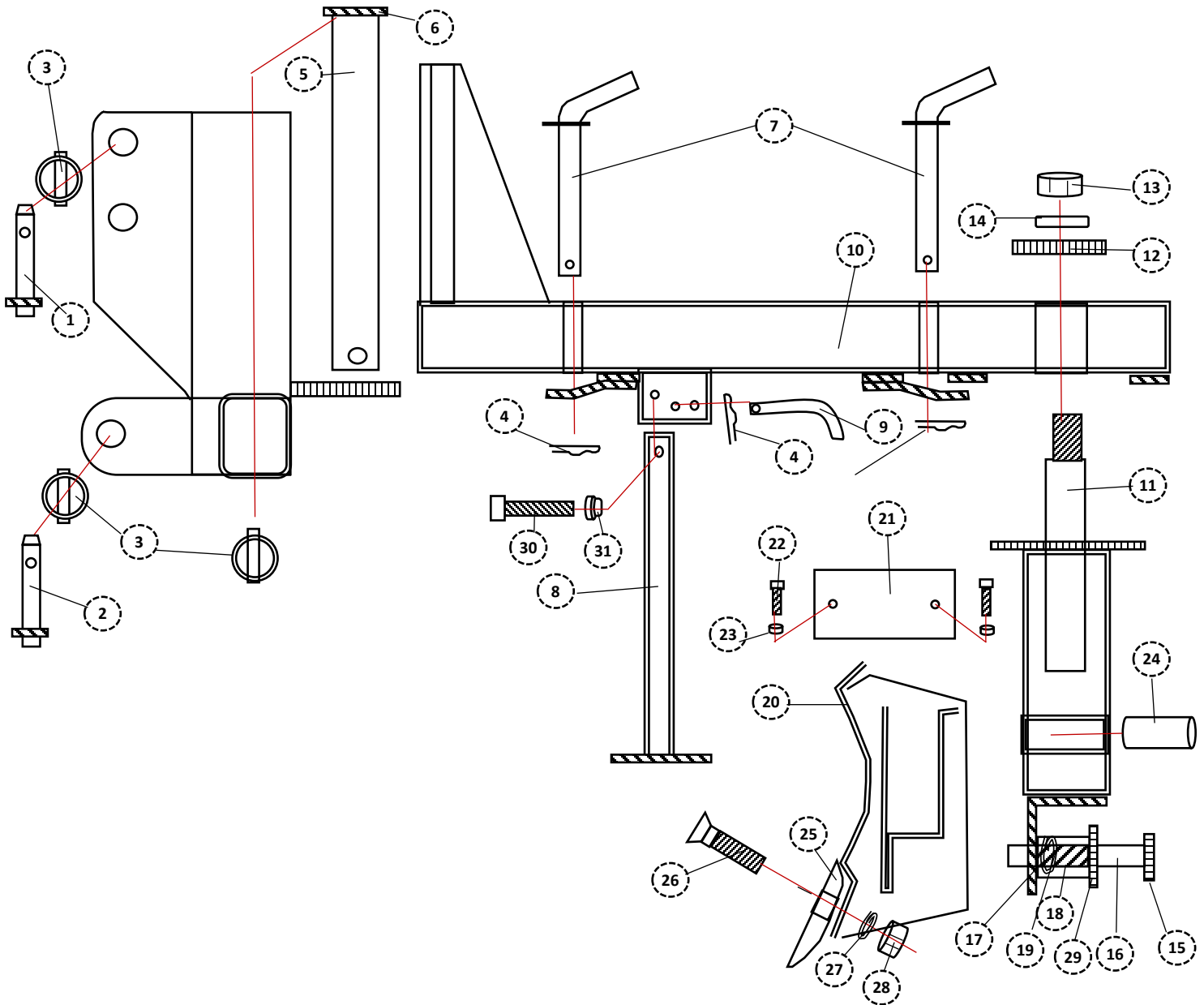

			75	85	95
1	P100500C2TL	CAT II TOP LINK	1	1	1
2	P118500MD	CAT II DRAW PIN	2	2	2
3	P716175LY	7/16 X 1 1/2" LYNCH PINS	4	4	4
4	P11	HAIR PIN	2	2	2
5	R174106	3-POINT SHAFT	1	1	1
6	P0122	PIN TOP	1	1	1
7	R004109	LOCK PINS	1	1	1
8	T015113	JACK STAND	1	1	1
9	P050300BL	BENT "L" PIN	1	1	1
10	T184101	CAT II BOOM	1	1	1
11	R104122	KING PIN	1	1	1
12	P034150	PEDISTAL WASHER	1	1	1
13	N125L	1 1/2" LOCK NUT	1	1	1
14	W125F	1 1/2" FLAT WASHER	1	1	1
15	R01134	PIN TOP			
16	R044108	TILT LOCK OUT PIN			

			75	85	95
17	W075L	3/8" LOCK WASHER			
18	X174011	TILT PIN SPRING			
19	S075200COM	TILT COMPRESSION SPRING			
20	P0151(89/99/88)	MOLDBOARD	1	1	1
21	F125211	KEEPER PLATE	1	1	1
22	B038150	3/8 X 1 1/2" BOLT FOR KEEPER PLATE	2	2	2
23	N038L	3/8" NYLOCK FOR KEEPER PLATE	2	2	2
24	R105171	TILT PIN	1	1	1
25	CE	CUTTING EDGE	1	1	1
26	B058200P	5/8" X 2" PLOW BOLT	7	8	9
27	W058L	5/8" LOCK WASHER	7	8	9
28	N058H	5/8" HEX NUT	7	8	9
29	W075F	3/2" FLAT WASHER			
30	B050350	1/2 X 3 1/2" BOLT	1	1	1
31	N050L	1/2" LOCK NUT	3	3	3

PLEASE NOTE: The illustrations above are for reference only. SUPERIOR IMPLEMENTS reserves the right to change or correct part numbers, descriptions or dimensions at any time. If you have specific questions about parts not specified in the illustration above, please contact your SUPERIOR IMPLEMENTS authorized dealer.