

I'm not robot  reCAPTCHA

I'm not robot!

John deere 265 mower drive belt diagram lt155

John deere lt155 mower belt diagram. John deere ltr155 drive belt replacement.

I'm disappointed.



After using my LT155 Lawn Tractor once or twice a week for six months every year for 19 years, the drive belt gave out. Although it didn't break, it finally cracked enough become too loose. Luckily it slipped off the transmission just as I finished mowing the yard. Yes, I should have changed it proactively much, much earlier. The new belt didn't come with instructions and the owner's manual only describes how to change the mower blade drive belt, which I had already done years ago. I did find an article online by blizzardj.1 But I want to provide my own take on the procedure with additional advice and clarifications. If you have the tools, ability and agility, you can change your own drive belt in one or two hours, for just the price of a new belt (about \$30 at my local John Deere dealer). You can download and print these steps. You will be prompted for a user name and password. The user name is Guest and the password is deere. Tools Needed Safety glassesMechanic's glovesTrigger clamp (like one shown here)Vice grips or locking pliersOld flat head screw driver or pointed pry bar13mm socket and ratchet wrench, deep socket or with extender2 new cotter pins to replace old ones if necessaryDigital camera or smartphone to remember parts orientationOld putty knife and air compressor to clean out old grass clippings Remove Mower Deck Follow the instructions in the owner's manual to detach and remove the mower deck from under the tractor. It needs to be out of the way to access the power train drive belt. Clean the Underside There can be quite a bit of old grass clippings and dirt accumulated in the hidden ledges and crevices under the tractor. Use an old putty knife, screwdriver and/or air compressor to poke around. Clean it before beginning to avoid a face full of dust while you're working on it. Park the Tractor Position the tractor on a level surface and chock all four wheels so it can't roll. Release the brake lever. I have a storm shelter in the garage floor. I parked the tractor over it, such that I could sit comfortably underneath it. You can also lie on your back on the floor. Please wear safety glasses. Parts Reference In the pictures that follow, I refer to various parts using the same numbers on the John Deere parts diagram.2 In summary, you'll have to remove the parts I circled here in red, as well as detach one end, but not remove, each of the two steering tie rods. Remove Tension Spring Start by removing the tension spring (14). Wear gloves and safety glasses. Use a trigger clamp to help relieve tension on the spring. Place one jaw on the notched arm shown, and the other jaw on the nearby steel crossbar. Use vice grips to lock onto the straight wire at the other end of the spring (not shown) and pull enough to remove it from the bushing under the idler (24). Wear gloves to avoid scraping your hands.

Remove Belt from Transmission Once the tension spring is released, remove the belt from the pulley (10) over the transmission (not shown) and through the guide (4). Remove the Idler The other end of the tension spring (14) is hooked onto the idler (24) against the left side of the tractor's frame. Once the spring is removed, use a 13mm socket to remove this idler. The bolt can be pushed upward to more easily remove the idler and belt together. Disconnect Tie Rods Next unhook both tie rods (18, 19) from the steering column by removing the cotter pins (15) and washers (16). You will probably need new cotter pins when you reinstall the tie rods later. You could instead remove the tie rods from the wheels at the front if that's easier. But don't remove both ends of the tie rods.

(This parts diagram is just to show the cotter pins on the steering tie rods. Disregard all other part number references here and refer instead to the Parts Reference diagram earlier.) Remove Belt from Engine Remove the belt from the upper pulley (27) assembly under the engine (not shown). Fish the belt through the guides (17) and over the loose ends of the two steering tie rods (not shown). Disassemble the Idler/Pulley The final steps to remove the old belt involve the S-shaped idler/pulley assembly in the middle of the underside of the tractor. Before you remove the guide (30), take a digital picture of it so you can refer to it when you reinstall it. Notice how it lines up with the other parts of the arm (6). I'm not sure it makes a difference, but I was careful to reinstall mine in the same orientation. Now remove the guide (30) attached to the pulley (31), but do not remove the pulley (31) itself. Next pivot the assembly so the idler (32) comes into view. Don't loosen the pivot bolt. Remove the idler (32). You should be able to get enough of the socket on the nut to loosen it. The steel crossbar is slightly in the way. Fish Out the Belt Once it is free of all idlers, pulleys and guides, you can remove the belt by pushing it up and over the flat vertical bar shown. (The spring shown here would not be attached.) Notice the notch in the frame that is just big enough to fit the belt through. You can then fish the whole belt down through the hole in the frame just visible in this view, top right. Install New Belt Install the new belt by fishing it up through that hole in the frame, where you just removed the old belt. Then pull the left side of the belt over and down through the notch in the frame.



Route the new belt over the loose steering tie rods, through the guide (17) and onto the upper pulley (27) under the engine. Route the new belt through the guide (4) and onto the pulley (10) at the transmission. Route the new belt between the frame and the idler (24) at the same time you reinstall the idler (24) and bushing, along the left side of the frame. Route the new belt through the S-shaped idler/pulley assembly while reinstalling the idler (32), then reattach the guide (30) to the pulley (31). Refer to the digital picture you took earlier to properly align the guide (30) in relation to the arm (6). The outside (back) of the new belt rides on the pulley (31) while the inside of the belt rides on the idler (32). Check that the new belt is routed properly through all guides, idlers and pulleys. It has a tendency to slip off the transmission or engine pulleys as you route it other places. Reattach the steering tie rods, using new cotter pins if necessary. The last step is to reattach the tension spring (14).

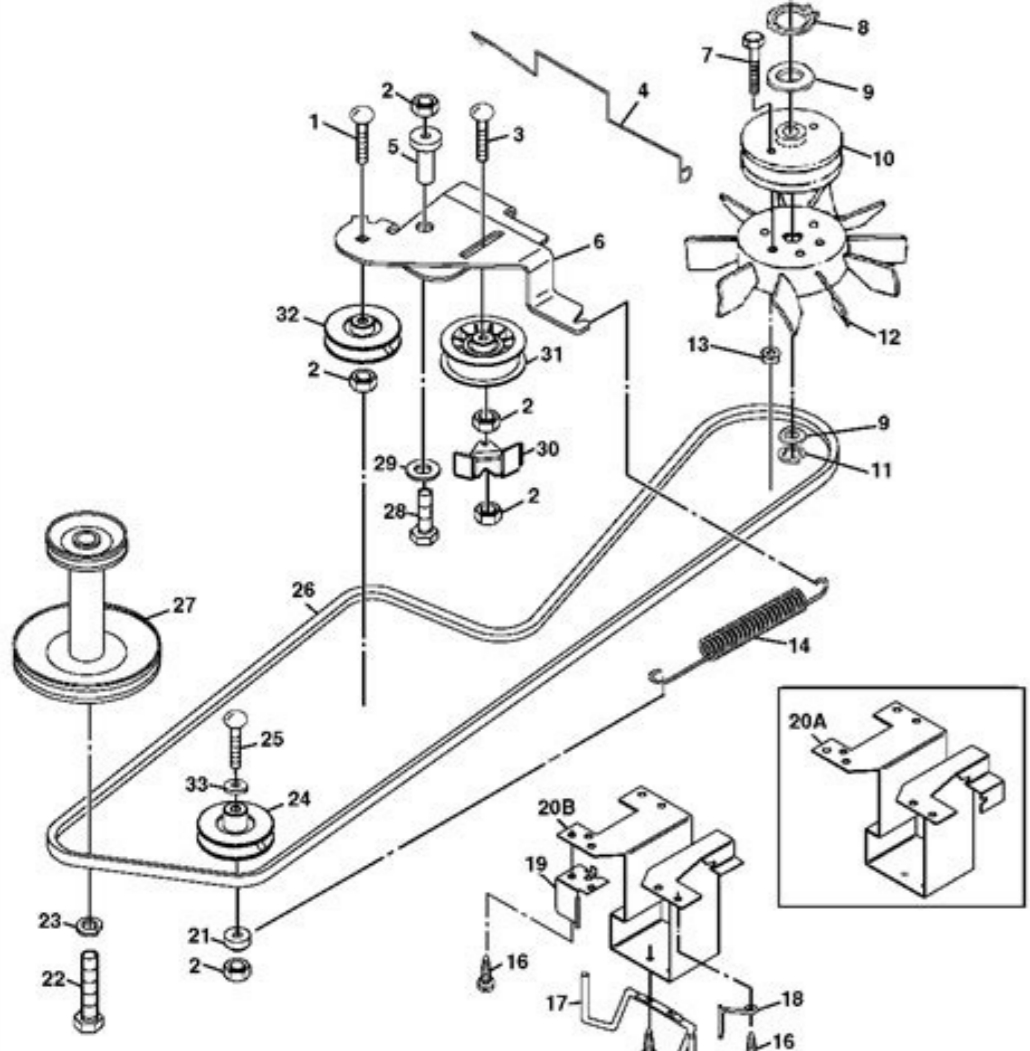

First ensure the other spring, the one that stretches between brake pedal shaft and the idler/pulley assembly, is positioned in the correct notches. It has a tendency to slip out of those notches when you pivot the idler/pulley assembly. You cannot get proper tension on the belt unless the brake spring is in those notches. You cannot apply enough force to attach the tension spring by hand. Use a trigger clamp between the "Clamping Points" shown in the photo above. This puts a fair amount of tension on the new belt. You can then use an old screw driver or pointed pry bar to leverage the spring over and slip the end on the bushing on the idler (24). Wear gloves and safety glasses as you do this. Footnotes: How to Change the Traction Belt on a John Deere LT The traction belt is the one that Start by removing the deck and raising the tractor up so you can work Make sure the new belt is routed properly, reattach the steering tie rods, and. Picture Note: Inch mower deck is used for photo purposes throughout this procedure.5. Remove Make sure belt is routed through both belt guide loops (1). The John Deere has only one belt, which is the belt that runs the drive system for Since mower deck removal is part of many different maintenance procedures, Route the belt around the pulleys just as the old belt was routed and make.How to Change the Traction Belt on a John Deere LT The traction belt is the one that Start by removing the deck and raising the tractor up so you can work Make sure the new belt is routed properly, reattach the steering tie rods, and. I did a sample search for generic riding mower deck and found great diagram of belt routing.Give it a try you will find same results Good Luck!.Find great deals on eBay for john deere mower belt lItMake Money When You Sell · Free Shipping Available · Returns Made Easy · Top BrandsTypes: Fashion, Home & Garden, Electronics, Motors, Collectibles & Arts, Toys & Hobbies.

Fortunately, the folks at John Deere have made the process of removing the inch mower deck much simpler than it might seem at first.You don't need special tools or advanced knowledge of the LT to remove the mower deck.

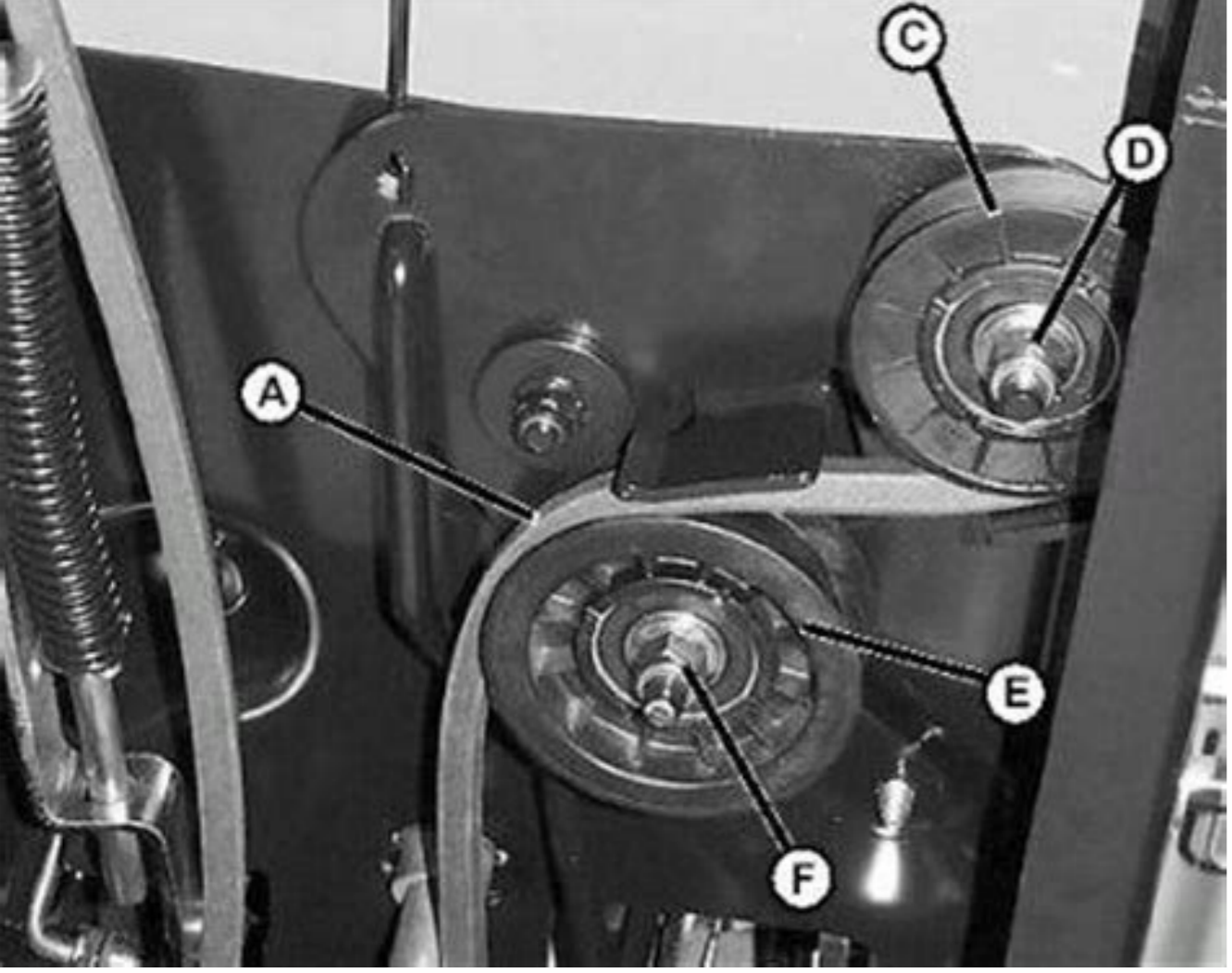

5.Remove mower belt. 6.Clean top of mower deck and sheaves. 7.Inspect belt for wear or damage; replace as necessary. 8.Install belt on mower deck as shown. 9. Tighten sheaves.Install belt shields and fasten with six cap screws. Install mower deck and adjust mower engagement rod, if necessary.Move lift lever to transport position. May 11, · Im looking for a drive belt diagram for a Deere LT - Answered by a verified Technician Im looking for a drive belt diagram for a John Deere LT Show More. Show Less.Ask Your Own Small Engine Question. I am looking for a diagram of how to put on a mower deck drive belt on a John Deere mower 5/5,John Deere LT Lawn Tractor Parts 38 Mower Deck Quick Reference Guide. Click the part number below to view and order John Deere LT Lawn Tractor Parts 38 Mower Deck, or search illustrated diagrams to determine the part you need.It belt diagram Questions & Answers (with Pictures) - FixyaDiagram for drive belt on john deere lt - Fixya