

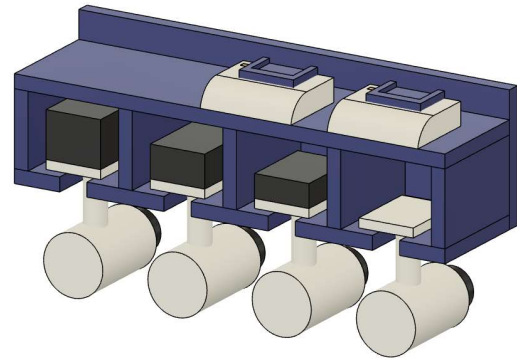

# Cordless Drill Charging Station

Build Plan – V1 – 04/2022

<https://HuntsWorkshop.com>

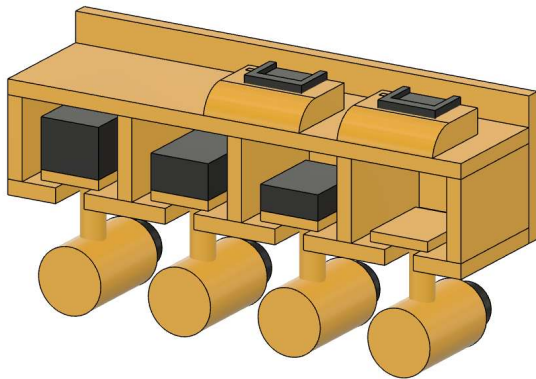
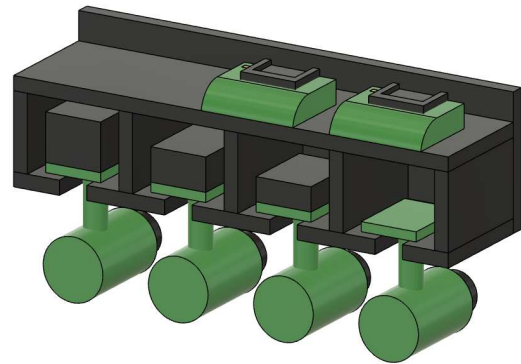
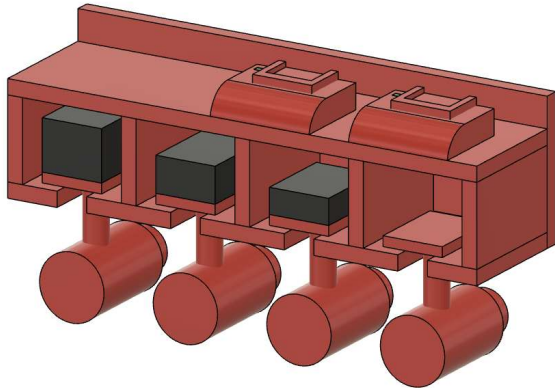

## Introduction

This Plan will produce a 23.75"x8"x6" Cordless Drill Charging Station. Not only does it hold drills with small, medium, or large batteries, but you can put chargers and spare batteries on top. Secure the chargers to the top for quick one-handed battery swaps.

**NOTE:** There is a 1.5" space between the bottom supports to account for the width of the drill handle. You can adjust the plan and cut list if needed.

## Videos

Build Video is available on YouTube. <https://YouTube.com/c/HuntsWorkshop>

## Tools

- Table Saw (Substitutes: Track Saw, Miter Saw, Circular Saw, Jigsaw)
- Drill/Driver
- Drill Bit
- Counter Sink Bit
- Brad/Pin Nailer



## Materials

- 24"x48"x3/4" Plywood (Substitute: 1x8, 1x10, etc. scraps) | Qty: 1
- Water Based Enamel Paint (Enamel will be impact and Water Resistant)

## Cut List

Part Name	Quantity	Width in	Length in	Height in
Vertical Support	5	4	6	0.75
Bottom Centers	3	4.25	6	0.75
Bottom Ends	2	2.5	6	0.75
Back	1	23.75	8	0.75
Top	1	23.75	6	0.75

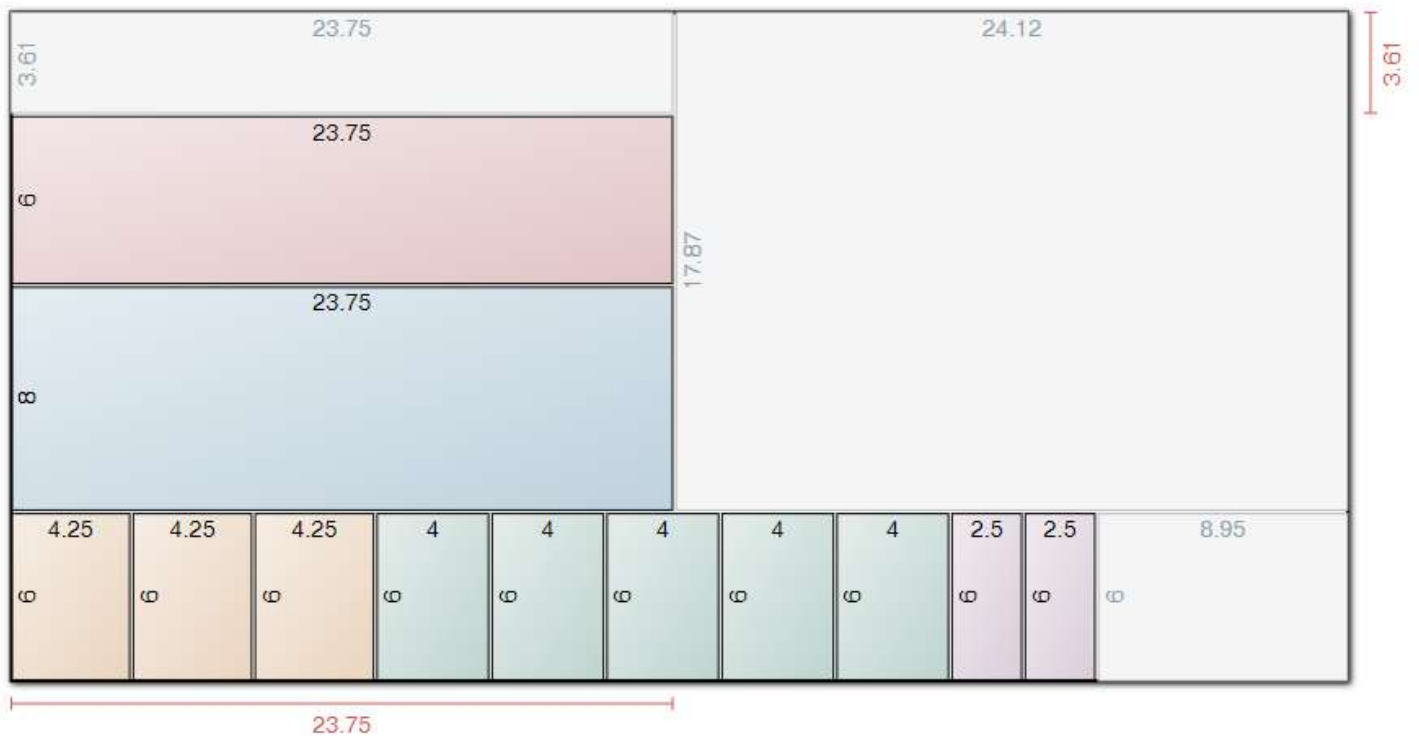

## Instructions

1. Attach 1 of the 5 vertical supports (4"H x 6"D) to 1 of the 3 bottom center supports (4.25"W x 6"D).
2. Repeat step 1 until you have 3 matching pieces.

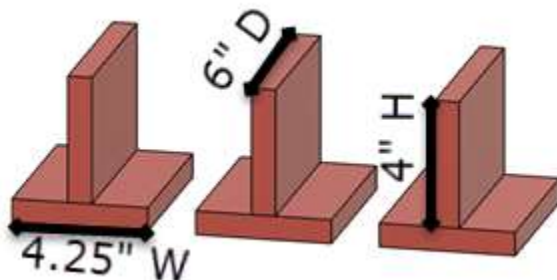

- Attach 1 of the 5 vertical supports (4" x 6") to 1 of the bottom end supports (2.5" x 6")

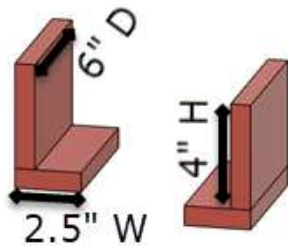

- Align supports to the back with 1.5" spacing between the bottom sections.
- Attach supports to the back using glue and brad nails as shown below.
- Drill and Countersink 2 holes through back into each vertical support.
- Install 2 screws through back into each vertical support.

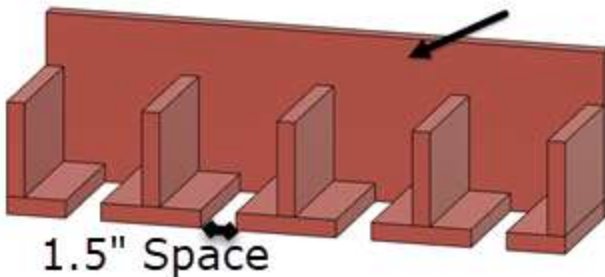

- Attach top plate with glue and brad nails.
- Drill and Countersink 2 holes through top into each vertical support.
- Install 2 screws through top into each vertical support.

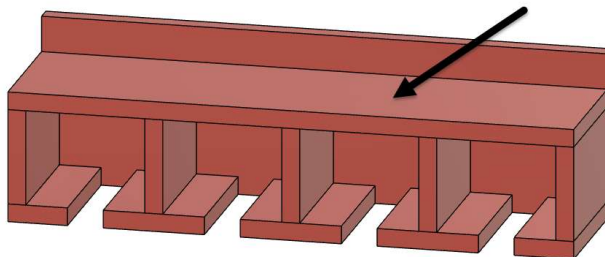

- Drill and Countersink 4 holes through back into top shelf.
- Install 4 screws through back into top shelf.
- Optional: Install mounting screws on the top shelf to hold chargers.  
(Note: In the case of Milwaukee M18 Chargers slide a shim behind the charger so it can't slide backwards)  
(Note: This makes single handed battery changes super easy)

