

RECON BLOCK LEGEND

BLOCK DESCRIPTION	BLOCK ABBREVIATION
24" BASE	24B
39" BASE	39B
45" BASE	45B
60" BASE	60B
66" BASE	66B
72" BASE	72B
78" BASE	78B
84" BASE	84B
24" MIDDLE	24M
39" MIDDLE	39M
45" MIDDLE	45M
60" MIDDLE	60M
66" MIDDLE	66M
72" MIDDLE	72M
78" MIDDLE	78M
84" MIDDLE	84M
24" TOP	24T
39" TOP	39T
24" HALF	24H
39" HALF	39H
HALF TOP - 24"	HT
LEFT CORNER TOP	LCT
RIGHT CORNER TOP	RCT
SLOPED LEFT CORNER TOP	SLCT
SLOPED RIGHT CORNER TOP	SRCT
REVERSIBLE CORNER	C
FITTING - 24"	FIT24
FITTING - 39"	FIT39

© Copyright 2021 Recon Wall Systems, Inc. All Rights Reserved

Disclaimer: This drawing has been prepared by Recon Wall Systems, Inc. and to the best of its knowledge, accurately represents the product use in the application that it is illustrated. This drawing is intended for conceptual purposes only. Anyone making use of this drawing does so at their own risk and assumes all liability for such use. Final design for construction purposes must be completed by a Registered Professional Engineer who is familiar with the product and who has taken into account specific site conditions.



RECON BLOCK TYPES

RECON WALL SYSTEMS, INC.
11521 EAGLE STREET, SUITE #3
COON RAPIDS, MN 55448
952-922-0027
www.reconwalls.com

DRAWING
#101

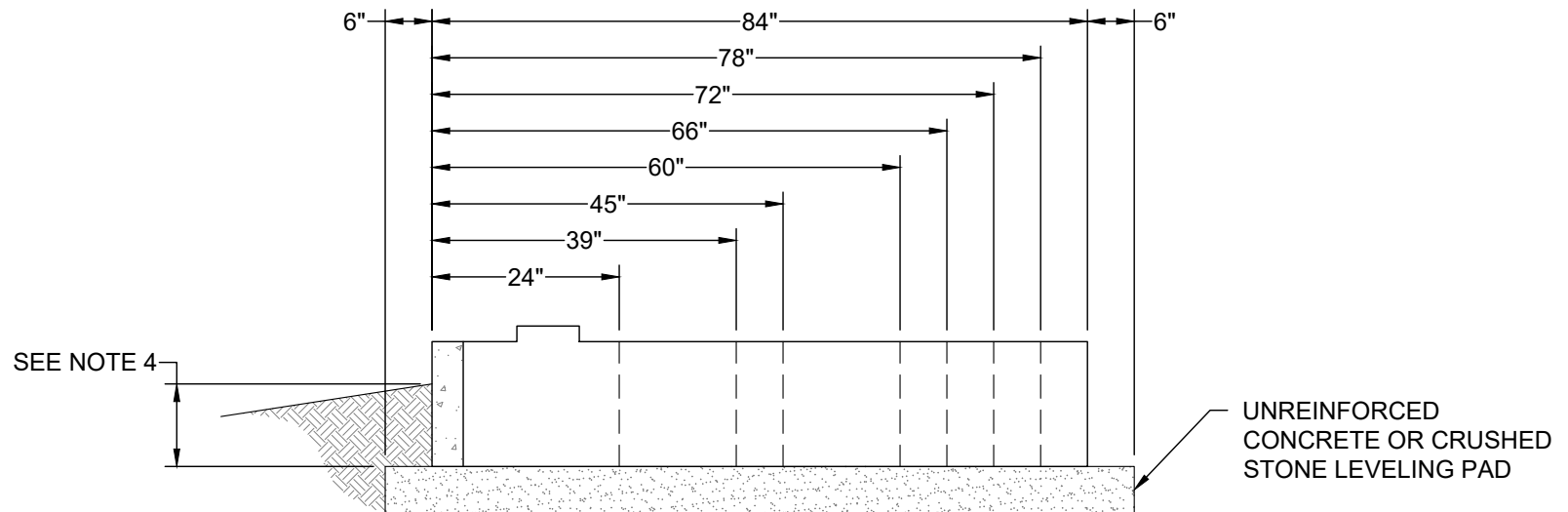

NOTES:

1. LEVELING PAD SHOULD BE AS SPECIFIED BY THE DESIGN ENGINEER IN THE PROJECT PLAN SET.
2. THE WIDTH OF THE LEVELING PAD MUST EXTEND 6" (MINIMUM) IN FRONT AND 6" (MINIMUM) IN BACK OF THE BASE BLOCK. AS A RESULT THE TYPICAL WIDTH OF LEVELING PAD WOULD BE:
 - 24" DEEP BASE BLOCK...LEVELING PAD WIDTH IS 36"
 - 39" DEEP BASE BLOCK...LEVELING PAD WIDTH IS 51"
 - 45" DEEP BASE BLOCK...LEVELING PAD WIDTH IS 57"
 - 60" DEEP BASE BLOCK...LEVELING PAD WIDTH IS 72"
 - 66" DEEP BASE BLOCK...LEVELING PAD WIDTH IS 78"
 - 72" DEEP BASE BLOCK...LEVELING PAD WIDTH IS 84"
 - 78" DEEP BASE BLOCK...LEVELING PAD WIDTH IS 90"
 - 84" DEEP BASE BLOCK...LEVELING PAD WIDTH IS 96"
3. SET THE BASE BLOCK AND CHECK FOR LEVEL FROM FRONT TO BACK.
4. EMBEDMENT SHOULD BE THE GREATER OF 6" OR H/20 FOR WALLS WITH LEVEL GRADE AT THE TOE. REFER TO RECON'S EMBEDMENT RECOMMENDATION DOCUMENT FOR ADDITIONAL INFORMATION FOR WALLS WITH A TOE SLOPE CONDITION.
5. COMPACTION TO THE SPECIFIED EMBEDMENT DEPTH SHALL BE DONE IN FRONT OF THE BASE BLOCK **BEFORE** COMPACTION IS DONE BEHIND THE BASE BLOCK. THIS REDUCES THE CHANCE THAT COMPACTION BEHIND THE BASE BLOCK WILL ROLL THE BASE BLOCK FORWARD.
6. SEE BLOCK SPECIFICATION & INSTALLATION INSTRUCTIONS FOR MORE DETAILS.

© Copyright 2021 Recon Wall Systems, Inc. All Rights Reserved

Disclaimer: This drawing has been prepared by Recon Wall Systems, Inc. and to the best of its knowledge, accurately represents the product use in the application that it is illustrated. This drawing is intended for conceptual purposes only. Anyone making use of this drawing does so at their own risk and assumes all liability for such use. Final design for construction purposes must be completed by a Registered Professional Engineer who is familiar with the product and who has taken into account specific site conditions.



BASE BLOCK PLACEMENT

RECON WALL SYSTEMS, INC.
11521 EAGLE STREET, SUITE #3
COON RAPIDS, MN 55448
952-922-0027
www.reconwalls.com

DRAWING
#102

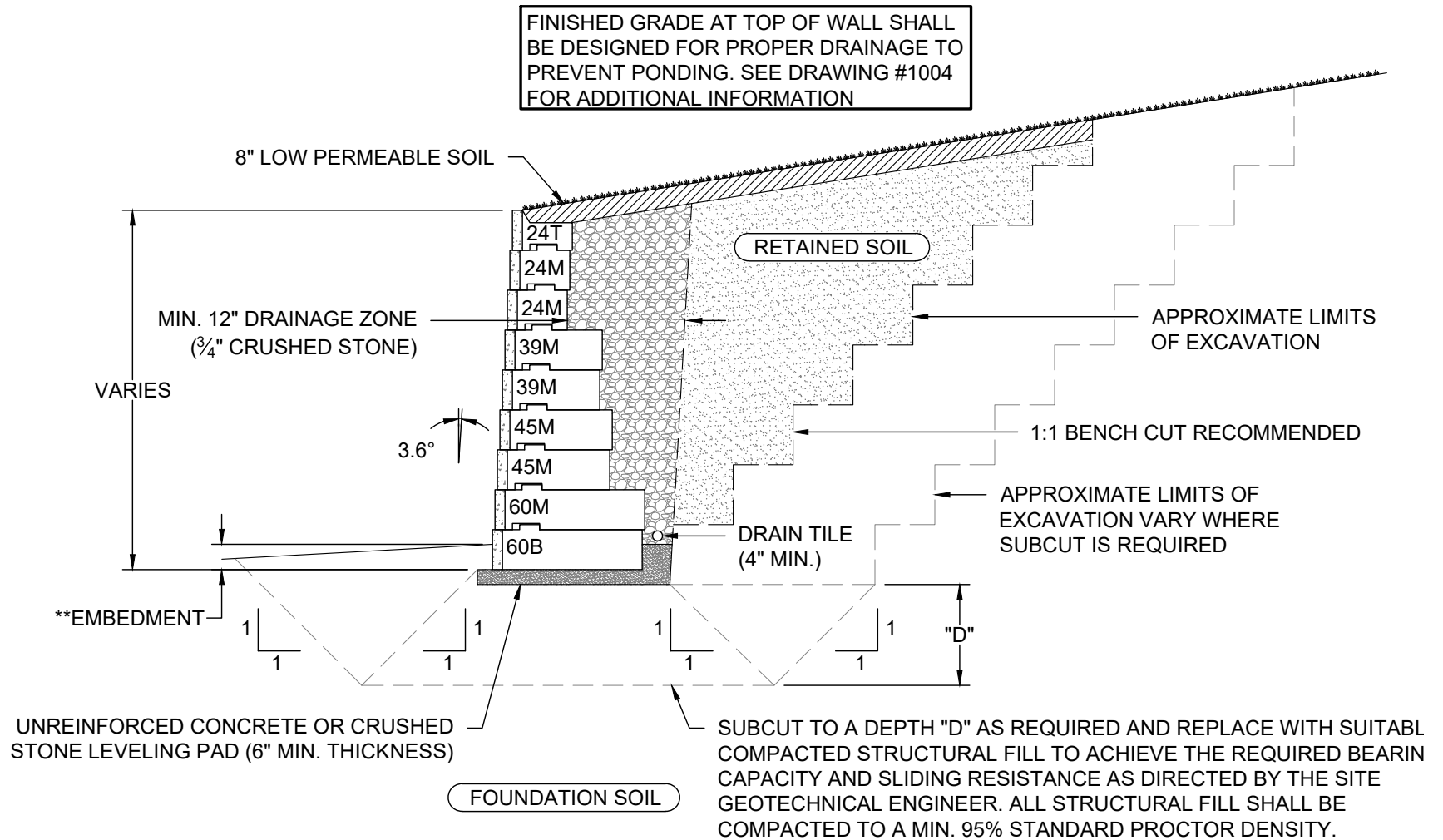

**EMBEDMENT SHOULD BE THE GREATER OF 6" OR H/20 FOR WALLS WITH LEVEL GRADE AT THE TOE. REFER TO RECON'S EMBEDMENT RECOMMENDATION DOCUMENT FOR ADDITIONAL INFORMATION FOR WALLS WITH A TOE SLOPE CONDITION.

© Copyright 2021 Recon Wall Systems, Inc. All Rights Reserved

Disclaimer: This drawing has been prepared by Recon Wall Systems, Inc. and to the best of its knowledge, accurately represents the product use in the application that it is illustrated. This drawing is intended for conceptual purposes only. Anyone making use of this drawing does so at their own risk and assumes all liability for such use. Final design for construction purposes must be completed by a Registered Professional Engineer who is familiar with the product and who has taken into account specific site conditions.



TYPICAL GRAVITY WALL CROSS SECTION

RECON WALL SYSTEMS, INC.
11521 EAGLE STREET, SUITE #3
COON RAPIDS, MN 55448
952-922-0027
www.reconwalls.com

DRAWING
#103

NOTE: BLOCK MUST BE PLACED ON A MINIMUM 6" THICK LEVELING PAD CONSISTING OF $\frac{3}{4}$ " CRUSHED STONE, CLASS 5, OR LEAN CONCRETE AS SPECIFIED IN THE SITE SPECIFIC PLANS DESIGNED BY A REGISTERED PROFESSIONAL ENGINEER. GENERALLY THE LEVELING PAD BASE MATERIAL MUST BE COMPACTED TO 95% OF STANDARD PROCTOR DENSITY.

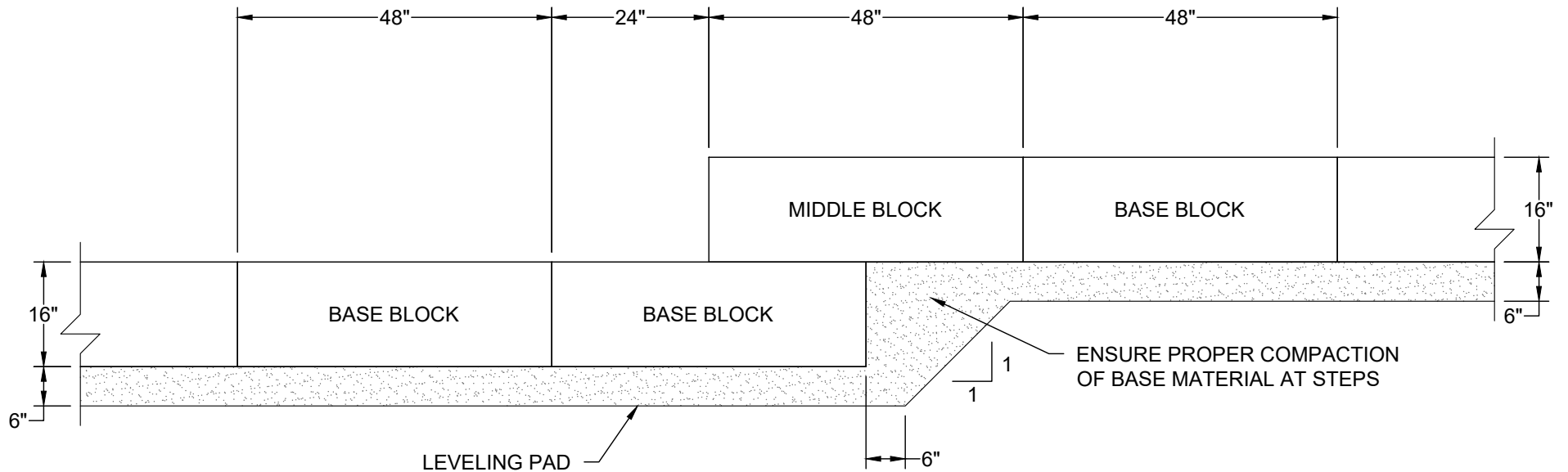

© Copyright 2021 Recon Wall Systems, Inc. All Rights Reserved

Disclaimer: This drawing has been prepared by Recon Wall Systems, Inc. and to the best of its knowledge, accurately represents the product use in the application that it is illustrated. This drawing is intended for conceptual purposes only. Anyone making use of this drawing does so at their own risk and assumes all liability for such use. Final design for construction purposes must be completed by a Registered Professional Engineer who is familiar with the product and who has taken into account specific site conditions.



BASE ROW STEP UP

RECON WALL SYSTEMS, INC.
11521 EAGLE STREET, SUITE #3
COON RAPIDS, MN 55448
952-922-0027
www.reconwalls.com

DRAWING
#104

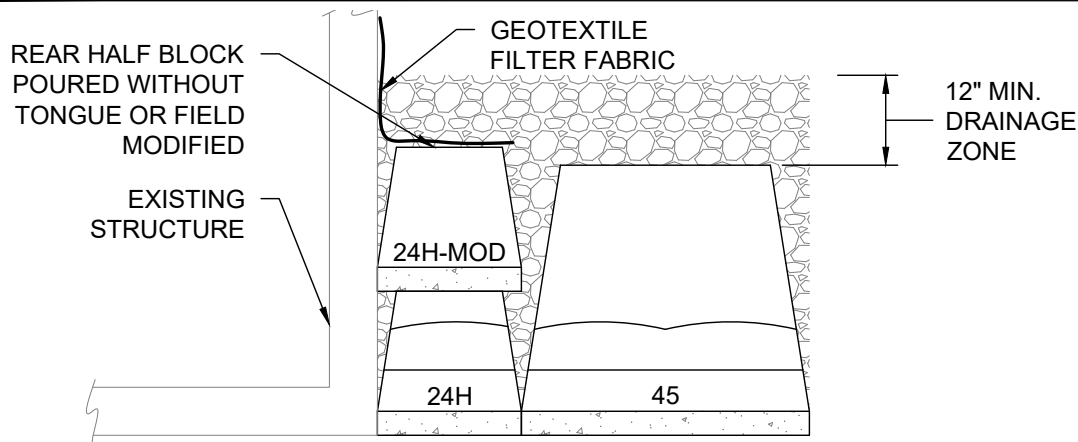

DOUBLE STACKED HALF BLOCKS - 45" DEEP BLOCKS
PLAN VIEW

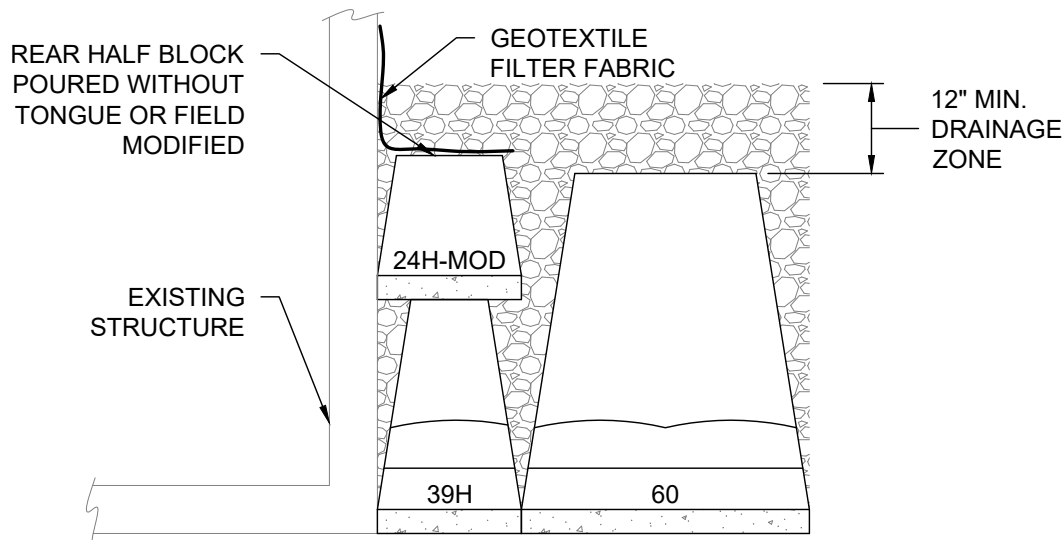

DOUBLE STACKED HALF BLOCKS - 60" DEEP BLOCKS
PLAN VIEW

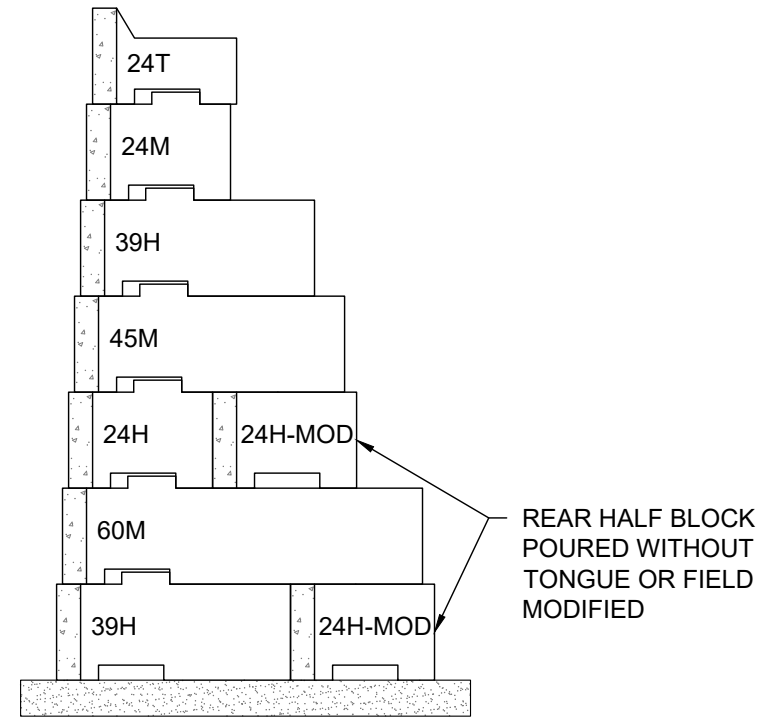

DOUBLE STACKED HALF BLOCKS - FB60
SECTION VIEW

NOTE: WHEN DOUBLE STACKING HALF BLOCKS, THE HALF BLOCK SHALL BE CAST WITH THE LIFTING LOOP RECESSED FULLY INTO THE TOP OF THE BLOCK OR REMOVED IN THE FIELD AS REQUIRED. THE REAR BLOCK SHALL BE CAST WITHOUT A TONGUE IF THE TONGUE WILL PREVENT THE BLOCK ABOVE FROM RESTING ON A LEVEL SURFACE.

© Copyright 2021 Recon Wall Systems, Inc. All Rights Reserved

Disclaimer: This drawing has been prepared by Recon Wall Systems, Inc. and to the best of its knowledge, accurately represents the product use in the application that it is illustrated. This drawing is intended for conceptual purposes only. Anyone making use of this drawing does so at their own risk and assumes all liability for such use. Final design for construction purposes must be completed by a Registered Professional Engineer who is familiar with the product and who has taken into account specific site conditions.



DOUBLE STACKED HALF BLOCKS UP TO 60"

RECON WALL SYSTEMS, INC.
11521 EAGLE STREET, SUITE #3
COON RAPIDS, MN 55448
952-922-0027
www.reconwalls.com

DRAWING
#105

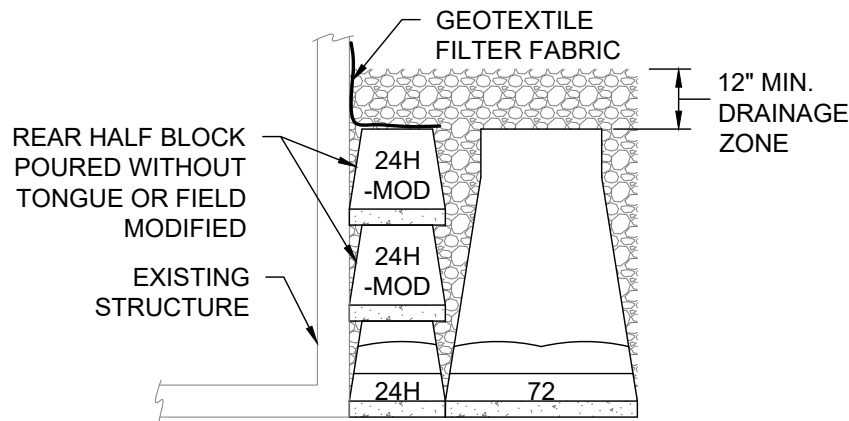

DOUBLE STACKED HALF BLOCKS - 72" DEEP BLOCKS
PLAN VIEW

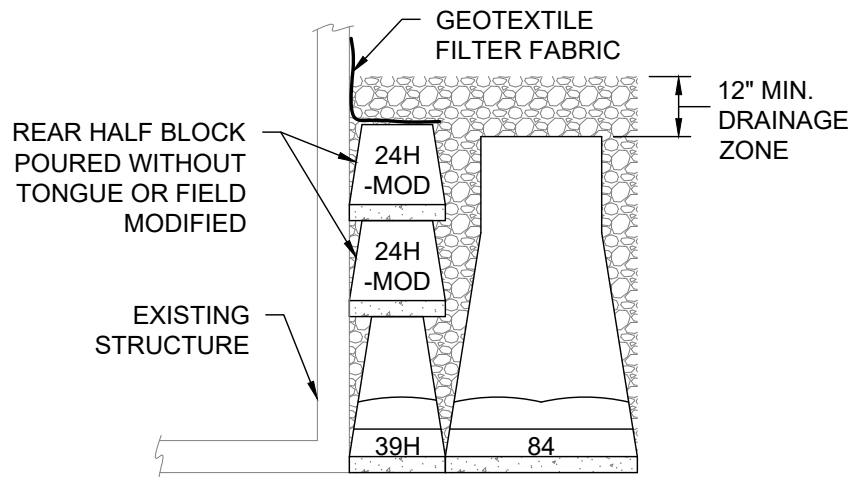

DOUBLE STACKED HALF BLOCKS - 84" DEEP BLOCKS
PLAN VIEW

NOTE: WHEN DOUBLE STACKING HALF BLOCKS, THE HALF BLOCK SHALL BE CAST WITH THE LIFTING LOOP RECESSED FULLY INTO THE TOP OF THE BLOCK OR REMOVED IN THE FIELD AS REQUIRED. THE REAR BLOCK SHALL BE CAST WITHOUT A TONGUE IF THE TONGUE WILL PREVENT THE BLOCK ABOVE FROM RESTING ON A LEVEL SURFACE.

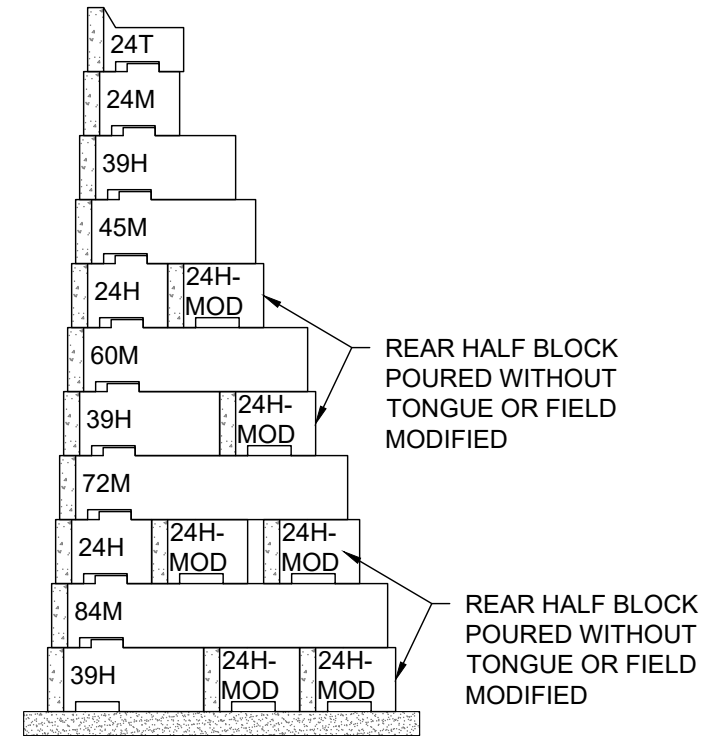

DOUBLE STACKED HALF BLOCKS - FB84
SECTION VIEW

© Copyright 2021 Recon Wall Systems, Inc. All Rights Reserved

Disclaimer: This drawing has been prepared by Recon Wall Systems, Inc. and to the best of its knowledge, accurately represents the product use in the application that it is illustrated. This drawing is intended for conceptual purposes only. Anyone making use of this drawing does so at their own risk and assumes all liability for such use. Final design for construction purposes must be completed by a Registered Professional Engineer who is familiar with the product and who has taken into account specific site conditions.



DOUBLE STACKED HALF BLOCKS UP 72" TO 84"

RECON WALL SYSTEMS, INC.
11521 EAGLE STREET, SUITE #3
COON RAPIDS, MN 55448
952-922-0027
www.reconwalls.com

DRAWING
#106

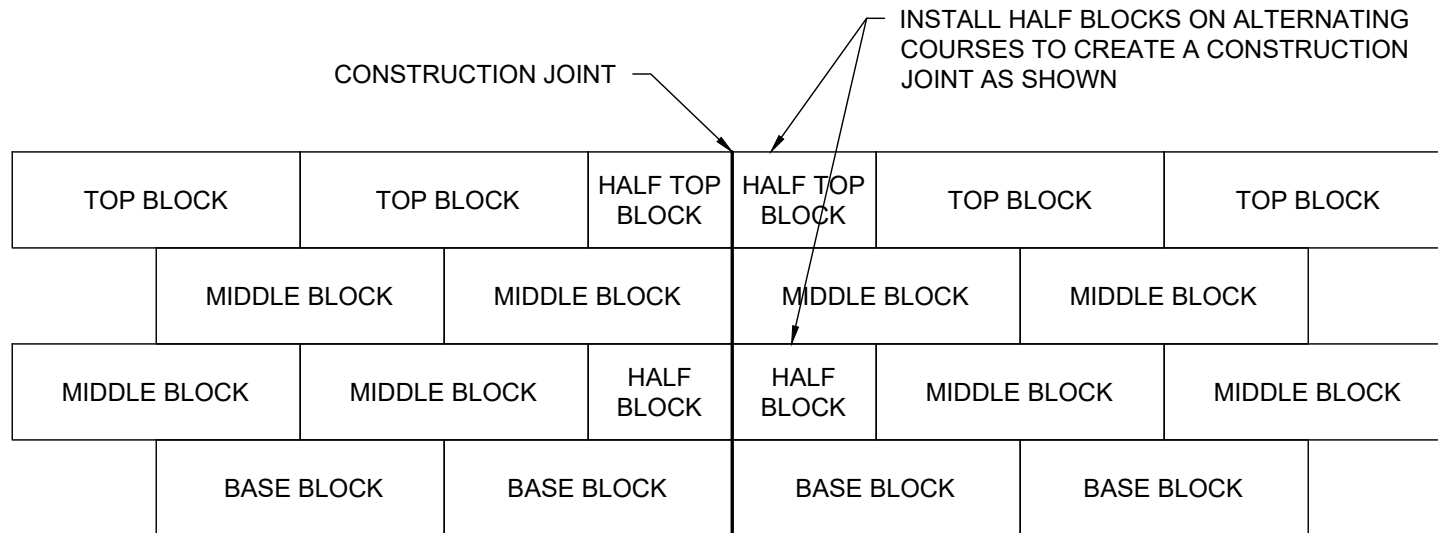

**CONSTRUCTION JOINT DETAIL
PROFILE VIEW**

© Copyright 2021 Recon Wall Systems, Inc. All Rights Reserved

Disclaimer: This drawing has been prepared by Recon Wall Systems, Inc. and to the best of its knowledge, accurately represents the product use in the application that it is illustrated. This drawing is intended for conceptual purposes only. Anyone making use of this drawing does so at their own risk and assumes all liability for such use. Final design for construction purposes must be completed by a Registered Professional Engineer who is familiar with the product and who has taken into account specific site conditions.



CONSTRUCTION JOINT DETAIL

RECON WALL SYSTEMS, INC.
11521 EAGLE STREET, SUITE #3
COON RAPIDS, MN 55448
952-922-0027
www.reconwalls.com

DRAWING
#107

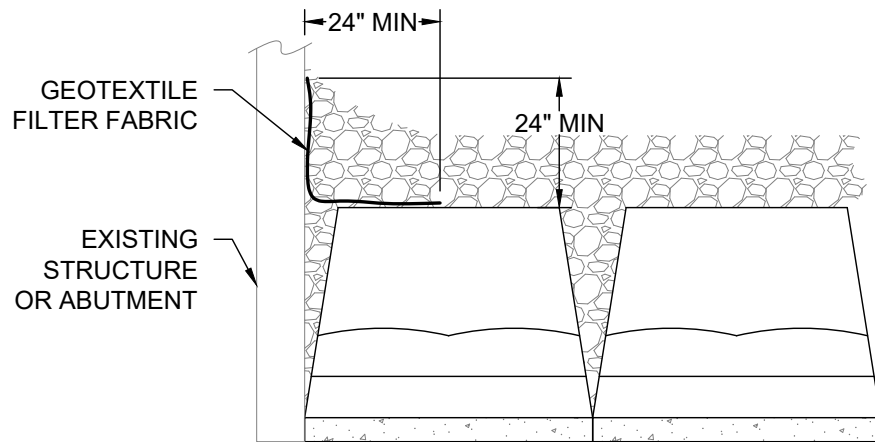

**PERPENDICULAR ABUTMENT
PLAN VIEW**

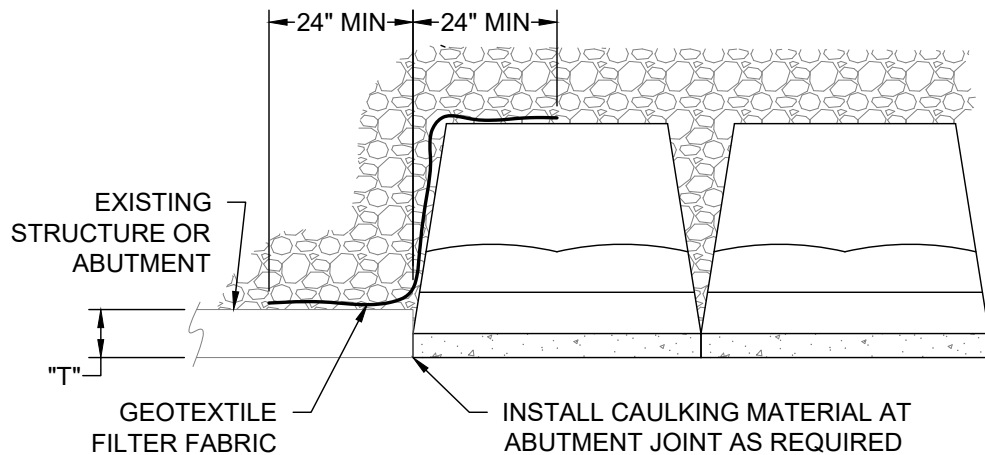

**PARALLEL ABUTMENT
PLAN VIEW**

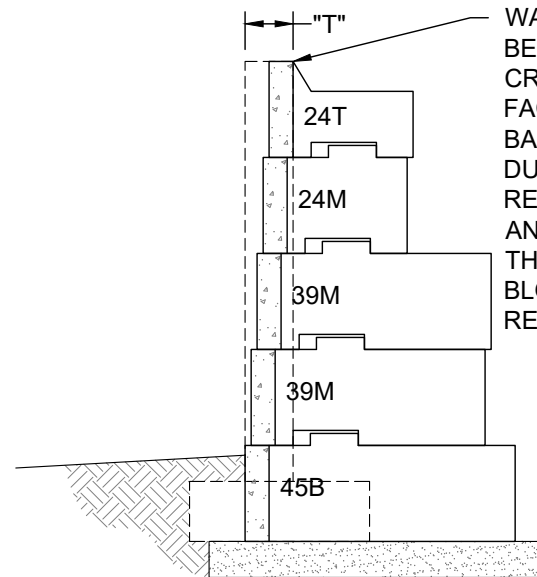

**PARALLEL ABUTMENT
SECTION VIEW**

WALL THICKNESS "T" SHOULD BE SUCH THAT A GAP IS NOT CREATED BETWEEN THE FACE OF THE BLOCK AND THE BACK OF THE VERTICAL WALL DUE TO THE BATTER OF THE RECON WALL. IF GAPPING IS ANTICIPATED INCREASE WALL THICKNESS "T" OR MOVE BLOCK WALL FORWARD AS REQUIRED.

© Copyright 2021 Recon Wall Systems, Inc. All Rights Reserved

Disclaimer: This drawing has been prepared by Recon Wall Systems, Inc. and to the best of its knowledge, accurately represents the product use in the application that it is illustrated. This drawing is intended for conceptual purposes only. Anyone making use of this drawing does so at their own risk and assumes all liability for such use. Final design for construction purposes must be completed by a Registered Professional Engineer who is familiar with the product and who has taken into account specific site conditions.



WALL ABUTTING TO EXISTING STRUCTURE

RECON WALL SYSTEMS, INC.
11521 EAGLE STREET, SUITE #3
COON RAPIDS, MN 55448
952-922-0027
www.reconwalls.com

**DRAWING
#108**

RECON 8" SETBACK BLOCK LEGEND	
BLOCK DESCRIPTION	BLOCK ABBREVIATION
39" SETBACK BASE	39SB
45" SETBACK BASE	45SB
60" SETBACK BASE	60SB
66" SETBACK BASE	66SB
72" SETBACK BASE	72SB
78" SETBACK BASE	78SB
84" SETBACK BASE	84SB
39" SETBACK MIDDLE	39SM
45" SETBACK MIDDLE	45SM
60" SETBACK MIDDLE	60SM
66" SETBACK MIDDLE	66SM
72" SETBACK MIDDLE	72SM
78" SETBACK MIDDLE	78SM
84" SETBACK MIDDLE	84SM

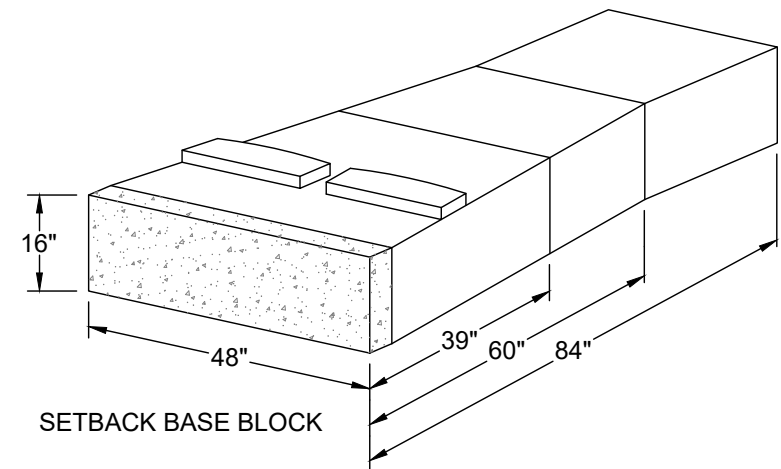
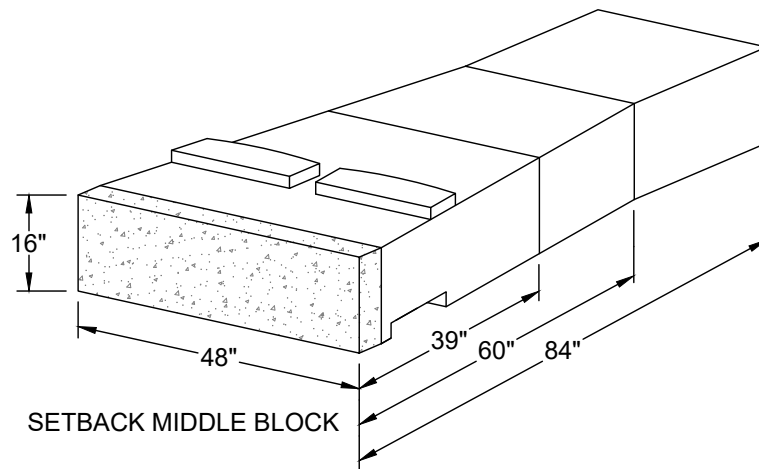

© Copyright 2021 Recon Wall Systems, Inc. All Rights Reserved

Disclaimer: This drawing has been prepared by Recon Wall Systems, Inc. and to the best of its knowledge, accurately represents the product use in the application that it is illustrated. This drawing is intended for conceptual purposes only. Anyone making use of this drawing does so at their own risk and assumes all liability for such use. Final design for construction purposes must be completed by a Registered Professional Engineer who is familiar with the product and who has taken into account specific site conditions.



SETBACK BLOCK TYPES

RECON WALL SYSTEMS, INC.
11521 EAGLE STREET, SUITE #3
COON RAPIDS, MN 55448
952-922-0027
www.reconwalls.com

DRAWING
#109

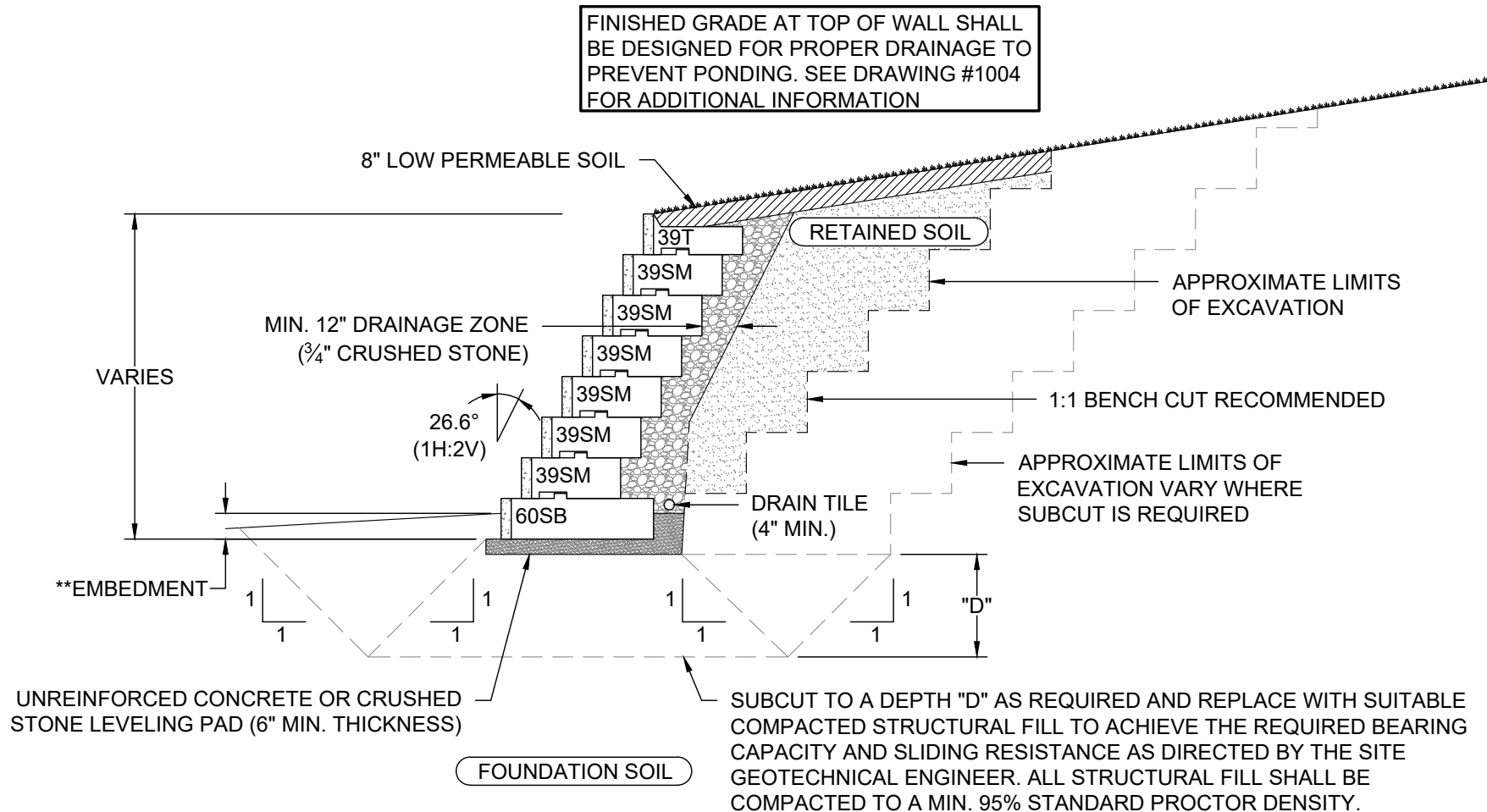

**EMBEDMENT SHOULD BE THE GREATER OF 6" OR H/20 FOR WALLS WITH LEVEL GRADE AT THE TOE. REFER TO RECON'S EMBEDMENT RECOMMENDATION DOCUMENT FOR ADDITIONAL INFORMATION FOR WALLS WITH A TOE SLOPE CONDITION.

© Copyright 2021 Recon Wall Systems, Inc. All Rights Reserved

Disclaimer: This drawing has been prepared by Recon Wall Systems, Inc. and to the best of its knowledge, accurately represents the product use in the application that it is illustrated. This drawing is intended for conceptual purposes only. Anyone making use of this drawing does so at their own risk and assumes all liability for such use. Final design for construction purposes must be completed by a Registered Professional Engineer who is familiar with the product and who has taken into account specific site conditions.



TYPICAL SETBACK (26.6°) BLOCK GRAVITY SECTION

RECON WALL SYSTEMS, INC.
11521 EAGLE STREET, SUITE #3
COON RAPIDS, MN 55448
952-922-0027
www.reconwalls.com

DRAWING
#110

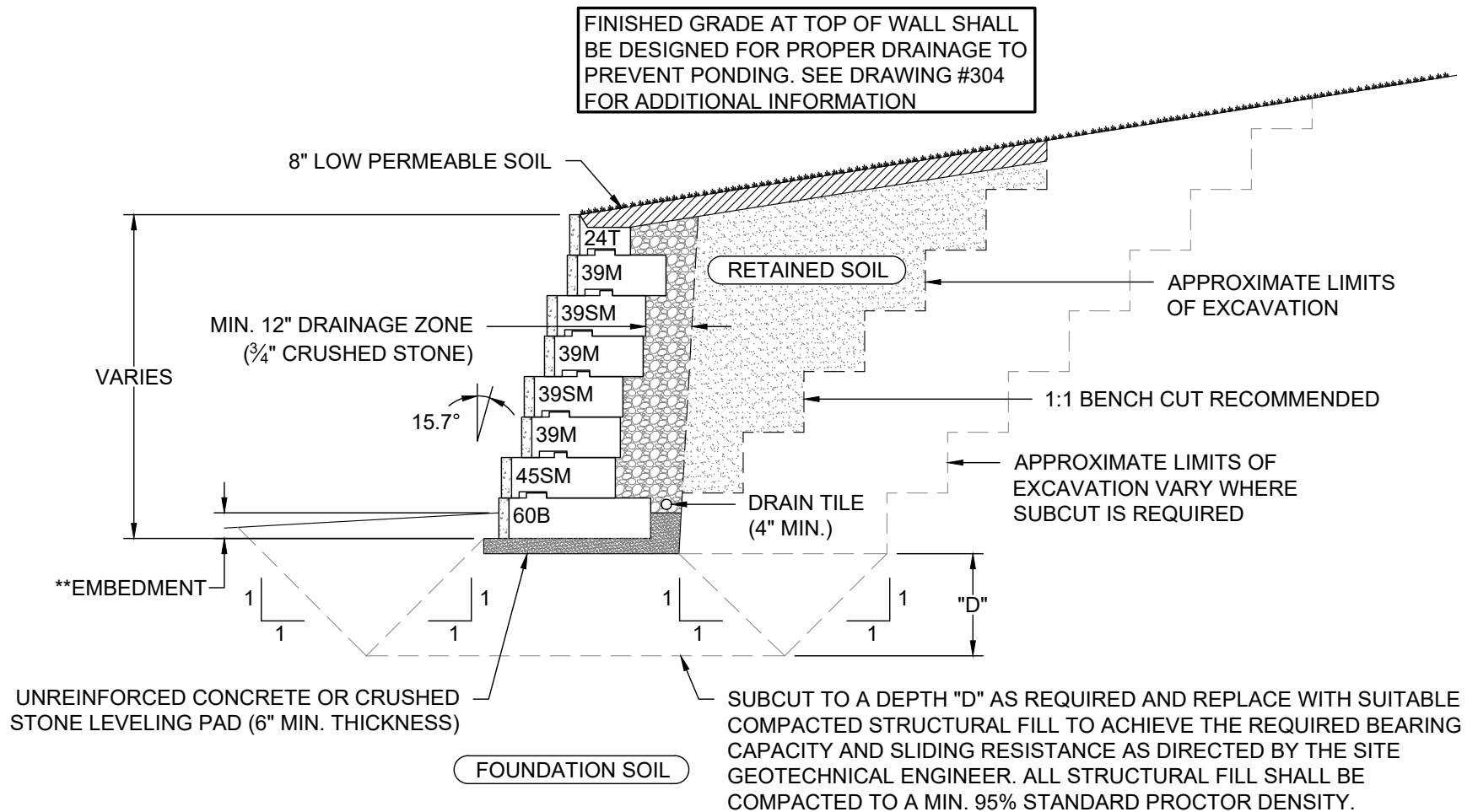

**EMBEDMENT SHOULD BE THE GREATER OF 6" OR H/20 FOR WALLS WITH LEVEL GRADE AT THE TOE. REFER TO RECON'S EMBEDMENT RECOMMENDATION DOCUMENT FOR ADDITIONAL INFORMATION FOR WALLS WITH A TOE SLOPE CONDITION.

© Copyright 2021 Recon Wall Systems, Inc. All Rights Reserved

Disclaimer: This drawing has been prepared by Recon Wall Systems, Inc. and to the best of its knowledge, accurately represents the product use in the application that it is illustrated. This drawing is intended for conceptual purposes only. Anyone making use of this drawing does so at their own risk and assumes all liability for such use. Final design for construction purposes must be completed by a Registered Professional Engineer who is familiar with the product and who has taken into account specific site conditions.



VARIED SETBACK (15.7°) BLOCK GRAVITY SECTION

RECON WALL SYSTEMS, INC.
11521 EAGLE STREET, SUITE #3
COON RAPIDS, MN 55448
952-922-0027
www.reconwalls.com

DRAWING
#111

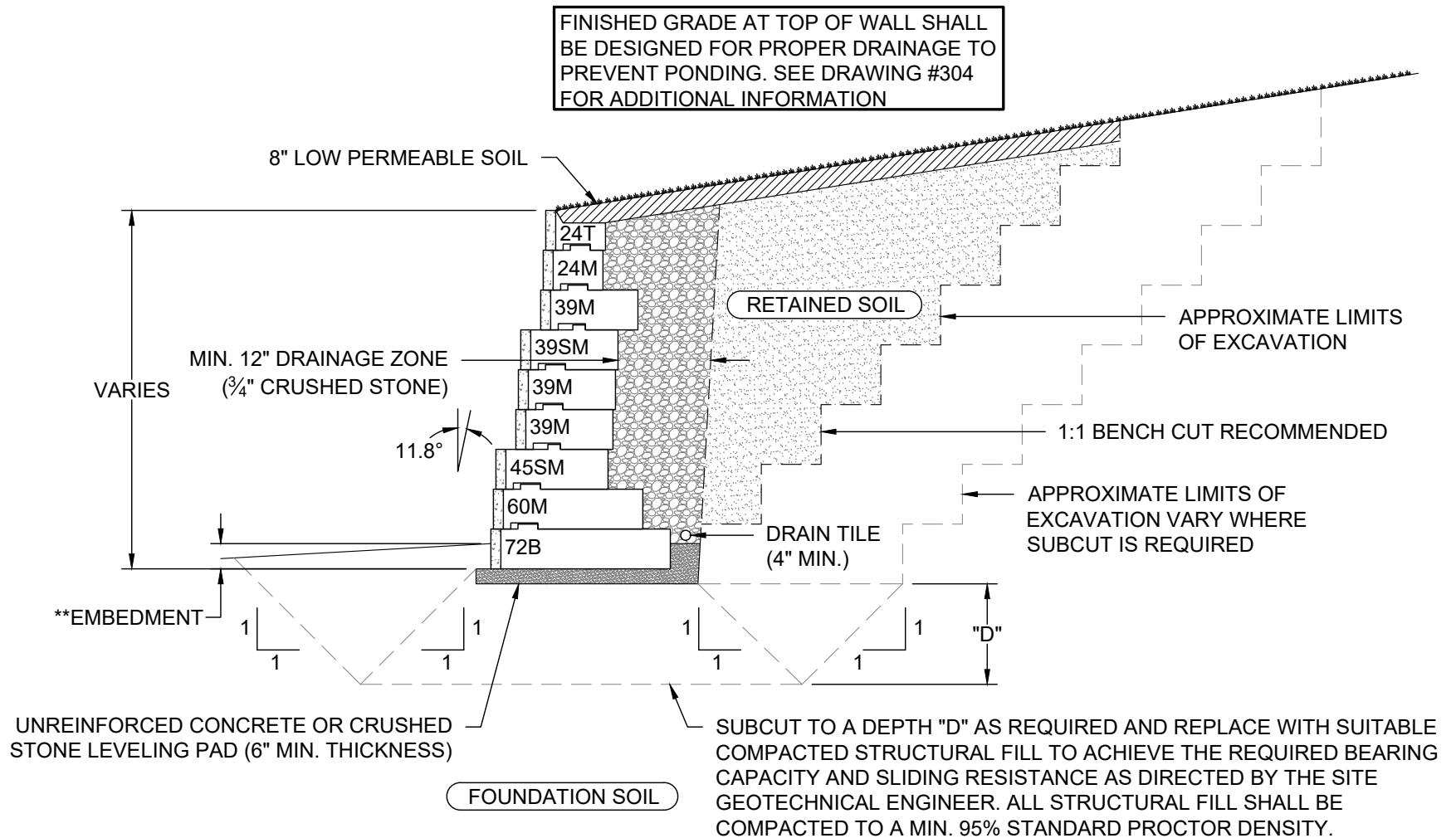

**EMBEDMENT SHOULD BE THE GREATER OF 6" OR H/20 FOR WALLS WITH LEVEL GRADE AT THE TOE. REFER TO RECON'S EMBEDMENT RECOMMENDATION DOCUMENT FOR ADDITIONAL INFORMATION FOR WALLS WITH A TOE SLOPE CONDITION.

© Copyright 2021 Recon Wall Systems, Inc. All Rights Reserved

Disclaimer: This drawing has been prepared by Recon Wall Systems, Inc. and to the best of its knowledge, accurately represents the product use in the application that it is illustrated. This drawing is intended for conceptual purposes only. Anyone making use of this drawing does so at their own risk and assumes all liability for such use. Final design for construction purposes must be completed by a Registered Professional Engineer who is familiar with the product and who has taken into account specific site conditions.



VARIED SETBACK (11.8°) BLOCK GRAVITY SECTION

RECON WALL SYSTEMS, INC.
11521 EAGLE STREET, SUITE #3
COON RAPIDS, MN 55448
952-922-0027
www.reconwalls.com

DRAWING
#112