

BX 2415B

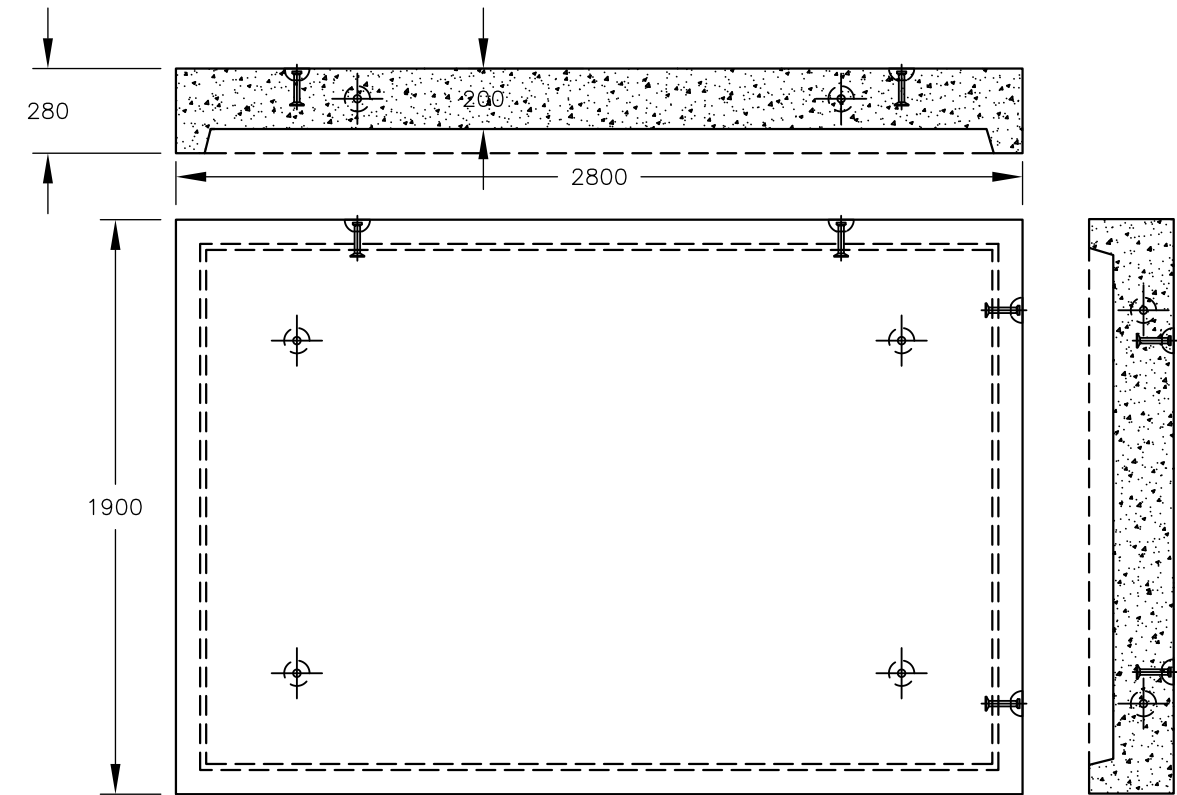

BX 2415L

2415 BOX CULVERT BASE WEIGHT: 2,400 KG. (5,300 LBS.)  
 2415 BOX CULVERT LID WEIGHT: 2,700 KG. (6,000 LBS.)

**GENERAL NOTES**

Precast concrete shall be exposure Class HSe and meet min compressive strength of 35MPa @28d

Air Category: 4.0% - 7.0%

Aggregate: CSA/CAN A23.4  
 Maximum Size: 20mm

Admixtures: CSA/CAN A23.4

Reinforcing: Grade 400W CSA G30.18

Inserts/Embeds: As noted in drawing details

Manufacture of precast concrete units shall be in accordance with specification CSA A23.4, ASTM C1422M

Meets BCL625 Loading

**\*\* LEKO PRECAST LTD SHALL NOT BE RESPONSIBLE FOR ANY INSTALLATION PRACTICES FOLLOWED ON-SITE UNLESS PERFORMED BY LEKO PRECAST LTD \*\***

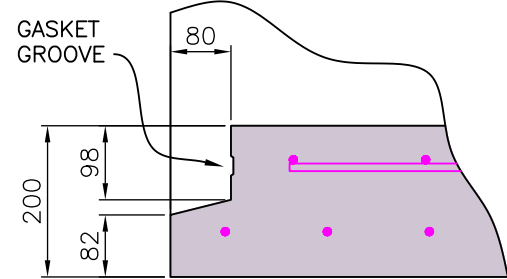

DETAIL SCALE; 1:10 (B)

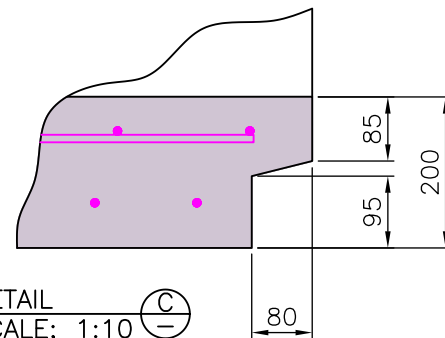

DETAIL SCALE; 1:10 (C)

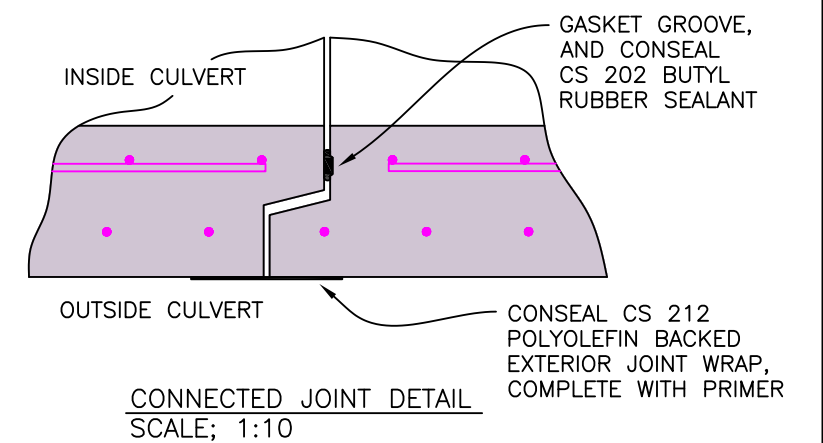

<b>Leko PRECAST LTD.</b>				<b>BOX CULVERT LIDS; 2.8m x 1.9m, 0.2m THK</b>	
DRAWN BY: J.A	CHECKED BY:	APPROVED BY:	DATE: June 2019		
ASSEMBLY DWG.	PREVIOUS DWG.	DRAWING NO.	REVISION		
SCALE: 1:25		ISOMETRIC: 1:50		BX 2415 L/B 0	
DO NOT SCALE THIS DRAWING					