

BX 2424B

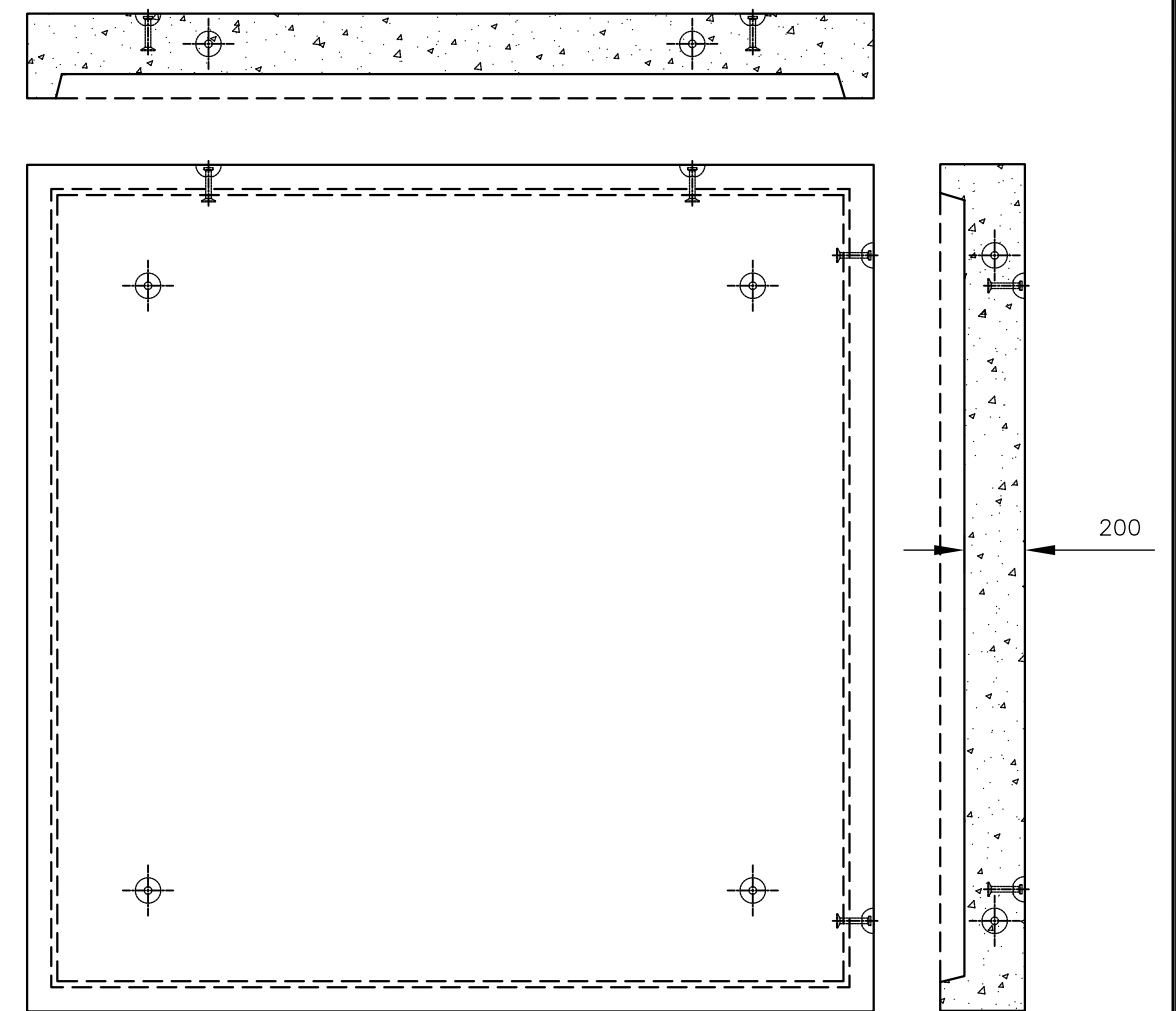

BX 2424L

2424 BOX CULVERT BASE WEIGHT: 3,575 KG. (7,900 LBS.)

2424 BOX CULVERT LID WEIGHT: 3,950 KG. (8,700 LBS.)

GENERAL NOTES

Precast concrete shall be exposure Class HSe and meet min compressive strength of 35MPa @28d

Air Category: 4.0% - 7.0%
 Aggregate: CSA/CAN A23.4
 Maximum Size: 20mm
 Admixtures: CSA/CAN A23.4
 Reinforcing: Grade 400W CSA G30.18
 Inserts/Embeds: As noted in drawing details

Manufacture of precast concrete units shall be in accordance with specification CSA A23.4, ASTM C1422M

Meets BCL625 Loading

**** LEKO PRECAST LTD SHALL NOT BE RESPONSIBLE FOR ANY INSTALLATION PRACTICES FOLLOWED ON-SITE UNLESS PERFORMED BY LEKO PRECAST LTD ****

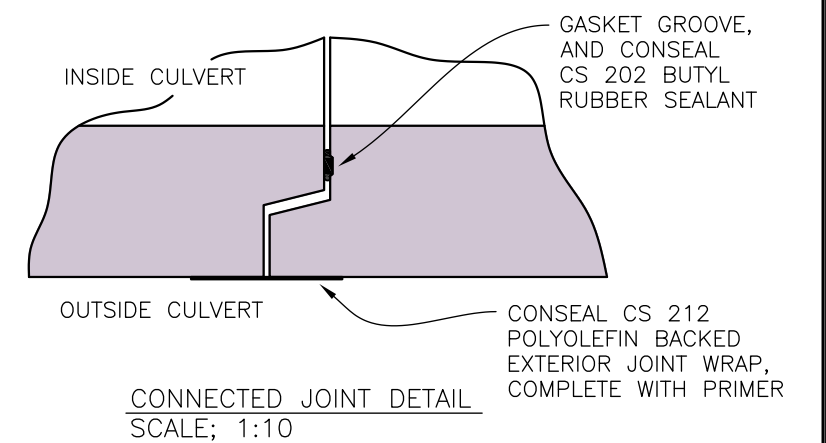
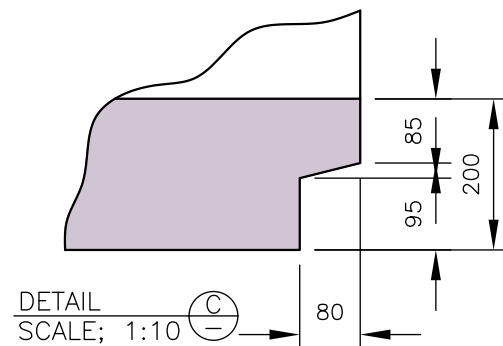
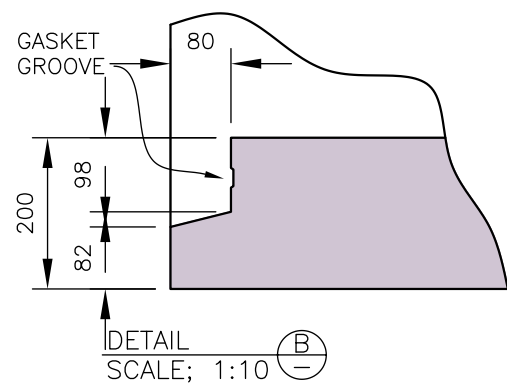

BOX CULVERT LIDS; 2.8m x 2.8m, 0.2m THK

DRAWN BY: J.A	CHECKED BY:	APPROVED BY:	DATE: June 2019
ASSEMBLY DWG.	PREVIOUS DWG.	DRAWING NO.	REVISION
SCALE: 1:25 ISOMETRIC: 1:50		BX 2424 L/B 0	
DO NOT SCALE THIS DRAWING			