

- NOTES**
1. BUILDING PLANS PROVIDED BY CLIENT AND DO NOT REPRESENT AS BUILT CONDITIONS.
 2. ALL AREAS WITHIN THE CONDOMINIUM AND OUTSIDE THE UNITS ARE COMMON ELEMENTS UNLESS NOTED AS LIMITED COMMON ELEMENT.
 3. ALL BUILDING SETBACKS AND OTHER LAND USE REQUIREMENTS SHOULD BE VERIFIED BY THE CHIPPEWA COUNTY PLANNING AND ZONING DEPARTMENT PRIOR TO ANY CONSTRUCTION OR OTHER USE ACTIVITIES.

ACCESS NOTE:
NO COMMON AREAS OR UNITS OF THIS CONDOMINIUM HAVE DIRECT ACCESS ONTO U.S. HIGHWAY 29

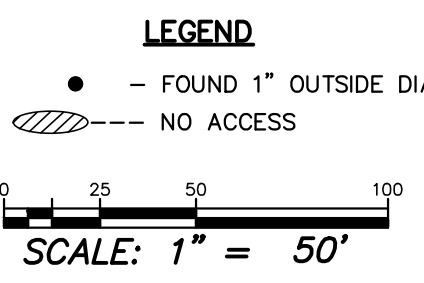

SURVEYOR'S CERTIFICATE:
I, JEREMY D. SKAW, PROFESSIONAL LAND SURVEYOR, HEREBY CERTIFY: THAT BY THE DIRECTION OF NICK SEMLING, I HAVE SURVEYED AND MAPPED THE CONDOMINIUM PLAT OF COUNTRIFIED STORAGE CONDOMINIUMS, LOCATED IN THE SOUTHWEST ¼ OF THE SOUTHWEST ¼, SECTION 11, AND THE SOUTHEAST ¼ OF THE SOUTHEAST ¼, SECTION 10, ALL IN TOWNSHIP 28 NORTH, RANGE 8 WEST, TOWN OF LAFAYETTE, CHIPPEWA COUNTY, WISCONSIN, BEING ALL OF LOT 2 CERTIFIED SURVEY MAP #5704, VOLUME 28 OF CERTIFIED SURVEY MAPS, PAGES 190-192, DOCUMENT #939288 AND BEING MORE PARTICULARLY DESCRIBED AS FOLLOWS:

- BEING ALL OF LOT 2 CERTIFIED SURVEY MAP #5704, VOLUME 28 OF CERTIFIED SURVEY MAPS, PAGES 190-192, DOCUMENT #939288

THAT SUCH PLAT IS A CORRECT REPRESENTATION OF ALL EXTERIOR BOUNDARIES OF THE LAND SURVEYED AND SHOWS THE CORRECT LOCATION OF THE BUILDINGS BUILT OR TO BE BUILT THEREON. THAT I HAVE FULLY COMPLIED WITH THE PROVISIONS OF CHAPTER 703 OF THE WISCONSIN STATUTES AND A-E.7 WISCONSIN ADMINISTRATIVE CODE IN SURVEYING AND MAPPING THE SAME.

JEREMY D. SKAW, P.L.S. 3228
DATED THIS _____ DAY OF _____, 2026

CHIPPEWA COUNTY DEPARTMENT OF PLANNING AND ZONING
I, DOUGLAS CLARY, DIRECTOR OF CHIPPEWA COUNTY DEPARTMENT OF PLANNING & ZONING, CERTIFY THAT THIS CONDOMINIUM PLAT IS APPROVED AS COMPLYING WITH CHAPTER 38 AND OTHER APPLICABLE CHAPTERS OF THE COUNTY CODE OF GENERAL ORDINANCES.
DATED THIS _____ DAY OF _____, 2026
DOUGLAS CLARY, DIRECTOR

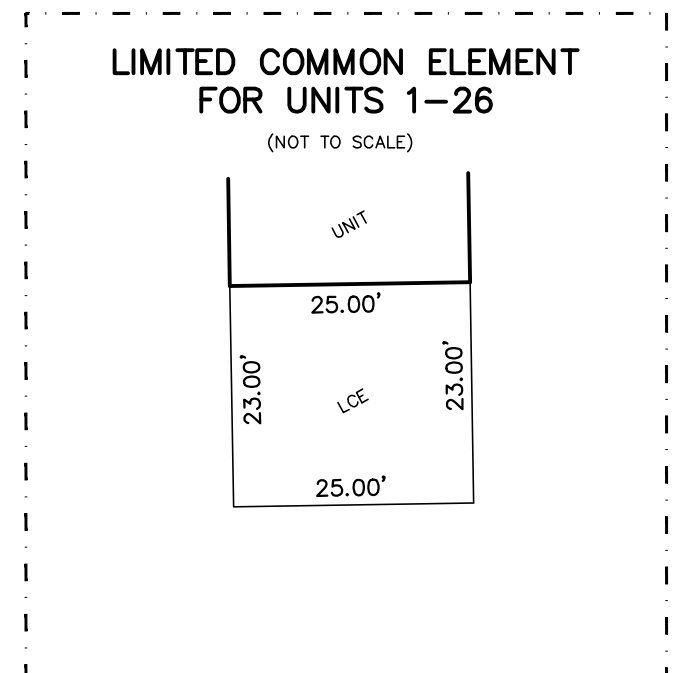
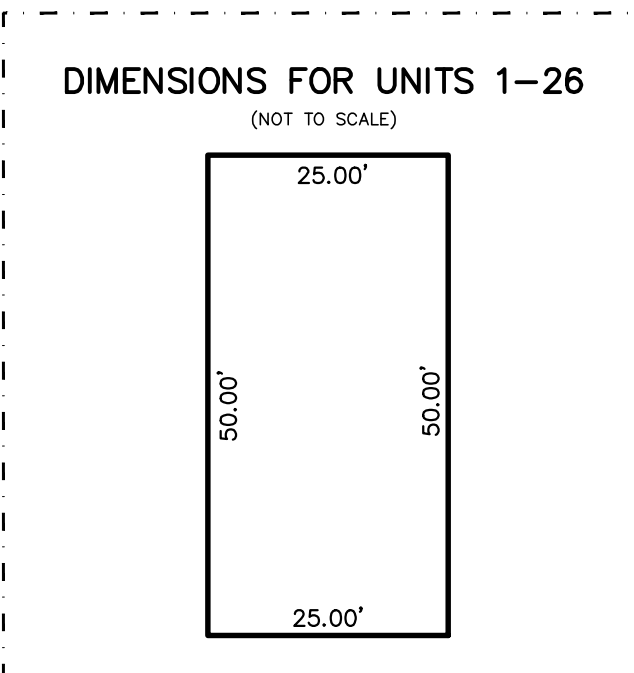

CONDOMINIUM PLAT OF
COUNTRIFIED STORAGE CONDOMINIUMS

LOCATED IN THE SOUTHWEST ¼ OF THE SOUTHWEST ¼, SECTION 11, AND THE SOUTHEAST ¼ OF THE SOUTHEAST ¼, SECTION 10, ALL IN TOWNSHIP 28 NORTH, RANGE 8 WEST, TOWN OF LAFAYETTE, CHIPPEWA COUNTY, WISCONSIN
BEING ALL OF LOT 2 CERTIFIED SURVEY MAP #5704, VOLUME 28 OF CERTIFIED SURVEY MAPS, PAGES 190-192, DOCUMENT #939288