

2021

FusionX
Fishing Lures
INNOVATION THROUGH THE
FUSION OF ART & SCIENCE
www.FUSIONXFISHING.com

FX mold

Proudly



SILICONE OPEN POUR LURE MOLDS

- Over 1000 Mold Styles Available.
- Made With Premium Quality Silicone.
- Specifically Designed For Low Volume Hand Pouring.
- Cast From Precision CNC Machined Master Molds.
- High Temperature Resistance.
- No Mold Release Needed With All FusionX Resins.
- Available in Lure Sizes from 1" to 14"
- All Designs Available in Single Cavity & Multiple Cavity Versions

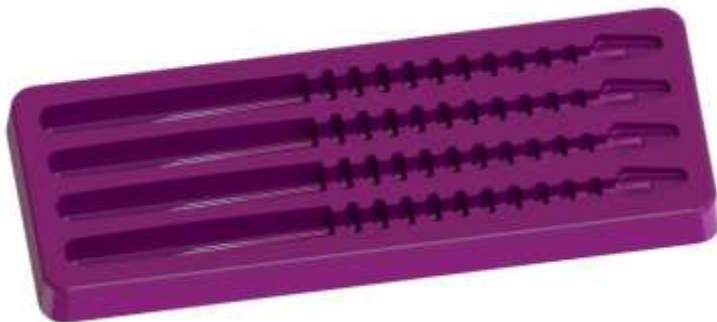

- Prices subject to change without notice.
- Lure specifications subject to change without notice.
- Lure lengths given in "as molded" condition and are for **reference only**.
- Lures per pack of X-Cubes and per Quart of Resin are estimates and for **reference only**.
- Refer to latest revision of this document for up-to-date information.

FX mold

SILICONE OPEN POUR LURE MOLDS

SILICONE HAND POUR MOLDS – Silicone molds are a great way to produce soft plastic fishing lures. They are economical, durable, and easy to use. The greatest benefits of silicone molds is they allow softer resins to be used than injection molds and they are much easier to produce lures with multiple colors. Every mold and every lure will have its own personality and will require some level of trial and error to get optimal results when molded. Every type and brand of resin will react differently and will require changes to the molding procedure. Experiment with resin temperature, pouring techniques, and pouring utensils find the right molding parameters. Softer resins will be thinner and easier to pour, but will shrink more while cooling. Firm or hard resins will be thicker and will be difficult to fill small details.

Silicone Molds Are Not Approved For Direct Food Contact

Why Choose Silicone Open Pour Molds

Long Life

Low Cost

Great Lure Resolution

No Mold Release Needed

Easy To Pour 2 and 3 Color Lures

Work With Soft & Super Soft Resins

No Injector Needed

Less Waste (No Riser & Runner to Trim)

Large Range of Lure Sizes

Shorter Learning Curve

CUSTOM LURE & MOLD DESIGN SERVICES

FusionX Fishing offers custom lure and mold design services for open pour as well as injection molds using silicone, resin, and aluminium. We would gladly work with you on an option that fits your budget and timeline. Since each project is unique please contact us for a quotation and what options are right for you.

3D CAD Design Rapid Prototyping Machined Master Molds
Open Pour Molds Closed Pour Molds Injection Molds

CONTENTS

WORM MOLDS - (Pages 4-15)

TWITCH & JERK BAIT MOLDS - (Pages 16-22)

STICK BAITS - (Pages 23-27)

SWIM BAITS – (Pages 28-37)

CRAW LURES – (Pages 38-47)

CREATURE LURES – (Pages 48-57)

FINESSE & DROP SHOT LURES – (Pages 58-66)

TRAILERS & GRUBS – (Pages 67-73)

OTHERS (Lizard, Shrimp, Frogs, Shad, Bluegill) – (Pages 74-83)

COMBINATION MOLDS – (Pages 84-90)

TUBE DIPPERS – (Pages 91-92)

EPOX CLOSED POUR MOLDS – (Pages 93-97)

Lure Dimensions:

All dimensions provided are approximate and for reference only. Please review sketch below for how lure dimensions are taken as they will differ from common production lure sizes. More lure and mold photos are available at www.FusionXFishing.com that provide additional size information and comparisons for each lure family.

Length (L) – Length with tail in “as molded” curled position.

Width (W) – Maximum width of lure.

Thickness/Height (H) – Maximum Height or Thickness

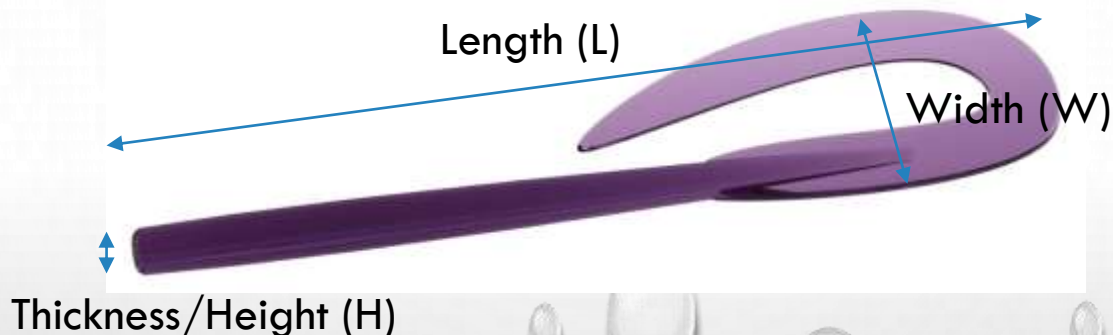

FX mold

SILICONE OPEN POUR LURE MOLDS

ShakySX



Slim Profile Finesse Worm

ShakySX

The ShakySX is a thin straight profile finesse worm designed for lifelike action when used on a drop shot, shaky head, or Texas rig. It is a highly effective and versatile design for clear water and heavy pressured areas. By far one of the most effective drop shot designs available.

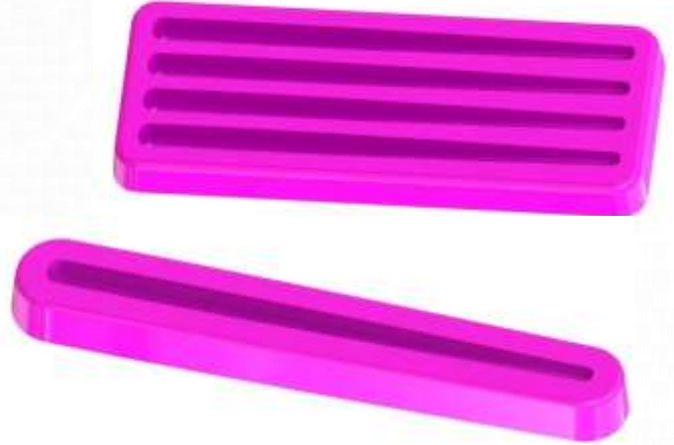

| Size | Lure Dimensions (inches) | | | Single Cavity | | Multi-Cavity | | | Lures per Pack X Cubes | Lures Per Quart Resin |
|---------|--------------------------|-------|--------|---------------|--------|--------------|---------------|---------|------------------------|-----------------------|
| | Length | Width | Height | Part Number | MSRP | Part Number | # of Cavities | MSRP | | |
| 3-1/2" | 3.25" | 0.22" | 0.22" | 0035SC | \$5.61 | 0035MC | 4 | \$9.20 | 44 | 476 |
| 4-1/2" | 4.50" | 0.26" | 0.30" | 0045SC | \$6.21 | 0045MC | 4 | \$10.36 | 22 | 234 |
| 5-1/2" | 5.50" | 0.25" | 0.25" | 0055SC | \$6.44 | 0055MC | 4 | \$11.26 | 17 | 188 |
| 6-1/2" | 6.50" | 0.27" | 0.30" | 0065SC | \$6.67 | 0065MC | 4 | \$12.42 | 13 | 142 |
| 8-1/2" | 8.25" | 0.30" | 0.32" | 0085SC | \$7.43 | 0085SC | 4 | \$14.12 | 8 | 91 |
| 10-1/2" | 10.25" | 0.32" | 0.32" | 00105SC | \$8.23 | 00105SC | 4 | \$16.85 | 6 | 65 |

FX mold

SILICONE OPEN POUR LURE MOLDS

ShakyX



Straight Profile Finesse Worm

ShakyX

The ShakyX is a standard profile straight tail worm designed for a subtle lifelike action when used on a shaky head, drop shot or Texas rig. It is a highly effective lure when a lot of vibration and action is not wanted. The ShakyX has a thicker profile than the Shaky SX.



| Size | Lure Dimensions (inches) | | | Single Cavity | | Multi-Cavity | | | Lures per Pack X Cubes | Lures Per Quart Resin |
|------|--------------------------|-------|--------|---------------|---------|--------------|---------------|---------|------------------------|-----------------------|
| | Length | Width | Height | Part Number | MSRP | Part Number | # of Cavities | MSRP | | |
| 4" | 4.00" | 0.27" | 0.27" | 0140SC | \$6.07 | 0140MC | 4 | \$10.27 | 23 | 246 |
| 5" | 5.00" | 0.28" | 0.28" | 0150SC | \$6.50 | 0150MC | 4 | \$11.73 | 16 | 170 |
| 6" | 5.50" | 0.28" | 0.33" | 0160SC | \$7.22 | 0160MC | 3 | \$13.18 | 11 | 114 |
| 8" | 7.50" | 0.28" | 0.33" | 0180SC | \$8.11 | 0180MC | 3 | \$17.40 | 8 | 86 |
| 10" | 9.50" | 0.40" | 0.40" | 01100SC | \$10.08 | 01100MC | 3 | \$19.76 | 4 | 47 |
| 12" | 11.50" | 0.45" | 0.42" | 01120SC | \$12.14 | 01120MC | 3 | \$21.81 | 3 | 31 |
| 14" | 13.75" | 0.45" | 0.47" | 01140SC | \$13.50 | 01140MC | 3 | \$25.28 | 2 | 26 |

FX mold

SILICONE OPEN POUR LURE MOLDS

X-Flip



Paddle Tail Worm

X-Flip

The X-Flip is a standard profile straight worm with a paddle tail designed for a subtle slow tail movement when used on a shaky head, drop shot or Texas rig. It is a good all around worm for use in most conditions and rigging methods. This is one of the most popular worm designs of all time.

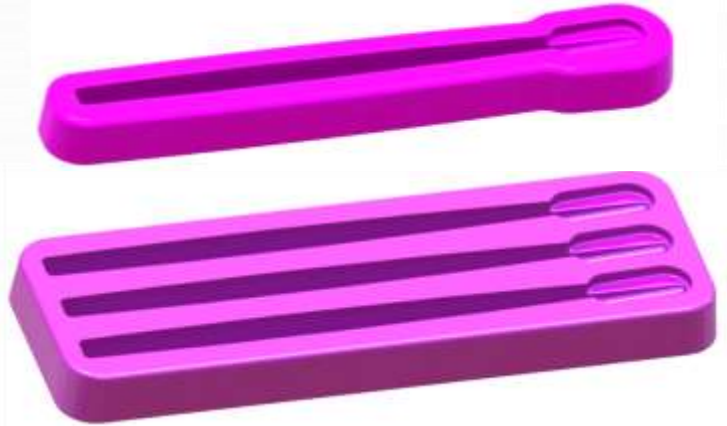

| Size | Lure Dimensions (inches) | | | Single Cavity | | Multi-Cavity | | | Lures per Pack X Cubes | Lures Per Quart Resin |
|------|--------------------------|-------|--------|---------------|---------|--------------|---------------|---------|------------------------|-----------------------|
| | Length | Width | Height | Part Number | MSRP | Part Number | # of Cavities | MSRP | | |
| 3" | 3.30" | 0.36" | 0.27" | 0230SC | \$5.53 | 0230MC | 4 | \$10.09 | 37 | 396 |
| 4" | 4.30" | 0.33" | 0.19" | 0240SC | \$5.79 | 0240MC | 4 | \$11.76 | 15 | 157 |
| 5" | 5.00" | 0.35" | 0.28" | 0250SC | \$6.74 | 0250MC | 4 | \$11.97 | 12 | 134 |
| 6" | 6.00" | 0.35" | 0.28" | 0260SC | \$7.46 | 0260MC | 3 | \$13.68 | 8 | 88 |
| 8" | 8.00" | 0.38" | 0.35" | 0280SC | \$8.74 | 0280MC | 3 | \$16.03 | 6 | 68 |
| 10" | 10.00" | 0.75" | 0.40" | 02100SC | \$10.56 | 02100MC | 3 | \$25.27 | 3 | 35 |
| 12" | 12.10" | 1.00" | 0.45" | 02120SC | \$11.94 | 02120MC | 3 | \$34.41 | 2 | 25 |

FX mold

SILICONE OPEN POUR LURE MOLDS

RX-Flip



Ribbed Body Paddle Tail Worm

RX-Flip

The RX-Flip is a ribbed profile straight worm with a paddle tail designed for a subtle slow tail movement when used on a shaky head, drop shot or Texas rig. The ribbed body gives the appearance of a larger profile, creates extra vibration, and slows the fall of the lure. The RX-Flip is a great choice when a little extra bulk is needed without the added weight.



| Size | Lure Dimensions (inches) | | | Single Cavity | | Multi-Cavity | | | Lures per Pack X Cubes | Lures Per Quart Resin |
|------|--------------------------|-------|--------|---------------|---------|--------------|---------------|---------|------------------------|-----------------------|
| | Length | Width | Height | Part Number | MSRP | Part Number | # of Cavities | MSRP | | |
| 3" | 3.00" | 0.42" | 0.35" | 0330SC | \$6.62 | 0330MC | 3 | \$10.48 | 26 | 278 |
| 4" | 4.00" | 0.38" | 0.41" | 0340SC | \$7.54 | 0340MC | 3 | \$11.64 | 16 | 170 |
| 5" | 5.00" | 0.42" | 0.41" | 0350SC | \$8.56 | 0350MC | 3 | \$13.89 | 11 | 115 |
| 6" | 6.00" | 0.42" | 0.43" | 0360SC | \$9.58 | 0360MC | 3 | \$15.03 | 9 | 93 |
| 8" | 8.00" | 0.47" | 0.46" | 0380SC | \$10.54 | 0380MC | 3 | \$21.29 | 5 | 49 |

FX mold

SILICONE OPEN POUR LURE MOLDS

WaX Worm



Curved Body Wacky Worm

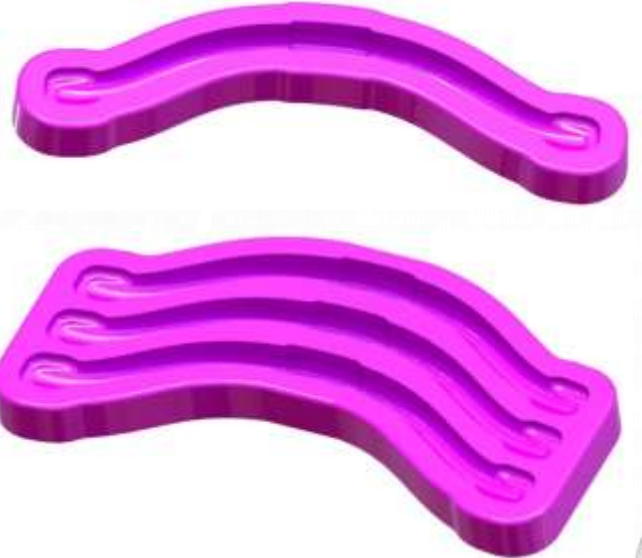

WaX

The WaX Worm is a curved body "wacky" worm. The curved body gives the worm a pulsating movement when moved through the water on a stop and go retrieve. It is a very popular worm for rigging weightless and on a jig head. Absolutely deadly on a drop shot rig.

| Size | Lure Dimensions (inches) | | | Single Cavity | | Multi-Cavity | | | Lures per Pack X Cubes | Lures Per Quart Resin |
|------|--------------------------|-------|--------|---------------|--------|--------------|---------------|---------|------------------------|-----------------------|
| | Length | Width | Height | Part Number | MSRP | Part Number | # of Cavities | MSRP | | |
| 3" | 3.25" | 0.26" | 0.24" | 0430SC | \$6.19 | 0430MC | 3 | \$9.79 | 37 | 404 |
| 4" | 4.12" | 0.28" | 0.28" | 0440SC | \$6.59 | 0440MC | 3 | \$10.66 | 21 | 228 |
| 5" | 5.15" | 0.36" | 0.33" | 0450SC | \$7.19 | 0450MC | 3 | \$12.53 | 12 | 129 |
| 6" | 6.19" | 0.46" | 0.38" | 0460SC | \$7.78 | 0460MC | 3 | \$16.06 | 7 | 80 |
| 8" | 8.27" | 0.42" | 0.36" | 0480SC | \$8.62 | 0480MC | 3 | \$19.53 | 6 | 64 |

FX mold

SILICONE OPEN POUR LURE MOLDS

DragonX Worm



Serpent Tail Worm

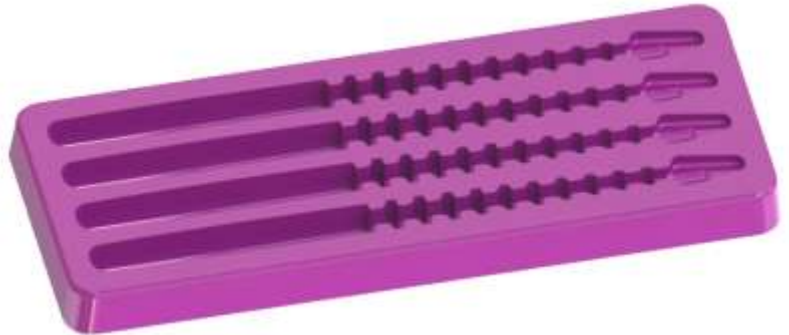

Dragon X

The DRAGON X worm is a segmented tail finesse worm. The unique tail design creates increased action when used on a drop shot or shaky head rig. Ribs on the tail help create additional vibration in the water to attract strikes from the wariest of fish.

| Size | Lure Dimensions (inches) | | | Single Cavity | | Multi-Cavity | | | Lures per Pack X Cubes | Lures Per Quart Resin |
|------|--------------------------|-------|--------|---------------|--------|--------------|---------------|---------|------------------------|-----------------------|
| | Length | Width | Height | Part Number | MSRP | Part Number | # of Cavities | MSRP | | |
| 3" | 3.45" | 0.26" | 0.24" | 0530SC | \$6.36 | 0530MC | 4 | \$10.70 | 37 | 402 |
| 4" | 4.30" | 0.32" | 0.31" | 0540SC | \$6.59 | 0540MC | 4 | \$11.74 | 18 | 193 |
| 5" | 5.05" | 0.35" | 0.33" | 0550SC | \$7.02 | 0550MC | 4 | \$13.92 | 14 | 152 |
| 6" | 5.80" | 0.35" | 0.33" | 0560SC | \$7.21 | 0560MC | 4 | \$17.83 | 12 | 127 |
| 8" | 7.80" | 0.38" | 0.35" | 0580SC | \$8.00 | 0580MC | 4 | \$19.13 | 8 | 84 |
| 10" | 9.80" | 0.38" | 0.37" | 05100SC | \$8.51 | 05100MC | 3 | \$17.53 | 5 | 57 |

FX mold

SILICONE OPEN POUR LURE MOLDS

CurlyX Worm



Curl Tail Worm



CurlyX

The CurlyX is a standard profile worm with a curled swim tail. The curled swim tail creates a swimming action when moved through the water. It is a very popular Texas rigged worm that also works well when used on a shaky head, drop shot or Carolina rig. It is a good all around worm for use in most conditions and applications. This is probably the most popular style worm for warm water use.



| Size | Lure Dimensions (inches) | | | Single Cavity | | Multi-Cavity | | | Lures per Pack X Cubes | Lures Per Quart Resin |
|------|--------------------------|-------|--------|---------------|---------|--------------|---------------|---------|------------------------|-----------------------|
| | Length | Width | Height | Part Number | MSRP | Part Number | # of Cavities | MSRP | | |
| 3" | 3.00" | 0.64" | 0.27" | 0630SC | \$5.70 | 0630MC | 3 | \$9.87 | 37 | 399 |
| 4" | 3.91" | 0.81" | 0.30" | 0640SC | \$6.11 | 0640MC | 3 | \$11.91 | 21 | 230 |
| 5" | 4.96" | 0.79" | 0.30" | 0650SC | \$6.41 | 0650MC | 3 | \$13.55 | 17 | 186 |
| 6" | 6.25" | 0.97" | 0.33" | 0660SC | \$7.31 | 0660MC | 3 | \$16.13 | 11 | 119 |
| 8" | 8.00" | 1.12" | 0.36" | 0680SC | \$9.18 | 0680MC | 3 | \$29.39 | 7 | 73 |
| 10" | 10.00" | 1.29" | 0.43" | 06100SC | \$12.07 | 06100MC | 3 | \$39.31 | 4 | 45 |

FX mold

SILICONE OPEN POUR LURE MOLDS

SnakeX



Snake Body Worm

Snake X

The SnakeX is a "snakelike" body worm designed to create a lifelike swimming action on retrieve. It is a great option for Texas rig or weightless fishing heavy cover as well as a trailer on a buzzbait or spinnerbait.



| Size | Lure Dimensions (inches) | | | Single Cavity | | Multi-Cavity | | | Lures per Pack X Cubes | Lures Per Quart Resin |
|------|--------------------------|-------|--------|---------------|---------|--------------|---------------|---------|------------------------|-----------------------|
| | Length | Width | Height | Part Number | MSRP | Part Number | # of Cavities | MSRP | | |
| 3" | 2.61" | 0.76" | 0.22" | 0730SC | \$5.90 | 0730MC | 3 | \$10.58 | 39 | 421 |
| 4" | 3.26" | 0.38" | 0.22" | 0740SC | \$6.00 | 0740MC | 3 | \$12.10 | 25 | 271 |
| 5" | 3.73" | 0.50" | 0.32" | 0750SC | \$6.79 | 0750MC | 3 | \$14.81 | 12 | 129 |
| 6" | 4.72" | 0.60" | 0.35" | 0760SC | \$7.89 | 0760MC | 3 | \$22.48 | 6 | 66 |
| 8" | 7.13" | 0.91" | 0.42" | 0780SC | \$12.16 | 0780MC | 3 | \$38.22 | 2 | 26 |
| 10" | 9.33" | 0.99" | 0.50" | 071000SC | \$15.09 | 07100MC | 3 | \$49.93 | 1 | 16 |
| 12" | 10.46" | 1.16" | 0.64" | 071200SC | \$18.49 | 07120MC | 3 | \$67.35 | 1 | 10 |
| 14" | 11.41" | 1.35" | 0.66" | 071400SC | \$23.21 | 07140MC | 3 | \$93.33 | -- | 7 |

FX mold

SILICONE OPEN POUR LURE MOLDS

RazorX Worm



Ribbon Tail Worm



RazorX

The RazorX is a standard profile worm with a large ribbon swim tail. The ribbon swim tail creates an aggressive swimming action when moved through the water. It is a very popular Texas rigged worm that also works well when used on a shaky head, drop shot or Carolina rig. It is a good choice when extra action is wanted to trigger aggressive reaction strikes. Also makes a great trailer.

| Size | Lure Dimensions (inches) | | | Single Cavity | | Multi-Cavity | | | Lures per Pack X Cubes | Lures Per Quart Resin |
|------|--------------------------|-------|--------|---------------|---------|--------------|---------------|---------|------------------------|-----------------------|
| | Length | Width | Height | Part Number | MSRP | Part Number | # of Cavities | MSRP | | |
| 3" | 2.96" | 0.79" | 0.29" | 0830SC | \$6.10 | 0830MC | 3 | \$11.12 | 31 | 338 |
| 4" | 4.09" | 1.03" | 0.29" | 0840SC | \$6.50 | 0840MC | 3 | \$14.15 | 19 | 210 |
| 5" | 5.05" | 1.03" | 0.29" | 0850SC | \$7.20 | 0850MC | 3 | \$15.33 | 16 | 171 |
| 6" | 6.10" | 1.38" | 0.32" | 0860SC | \$8.97 | 0860MC | 3 | \$21.85 | 10 | 110 |
| 8" | 8.14" | 1.55" | 0.34" | 0880SC | \$10.73 | 0880MC | 3 | \$29.96 | 6 | 69 |
| 10" | 9.97" | 1.48" | 0.42" | 08100SC | \$12.51 | 08100MC | 3 | \$35.90 | 4 | 42 |
| 12" | 12.00" | 1.56" | 0.46" | 08120SC | \$14.39 | 08120MC | 3 | \$42.64 | 3 | 30 |

FX mold

SILICONE OPEN POUR LURE MOLDS

Craw Worm



Craw Tail Worm



Craw Worm

The Craw Worm is a standard profile worm with a craw pincher tail. The extra profile at the tail creates a unique look without being bulky. It is a very popular Texas rigged worm that also works well when used on a shaky head, drop shot or Carolina rig. The Craw Worm also works great for use as a jig trailer.

| Size | Lure Dimensions (inches) | | | Single Cavity | | Multi-Cavity | | | Lures per Pack X Cubes | Lures Per Quart Resin |
|------|--------------------------|-------|--------|---------------|---------|--------------|---------------|---------|------------------------|-----------------------|
| | Length | Width | Height | Part Number | MSRP | Part Number | # of Cavities | MSRP | | |
| 3" | 3.12" | 1.02" | 0.29" | 0930SC | \$6.25 | 0930MC | 3 | \$12.84 | 24 | 260 |
| 4" | 3.96" | 1.02" | 0.32" | 0940SC | \$6.48 | 0940MC | 3 | \$14.15 | 12 | 134 |
| 5" | 5.00" | 1.14" | 0.35" | 0950SC | \$7.14 | 0950MC | 3 | \$18.16 | 8 | 89 |
| 6" | 6.00" | 1.20" | 0.39" | 0960SC | \$7.79 | 0960MC | 3 | \$20.80 | 6 | 64 |
| 8" | 8.00" | 1.28" | 0.44" | 0980SC | \$10.15 | 0980MC | 3 | \$32.84 | 3 | 35 |

FX mold

SILICONE OPEN POUR LURE MOLDS

XCutR Worm

Cut Tail Worm



XCutR

The XCutR is a standard profile worm with a curled swim tail. The curled swim tail is cut short to create a unique swimming action when moved through the water. It is a very popular Texas rigged worm that also works well when used on a shaky head, drop shot or Carolina rig. It is a good all around worm for use in most conditions and applications. This is a slightly different take on probably the most popular style worm for warm water use.

| Size | Lure Dimensions (inches) | | | Single Cavity | | Multi-Cavity | | | Lures per Pack X Cubes | Lures Per Quart Resin |
|------|--------------------------|-------|--------|---------------|---------|--------------|---------------|---------|------------------------|-----------------------|
| | Length | Width | Height | Part Number | MSRP | Part Number | # of Cavities | MSRP | | |
| 3" | 3.00" | 0.64" | 0.27" | X630SC | \$5.70 | X630MC | 4 | \$10.87 | 37 | 399 |
| 4" | 3.91" | 0.81" | 0.30" | X640SC | \$6.11 | X640MC | 4 | \$12.91 | 21 | 230 |
| 5" | 4.96" | 0.79" | 0.30" | X650SC | \$6.41 | X650MC | 4 | \$14.55 | 17 | 186 |
| 6" | 6.25" | 0.97" | 0.33" | X660SC | \$7.31 | X660MC | 4 | \$17.13 | 11 | 119 |
| 8" | 8.00" | 1.12" | 0.36" | X680SC | \$9.18 | X680MC | 4 | \$29.39 | 7 | 73 |
| 10" | 10.00" | 1.29" | 0.43" | X6100SC | \$12.07 | X6100MC | 3 | \$39.31 | 4 | 45 |

FX mold

SILICONE OPEN POUR LURE MOLDS

X-Pad Big Paddle Tail Worm



X-Pad

The X-Pad is a thick profile straight worm with a large paddle tail designed for a subtle slow tail movement when used on a shaky head, drop shot or Texas rig. The tail and body profile are both large than the X-Flip. It is a good all around worm for use in most conditions and rigging methods. Has hook slot in back.

| Size | Lure Dimensions (inches) | | | Single Cavity | | Multi-Cavity | | | Lures per Pack X Cubes | Lures Per Quart Resin |
|------|--------------------------|-------|--------|---------------|---------|--------------|---------------|---------|------------------------|-----------------------|
| | Length | Width | Height | Part Number | MSRP | Part Number | # of Cavities | MSRP | | |
| 3" | 3.30" | 0.36" | 0.27" | X230SC | \$5.53 | X230MC | 4 | \$10.09 | 37 | 396 |
| 4" | 4.30" | 0.33" | 0.19" | X240SC | \$5.79 | X240MC | 4 | \$11.76 | 15 | 157 |
| 5" | 5.00" | 0.35" | 0.28" | X250SC | \$6.74 | X250MC | 4 | \$11.97 | 12 | 134 |
| 6" | 6.00" | 0.35" | 0.28" | X260SC | \$7.46 | X260MC | 3 | \$13.68 | 8 | 88 |
| 8" | 8.00" | 0.38" | 0.35" | X280SC | \$8.74 | X280MC | 3 | \$16.03 | 6 | 68 |
| 10" | 10.00" | 0.75" | 0.40" | X2100SC | \$10.56 | X2100MC | 3 | \$25.27 | 3 | 35 |
| 12" | 12.10" | 1.00" | 0.45" | X2120SC | \$11.94 | X2120MC | 3 | \$34.41 | 2 | 25 |

FX mold

SILICONE OPEN POUR LURE MOLDS

Itchy Twitchy



Paddle Tail Twitch Bait



ITCHY TWITCHY

The ITCHY TWITCHY is a classic paddle tail twitch bait style. It has incredible side to side darting action that fish cannot ignore. This may be the most versatile soft plastic lure around. It catches just about any species of fish that swims in freshwater or saltwater. It can be rigged weightless, drop shot, Texas, Carolina, Shaky head, on a jig head, as a trailer, and on umbrella rigs.

| Size | Lure Dimensions (inches) | | | Single Cavity | | Multi-Cavity | | | Lures per Pack X Cubes | Lures Per Quart Resin |
|------|--------------------------|-------|--------|---------------|---------|--------------|---------------|----------|------------------------|-----------------------|
| | Length | Width | Height | Part Number | MSRP | Part Number | # of Cavities | MSRP | | |
| 2" | 2.13" | 0.20" | 0.38" | 1020SC | \$5.79 | 1020MC | 4 | \$10.15 | 60 | 653 |
| 3" | 3.25" | 0.20" | 0.38" | 1030SC | \$6.18 | 1030MC | 4 | \$12.77 | 28 | 303 |
| 4" | 4.00" | 0.18" | 0.50" | 1040SC | \$7.21 | 1040MC | 4 | \$17.10 | 12 | 126 |
| 5" | 5.00" | 0.35" | 0.60" | 1050SC | \$8.05 | 1050MC | 4 | \$20.06 | 11 | 118 |
| 6" | 5.88" | 0.17" | 0.50" | 1060SC | \$9.09 | 1060MC | 3 | \$22.12 | 9 | 97 |
| 8" | 8.00" | 0.33" | 0.50" | 1080SC | \$13.15 | 1080MC | 3 | \$31.68 | 4 | 40 |
| 10" | 10.25" | 1.15" | 0.75" | 10100SC | \$14.44 | 10100MC | 3 | \$39.72 | 2 | 25 |
| 12" | 12.25" | 0.97" | 1.07" | 10120SC | \$19.03 | 10120MC | 3 | \$58.15 | 2 | 23 |
| 14" | 14.00" | 1.46" | 1.34" | 10140SC | \$27.98 | 10140MC | 3 | \$126.81 | 1 | 12 |

FX mold

SILICONE OPEN POUR LURE MOLDS

Slim Twitchy



Straight Tail Twitch Bait

SLIM TWITCHY

The SLIM TWITCHY is a classic straight tail twitch bait style. The straight and thin tail gives increased tail action and a faster darting action for a more "lifelike" presentation. It can be rigged weightless, drop shot, Texas, Carolina, Shaky head, on a jig head, as a trailer, and on umbrella rigs. Try the slim twitchy on a double rig with a fast erratic retrieve and drive the Smallmouth Bass crazy.



| Size | Lure Dimensions (inches) | | | Single Cavity | | Multi-Cavity | | | Lures per Pack X Cubes | Lures Per Quart Resin |
|------|--------------------------|-------|--------|---------------|---------|--------------|---------------|---------|------------------------|-----------------------|
| | Length | Width | Height | Part Number | MSRP | Part Number | # of Cavities | MSRP | | |
| 2" | 2.00" | 0.20" | 0.35" | 1120SC | \$5.48 | 1120MC | 4 | \$8.67 | 83 | 901 |
| 3" | 3.00" | 0.20" | 0.35" | 1130SC | \$5.93 | 1130MC | 4 | \$9.90 | 47 | 502 |
| 4" | 4.00" | 0.20" | 0.38" | 1140SC | \$6.21 | 1140MC | 4 | \$12.22 | 21 | 230 |
| 5" | 5.00" | 0.25" | 0.45" | 1150SC | \$7.13 | 1150MC | 4 | \$14.56 | 16 | 168 |
| 6" | 6.00" | 0.33" | 0.50" | 1160SC | \$8.38 | 1160MC | 3 | \$15.99 | 10 | 105 |
| 8" | 8.00" | 0.35" | 0.65" | 1180SC | \$10.70 | 1180MC | 3 | \$23.67 | 5 | 58 |
| 10" | 10.00" | 0.55" | 0.80" | 11100SC | \$13.41 | 11100MC | 3 | \$35.28 | 3 | 33 |
| 12" | 12.00" | 0.79" | 1.20" | 11120SC | \$22.23 | 11120MC | 3 | \$63.43 | 1 | 14 |
| 14" | 14.00" | 0.86" | 1.30" | 11140SC | \$25.10 | 11140MC | 3 | \$72.62 | 1 | 10 |

FX mold

SILICONE OPEN POUR LURE MOLDS

XW Twitch



Paddle Tail Twitch Bait

(Wide Body & Belly Hook Slot)



XW TWITCH

The XW TWITCH is a wide body paddle tail twitch bait. It has a wider body to give the lure more mass for windy days and deeper water fishing. Give the XW Twitch a try for a slower and more subtle twitch bait approach. The belly of the lure has a hook clearance groove that helps improve hooksets and reduces lost fish.

| Size | Lure Dimensions (inches) | | | Single Cavity | | Multi-Cavity | | | Lures per Pack X Cubes | Lures Per Quart Resin |
|---------|--------------------------|-------|--------|---------------|---------|--------------|---------------|----------|------------------------|-----------------------|
| | Length | Width | Height | Part Number | MSRP | Part Number | # of Cavities | MSRP | | |
| 2-1/2" | 2.75" | 0.43" | 0.45" | 1225SC | \$6.31 | 1225MC | 3 | \$12.02 | 21 | 231 |
| 3-1/2" | 3.50" | 0.47" | 0.40" | 1235SC | \$6.69 | 1235MC | 3 | \$14.75 | 17 | 186 |
| 4-1/2" | 4.50" | 0.47" | 0.50" | 1245SC | \$7.24 | 1245MC | 3 | \$16.75 | 12 | 132 |
| 5-1/2" | 5.50" | 0.61" | 0.55" | 1255SC | \$8.41 | 1255MC | 3 | \$20.51 | 9 | 102 |
| 6-1/2" | 6.50" | 0.71" | 0.60" | 1265SC | \$9.90 | 1265MC | 3 | \$25.28 | 6 | 63 |
| 7-1/2" | 7.50" | 0.82" | 0.75" | 1275SC | \$12.61 | 1275MC | 3 | \$31.08 | 4 | 42 |
| 9-1/2" | 10.00" | 1.13" | 1.00" | 1295SC | \$18.80 | 1295MC | 3 | \$62.27 | 2 | 21 |
| 11-1/2" | 11.63" | 1.38" | 1.20" | 12115SC | \$23.79 | 12115MC | 3 | \$98.99 | 1 | 12 |
| 13-1/2" | 13.75" | 1.64" | 1.30" | 12135SC | \$30.08 | 12135MC | 3 | \$105.55 | -- | 6 |

FX mold

SILICONE OPEN POUR LURE MOLDS

Crinkle Twitch



Ribbed Body Twitch Bait

CRINKLE TWITCH

The CRINKLE TWITCH is a paddle tail twitch bait with a minnow style body. The body design is wider and shallower than most standard twitch baits for a unique action. The paddle tail gives increased tail action and a faster darting action for a more "lifelike" presentation. It can be rigged weightless, drop shot, Texas, Carolina, Shaky head, on a jig head, as a trailer, and on umbrella rigs

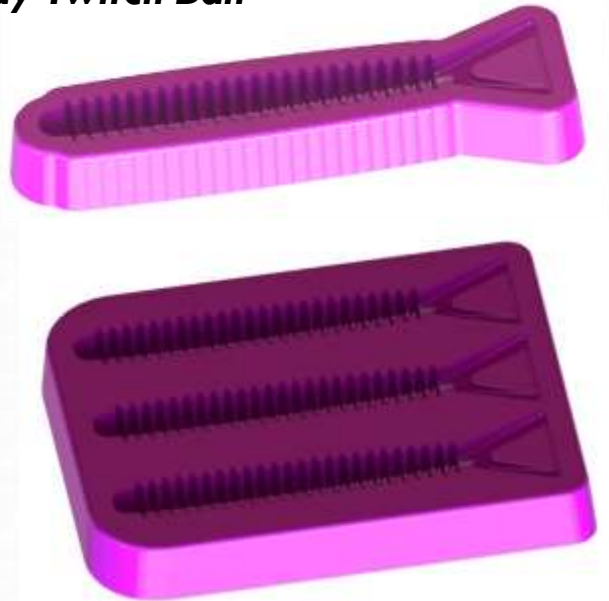

| Size | Lure Dimensions (inches) | | | Single Cavity | | Multi-Cavity | | | Lures per Pack X Cubes | Lures Per Quart Resin |
|--------|--------------------------|-------|--------|---------------|--------|--------------|---------------|---------|------------------------|-----------------------|
| | Length | Width | Height | Part Number | MSRP | Part Number | # of Cavities | MSRP | | |
| 3" | 3.00" | 0.72" | 0.41" | 1330SC | \$6.52 | 1330MC | 3 | \$12.51 | 15 | 164 |
| 3-1/2" | 3.50" | 0.81" | 0.46" | 1335SC | \$6.72 | 1335MC | 3 | \$15.18 | 10 | 107 |
| 4" | 4.20" | 0.95" | 0.46" | 1340SC | \$7.51 | 1340MC | 3 | \$17.49 | 7 | 79 |
| 5" | 5.00" | 0.95" | 0.51" | 1350SC | \$7.89 | 1350MC | 3 | \$20.90 | 5 | 57 |
| 6" | 6.00" | 1.06" | 0.51" | 1360SC | \$8.40 | 1360MC | 3 | \$24.89 | 4 | 47 |
| 8" | 8.25" | 1.19" | 0.53" | 1380SC | \$9.47 | 1380MC | 3 | \$34.85 | 3 | 30 |

FX mold

SILICONE OPEN POUR LURE MOLDS

XS Twitch



Straight Tail Twitch Bait

(Wide Body & Belly Hook Slot)

XS TWITCH

The XS TWITCH is a wide body straight tail twitch bait. It has a wider body to give the lure more mass for windy days and deeper water fishing. Give the XS Twitch a try for a slower and more subtle twitch bait approach. The belly of the lure has a hook clearance groove that helps improve hooksets and reduces lost fish.

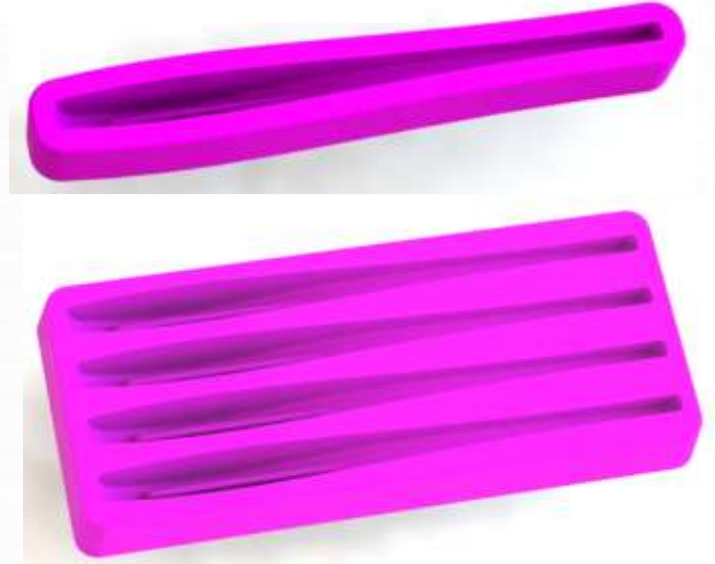

| Size | Lure Dimensions (inches) | | | Single Cavity | | Multi-Cavity | | | Lures per Pack X Cubes | Lures Per Quart Resin |
|------|--------------------------|-------|--------|---------------|---------|--------------|---------------|---------|------------------------|-----------------------|
| | Length | Width | Height | Part Number | MSRP | Part Number | # of Cavities | MSRP | | |
| 3" | 3.25" | 0.32" | 0.42" | 1530SC | \$5.98 | 1530MC | 3 | \$14.41 | 28 | 299 |
| 4" | 4.13" | 0.35" | 0.55" | 1540SC | \$6.52 | 1540MC | 3 | \$15.84 | 15 | 167 |
| 5" | 5.25" | 0.38" | 0.58" | 1550SC | \$7.21 | 1550MC | 3 | \$18.04 | 12 | 128 |
| 6" | 6.25" | 0.45" | 0.64" | 1560SC | \$8.19 | 1560MC | 3 | \$20.33 | 7 | 73 |
| 8" | 8.26" | 0.52" | 0.69" | 1580SC | \$9.27 | 1580MC | 3 | \$24.75 | 4 | 46 |
| 10" | 10.29" | 0.75" | 0.90" | 15100SC | \$14.36 | 15100MC | 3 | \$45.33 | 2 | 20 |
| 12" | 12.25" | 0.83" | 1.05" | 15120SC | \$17.89 | 15120MC | 3 | \$57.74 | 1 | 11 |

FORKY

FX mold

SILICONE OPEN POUR LURE MOLDS



Fork Tail Twitch



Hand Trim Fork Tail After Molding

FORKY

The Forky is a twitch bait with a tall vertical tail that is cut into a fork after molding. Gives a unique action compared to the other twitch bait option. The belly of the lure has a hook clearance groove that helps improve hooksets and reduces lost fish.



| Size | Lure Dimensions (inches) | | | Single Cavity | | Multi-Cavity | | | Lures per Pack X Cubes | Lures Per Quart Resin |
|------|--------------------------|-------|--------|---------------|---------|--------------|---------------|---------|------------------------|-----------------------|
| | Length | Width | Height | Part Number | MSRP | Part Number | # of Cavities | MSRP | | |
| 3" | 3.25" | 0.32" | 0.42" | 1630SC | \$6.98 | 1630MC | 3 | \$16.41 | 28 | 299 |
| 4" | 4.13" | 0.35" | 0.55" | 1640SC | \$7.52 | 1640MC | 3 | \$17.84 | 15 | 167 |
| 5" | 5.25" | 0.38" | 0.58" | 1650SC | \$8.21 | 1650MC | 3 | \$20.04 | 12 | 128 |
| 6" | 6.25" | 0.45" | 0.64" | 1660SC | \$9.19 | 1660MC | 3 | \$22.33 | 7 | 73 |
| 8" | 8.26" | 0.52" | 0.69" | 1680SC | \$10.27 | 1680MC | 3 | \$26.75 | 4 | 46 |
| 10" | 10.29" | 0.75" | 0.90" | 16100SC | \$15.36 | 16100MC | 3 | \$47.33 | 2 | 20 |
| 12" | 12.25" | 0.83" | 1.05" | 16120SC | \$18.89 | 16120MC | 3 | \$59.74 | 1 | 11 |

FX mold

SILICONE OPEN POUR LURE MOLDS

RecoilX



Curl Tail Twitch Bait

(Wide Body & Belly Hook Slot)

RECOILX

The RECOILX is a unique wide body curled tail twitch bait. It has a wider body to give the lure more mass for windy days and deeper water fishing. The curled tail creates a more "lifelike" swimming action when moved. Give the RECOIL X a try for a unique twitch bait fishing experience. The belly of the lure has a hook clearance groove that helps improve hooksets and reduces lost fish. Also works great as a trailer for spinnerbaits, jigs, chatter baits, and buzzbaits.



| Size | Lure Dimensions (inches) | | | Single Cavity | | Multi-Cavity | | | Lures per Pack X Cubes | Lures Per Quart Resin |
|------|--------------------------|-------|--------|---------------|---------|--------------|---------------|----------|------------------------|-----------------------|
| | Length | Width | Height | Part Number | MSRP | Part Number | # of Cavities | MSRP | | |
| 3" | 2.79" | 0.32" | 0.43" | 1830SC | \$6.19 | 1830MC | 3 | \$13.55 | 27 | 289 |
| 4" | 3.59" | 0.33" | 0.52" | 1840SC | \$7.09 | 1840MC | 3 | \$17.57 | 16 | 171 |
| 5" | 4.08" | 0.40" | 0.51" | 1850SC | \$8.00 | 1850MC | 3 | \$20.88 | 12 | 127 |
| 6" | 5.35" | 0.40" | 0.59" | 1860SC | \$8.68 | 1860MC | 3 | \$27.38 | 9 | 96 |
| 8" | 6.47" | 0.60" | 0.79" | 1880SC | \$14.72 | 1880MC | 3 | \$50.16 | 3 | 36 |
| 10" | 8.53" | 0.75" | 1.01" | 18100SC | \$24.88 | 18100MC | 3 | \$102.30 | 1 | 16 |

FX mold

SILICONE OPEN POUR LURE MOLDS

StiX



Standard Body Stick Bait

StiX

The StiX is a broad body soft plastic stick bait lure made popular by lures such as the “Yamamoto Senko”. It has a thick body and makes a great stick bait for use as a weightless stick bait, wacky rig, shaky head, Carolina rig, drop shot, or Texas rig. It has a solid side to side darting action. The extra thickness gives it increased weight for fishing deeper or on windy days.



| Size | Lure Dimensions (inches) | | | Single Cavity | | Multi-Cavity | | | Lures per Pack X Cubes | Lures Per Quart Resin |
|------|--------------------------|-------|--------|---------------|---------|--------------|---------------|---------|------------------------|-----------------------|
| | Length | Width | Height | Part Number | MSRP | Part Number | # of Cavities | MSRP | | |
| 3" | 3.00" | 0.30" | 0.30" | 2030SC | \$5.98 | 2030MC | 4 | \$9.64 | 21 | 223 |
| 4" | 4.25" | 0.35" | 0.35" | 2040SC | \$6.49 | 2040MC | 4 | \$11.72 | 10 | 112 |
| 5" | 5.00" | 0.35" | 0.35" | 2050SC | \$6.94 | 2050MC | 4 | \$13.66 | 9 | 100 |
| 6" | 6.00" | 0.38" | 0.38" | 2060SC | \$7.66 | 2060MC | 4 | \$17.27 | 6 | 67 |
| 8" | 8.00" | 0.40" | 0.40" | 2080SC | \$9.27 | 2080MC | 3 | \$21.33 | 4 | 45 |
| 10" | 10.00" | 0.46" | 0.46" | 20100SC | \$9.93 | 20100MC | 3 | \$24.79 | 3 | 32 |
| 12" | 12.00" | 0.45" | 0.47" | 20120SC | \$10.90 | 20120MC | 3 | \$27.70 | 2 | 25 |
| 14" | 14.00" | 0.48" | 0.50" | 20140SC | \$11.85 | 20140MC | 3 | \$29.75 | 2 | 19 |

FX mold

SILICONE OPEN POUR LURE MOLDS

Slim Stick



Slim Body Stick Bait

Slim Stick

The Slim Stick has a thinner body than a standard stick bait for increased action and a slower fall. It makes a great stick bait for use as a weightless stick bait, wacky rig, shaky head, Carolina rig, drop shot, or Texas rig. It has a solid side to side darting action. The Slim Stick is a great choice for shallow water and a more finesse presentation

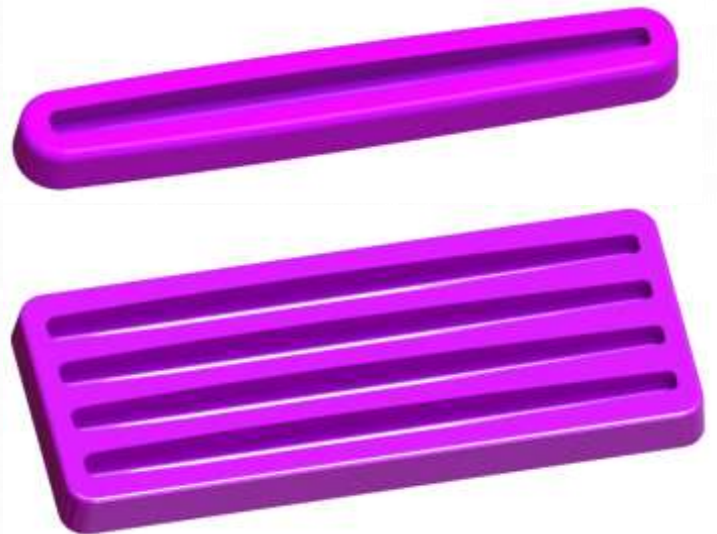

| Size | Lure Dimensions (inches) | | | Single Cavity | | Multi-Cavity | | | Lures per Pack X Cubes | Lures Per Quart Resin |
|---------|--------------------------|-------|--------|---------------|--------|--------------|---------------|---------|------------------------|-----------------------|
| | Length | Width | Height | Part Number | MSRP | Part Number | # of Cavities | MSRP | | |
| 2-1/2" | 2.75" | 0.25" | 0.25" | 2125SC | \$5.54 | 2125MC | 4 | \$8.76 | 35 | 379 |
| 3-1/2" | 3.75" | 0.25" | 0.25" | 2135SC | \$6.19 | 2135MC | 4 | \$9.88 | 21 | 224 |
| 4-1/2" | 4.50" | 0.28" | 0.28" | 2145SC | \$6.38 | 2145MC | 4 | \$11.17 | 16 | 172 |
| 5-1/2" | 5.50" | 0.28" | 0.28" | 2155SC | \$6.65 | 2155MC | 4 | \$12.34 | 11 | 117 |
| 6-1/2" | 6.50" | 0.30" | 0.33" | 2165SC | \$6.97 | 2165MC | 4 | \$12.43 | 9 | 100 |
| 7-1/2" | 7.50" | 0.33" | 0.35" | 2175SC | \$8.19 | 2175MC | 4 | \$13.27 | 7 | 71 |
| 9-1/2" | 9.50" | 0.38" | 0.38" | 2195SC | \$9.04 | 2195MC | 3 | \$17.91 | 5 | 54 |
| 11-1/2" | 11.50" | 0.45" | 0.40" | 21115SC | \$9.90 | 21115MC | 3 | \$19.31 | 4 | 39 |

FX mold

SILICONE OPEN POUR LURE MOLDS

CrinkleX



Ribbed Body Stick Bait

CrinkleX

The CrinkleX Stick is a broad body stick bait with the addition of ribs on the body for extra vibration and a different feel. It has a thick body and makes a great stick bait for use as a weightless stick bait, wacky rig, shaky head, Carolina rig, drop shot, or Texas rig. It has a slow side to side darting action with increased stiffness over a standard stick bait for a very unique action. The extra thickness gives it increases weight for fishing deeper or on windy days

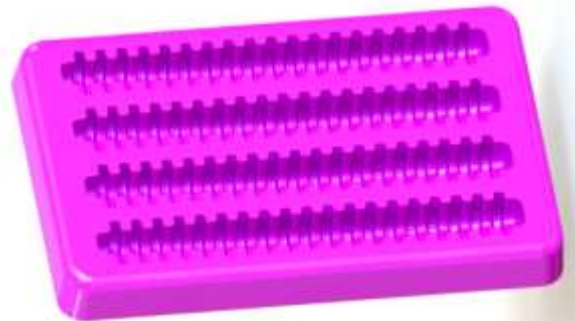

| Size | Lure Dimensions (inches) | | | Single Cavity | | Multi-Cavity | | | Lures per Pack X Cubes | Lures Per Quart Resin |
|------|--------------------------|-------|--------|---------------|--------|--------------|---------------|---------|------------------------|-----------------------|
| | Length | Width | Height | Part Number | MSRP | Part Number | # of Cavities | MSRP | | |
| 3" | 3.25" | 0.45" | 0.40" | 2230SC | \$6.59 | 2230MC | 4 | \$11.32 | 12 | 130 |
| 4" | 4.00" | 0.50" | 0.40" | 2240SC | \$7.08 | 2240MC | 4 | \$12.92 | 9 | 99 |
| 5" | 5.00" | 0.50" | 0.40" | 2250SC | \$8.01 | 2250MC | 3 | \$12.61 | 8 | 81 |
| 6" | 6.00" | 0.50" | 0.40" | 2260SC | \$8.58 | 2260MC | 3 | \$15.19 | 6 | 63 |
| 8" | 8.00" | 0.58" | 0.42" | 2280SC | \$8.81 | 2280MC | 3 | \$16.11 | 4 | 41 |

FX mold

SILICONE OPEN POUR LURE MOLDS

CatX



Caterpillar Stick Bait

CatX

The CatX is a segmented stick bait or caterpillar worm. It has a thick body and tail to give it a stiff appearance in the water. This is a very popular design for Ned rig fishing. It works equally well as a weightless stick bait, drop shot, or shaky head lure.

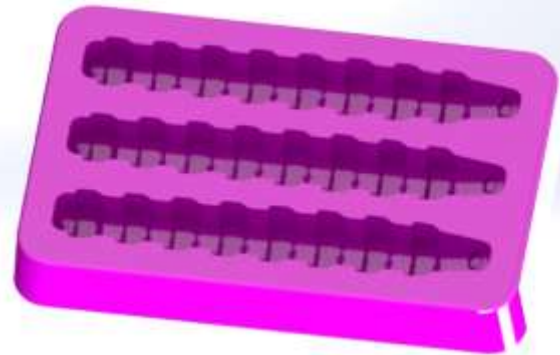
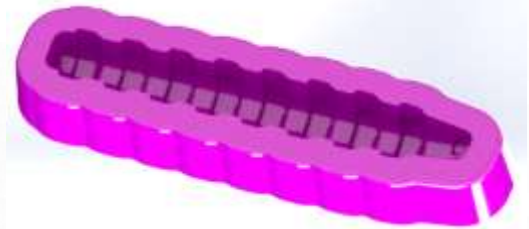

| Size | Lure Dimensions (inches) | | | Single Cavity | | Multi-Cavity | | | Lures per Pack X Cubes | Lures Per Quart Resin |
|--------|--------------------------|-------|--------|---------------|--------|--------------|---------------|---------|------------------------|-----------------------|
| | Length | Width | Height | Part Number | MSRP | Part Number | # of Cavities | MSRP | | |
| 2" | 2.00" | 0.44" | 0.36" | 2320SC | \$5.62 | 2320MC | 3 | \$8.64 | 24 | 255 |
| 2-1/2" | 2.50" | 0.48" | 0.39" | 2325SC | \$5.76 | 2325MC | 3 | \$9.31 | 16 | 172 |
| 3" | 3.00" | 0.46" | 0.38" | 2330SC | \$5.89 | 2330MC | 3 | \$9.93 | 12 | 130 |
| 3-1/2" | 3.50" | 0.54" | 0.40" | 2335SC | \$6.14 | 2335MC | 3 | \$10.12 | 9 | 98 |
| 4" | 4.00" | 0.50" | 0.40" | 2340SC | \$6.18 | 2340MC | 3 | \$11.20 | 9 | 94 |
| 5" | 4.62" | 0.57" | 0.45" | 2350SC | \$6.97 | 2350MC | 3 | \$13.57 | 6 | 69 |

FX mold

SILICONE OPEN POUR LURE MOLDS

Big Fat StiX



Fat Body Stick Bait

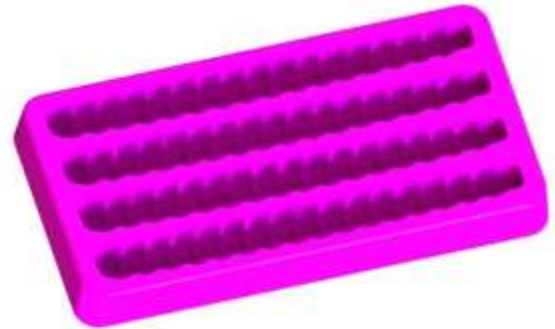
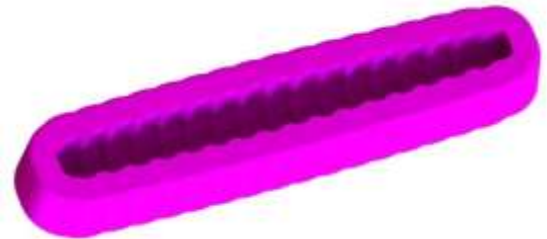

Big Fat StiX

The Big Fat StiX is a thick bodied stick bait design. It has a thick body and tail to give it a stiff appearance in the water. The extra size allows easy casting in the wind and a faster fall rate for windy days. It works equally well as a weightless stick bait, drop shot, Carolina rig, or shaky head lure.

| Size | Lure Dimensions (inches) | | | Single Cavity | | Multi-Cavity | | | Lures per Pack X Cubes | Lures Per Quart Resin |
|------|--------------------------|-------|--------|---------------|--------|--------------|---------------|---------|------------------------|-----------------------|
| | Length | Width | Height | Part Number | MSRP | Part Number | # of Cavities | MSRP | | |
| 3" | 3.35 | 0.46" | 0.44" | 2430SC | \$6.50 | 2430MC | 4 | \$10.10 | 10 | 100 |
| 4" | 4.20" | 0.48" | 0.44" | 2440SC | \$6.78 | 2440MC | 4 | \$10.70 | 7 | 80 |
| 5" | 5.00" | 0.49" | 0.44" | 2450SC | \$7.09 | 2450MC | 4 | \$11.40 | 6 | 68 |
| 6" | 6.00" | 0.52" | 0.46" | 2460SC | \$7.46 | 2460MC | 4 | \$12.33 | 5 | 50 |
| 7" | 7.00" | 0.54" | 0.47" | 2470SC | \$7.87 | 2470MC | 3 | \$12.97 | 4 | 42 |
| 8" | 8.00" | 0.59" | 0.50" | 2480SC | \$8.25 | 2480MC | 3 | \$14.42 | 3 | 32 |

FX mold

SILICONE OPEN POUR LURE MOLDS

SX Shad



Shad Body Swim Bait

SX SHAD

The SX SHAD is a traditional shad bodied swim bait with a medium profile body. This lure has a swimming action created by a paddle swim tail. It is a very traditional design that has been catching fish for decades. The paddle tail creates tremendous action and vibration that fish cannot resist. The SX Shad can be rigged in many methods including weightless, jig head, and as a trailer



| Size | Lure Dimensions (inches) | | | Single Cavity | | Multi-Cavity | | | Lures per Pack X Cubes | Lures Per Quart Resin |
|--------|--------------------------|-------|--------|---------------|---------|--------------|---------------|---------|------------------------|-----------------------|
| | Length | Width | Height | Part Number | MSRP | Part Number | # of Cavities | MSRP | | |
| 1-1/2" | 1.62" | 0.37" | 0.42" | 3015SC | \$6.14 | 3015MC | 4 | \$12.49 | 61 | 663 |
| 2" | 2.12" | 0.43" | 0.48" | 3020SC | \$6.52 | 3020MC | 4 | \$13.19 | 34 | 369 |
| 3" | 3.18" | 0.50" | 0.66" | 3030SC | \$7.70 | 3030MC | 4 | \$19.58 | 14 | 155 |
| 4" | 4.18" | 0.61" | 0.78" | 3040SC | \$8.86 | 3040MC | 4 | \$27.26 | 9 | 99 |
| 5" | 5.18" | 0.74" | 0.85" | 3050SC | \$9.55 | 3050MC | 4 | \$28.57 | 6 | 64 |
| 6" | 6.18" | 0.93" | 1.13" | 3060SC | \$13.27 | 3060MC | 3 | \$48.39 | 3 | 29 |
| 8" | 8.18" | 1.18" | 1.50" | 3080SC | \$23.87 | 3080MC | 3 | 102.73 | 1 | 14 |
| 10" | 10.75" | 1.36" | 1.75" | 30100SC | \$34.90 | 30100MC | 3 | 118.63 | -- | 8 |
| 12" | 13.00" | 1.49" | 1.75" | 30120SC | \$50.45 | 30120MC | 3 | 179.96 | -- | 6 |

FX mold

SILICONE OPEN POUR LURE MOLDS

Swimmy Minny



Minnow Body Swim Bait

Swimmy Minny

The SWIMMY MINNY is a minnow bodied swim bait with a broad body and a thicker tail than the SX Shad. This lure has a swimming action created by a paddle swim tail. The broader design creates a slower tail action and a unique vibration compared to the SX Shad. The Swimmy Minny can be rigged in many methods including weightless, jig head, and as a trailer



| Size | Lure Dimensions (inches) | | | Single Cavity | | Multi-Cavity | | | Lures per Pack X Cubes | Lures Per Quart Resin |
|---------|--------------------------|-------|--------|---------------|---------|--------------|---------------|----------|------------------------|-----------------------|
| | Length | Width | Height | Part Number | MSRP | Part Number | # of Cavities | MSRP | | |
| 1-1/2" | 1.60" | 0.30" | 0.31" | 3115SC | \$5.83 | 3115MC | 4 | \$10.32 | 91 | 978 |
| 2-1/2" | 2.68" | 0.45" | 0.45" | 3125SC | \$6.96 | 3125MC | 4 | \$15.31 | 30 | 323 |
| 3-1/2" | 3.68" | 0.50" | 0.55" | 3135SC | \$7.47 | 3135MC | 4 | \$19.50 | 14 | 148 |
| 4-1/2" | 4.68" | 0.58" | 0.68" | 3145SC | \$8.82 | 3145MC | 4 | \$27.57 | 8 | 82 |
| 5-1/2" | 5.50" | 0.76" | 0.75" | 3155SC | \$10.91 | 3155MC | 4 | \$39.93 | 5 | 59 |
| 6-1/2" | 6.50" | 0.82" | 0.90" | 3165SC | \$12.51 | 3165MC | 3 | \$37.77 | 3 | 35 |
| 8-1/2" | 8.50" | 1.04" | 1.00" | 3185SC | \$16.97 | 3185MC | 3 | \$59.81 | 2 | 18 |
| 10-1/2" | 11.15" | 1.02" | 1.25" | 31105SC | \$28.49 | 31105MC | 3 | \$96.47 | 1 | 12 |
| 12-1/2" | 13.50" | 1.24" | 1.50" | 31125SC | \$43.77 | 31125MC | 3 | \$153.56 | -- | 6 |

FX mold

SILICONE OPEN POUR LURE MOLDS

BIG Swim X



Wide Body Swim Bait

Big Swim X

The BIG SWIM X is a big body swim bait. It has a very thick body for better casting and easier fishing in deep water without the need for added weights. The tail and body design create a subtle and slow swimming action on retrieve. The Big Swim X is designed for those in pursuit of trophy fish of all species



| Size | Lure Dimensions (inches) | | | Single Cavity | | Multi-Cavity | | | Lures per Pack X Cubes | Lures Per Quart Resin |
|--------|--------------------------|-------|--------|---------------|---------|--------------|---------------|---------|------------------------|-----------------------|
| | Length | Width | Height | Part Number | MSRP | Part Number | # of Cavities | MSRP | | |
| 2 | 1.90" | 0.42" | 0.50" | 3220SC | \$6.53 | 3220MC | 3 | \$11.89 | 29 | 311 |
| 2-1/2" | 2.65" | 0.46" | 0.58" | 3225SC | \$7.12 | 3225MC | 3 | \$13.20 | 18 | 194 |
| 3" | 3.25" | 0.47" | 0.60" | 3230SC | \$7.45 | 3230MC | 3 | \$14.84 | 11 | 114 |
| 3-1/2" | 3.60" | 0.55" | 0.65" | 3235SC | \$7.56 | 3235MC | 3 | \$17.60 | 8 | 86 |
| 4" | 4.00" | 0.65" | 0.75" | 3240SC | \$9.55 | 3240MC | 3 | \$21.89 | 5 | 56 |
| 5" | 5.25" | 0.75" | 1.00" | 3250SC | \$13.10 | 3250MC | 3 | \$32.08 | 3 | 29 |
| 6" | 6.25" | 1.08" | 1.30" | 3260SC | \$18.73 | 3260MC | 3 | \$55.88 | 1 | 15 |
| 8" | 8.50" | 1.00" | 1.75" | 3280SC | \$30.81 | 3280MC | 3 | \$90.63 | -- | 7 |

FX mold

SILICONE OPEN POUR LURE MOLDS

Slim Shad



Thin Body Swim Bait

Slim Shad

The SLIM SHAD is a shad bodied swim bait with a thin body. This lure has a swimming action created by a paddle swim tail. It has a body that is thinner across the back and larger from the back to belly than the SX SHAD. The paddle tail creates tremendous action and vibration that fish cannot resist. The SLIM SHAD can be rigged in many methods including weightless, jig head, and as a trailer



| Size | Lure Dimensions (inches) | | | Single Cavity | | Multi-Cavity | | | Lures per Pack X Cubes | Lures Per Quart Resin |
|------|--------------------------|-------|--------|---------------|---------|--------------|---------------|----------|------------------------|-----------------------|
| | Length | Width | Height | Part Number | MSRP | Part Number | # of Cavities | MSRP | | |
| 2" | 2.15" | 0.45" | 0.50" | 3320SC | \$6.54 | 3320MC | 3 | \$13.62 | 31 | 339 |
| 3" | 3.15" | 0.55" | 0.70" | 3330SC | \$8.14 | 3330MC | 3 | \$16.77 | 13 | 137 |
| 4" | 4.15" | 0.63" | 0.95" | 3340SC | \$10.37 | 3340MC | 3 | \$25.74 | 6 | 63 |
| 5" | 5.30" | 0.73" | 1.10" | 3350SC | \$11.49 | 3350MC | 3 | \$35.59 | 3 | 36 |
| 6" | 6.25" | 0.88" | 1.20" | 3360SC | \$18.06 | 3360MC | 3 | \$53.03 | 2 | 22 |
| 8" | 8.50" | 1.02" | 1.35" | 3380SC | \$26.68 | 3380MC | 3 | \$88.97 | 1 | 11 |
| 10" | 10.50" | 1.37" | 1.75" | 33100SC | \$41.77 | 33100MC | 3 | \$142.49 | -- | 6 |
| 12" | 12.75" | 1.50" | 2.00" | 33120SC | \$50.93 | 31200MC | 3 | \$196.17 | -- | 5 |

Curly Minny

FX mold

SILICONE OPEN POUR LURE MOLDS



Curl Tail Minnow Swim Bait

Curly Minny

The Curly Minny is a minnow bodied swim bait with a thin curl tail. The CURLY MINNY can be rigged in many methods including weightless, jig head, and as a trailer.



| Size | Lure Dimensions (inches) | | | Single Cavity | | Multi-Cavity | | | Lures per Pack X Cubes | Lures Per Quart Resin |
|------|--------------------------|-------|--------|---------------|---------|--------------|---------------|----------|------------------------|-----------------------|
| | Length | Width | Height | Part Number | MSRP | Part Number | # of Cavities | MSRP | | |
| 2" | 2.15" | 0.45" | 0.50" | 3420SC | \$7.54 | 3420MC | 3 | \$15.62 | 31 | 339 |
| 3" | 3.15" | 0.55" | 0.70" | 3430SC | \$9.14 | 3430MC | 3 | \$18.77 | 13 | 137 |
| 4" | 4.15" | 0.63" | 0.95" | 3440SC | \$11.37 | 3440MC | 3 | \$27.74 | 6 | 63 |
| 5" | 5.30" | 0.73" | 1.10" | 3450SC | \$12.49 | 3450MC | 3 | \$37.59 | 3 | 36 |
| 6" | 6.25" | 0.88" | 1.20" | 3460SC | \$19.06 | 3460MC | 3 | \$55.03 | 2 | 22 |
| 8" | 8.50" | 1.02" | 1.35" | 3480SC | \$27.68 | 3480MC | 3 | \$90.97 | 1 | 11 |
| 10" | 10.50" | 1.37" | 1.75" | 34100SC | \$42.77 | 34100MC | 3 | \$143.49 | -- | 6 |
| 12" | 12.75" | 1.50" | 2.00" | 34120SC | \$51.93 | 34200MC | 3 | \$198.17 | -- | 5 |

FX mold

SILICONE OPEN POUR LURE MOLDS

RX Swim



Ribbed Body Swim Bait

RX Swim

The RX Swim is a minnow bodied swim bait with a slightly ribbed body. This lure has a swimming action created by a paddle swim tail. The unique profile and ribbed body create a different action and vibration than other stick baits. The RX Swim can be rigged in many methods including weightless, jig head, and as a trailer



| Size | Lure Dimensions (inches) | | | Single Cavity | | Multi-Cavity | | | Lures per Pack X Cubes | Lures Per Quart Resin |
|--------|--------------------------|-------|--------|---------------|---------|--------------|---------------|---------|------------------------|-----------------------|
| | Length | Width | Height | Part Number | MSRP | Part Number | # of Cavities | MSRP | | |
| 2" | 1.80" | 0.35" | 0.40" | 3520SC | \$6.26 | 3520MC | 3 | \$10.86 | 36 | 392 |
| 3" | 2.95" | 0.49" | 0.50" | 3530SC | \$7.22 | 3530MC | 3 | \$15.01 | 18 | 198 |
| 3-1/2" | 3.44" | 0.67" | 0.68" | 3535SC | \$8.58 | 3535MC | 3 | \$21.61 | 8 | 86 |
| 4" | 3.82" | 0.67" | 0.68" | 3540SC | \$8.81 | 3540MC | 3 | \$22.88 | 7 | 81 |
| 5" | 4.82" | 0.63" | 0.68" | 3550SC | \$9.69 | 3550MC | 3 | \$25.58 | 4 | 45 |
| 6" | 5.75" | 0.74" | 0.70" | 3560SC | \$10.49 | 3560MC | 3 | \$34.24 | 3 | 38 |

Curly Shad

Ribbontail Swim Shad

FX mold

SILICONE OPEN POUR LURE MOLDS



Curly Shad

The Curly Shad is a shad bodied swim bait with a thin ribbontail tail. The Curly Shad can be rigged in many methods including weightless, jig head, and as a trailer.

| Size | Lure Dimensions (inches) | | | Single Cavity | | Multi-Cavity | | | Lures per Pack X Cubes | Lures Per Quart Resin |
|------|--------------------------|-------|--------|---------------|---------|--------------|---------------|----------|------------------------|-----------------------|
| | Length | Width | Height | Part Number | MSRP | Part Number | # of Cavities | MSRP | | |
| 2" | 2.15" | 0.45" | 0.50" | 3620SC | \$9.54 | 3620MC | 3 | \$16.62 | 31 | 339 |
| 3" | 3.15" | 0.55" | 0.70" | 3630SC | \$11.14 | 3630MC | 3 | \$19.77 | 13 | 137 |
| 4" | 4.15" | 0.63" | 0.95" | 3640SC | \$12.37 | 3640MC | 3 | \$28.74 | 6 | 63 |
| 5" | 5.30" | 0.73" | 1.10" | 3650SC | \$13.49 | 3650MC | 3 | \$38.59 | 3 | 36 |
| 6" | 6.25" | 0.88" | 1.20" | 3660SC | \$20.06 | 3660MC | 3 | \$56.03 | 2 | 22 |
| 8" | 8.50" | 1.02" | 1.35" | 3680SC | \$28.68 | 3680MC | 3 | \$89.97 | 1 | 11 |
| 10" | 10.50" | 1.37" | 1.75" | 36100SC | \$44.77 | 36100MC | 3 | \$145.49 | -- | 6 |
| 12" | 12.75" | 1.50" | 2.00" | 36120SC | \$55.93 | 36200MC | 3 | \$198.17 | -- | 5 |

FX mold

SILICONE OPEN POUR LURE MOLDS

Rumble Shad



Big Tail Swim Bait

Rumble Shad

The RUMBLE SHAD is a shad bodied swim bait with a thin body and an oversized tail. This lure has a swimming action created by a paddle swim tail. The RUMBLE SHAD body fits between the SX SHAD and SLIM SHAD in size and has a tail that is larger to create more vibration and action. The paddle tail creates tremendous action and vibration that fish cannot resist. The RUMBLE SHAD can be rigged in many methods including weightless, jig head, and as a trailer.



| Size | Lure Dimensions (inches) | | | Single Cavity | | Multi-Cavity | | | Lures per Pack X Cubes | Lures Per Quart Resin |
|------|--------------------------|-------|--------|---------------|---------|--------------|---------------|----------|------------------------|-----------------------|
| | Length | Width | Height | Part Number | MSRP | Part Number | # of Cavities | MSRP | | |
| 4" | 4.18" | 0.76" | 0.85" | 3740SC | \$9.66 | 3740MC | 3 | \$30.35 | 8 | 90 |
| 5" | 5.18" | 0.86" | 1.00" | 3750SC | \$11.77 | 3750MC | 3 | \$42.73 | 3 | 34 |
| 6" | 6.30" | 1.14" | 1.25" | 3760SC | \$17.30 | 3760MC | 3 | \$59.85 | 2 | 26 |
| 7" | 7.30" | 1.14" | 1.25" | 3770SC | \$18.72 | 3770MC | 3 | \$66.79 | 2 | 24 |
| 8" | 8.60" | 1.61" | 2.00" | 3780SC | \$39.67 | 3780MC | 3 | \$146.91 | 1 | 11 |
| 9" | 9.60" | 1.75" | 2.00" | 3790SC | \$43.44 | 3790MC | 3 | \$167.80 | -- | 9 |
| 10" | 10.60" | 1.93" | 2.13" | 37100SC | \$46.45 | 37100MC | 3 | \$170.07 | -- | 7 |
| 12" | 12.60" | 2.03" | 2.25" | 37120SC | \$53.12 | 37120MC | 3 | \$218.47 | -- | 5 |

FX mold

SILICONE OPEN POUR LURE MOLDS

Big Swim Plus



Big Tail Swim Bait

(Wide Body, Belly Hook Slot)

Big Swim Plus

The BIG SWIM Plus is a big body swim bait. It has a very thick body for better casting and easier fishing in deep water without the need for added weights. The tail and body design create a subtle and slow swimming action on retrieve. The Big Swim Plus is designed for those in pursuit of trophy fish of all species. The Plus model has a belly hook slot along with a larger tail profile.



| Size | Lure Dimensions (inches) | | | Single Cavity | | Multi-Cavity | | | Lures per Pack X Cubes | Lures Per Quart Resin |
|------|--------------------------|-------|--------|---------------|---------|--------------|---------------|---------|------------------------|-----------------------|
| | Length | Width | Height | Part Number | MSRP | Part Number | # of Cavities | MSRP | | |
| 4" | 4.00" | 0.65" | 0.75" | 3840SC | \$10.55 | 3840MC | 3 | \$22.89 | 5 | 56 |
| 5" | 5.25" | 0.75" | 1.00" | 3850SC | \$14.10 | 3850MC | 3 | \$34.08 | 3 | 29 |
| 6" | 6.25" | 1.08" | 1.30" | 3860SC | \$19.73 | 3860MC | 3 | \$57.88 | 1 | 15 |
| 7" | 7.50" | 1.00" | 1.50" | 3870SC | \$26.66 | 3870MC | 3 | \$78.12 | -- | 10 |
| 8" | 8.50" | 1.00" | 1.75" | 3880SC | \$31.81 | 3880MC | 3 | \$92.63 | -- | 7 |

FX mold

SILICONE OPEN POUR LURE MOLDS

Rumble Shad Plus



Big Tail Swim Bait



Rumble Shad Plus

The RUMBLE SHAD Plus is a shad bodied swim bait with a thin body and an oversized tail. This lure has a swimming action created by a paddle swim tail. The RUMBLE SHAD body fits between the SX SHAD and SLIM SHAD in size and has a tail that is larger to create more vibration and action. The paddle tail creates tremendous action and vibration that fish cannot resist. The RUMBLE SHAD can be rigged in many methods including weightless, jig head, and as a trailer. The plus model features a hook slot on the belly.

| Size | Lure Dimensions (inches) | | | Single Cavity | | Multi-Cavity | | | Lures per Pack X Cubes | Lures Per Quart Resin |
|------|--------------------------|-------|--------|---------------|---------|--------------|---------------|----------|------------------------|-----------------------|
| | Length | Width | Height | Part Number | MSRP | Part Number | # of Cavities | MSRP | | |
| 4" | 4.18" | 0.76" | 0.85" | 3940SC | \$9.66 | 3940MC | 3 | \$30.35 | 8 | 90 |
| 5" | 5.18" | 0.86" | 1.00" | 3950SC | \$11.77 | 3950MC | 3 | \$42.73 | 3 | 34 |
| 6" | 6.30" | 1.14" | 1.25" | 3960SC | \$17.30 | 3960MC | 3 | \$59.85 | 2 | 26 |
| 7" | 7.30" | 1.14" | 1.25" | 3970SC | \$18.72 | 3970MC | 3 | \$66.79 | 2 | 24 |
| 8" | 8.60" | 1.61" | 2.00" | 3980SC | \$39.67 | 3980MC | 3 | \$146.91 | 1 | 11 |
| 9" | 9.60" | 1.75" | 2.00" | 3990SC | \$43.44 | 3990MC | 3 | \$167.80 | -- | 9 |
| 10" | 10.60" | 1.93" | 2.13" | 39100SC | \$46.45 | 39100MC | 3 | \$170.07 | -- | 7 |
| 12" | 12.60" | 2.03" | 2.25" | 39120SC | \$53.12 | 39120MC | 3 | \$218.47 | -- | 5 |

FX mold

SILICONE OPEN POUR LURE MOLDS

Slim Craw



Slim Profile Crawdad



SLIM CRAW

The SLIM CRAW is a traditional craw body lure. It has a proportionally correct shape to fool fish into thinking it is a real crawdad. It is a very versatile lure that can be rigged Texas, Carolina, Shaky, as a trailer, or on a jig head.



| Size | Lure Dimensions (inches) | | | Single Cavity | | Multi-Cavity | | | Lures per Pack X Cubes | Lures Per Quart Resin |
|--------|--------------------------|-------|--------|---------------|---------|--------------|---------------|---------|------------------------|-----------------------|
| | Length | Width | Height | Part Number | MSRP | Part Number | # of Cavities | MSRP | | |
| 2" | 1.75" | 0.75" | 0.20" | 4020SC | \$5.51 | 4020MC | 3 | \$8.76 | 75 | 805 |
| 2-1/2" | 2.25" | 1.00" | 0.20" | 4025SC | \$6.07 | 4025MC | 3 | \$11.29 | 33 | 356 |
| 3" | 3.00" | 0.90" | 0.31" | 4030SC | \$7.23 | 4030MC | 3 | \$12.21 | 18 | 192 |
| 3-1/2" | 3.50" | 1.13" | 0.35" | 4035SC | \$8.68 | 4035MC | 3 | \$12.79 | 17 | 182 |
| 4" | 4.00" | 1.40" | 0.37" | 4040SC | \$9.04 | 4040MC | 3 | \$16.79 | 9 | 100 |
| 4-1/2" | 4.50" | 1.50" | 0.37" | 4045SC | \$10.44 | 4045MC | 3 | \$22.31 | 7 | 72 |
| 5" | 5.00" | 1.60" | 0.40" | 4050SC | \$11.37 | 4050MC | 3 | \$27.02 | 5 | 56 |
| 6" | 6.00" | 1.75" | 0.45" | 4060SC | \$12.37 | 4060MC | 3 | \$44.23 | 4 | 39 |
| 8" | 8.00" | 2.31" | 0.50" | 4080SC | \$14.15 | 4080MC | 3 | \$49.46 | 2 | 19 |

FX mold

SILICONE OPEN POUR LURE MOLDS

Rib Craw



Ribbed Body Crawdad

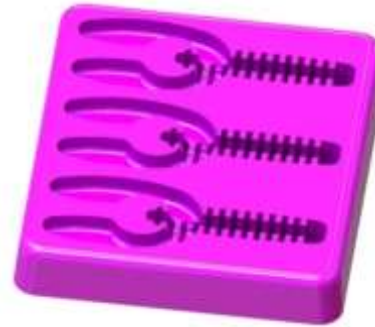

RIB CRAW

The RIB CRAW is a traditional craw body lure with the addition of thin ribs to give the body more bulk, increased vibration, and a softer feel. It has a proportionally correct shape to fool fish into thinking it is a real crawdad. It is a very versatile lure that can be rigged Texas, Carolina, Shaky, as a trailer, or on a jig head.

| Size | Lure Dimensions (inches) | | | Single Cavity | | Multi-Cavity | | | Lures per Pack X Cubes | Lures Per Quart Resin |
|--------|--------------------------|-------|--------|---------------|---------|--------------|---------------|---------|------------------------|-----------------------|
| | Length | Width | Height | Part Number | MSRP | Part Number | # of Cavities | MSRP | | |
| 2" | 2.10" | 0.65" | 0.38" | 4120SC | \$6.32 | 4120MC | 3 | \$10.33 | 33 | 359 |
| 2-1/2" | 2.40" | 0.75" | 0.42" | 4125SC | \$7.85 | 4125MC | 3 | \$11.13 | 30 | 329 |
| 3" | 2.80" | 1.00" | 0.42" | 4130SC | \$7.45 | 4130MC | 3 | \$12.66 | 24 | 261 |
| 3-1/2" | 3.50" | 1.25" | 0.42" | 4135SC | \$8.55 | 4135MC | 3 | \$15.84 | 14 | 152 |
| 4" | 4.00" | 1.44" | 0.50" | 4140SC | \$10.68 | 4140MC | 3 | \$18.61 | 9 | 93 |
| 4-1/2" | 4.50" | 1.50" | 0.60" | 4145SC | \$10.92 | 4145MC | 3 | \$20.64 | 8 | 82 |
| 5-1/2" | 5.25" | 1.70" | 0.65" | 4155SC | \$13.45 | 4155MC | 3 | \$25.03 | 6 | 61 |

FX mold

SILICONE OPEN POUR LURE MOLDS

Flat Craw



Wide Profile Crawdad

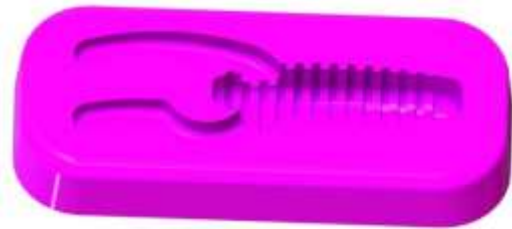

FLAT CRAW

The FLAT CRAW has a much broader and flatter body when compared to the Slim Craw. The body shape creates a slower fall and increased action. It is a very versatile lure that can be rigged Texas, Carolina, Shaky, as a trailer, or on a jig head.



| Size | Lure Dimensions (inches) | | | Single Cavity | | Multi-Cavity | | | Lures per Pack X Cubes | Lures Per Quart Resin |
|--------|--------------------------|-------|--------|---------------|---------|--------------|---------------|---------|------------------------|-----------------------|
| | Length | Width | Height | Part Number | MSRP | Part Number | # of Cavities | MSRP | | |
| 2" | 2.15" | 0.65" | 0.26" | 4220SC | \$6.26 | 4220MC | 3 | \$9.87 | 30 | 310 |
| 2-1/2" | 2.50" | 0.75" | 0.28" | 4225SC | \$6.45 | 4225MC | 3 | \$10.90 | 22 | 238 |
| 3" | 2.80" | 1.00" | 0.30" | 4230SC | \$6.81 | 4230MC | 3 | \$12.40 | 14 | 150 |
| 3-1/2" | 3.55" | 1.48" | 0.32" | 4235SC | \$10.45 | 4235MC | 3 | \$17.63 | 8 | 83 |
| 4" | 4.10" | 1.52" | 0.36" | 4240SC | \$11.01 | 4240MC | 3 | \$22.99 | 6 | 62 |
| 4-1/2" | 4.50" | 1.60" | 0.40" | 4245SC | \$11.41 | 4245MC | 3 | \$27.41 | 4 | 45 |
| 5-1/2" | 5.50" | 1.75" | 0.42" | 4255SC | \$14.78 | 4255MC | 3 | \$43.11 | 2 | 24 |

FX mold

SILICONE OPEN POUR LURE MOLDS

Swimmy Craw



Swim Claw Crawdad



SWIMMY CRAW

The SWIMMY CRAW has a standard craw body with ribs for increased action and feel. The Swimmy Craw has the addition of curled pinchers to create a swimming action on retrieve. It is a very versatile lure that can be rigged Texas, Carolina, Shaky, as a trailer, or on a jig head.

| Size | Lure Dimensions (inches) | | | Single Cavity | | Multi-Cavity | | | Lures per Pack X Cubes | Lures Per Quart Resin |
|--------|--------------------------|-------|--------|---------------|--------|--------------|---------------|---------|------------------------|-----------------------|
| | Length | Width | Height | Part Number | MSRP | Part Number | # of Cavities | MSRP | | |
| 2" | 2.20" | 1" | 0.25" | 4320SC | \$6.44 | 4320MC | 3 | \$12.67 | 29 | 286 |
| 2-1/2" | 2.55" | 1.23" | 0.27" | 4325SC | \$6.63 | 4325MC | 3 | \$13.59 | 24 | 229 |
| 3" | 2.75" | 1.49" | 0.30" | 4330SC | \$6.86 | 4330MC | 3 | \$14.94 | 21 | 221 |
| 3-1/2" | 3.50" | 1.74" | 0.40" | 4335SC | \$7.80 | 4335MC | 3 | \$20.05 | 12 | 126 |
| 4" | 4.25" | 2.49" | 0.37" | 4340SC | \$9.18 | 4340MC | 3 | \$21.89 | 9 | 92 |
| 4-1/2" | 4.55" | 2.60" | 0.40" | 4345SC | \$9.20 | 4345MC | 3 | \$23.19 | 8 | 88 |

FX mold

SILICONE OPEN POUR LURE MOLDS

KnoX Craw



Big Claw Crawdad

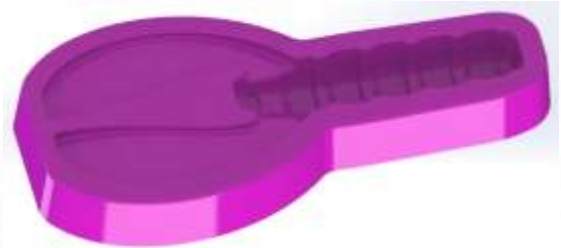

KnoX CRAW

The KnoX CRAW has a wide craw body with oversized pinchers. The pinchers are designed to create a flapping action on retrieve. This craw has exception action when used as a jig trailer, Texas rig, Carolina rig, and on a jig head

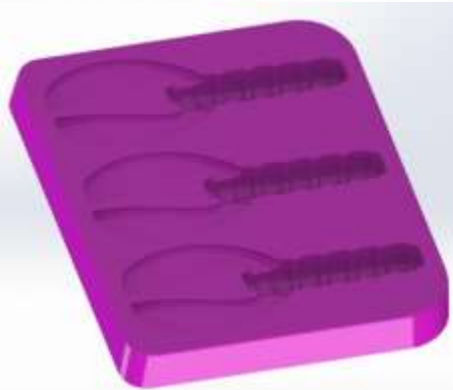

| Size | Lure Dimensions (inches) | | | Single Cavity | | Multi-Cavity | | | Lures per Pack X Cubes | Lures Per Quart Resin |
|--------|--------------------------|-------|--------|---------------|--------|--------------|---------------|---------|------------------------|-----------------------|
| | Length | Width | Height | Part Number | MSRP | Part Number | # of Cavities | MSRP | | |
| 2" | 2.13" | 1.00" | 0.29" | 4420SC | \$6.06 | 4420MC | 3 | \$11.70 | 41 | 448 |
| 2-1/2" | 2.63" | 1.25" | 0.32" | 4425SC | \$6.50 | 4425MC | 3 | \$15.07 | 25 | 265 |
| 3" | 3.00" | 1.40" | 0.35" | 4430SC | \$6.67 | 4430MC | 3 | \$17.28 | 18 | 191 |
| 3-1/2" | 3.63" | 1.50" | 0.43" | 4435SC | \$7.33 | 4435MC | 3 | \$18.14 | 10 | 108 |
| 4" | 4.13" | 1.60" | 0.43" | 4440SC | \$8.01 | 4440MC | 3 | \$20.09 | 8 | 82 |
| 4-1/2" | 4.63" | 1.70" | 0.44" | 4445SC | \$8.74 | 4445MC | 3 | \$26.83 | 7 | 71 |

FX mold

SILICONE OPEN POUR LURE MOLDS

Xorcist



Creature Crawdad



Xorcist

The Xorcist is a creature type craw lure designed to entice fish with a new and unique look. With a wide ribbed body the curl pinchers and side tentacles create a slow action on retrieve. The Xorcist can be rigged as a trailer, Texas Rig, Carolina rig, and Jig Head

| Size | Lure Dimensions (inches) | | | Single Cavity | | Multi-Cavity | | | Lures per Pack X Cubes | Lures Per Quart Resin |
|--------|--------------------------|-------|--------|---------------|--------|--------------|---------------|---------|------------------------|-----------------------|
| | Length | Width | Height | Part Number | MSRP | Part Number | # of Cavities | MSRP | | |
| 2" | 1.73" | 1.20" | 0.30" | 4520SC | \$6.46 | 4520SC | 3 | \$10.54 | 32 | 341 |
| 2-1/2" | 2.21" | 1.75" | 0.32" | 4525SC | \$6.49 | 4525SC | 3 | \$13.24 | 20 | 217 |
| 3" | 2.61" | 2.01" | 0.38" | 4530SC | \$7.31 | 4530SC | 3 | \$15.39 | 13 | 136 |
| 3-1/2" | 3.07" | 2.00" | 0.45" | 4535SC | \$8.42 | 4535SC | 3 | \$19.26 | 9 | 99 |
| 4" | 3.59" | 2.00" | 0.41" | 4540SC | \$8.90 | 4540SC | 3 | \$19.40 | 8 | 85 |
| 4-1/2" | 4.10" | 2.49" | 0.45" | 4545SC | \$9.81 | 4545SC | 3 | \$25.72 | 6 | 61 |

FX mold

SILICONE OPEN POUR LURE MOLDS

MOP Craw



Creature Crawdad



MOP CRAW

The MOP CRAW is a creature type craw lure designed to entice fish with a new and unique look. The pinchers and tentacles create a slow action on retrieve. The MOP CRAW can be rigged as a trailer, Texas Rig, Carolina rig, and Jig Head.



| Size | Lure Dimensions (inches) | | | Single Cavity | | Multi-Cavity | | | Lures per Pack X Cubes | Lures Per Quart Resin |
|--------|--------------------------|-------|--------|---------------|---------|--------------|---------------|---------|------------------------|-----------------------|
| | Length | Width | Height | Part Number | MSRP | Part Number | # of Cavities | MSRP | | |
| 2" | 2.20" | 1.10" | 0.24" | 4620SC | \$5.24 | 4620MC | 3 | \$11.22 | 50 | 535 |
| 2-1/2" | 2.55" | 1.27" | 0.27" | 4625SC | \$6.00 | 4625MC | 3 | \$12.82 | 32 | 342 |
| 3" | 3.14" | 1.56" | 0.34" | 4630SC | \$6.95 | 4630MC | 3 | \$17.82 | 17 | 184 |
| 3-1/2" | 3.53" | 1.76" | 0.38" | 4635SC | \$7.26 | 4635MC | 3 | \$18.90 | 12 | 129 |
| 4" | 4.00" | 1.83" | 0.43" | 4640SC | \$8.17 | 4640MC | 3 | \$20.98 | 9 | 96 |
| 4-1/2" | 4.30" | 1.98" | 0.43" | 4645SC | \$8.46 | 4645MC | 3 | \$22.68 | 8 | 90 |
| 5" | 4.91" | 2.29" | 0.53" | 4650SC | \$10.55 | 4650MC | 3 | \$38.90 | 5 | 49 |

FX mold

SILICONE OPEN POUR LURE MOLDS

X-Bug



Creature Crawdad

X-BUG

The X-BUG CRAW is a creature crawl lure designed for a smaller profile while having plenty of action. It combines narrow pinchers with side appendages to attract the most wary fish.



| Size | Lure Dimensions (inches) | | | Single Cavity | | Multi-Cavity | | | Lures per Pack X Cubes | Lures Per Quart Resin |
|--------|--------------------------|-------|--------|---------------|---------|--------------|---------------|---------|------------------------|-----------------------|
| | Length | Width | Height | Part Number | MSRP | Part Number | # of Cavities | MSRP | | |
| 2" | 1.61" | 1.26" | 0.22" | 4720SC | \$6.14 | 4720MC | 3 | \$9.73 | 58 | 625 |
| 2-1/2" | 2.04" | 1.60" | 0.28" | 4725SC | \$6.18 | 4725MC | 3 | \$12.25 | 28 | 305 |
| 3" | 2.55" | 2.11" | 0.36" | 4730SC | \$6.98 | 4730MC | 3 | \$16.26 | 13 | 146 |
| 3-1/2" | 3.06" | 2.50" | 0.42" | 4735SC | \$7.81 | 4735MC | 3 | \$17.92 | 9 | 95 |
| 4" | 3.56" | 2.50" | 0.43" | 4740SC | \$8.63 | 4740MC | 3 | \$21.83 | 7 | 77 |
| 4-1/2" | 4.06" | 2.50" | 0.46" | 4745SC | \$9.46 | 4745MC | 3 | \$25.03 | 6 | 59 |
| 5" | 4.56" | 2.55" | 0.46" | 4750SC | \$10.71 | 4750MC | 3 | \$27.14 | 5 | 57 |

FX mold

SILICONE OPEN POUR LURE MOLDS

Creek Craw



Creature Crawdad

CREEK CRAW

The CREEK CRAW is a creature crawl lure designed for a smaller profile while having plenty of action. It combines narrow pinchers with side appendages to attract the most wary fish



| Size | Lure Dimensions (inches) | | | Single Cavity | | Multi-Cavity | | | Lures per Pack X Cubes | Lures Per Quart Resin |
|--------|--------------------------|-------|--------|---------------|---------|--------------|---------------|---------|------------------------|-----------------------|
| | Length | Width | Height | Part Number | MSRP | Part Number | # of Cavities | MSRP | | |
| 2" | 2.20" | 1.16" | 0.23" | 4820SC | \$6.00 | 4820MC | 3 | \$9.88 | 41 | 448 |
| 2-1/2" | 2.75" | 1.61" | 0.25" | 4825SC | \$6.42 | 4825MC | 3 | \$11.46 | 24 | 260 |
| 3" | 3.25" | 1.79" | 0.25" | 4830SC | \$6.61 | 4830MC | 3 | \$16.63 | 6 | 66 |
| 3-1/2" | 3.50" | 1.70" | 0.29" | 4835SC | \$6.78 | 4835MC | 3 | \$17.32 | 6 | 66 |
| 4" | 4.00" | 1.81" | 0.30" | 4840SC | \$7.11 | 4840MC | 3 | \$19.71 | 14 | 146 |
| 5" | 4.75" | 2.17" | 0.37" | 4850SC | \$7.81 | 4850MC | 3 | \$27.70 | 6 | 66 |
| 6" | 5.75" | 2.27" | 0.42" | 4860SC | \$9.45 | 4860MC | 3 | \$39.20 | 7 | 70 |
| 8" | 7.50" | 2.29" | 0.45" | 4880SC | \$11.29 | 4880MC | 3 | \$40.56 | 4 | 47 |

FX mold

SILICONE OPEN POUR LURE MOLDS

Flapper



Swim Leg Creature Crawdad



FLAPPER

The FLAPPER is a creature crawl lure designed for a smaller profile while having plenty of action. It combines curl pinchers with a slight rib on the ends to enhance the swimming action.

| Size | Lure Dimensions (inches) | | | Single Cavity | | Multi-Cavity | | | Lures per Pack X Cubes | Lures Per Quart Resin |
|--------|--------------------------|-------|--------|---------------|---------|--------------|---------------|---------|------------------------|-----------------------|
| | Length | Width | Height | Part Number | MSRP | Part Number | # of Cavities | MSRP | | |
| 2" | 2.15" | 1.00" | 0.27" | 4920SC | \$6.37 | 4920MC | 3 | \$10.55 | 34 | 366 |
| 2-1/2" | 2.49" | 1.06" | 0.27" | 4925SC | \$6.48 | 4925MC | 3 | \$11.61 | 28 | 303 |
| 3" | 3.00" | 1.08" | 0.32" | 4930SC | \$6.61 | 4930MC | 3 | \$12.62 | 18 | 197 |
| 3-1/2" | 3.63" | 1.15" | 0.32" | 4935SC | \$6.91 | 4935MC | 3 | \$14.53 | 15 | 159 |
| 4" | 3.88" | 1.27" | 0.34" | 4940SC | \$7.00 | 4940MC | 3 | \$15.04 | 11 | 122 |
| 4-1/2" | 4.38" | 1.40" | 0.37" | 4945SC | \$7.66 | 4945MC | 3 | \$16.86 | 9 | 98 |
| 5" | 4.75" | 1.41" | 0.37" | 4950SC | \$7.92 | 4950MC | 3 | \$17.70 | 9 | 98 |
| 6" | 5.75" | 2.05" | 0.40" | 4960SC | \$10.39 | 4960MC | 3 | \$23.44 | 6 | 65 |
| 8" | 7.50" | 2.02" | 0.47" | 4980SC | \$12.65 | 4980MC | 3 | \$34.98 | 4 | 42 |

FX mold

SILICONE OPEN POUR LURE MOLDS

CritterX



Wide Body Creature

Critter X

The Critter X is a broad and flat “beaver” style creature lure. The body shape creates a slow fall and increased action. The tail is molded as one piece with a molded in parting line so it can be easily cut or torn into two sections if needed. The Critter X is a great lure for flipping and pitching heavy cover. It is a very versatile lure that can be rigged Texas, Carolina, Shaky, as a trailer, or on a jig head.



| Size | Lure Dimensions (inches) | | | Single Cavity | | Multi-Cavity | | | Lures per Pack X Cubes | Lures Per Quart Resin |
|--------|--------------------------|-------|--------|---------------|---------|--------------|---------------|---------|------------------------|-----------------------|
| | Length | Width | Height | Part Number | MSRP | Part Number | # of Cavities | MSRP | | |
| 2" | 2.00" | 0.40" | 0.20" | 5020SC | \$6.35 | 5020MC | 3 | \$10.17 | 51 | 547 |
| 2-1/2" | 2.50" | 0.50" | 0.25" | 5025SC | \$7.16 | 5025MC | 3 | \$11.25 | 23 | 252 |
| 3" | 3.25" | 0.60" | 0.30" | 5030SC | \$7.40 | 5030MC | 3 | \$12.42 | 18 | 190 |
| 3-1/2" | 3.63" | 0.65" | 0.32" | 5035SC | \$8.00 | 5035MC | 3 | \$13.56 | 14 | 156 |
| 4" | 4.00" | 0.75" | 0.40" | 5040SC | \$8.35 | 5040MC | 3 | \$16.84 | 9 | 94 |
| 4-1/2" | 4.50" | 1.00" | 0.41" | 5045SC | \$9.36 | 5045MC | 3 | \$17.83 | 9 | 92 |
| 5" | 5.00" | 1.25" | 0.35" | 5050SC | \$10.17 | 5050MC | 3 | \$19.43 | 6 | 65 |
| 6" | 6.00" | 1.40" | 0.45" | 5060SC | \$12.50 | 5060MC | 3 | \$26.17 | 3 | 34 |

FX mold

SILICONE OPEN POUR LURE MOLDS

Slim Critter



Slim Body Creature

Slim Critter

The SLIM CRITTER is a thin and flat “beaver” style creature lure. The body shape creates a slow fall and increased action. The thinner body profile provides for a more finesse application. The tail is molded as one piece with a molded in parting line so it can be easily cut or torn into two sections if needed. The Slim Critter is a great lure for flipping and pitching heavy cover. It is a very versatile lure that can be rigged Texas, Carolina, Shaky, as a trailer, or on a jig head.



| Size | Lure Dimensions (inches) | | | Single Cavity | | Multi-Cavity | | | Lures per Pack X Cubes | Lures Per Quart Resin |
|--------|--------------------------|-------|--------|---------------|--------|--------------|---------------|---------|------------------------|-----------------------|
| | Length | Width | Height | Part Number | MSRP | Part Number | # of Cavities | MSRP | | |
| 2-1/2" | 2.75" | 0.62" | 0.25" | 5125SC | \$6.41 | 5125MC | 3 | \$11.77 | 29 | 311 |
| 3" | 3.00" | 0.62" | 0.30" | 5130SC | \$6.49 | 5130MC | 3 | \$11.91 | 20 | 221 |
| 3-1/2" | 3.50" | 0.80" | 0.30" | 5135SC | \$6.69 | 5135MC | 3 | \$14.69 | 19 | 205 |
| 4" | 4.00" | 0.84" | 0.33" | 5140SC | 7.05 | 5140MC | 3 | \$15.42 | 13 | 141 |
| 4-1/2" | 4.50" | 1.00" | 0.30" | 5145SC | \$7.24 | 5145MC | 3 | \$17.40 | 13 | 142 |
| 5-1/2" | 5.50" | 1.10" | 0.30" | 5155SC | \$7.99 | 5155MC | 3 | \$19.80 | 8 | 86 |
| 6-1/2" | 6.50" | 0.84" | 0.35" | 5165SC | \$8.39 | 5165MC | 3 | \$21.25 | 8 | 91 |
| 7-1/2" | 7.75" | 0.84" | 0.41" | 5175SC | \$8.88 | 5175MC | 3 | \$24.14 | 6 | 63 |

FX mold

SILICONE OPEN POUR LURE MOLDS

Crazy Critter

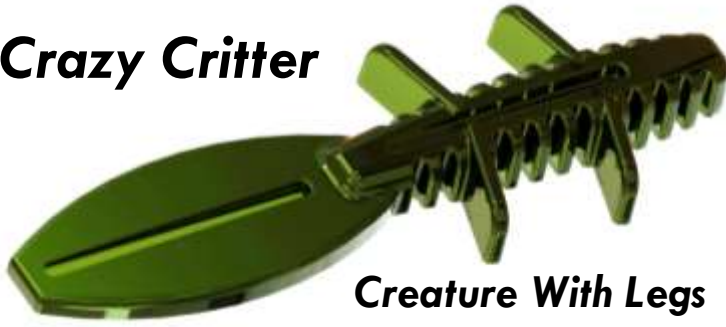

Creature With Legs

Crazy Critter

The CRAZY CRITTER is a broad and flat “beaver” style creature lure. The body shape creates a slow fall and increased action. The Crazy Critter has the addition of 4 legs for increase movement and vibration in the water. The tail is molded as one piece with a molded in parting line so it can be easily cut or torn into two sections if needed. The Crazy Critter is a great lure for flipping and pitching heavy cover. It is a very versatile lure that can be rigged Texas, Carolina, Shaky, as a trailer, or on a jig head.

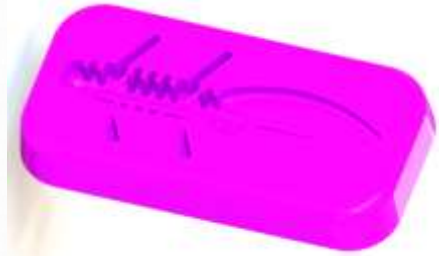

| Size | Lure Dimensions (inches) | | | Single Cavity | | Multi-Cavity | | | Lures per Pack X Cubes | Lures Per Quart Resin |
|--------|--------------------------|-------|--------|---------------|--------|--------------|---------------|---------|------------------------|-----------------------|
| | Length | Width | Height | Part Number | MSRP | Part Number | # of Cavities | MSRP | | |
| 2-1/2" | 2.50" | 1.35" | 0.26" | 5225SC | \$7.08 | 5225MC | 3 | \$15.79 | 25 | 270 |
| 3" | 3.25" | 1.35" | 0.30" | 5230SC | \$7.73 | 5230MC | 3 | \$16.63 | 16 | 168 |
| 3-1/2" | 3.60" | 1.30" | 0.31" | 5235SC | \$7.93 | 5235MC | 3 | \$18.06 | 15 | 159 |
| 4" | 4.00" | 1.30" | 0.35" | 5240SC | \$8.02 | 5240MC | 3 | \$20.39 | 12 | 127 |

FX mold

SILICONE OPEN POUR LURE MOLDS

Flippin' Critter

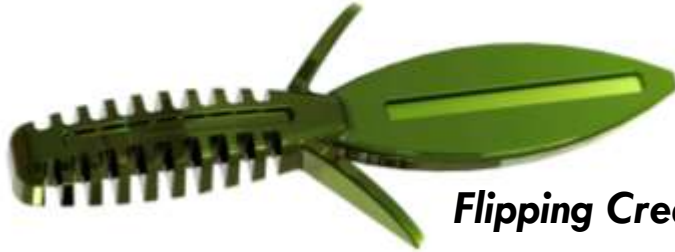

Flipping Creature

Flippin Critter

The FLIPPIN CRITTER is a broad and flat “beaver” style creature lure. The body shape creates a slow fall and increased action. The addition of side fins helps provide increased action as well as slowing the fall rate. The tail is molded as one piece with a molded in parting line so it can be easily cut or torn into two sections if needed. The FLIPPIN CRITTER is a great lure for flipping and pitching heavy cover. It is a very versatile lure that can be rigged Texas, Carolina, Shaky, as a trailer, or on a jig head

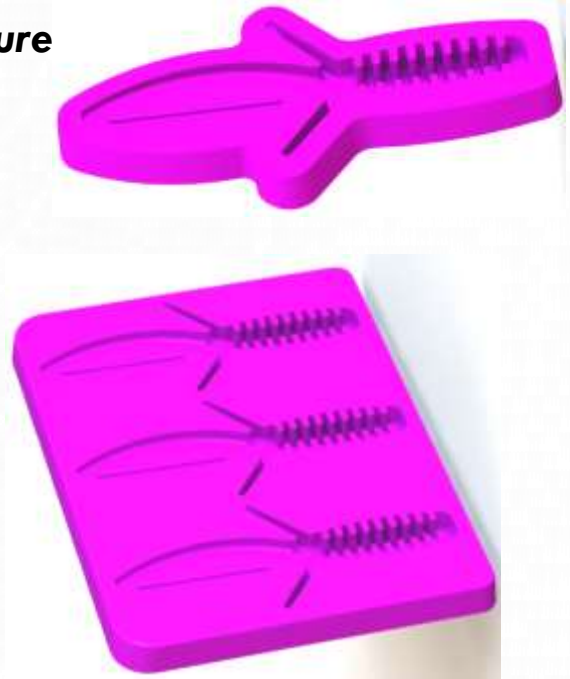

| Size | Lure Dimensions (inches) | | | Single Cavity | | Multi-Cavity | | | Lures per Pack X Cubes | Lures Per Quart Resin |
|--------|--------------------------|-------|--------|---------------|--------|--------------|---------------|---------|------------------------|-----------------------|
| | Length | Width | Height | Part Number | MSRP | Part Number | # of Cavities | MSRP | | |
| 2-1/2" | 2.75" | 1.17" | 0.30" | 5325SC | \$6.79 | 5325MC | 3 | \$14.68 | 21 | 222 |
| 3" | 3.25" | 1.39" | 0.28" | 5330SC | \$7.06 | 5330MC | 3 | \$16.93 | 15 | 159 |
| 3-1/2" | 3.63" | 1.43" | 0.31" | 5335SC | \$7.21 | 5335MC | 3 | \$17.77 | 12 | 134 |
| 4" | 4.00" | 1.92" | 0.32" | 5340SC | \$8.06 | 5340MC | 3 | \$21.94 | 9 | 96 |
| 4-1/2" | 4.50" | 1.92" | 0.38" | 5345SC | \$8.11 | 5345MC | 3 | \$23.52 | 8 | 87 |
| 5" | 5.25" | 2.28" | 0.43" | 5350SC | \$8.85 | 5350MC | 3 | \$28.02 | 4 | 46 |

FX mold

SILICONE OPEN POUR LURE MOLDS

Wacky Eel



Swimming Eel Creature



Wacky Eel The Wacky Eel is a ribbon tail eel lure designed to provide a swimming action when moved through the water. It is a very productive lure for both freshwater and saltwater species. It is best rigged on a jig head, but also works well Texas rigged, drop shot, down shot, or weightless. Many find it to be a really good spinner trailer

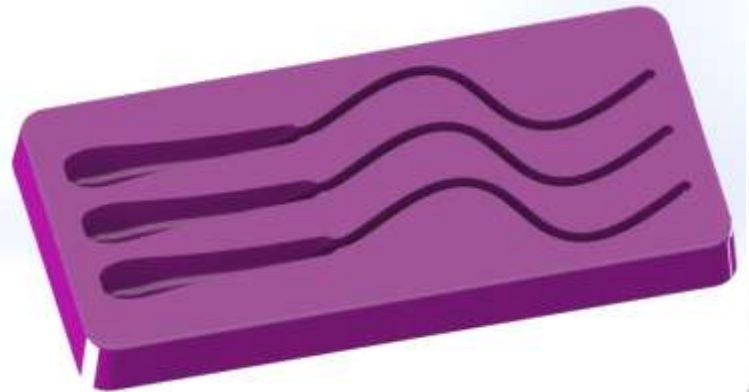

| Size | Lure Dimensions (inches) | | | Single Cavity | | Multi-Cavity | | | Lures per Pack X Cubes | Lures Per Quart Resin |
|------|--------------------------|-------|--------|---------------|---------|--------------|---------------|----------|------------------------|-----------------------|
| | Length | Width | Height | Part Number | MSRP | Part Number | # of Cavities | MSRP | | |
| 3" | 3.25" | 0.40" | 0.31" | 5430SC | \$6.70 | 5430MC | 3 | \$11.86 | 31 | 336 |
| 4" | 4.00" | 0.42" | 0.35" | 5440SC | \$7.31 | 5440MC | 3 | \$14.35 | 20 | 217 |
| 5" | 5.00" | 0.42" | 0.35" | 5450SC | \$7.10 | 5450MC | 3 | \$15.73 | 18 | 190 |
| 6" | 6.00" | 0.55" | 0.46" | 5460SC | \$7.88 | 5460MC | 3 | \$20.40 | 8 | 82 |
| 8" | 8.00" | 0.55" | 0.45" | 5480SC | \$8.44 | 5480MC | 3 | \$26.82 | 6 | 66 |
| 10" | 10.00" | 0.98" | 0.76" | 54100SC | \$15.46 | 54100MC | 3 | \$52.70 | 2 | 21 |
| 12" | 12.00" | 0.99" | 0.76" | 54120SC | \$15.52 | 54120MC | 3 | \$69.19 | 2 | 18 |
| 14" | 14.00" | 0.98" | 1.14" | 54140SC | \$23.09 | 54140MC | 3 | \$116.60 | 1 | 10 |

FX mold

SILICONE OPEN POUR LURE MOLDS

Crazy Hawg



Crazy Leg Creature



Crazy Hawg

The CRAZY HAWG is a curl tail “hog” style creature lure. The body shape and numerous appendages create a slow fall and crazy action. The Crazy Hawg has twin curl tails that create a swimming action on retrieve. The Crazy Hawg is a great lure for flipping and pitching heavy cover. It is a very versatile lure that can be rigged Texas, Carolina, Shaky, as a trailer, or on a jig head

| Size | Lure Dimensions (inches) | | | Single Cavity | | Multi-Cavity | | | Lures per Pack X Cubes | Lures Per Quart Resin |
|--------|--------------------------|-------|--------|---------------|---------|--------------|---------------|---------|------------------------|-----------------------|
| | Length | Width | Height | Part Number | MSRP | Part Number | # of Cavities | MSRP | | |
| 2" | 2.25" | 1.00" | 0.26" | 5520SC | \$6.45 | 5520MC | 3 | \$11.38 | 26 | 282 |
| 2-1/2" | 2.63" | 1.00" | 0.26" | 5525SC | \$6.49 | 5525MC | 3 | \$12.33 | 25 | 267 |
| 3" | 3.25" | 1.63" | 0.35" | 5530SC | \$7.54 | 5530MC | 3 | \$15.37 | 12 | 126 |
| 3-1/2" | 3.50" | 2.05" | 0.31" | 5535SC | \$7.74 | 5535MC | 3 | \$17.43 | 14 | 155 |
| 4" | 4.00" | 1.99" | 0.32" | 5540SC | \$8.32 | 5540MC | 3 | \$19.98 | 11 | 121 |
| 4-1/2" | 4.40" | 2.32" | 0.34" | 5545SC | \$8.54 | 5545MC | 3 | \$20.80 | 9 | 94 |
| 5" | 5.00" | 2.73" | 0.38" | 5550SC | \$9.91 | 5550MC | 3 | \$37.23 | 5 | 59 |
| 6" | 6.00" | 3.00" | 0.38" | 5560SC | \$10.96 | 5560MC | 3 | \$44.43 | 6 | 65 |
| 8" | 7.75" | 3.50" | 0.38" | 5580SC | \$16.79 | 5580MC | 3 | \$69.74 | 3 | 30 |

FX mold

SILICONE OPEN POUR LURE MOLDS

Spider SX



Skirted Swim Creature



Spider SX

The SPIDER SX is a twin tail creature lure with side tentacles that create a lifelike moving action even when sitting still. It has twin swimming curl tails to create a swimming action on retrieve. It has side wings that are molded as one piece and can either be left as one piece to slow the fall rate or slit into fine tentacles to create a more lifelike action. The Spider SX is best rigged on a jig head or Texas rigged.

| Size | Lure Dimensions (inches) | | | Single Cavity | | Multi-Cavity | | | Lures per Pack X Cubes | Lures Per Quart Resin |
|--------|--------------------------|-------|--------|---------------|---------|--------------|---------------|---------|------------------------|-----------------------|
| | Length | Width | Height | Part Number | MSRP | Part Number | # of Cavities | MSRP | | |
| 2" | 2.00" | 1.50" | 0.33" | 5620SC | \$6.47 | 5620MC | 3 | \$11.94 | 35 | 376 |
| 2-1/2" | 2.50" | 1.50" | 0.28" | 5625SC | \$7.22 | 5625MC | 3 | \$14.12 | 23 | 246 |
| 3" | 3.00" | 2.00" | 0.36" | 5630SC | \$7.65 | 5630MC | 3 | \$17.42 | 12 | 130 |
| 3-1/2" | 3.63" | 2.27" | 0.36" | 5635SC | \$8.52 | 5635MC | 3 | \$22.39 | 9 | 102 |
| 4" | 4.25" | 3.00" | 0.42" | 5640SC | \$10.98 | 5640MC | 3 | \$37.78 | 5 | 54 |
| 4-1/2" | 4.60" | 3.55" | 0.38" | 5645SC | \$10.97 | 5645MC | 3 | \$30.61 | 5 | 54 |

FX mold

SILICONE OPEN POUR LURE MOLDS

Spider PX



Skirted Creature Craw

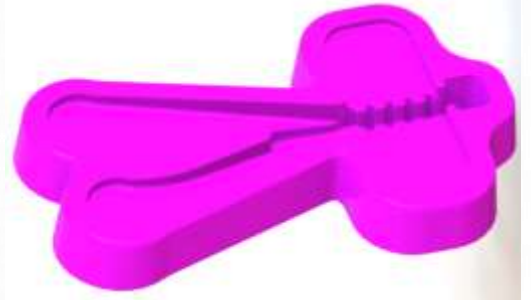

Spider PX

The SPIDER PX is a paddle tail creature lure with side tentacles that create a lifelike moving action even when sitting still. It has twin paddle tails to create a slow waving action in the water. It has side wings that are molded as one piece and can either be left as one piece to slow the fall rate or slit into fine tentacles to create a more lifelike action. The Spider PX is best rigged on a jig head or Texas rigged.



| Size | Lure Dimensions (inches) | | | Single Cavity | | Multi-Cavity | | | Lures per Pack X Cubes | Lures Per Quart Resin |
|--------|--------------------------|-------|--------|---------------|---------|--------------|---------------|---------|------------------------|-----------------------|
| | Length | Width | Height | Part Number | MSRP | Part Number | # of Cavities | MSRP | | |
| 2" | 2.00" | 1.50" | 0.32" | 5720SC | \$6.49 | 5720MC | 3 | \$11.24 | 41 | 444 |
| 2-1/2" | 2.50" | 1.75" | 0.33" | 5725SC | \$6.85 | 5725MC | 3 | \$15.01 | 26 | 277 |
| 3" | 3.15" | 1.75" | 0.36" | 5730SC | \$7.46 | 5730MC | 3 | \$18.20 | 13 | 137 |
| 3-1/2" | 3.65" | 2.00" | 0.40" | 5735SC | \$8.36 | 5735MC | 3 | \$22.87 | 10 | 106 |
| 4" | 4.15" | 2.77" | 0.45" | 5740SC | \$10.43 | 5740MC | 3 | \$33.32 | 7 | 73 |
| 4-1/2" | 4.74" | 2.73" | 0.42" | 5745SC | \$10.96 | 5745MC | 3 | \$37.13 | 6 | 61 |

FX mold

SILICONE OPEN POUR LURE MOLDS

X-Skirt



X-SKIRT

The X SKIRT is a soft plastic skirt lure designed to be placed ahead of another plastic lure to create a jig style lure. The X Skirt is molded with 6 broad tentacles that can be left as molded or slit into more fine tentacles to create a different action. The X Skirt opens up the playbook for creating an infinite amount of unique lure combinations



| Size | Lure Dimensions (inches) | | | Single Cavity | | Multi-Cavity | | | Lures per Pack X Cubes | Lures Per Quart Resin |
|--------|--------------------------|-------|--------|---------------|--------|--------------|---------------|---------|------------------------|-----------------------|
| | Length | Width | Height | Part Number | MSRP | Part Number | # of Cavities | MSRP | | |
| 2" | 2.00" | 2.00" | 0.20" | 5820SC | \$6.03 | 5820MC | 3 | \$11.00 | 47 | 509 |
| 2-1/2" | 2.25" | 2.25" | 0.25" | 5825SC | \$6.93 | 5825MC | 3 | \$13.98 | 38 | 412 |
| 3" | 3.00" | 3.00" | 0.35" | 5830SC | \$7.48 | 5830MC | 3 | \$16.24 | 19 | 204 |
| 3-1/2" | 3.50" | 3.50" | 0.35" | 5835SC | \$8.78 | 5835MC | 3 | \$26.95 | 7 | 78 |
| 4" | 4.00" | 4.00" | 0.38" | 5840SC | \$9.29 | 5840MC | 3 | \$27.13 | 6 | 61 |

FX mold

SILICONE OPEN POUR LURE MOLDS

X-Sting



Paddle Tail Creature

X-Sting

The X-Sting is a narrow and flat “beaver” style creature lure. The body shape creates a slow fall and increased action. The X-Sting has a much smaller tail profile than other lures of this style. The X-Sting Critter is a great lure for flipping and pitching heavy cover. It is a very versatile lure that can be rigged Texas, Carolina, Shaky, as a trailer, or on a jig head. The X-Sting also excels as a drop shot lure in many applications.

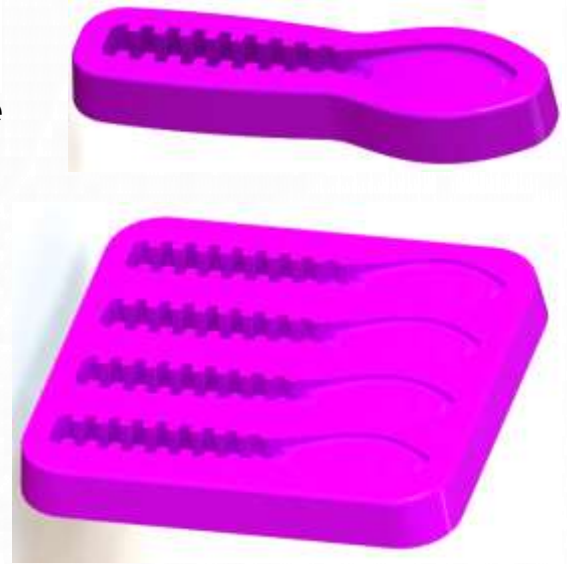

| Size | Lure Dimensions (inches) | | | Single Cavity | | Multi-Cavity | | | Lures per Pack X Cubes | Lures Per Quart Resin |
|--------|--------------------------|-------|--------|---------------|--------|--------------|---------------|---------|------------------------|-----------------------|
| | Length | Width | Height | Part Number | MSRP | Part Number | # of Cavities | MSRP | | |
| 1-1/2" | 1.63" | 0.44" | 0.28" | 5915SC | \$5.48 | 5915MC | 3 | \$9.25 | 67 | 727 |
| 2" | 2.00" | 0.57" | 0.31" | 5920SC | \$5.73 | 5920MC | 3 | \$10.12 | 40 | 428 |
| 2-1/2" | 2.50" | 0.63" | 0.31" | 5925SC | \$5.87 | 5925MC | 3 | \$11.24 | 30 | 326 |
| 3" | 3.00" | 0.65" | 0.35" | 5930SC | \$6.18 | 5930MC | 3 | \$13.38 | 21 | 229 |
| 3-1/2" | 3.50" | 0.68" | 0.38" | 5935SC | \$6.49 | 5935MC | 3 | \$14.36 | 16 | 177 |
| 4" | 4.00" | 0.73" | 0.41" | 5940SC | \$6.79 | 5940MC | 3 | \$18.08 | 13 | 135 |
| 5" | 5.00" | 0.73" | 0.41" | 5950SC | \$7.15 | 5950MC | 3 | \$20.28 | 9 | 98 |
| 6" | 6.25" | 0.94" | 0.42" | 5960SC | \$7.89 | 5960MC | 3 | \$24.07 | 6 | 69 |
| 8" | 8.00" | 0.93" | 0.48" | 5980SC | \$9.36 | 5980MC | 3 | \$36.19 | 4 | 46 |

FX mold

SILICONE OPEN POUR LURE MOLDS

PX Drop



Paddle Tail Drop Shot

PX DROP

The PX DROP is a slim body paddle tail drop shot lure designed for an enticing action in the water. The PX Drop is a very effective cleat water drop shot lure. It is versatile enough to be rigged Texas, shaky head, or on a jig head as well

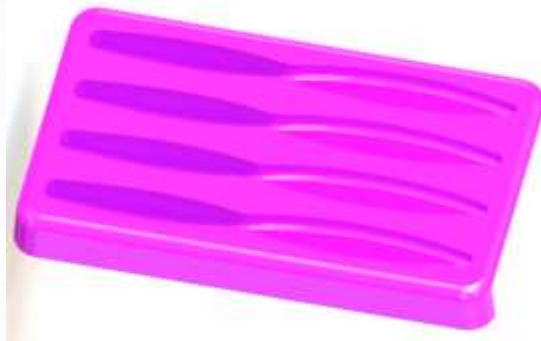

| Size | Lure Dimensions (inches) | | | Single Cavity | | Multi-Cavity | | | Lures per Pack X Cubes | Lures Per Quart Resin |
|------|--------------------------|-------|--------|---------------|--------|--------------|---------------|---------|------------------------|-----------------------|
| | Length | Width | Height | Part Number | MSRP | Part Number | # of Cavities | MSRP | | |
| 2" | 2.12" | 0.25" | 0.27" | 6020SC | \$5.40 | 6020MC | 3 | \$8.26 | 77 | 833 |
| 3" | 2.75" | 0.28" | 0.25" | 6030SC | \$5.76 | 6030MC | 3 | \$9.40 | 45 | 488 |
| 4" | 3.80" | 0.20" | 0.20" | 6040SC | \$6.08 | 6040MC | 3 | \$11.16 | 25 | 266 |
| 5" | 4.60" | 0.20" | 0.20" | 6050SC | \$6.74 | 6050MC | 3 | \$13.06 | 17 | 189 |
| 6" | 5.78" | 0.46" | 0.35" | 6060SC | \$7.03 | 6060MC | 3 | \$14.08 | 14 | 148 |
| 8" | 7.78" | 0.64" | 0.38" | 6080SC | \$7.89 | 6080MC | 3 | \$20.26 | 7 | 77 |

FX mold

SILICONE OPEN POUR LURE MOLDS

Slim Drop



Straight Tail Drop Shot



SLIM DROP

The SLIM DROP is a slim body drop shot lure with a narrow tail designed for an enticing action in the water. The Slim Drop is a very effective clear water drop shot lure. It is versatile enough to be rigged Texas, shaky head, or on a jig head as well.

| Size | Lure Dimensions (inches) | | | Single Cavity | | Multi-Cavity | | | Lures per Pack X Cubes | Lures Per Quart Resin |
|--------|--------------------------|-------|--------|---------------|--------|--------------|---------------|---------|------------------------|-----------------------|
| | Length | Width | Height | Part Number | MSRP | Part Number | # of Cavities | MSRP | | |
| 2" | 2.00" | 0.24" | 0.24" | 6120SC | \$5.34 | 6120MC | 3 | \$8.23 | 100 | 1076 |
| 2-1/2" | 2.63" | 0.28" | 0.28" | 6125SC | \$5.48 | 6125MC | 3 | \$8.73 | 62 | 667 |
| 3-1/2" | 3.25" | 0.28" | 0.31" | 6135SC | \$5.83 | 6135MC | 3 | \$10.25 | 47 | 502 |
| 4-1/2" | 4.25" | 0.30" | 0.32" | 6145SC | \$6.21 | 6145MC | 3 | \$10.87 | 28 | 306 |
| 5-1/2" | 5.50" | 0.32" | 0.34" | 6155SC | \$6.59 | 6155MC | 3 | \$12.61 | 19 | 202 |
| 6-1/2" | 6.50" | 0.35" | 0.35" | 6165SC | \$6.91 | 6165MC | 3 | \$13.74 | 14 | 149 |
| 8-1/2" | 8.50" | 0.38" | 0.37" | 6185SC | \$7.47 | 6185MC | 3 | \$15.29 | 9 | 94 |

FX mold

SILICONE OPEN POUR LURE MOLDS

Flutter Drop



Drop Shot Creature



FLUTTER DROP

The FLUTTER DROP is a slim body paddle tail drop shot lure designed for an enticing action in the water. The addition of 4 legs and thin wings on the tail give this lure a very unique fluttering action. The Flutter Drop is a very effective clear water drop shot lure. It is versatile enough to be rigged Texas, shaky head, or on a jig head as well.



| Size | Lure Dimensions (inches) | | | Single Cavity | | Multi-Cavity | | | Lures per Pack X Cubes | Lures Per Quart Resin |
|--------|--------------------------|-------|--------|---------------|--------|--------------|---------------|---------|------------------------|-----------------------|
| | Length | Width | Height | Part Number | MSRP | Part Number | # of Cavities | MSRP | | |
| 2" | 2.25" | 0.75" | 0.29" | 6220SC | \$5.98 | 6220MC | 3 | \$10.22 | 49 | 529 |
| 2-1/2" | 2.50" | 0.75" | 0.28" | 6225SC | \$6.30 | 6225MC | 3 | \$10.24 | 50 | 539 |
| 3" | 2.88" | 1.00" | 0.28" | 6230SC | \$6.33 | 6230MC | 3 | \$12.61 | 30 | 322 |
| 3-1/2" | 3.50" | 1.13" | 0.31" | 6235SC | \$6.64 | 6235MC | 3 | \$15.03 | 24 | 264 |
| 4" | 3.88" | 1.50" | 0.28" | 6240SC | \$6.95 | 6240MC | 3 | \$17.16 | 19 | 207 |
| 4-1/2" | 4.62" | 1.50" | 0.30" | 6245SC | \$7.01 | 6245MC | 3 | \$18.72 | 14 | 151 |

FX mold

SILICONE OPEN POUR LURE MOLDS

Sweet Drop



Paddle Tail Drop Shot

Sweet Drop

The Sweet Drop is a slim body paddle tail drop shot lure designed for an enticing action in the water. The Sweet Drop is a very effective cleat water drop shot lure. It is versatile enough to be rigged Texas, shaky head, or on a jig head as well



| Size | Lure Dimensions (inches) | | | Single Cavity | | Multi-Cavity | | | Lures per Pack X Cubes | Lures Per Quart Resin |
|--------|--------------------------|-------|--------|---------------|--------|--------------|---------------|---------|------------------------|-----------------------|
| | Length | Width | Height | Part Number | MSRP | Part Number | # of Cavities | MSRP | | |
| 2" | 2.63" | 0.28" | 0.28" | 6320SC | \$5.94 | 6320SC | 4 | \$9.35 | 44 | 478 |
| 2-1/2" | 2.85" | 0.28" | 0.28" | 6325SC | \$6.00 | 6325SC | 4 | \$9.68 | 43 | 464 |
| 3" | 3.38" | 0.30" | 0.30" | 6330SC | \$6.15 | 6330SC | 4 | \$10.56 | 29 | 310 |
| 3-1/2" | 3.75" | 0.33" | 0.33" | 6335SC | \$6.25 | 6335SC | 4 | \$11.24 | 25 | 273 |
| 4" | 4.25" | 0.38" | 0.35" | 6340SC | \$6.40 | 6340SC | 4 | \$12.99 | 16 | 169 |
| 4-1/2" | 4.75" | 0.38" | 0.35" | 6345SC | \$6.53 | 6345SC | 4 | \$14.07 | 15 | 159 |
| 5" | 5.25" | 0.39" | 0.35" | 6350SC | \$6.67 | 6350SC | 4 | \$14.87 | 13 | 141 |
| 6" | 6.25" | 0.40" | 0.38" | 6360SC | \$7.24 | 6360SC | 4 | \$17.02 | 9 | 100 |
| 8" | 8.25" | 0.45" | 0.41" | 6380SC | \$8.61 | 6380SC | 4 | \$22.29 | 6 | 70 |

FX mold

SILICONE OPEN POUR LURE MOLDS

Sweep X

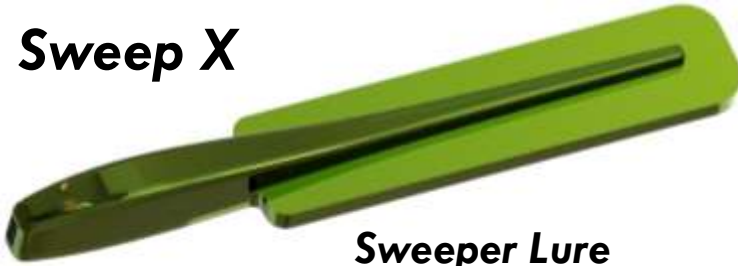

Sweeper Lure

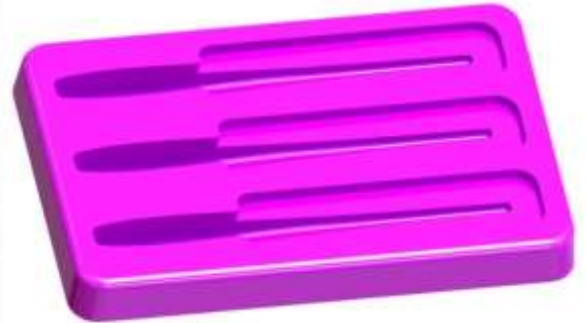

SWEEP X

The SWEEP X is a broad tail “sweeper” style lure. The tail is molded as a single piece and can be left alone or slit into thin strips for a different action. When the tail is slit into tentacles the lure has a very lifelike appearance when sitting still as the tentacles move in the current. The Sweep X can be rigged in a number of methods including Texas, Carolina, drop shot, shaky head, and on a jig head.

| Size | Lure Dimensions (inches) | | | Single Cavity | | Multi-Cavity | | | Lures per Pack X Cubes | Lures Per Quart Resin |
|------|--------------------------|-------|--------|---------------|--------|--------------|---------------|---------|------------------------|-----------------------|
| | Length | Width | Height | Part Number | MSRP | Part Number | # of Cavities | MSRP | | |
| 2" | 2.25" | 0.38" | 0.27" | 6420SC | \$5.64 | 6420MC | 3 | \$8.35 | 49 | 532 |
| 3" | 3.25" | 0.50" | 0.31" | 6430SC | \$6.12 | 6430MC | 3 | \$10.56 | 26 | 281 |
| 4" | 3.75" | 0.63" | 0.33" | 6440SC | \$6.46 | 6440MC | 3 | 11.66 | 19 | 207 |
| 5" | 4.75" | 0.63" | 0.33" | 6450SC | \$6.76 | 6450MC | 3 | \$12.62 | 12 | 129 |
| 6" | 6.00" | 0.66" | 0.35" | 6460SC | \$7.38 | 6460MC | 3 | \$14.35 | 10 | 112 |
| 8" | 7.75" | 0.81" | 0.38" | 6480SC | \$8.97 | 6480MC | 3 | \$22.29 | 6 | 62 |

FX mold

SILICONE OPEN POUR LURE MOLDS

Sweep RX



Ribbed Body Sweeper Lure

SWEEP RX

The Sweep RX is a broad tail “sweeper” style lure with the addition of a ribbed body for increased bulk and vibration. The tail is molded as a single piece and can be left alone or slit into thin strips for a different action.



| Size | Lure Dimensions (inches) | | | Single Cavity | | Multi-Cavity | | | Lures per Pack X Cubes | Lures Per Quart Resin |
|--------|--------------------------|-------|--------|---------------|---------|--------------|---------------|---------|------------------------|-----------------------|
| | Length | Width | Height | Part Number | MSRP | Part Number | # of Cavities | MSRP | | |
| 2-1/2" | 2.25" | 0.63" | 0.39" | 6525SC | \$6.61 | 6525MC | 3 | \$10.35 | 34 | 369 |
| 3-1/2" | 3.25" | 0.75" | 0.44" | 6535SC | \$7.65 | 6535MC | 3 | \$13.20 | 16 | 178 |
| 4-1/2" | 4.50" | 0.88" | 0.46" | 6545SC | \$8.96 | 6545MC | 3 | \$17.76 | 10 | 103 |
| 5-1/2" | 5.50" | 0.92" | 0.42" | 6555SC | \$9.75 | 6555MC | 3 | \$20.24 | 7 | 77 |
| 6-1/2" | 6.50" | 0.92" | 0.49" | 6565SC | \$10.40 | 6565MC | 3 | \$22.16 | 6 | 61 |

FX mold

SILICONE OPEN POUR LURE MOLDS

Goby Drop



Goby Lure

Goby Drop

The Goby Drop is a paddle tail dropshot lure with a goby shaped body. The Goby Drop is a true smallmouth killer in the great lakes when drop shot rigged.



| Size | Lure Dimensions (inches) | | | Single Cavity | | Multi-Cavity | | | Lures per Pack X Cubes | Lures Per Quart Resin |
|--------|--------------------------|-------|--------|---------------|---------|--------------|---------------|---------|------------------------|-----------------------|
| | Length | Width | Height | Part Number | MSRP | Part Number | # of Cavities | MSRP | | |
| 2-1/2" | 2.44" | 0.77" | 0.30" | 6625SC | \$6.03 | 6625MC | 3 | \$10.01 | 49 | 525 |
| 3" | 3.20" | 1.06" | 0.32" | 6630SC | \$6.49 | 6630MC | 3 | \$11.80 | 29 | 312 |
| 3-1/2" | 3.58" | 1.15" | 0.33" | 6635SC | \$6.69 | 6635MC | 3 | \$12.54 | 23 | 250 |
| 4" | 4.03" | 1.34" | 0.40" | 6640SC | \$7.10 | 6640MC | 3 | \$14.21 | 17 | 178 |
| 5" | 4.95" | 1.55" | 0.53" | 6650SC | \$8.24 | 6650MC | 3 | \$18.43 | 9 | 99 |
| 6" | 5.95" | 1.67" | 0.55" | 6660SC | \$8.84 | 6660MC | 3 | \$20.65 | 7 | 80 |
| 8" | 7.67" | 1.75" | 0.71" | 6680SC | \$11.52 | 6680MC | 3 | \$31.04 | 4 | 46 |

FX mold

SILICONE OPEN POUR LURE MOLDS

Shaky Eel



Eel Lure



Shaky Eel

The SHAKY EEL is a slim body drop shot lure with a narrow tail designed for an enticing action in the water. The SHAKY EEL is a very effective clear water drop shot lure. It is versatile enough to be rigged Texas, shaky head, or on a jig head as well.

| Size | Lure Dimensions (inches) | | | Single Cavity | | Multi-Cavity | | | Lures per Pack X Cubes | Lures Per Quart Resin |
|---------|--------------------------|-------|--------|---------------|---------|--------------|---------------|---------|------------------------|-----------------------|
| | Length | Width | Height | Part Number | MSRP | Part Number | # of Cavities | MSRP | | |
| 2-1/2" | 2.50" | 0.35" | 0.35" | 6725SC | \$6.14 | 6725MC | 3 | \$11.30 | 41 | 447 |
| 3" | 3.00" | 0.36" | 0.33" | 6730SC | \$6.25 | 6730MC | 3 | \$11.94 | 35 | 377 |
| 3-1/2" | 3.63" | 0.39" | 0.43" | 6735SC | \$6.56 | 6735MC | 3 | \$13.81 | 21 | 230 |
| 4" | 4.00" | 0.39" | 0.41" | 6740SC | \$6.69 | 6740MC | 3 | \$14.79 | 20 | 212 |
| 4-1/2" | 4.50" | 0.42" | 0.49" | 6745SC | \$7.04 | 6745MC | 3 | \$16.14 | 15 | 162 |
| 5" | 5.00" | 0.42" | 0.47" | 6750SC | \$7.19 | 6750MC | 3 | \$17.03 | 14 | 150 |
| 5-1/2" | 5.25" | 0.42" | 0.49" | 6755SC | \$7.29 | 6755MC | 3 | \$17.39 | 13 | 137 |
| 6-1/2" | 6.50" | 0.45" | 0.58" | 6765SC | \$8.51 | 6765MC | 3 | \$23.33 | 8 | 85 |
| 8-1/2" | 8.25" | 0.47" | 0.58" | 6785SC | \$9.51 | 6785MC | 3 | \$30.40 | 6 | 60 |
| 10-1/2" | 10.50" | 0.53" | 0.66" | 67105SC | \$10.50 | 67105MC | 3 | \$40.56 | 4 | 41 |

FX mold

SILICONE OPEN POUR LURE MOLDS

Rib Darter



Rib Body Drop Shot



Rib Darter

The RIB DARTER is a new twist on drop shot lures. It combines a broad body with ribs to create extra vibration and bulk as well as a thin straight tail for a tantalizing action. The Rib Darter also works great on a jig head, shaky head, Ned Rig, or Texas rig.

| Size | Lure Dimensions (inches) | | | Single Cavity | | Multi-Cavity | | | Lures per Pack X Cubes | Lures Per Quart Resin |
|--------|--------------------------|-------|--------|---------------|--------|--------------|---------------|---------|------------------------|-----------------------|
| | Length | Width | Height | Part Number | MSRP | Part Number | # of Cavities | MSRP | | |
| 1-1/2" | 1.50" | 0.31" | 0.26" | 6815SC | \$5.80 | 6815SC | 3 | \$9.00 | 118 | 1278 |
| 2" | 2.00" | 0.38" | 0.31" | 6820SC | \$6.05 | 6820SC | 3 | \$10.22 | 69 | 748 |
| 2-1/2" | 2.50" | 0.43" | 0.36" | 6825SC | \$6.74 | 6825SC | 3 | \$11.25 | 38 | 414 |
| 3" | 3.00" | 0.51" | 0.39" | 6830SC | \$7.04 | 6830SC | 3 | \$12.92 | 24 | 259 |
| 3-1/2" | 3.50" | 0.46" | 0.39" | 6835SC | \$7.26 | 6835SC | 3 | \$13.65 | 22 | 236 |
| 4" | 4.00" | 0.56" | 0.44" | 6840SC | \$7.62 | 6840SC | 3 | \$15.89 | 14 | 154 |
| 4-1/2" | 4.50" | 0.56" | 0.45" | 6845SC | \$7.86 | 6845SC | 3 | \$16.82 | 13 | 139 |
| 5" | 5.00" | 0.56" | 0.46" | 6850SC | \$8.09 | 6850SC | 3 | \$17.71 | 11 | 123 |
| 6" | 6.00" | 0.62" | 0.49" | 6860SC | \$8.64 | 6860SC | 3 | \$19.34 | 8 | 87 |
| 8" | 8.00" | 0.65" | 0.52" | 6880SC | \$9.29 | 6880SC | 3 | \$22.22 | 5 | 53 |

FX mold

SILICONE OPEN POUR LURE MOLDS

ChunX



Chunk Style Trailer



ChunX

The CHUNX trailer is a standard “chunk” style jig trailer. It has been the most popular type of jig trailer for over 50 years. The simple design creates a subtle action in the water that mimics both the movement of a crawfish and the movement of an injured bait fish



| Size | Lure Dimensions (inches) | | | Single Cavity | | Multi-Cavity | | | Lures per Pack X Cubes | Lures Per Quart Resin |
|--------|--------------------------|-------|--------|---------------|--------|--------------|---------------|---------|------------------------|-----------------------|
| | Length | Width | Height | Part Number | MSRP | Part Number | # of Cavities | MSRP | | |
| 1-1/2" | 1.25" | 0.59" | 0.24" | 7015SC | \$5.38 | 7015SC | 3 | \$8.12 | 68 | 739 |
| 2" | 1.75" | 0.67" | 0.28" | 7020SC | \$5.64 | 7020SC | 3 | \$8.93 | 34 | 369 |
| 2-1/2" | 2.25" | 1.00" | 0.28" | 7025SC | \$5.99 | 7025SC | 3 | \$9.86 | 17 | 185 |
| 3" | 2.63" | 1.16" | 0.30" | 7030SC | \$6.16 | 7030SC | 3 | \$11.62 | 13 | 142 |
| 3-1/2" | 3.00" | 1.35" | 0.35" | 7035SC | \$6.85 | 7035SC | 3 | \$13.81 | 9 | 93 |
| 4" | 3.75" | 1.44" | 0.44" | 7040SC | \$8.22 | 7040SC | 3 | \$18.26 | 4 | 47 |

FX mold

SILICONE OPEN POUR LURE MOLDS

XTrailer



Split Tail Trailer

Xtrailer

The X Trailer is a straight tail trailer that works great for spinner baits, buzz baits, and chatter baits. It is molded with a single straight tail that can be split into two sections to create a split tail trailer.

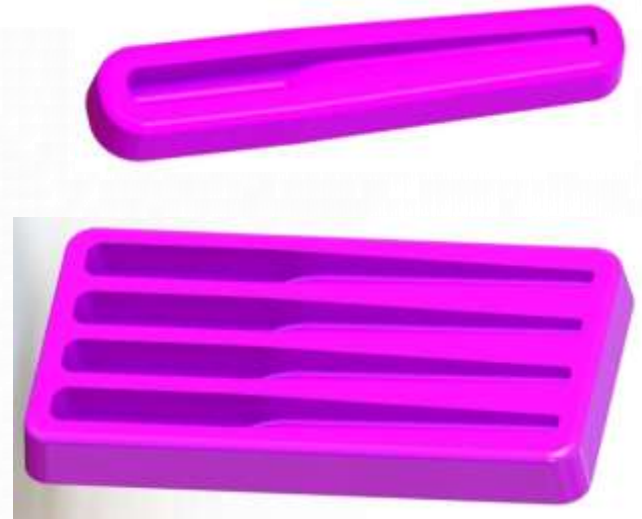

| Size | Lure Dimensions (inches) | | | Single Cavity | | Multi-Cavity | | | Lures per Pack X Cubes | Lures Per Quart Resin |
|--------|--------------------------|-------|--------|---------------|--------|--------------|---------------|---------|------------------------|-----------------------|
| | Length | Width | Height | Part Number | MSRP | Part Number | # of Cavities | MSRP | | |
| 1-1/2" | 1.85" | 0.24" | 0.22" | 7115SC | \$5.38 | 7115SC | 3 | \$8.20 | 96 | 1033 |
| 2" | 2.25" | 0.22" | 0.27" | 7120SC | \$5.46 | 7120SC | 3 | \$8.44 | 69 | 749 |
| 2-1/2" | 2.61" | 0.26" | 0.27" | 7125SC | \$5.51 | 7125SC | 3 | \$8.58 | 48 | 518 |
| 3" | 2.75" | 0.25" | 0.30" | 7130SC | \$5.75 | 7130SC | 3 | \$8.97 | 46 | 494 |
| 3-1/2" | 3.63" | 0.32" | 0.38" | 7135SC | \$6.21 | 7135SC | 3 | \$10.87 | 20 | 219 |
| 4" | 4.25" | 0.38" | 0.40" | 7140SC | \$6.39 | 7140SC | 3 | \$12.41 | 15 | 161 |
| 4-1/2" | 4.60" | 0.42" | 0.33" | 7145SC | \$6.52 | 7145SC | 3 | \$12.86 | 14 | 147 |
| 5" | 5.20" | 0.47" | 0.38" | 7150SC | \$6.68 | 7150SC | 3 | \$13.25 | 11 | 115 |
| 6" | 5.75" | 0.41" | 0.41" | 7160SC | \$7.46 | 7160SC | 3 | \$14.21 | 10 | 106 |
| 8" | 7.75" | 0.42" | 0.35" | 7180SC | \$8.24 | 7180SC | 3 | \$16.78 | 9 | 93 |
| 10" | 9.75" | 0.45" | 0.38" | 71100SC | \$8.97 | 71100SC | 3 | \$18.50 | 5 | 58 |

FX mold

SILICONE OPEN POUR LURE MOLDS

Swim XTrailer



Curl Tail Chunk Trailer

Swim Xtrailer

The Swim X Trailer is a “chunk” style jig trailer with the addition of two curled swimming legs for extra action. It works great for all jig applications and especially well for swimming jigs and chatter baits.



| Size | Lure Dimensions (inches) | | | Single Cavity | | Multi-Cavity | | | Lures per Pack X Cubes | Lures Per Quart Resin |
|--------|--------------------------|-------|--------|---------------|--------|--------------|---------------|---------|------------------------|-----------------------|
| | Length | Width | Height | Part Number | MSRP | Part Number | # of Cavities | MSRP | | |
| 1-1/2" | 1.25" | 0.77" | 0.26" | 7215SC | \$5.50 | 7215MC | 3 | \$8.58 | 88 | 953 |
| 2" | 1.75" | 1.06" | 0.29" | 7220SC | \$5.73 | 7220MC | 3 | \$9.95 | 31 | 336 |
| 2-1/2" | 2.25" | 1.50" | 0.30" | 7225SC | \$6.32 | 7225MC | 3 | \$12.50 | 20 | 211 |
| 3" | 2.75" | 1.57" | 0.30" | 7230SC | \$6.57 | 7230MC | 3 | \$13.97 | 11 | 117 |
| 3-1/2" | 3.38" | 2.07" | 0.35" | 7235SC | \$7.30 | 7235MC | 3 | \$19.25 | 7 | 72 |

FX mold

SILICONE OPEN POUR LURE MOLDS

XR Trailer



Swim Tail Chunk Trailer



XR Trailer

The XR Trailer is a “chunk” style jig trailer with the addition of two swimming legs for extra action. It works great for all jig applications and especially well for swimming jigs and chatter baits.

| Size | Lure Dimensions (inches) | | | Single Cavity | | Multi-Cavity | | | Lures per Pack X Cubes | Lures Per Quart Resin |
|--------|--------------------------|-------|--------|---------------|--------|--------------|---------------|---------|------------------------|-----------------------|
| | Length | Width | Height | Part Number | MSRP | Part Number | # of Cavities | MSRP | | |
| 2" | 1.99" | 1.34" | 0.27" | 7320SC | \$5.91 | 7320MC | 3 | \$10.28 | 26 | 281 |
| 2-1/2" | 2.24" | 1.63" | 0.29" | 7325SC | \$6.19 | 7325MC | 3 | \$11.31 | 19 | 204 |
| 3" | 2.76" | 1.90" | 0.31" | 7330SC | \$6.71 | 7330MC | 3 | \$13.22 | 13 | 142 |
| 3-1/2" | 3.22" | 2.35" | 0.35" | 7335SC | \$8.32 | 7335MC | 3 | \$19.39 | 8 | 85 |

FX mold

SILICONE OPEN POUR LURE MOLDS

Twin Swim



Curl Tail Trailer

Twin Swim

The TWIN SWIM is a twin curl tail trailer lure designed to create lots of vibration with two swimming legs. It makes a great trailer for jigs and works great paired with an X Skirt.



| Size | Lure Dimensions (inches) | | | Single Cavity | | Multi-Cavity | | | Lures per Pack X Cubes | Lures Per Quart Resin |
|--------|--------------------------|-------|--------|---------------|---------|--------------|---------------|---------|------------------------|-----------------------|
| | Length | Width | Height | Part Number | MSRP | Part Number | # of Cavities | MSRP | | |
| 1-1/2" | 1.50" | 0.88" | 0.24" | 7415SC | \$5.54 | 7415MC | 3 | \$8.71 | 106 | 1142 |
| 2" | 1.75" | 1.00" | 0.27" | 7420SC | \$5.66 | 7420MC | 3 | \$9.88 | 72 | 778 |
| 2-1/2" | 2.25" | 1.27" | 0.27" | 7425SC | \$6.03 | 7425MC | 3 | \$10.01 | 31 | 339 |
| 3" | 2.75" | 1.26" | 0.30" | 7430SC | \$6.19 | 7430MC | 3 | \$10.95 | 24 | 260 |
| 3-1/2" | 3.25" | 1.87" | 0.34" | 7435SC | \$7.27 | 7435MC | 3 | \$13.58 | 17 | 187 |
| 4" | 3.75" | 1.98" | 0.34" | 7440SC | \$7.53 | 7440MC | 3 | \$17.19 | 10 | 111 |
| 4-1/2" | 4.25" | 1.99" | 0.32" | 7445SC | \$8.08 | 7445MC | 3 | \$18.26 | 9 | 99 |
| 5" | 4.75" | 2.00" | 0.37" | 7450SC | \$9.17 | 7450MC | 3 | \$25.24 | 8 | 82 |
| 6" | 5.75" | 2.13" | 0.39" | 7460SC | \$10.70 | 7460MC | 3 | \$30.56 | 5 | 57 |
| 7" | 6.75" | 2.18" | 0.42" | 7470SC | \$11.33 | 7470MC | 3 | \$34.07 | 4 | 42 |
| 8" | 7.50" | 2.55" | 0.44" | 7480SC | \$12.39 | 7480MC | 3 | \$38.20 | 3 | 28 |

FX mold

SILICONE OPEN POUR LURE MOLDS

Xtreme Trailer



Swim Tail Trailer

Xtreme Trailer

The Xtreme Trailers is a twin curl tail trailer lure designed to create lots of vibration with two swimming legs. It makes a great trailer for jigs and works great paired with an X Skirt. The unique thin body design can be used as a “chunk” style trailer or threaded on the hook like a “standard” trailer.



| Size | Lure Dimensions (inches) | | | Single Cavity | | Multi-Cavity | | | Lures per Pack X Cubes | Lures Per Quart Resin |
|--------|--------------------------|-------|--------|---------------|--------|--------------|---------------|---------|------------------------|-----------------------|
| | Length | Width | Height | Part Number | MSRP | Part Number | # of Cavities | MSRP | | |
| 1-1/2" | 1.63" | 1.20" | 0.22" | 7515SC | \$5.58 | 7515MC | 3 | \$8.32 | 49 | 531 |
| 2" | 1.97" | 1.69" | 0.24" | 7520SC | \$6.02 | 7520MC | 3 | \$9.96 | 28 | 307 |
| 2-1/2" | 2.32" | 1.72" | 0.26" | 7525SC | \$6.20 | 7525MC | 3 | \$10.66 | 20 | 220 |
| 3" | 2.71" | 1.74" | 0.27" | 7530SC | \$6.54 | 7530MC | 3 | \$11.80 | 17 | 180 |
| 3-1/2" | 3.14" | 1.86" | 0.29" | 7535SC | \$7.24 | 7535MC | 3 | \$14.34 | 12 | 130 |
| 4" | 3.59" | 2.05" | 0.32" | 7540SC | \$7.99 | 7540MC | 3 | \$17.04 | 9 | 96 |

FX mold

SILICONE OPEN POUR LURE MOLDS

Craw Chunk



Crawdad Trailer

Craw Chunk The CRAW CHUNK trailer is a “chunk” style jig trailer with craw pinchers. It is a very popular type of jig trailer. The simple design creates a subtle action in the water that mimics both the movement of a crawfish and the movement of an injured bait fish



| Size | Lure Dimensions (inches) | | | Single Cavity | | Multi-Cavity | | | Lures per Pack X Cubes | Lures Per Quart Resin |
|--------|--------------------------|-------|--------|---------------|--------|--------------|---------------|---------|------------------------|-----------------------|
| | Length | Width | Height | Part Number | MSRP | Part Number | # of Cavities | MSRP | | |
| 1-1/2" | 1.50" | 1.10" | 0.25" | 7615SC | \$5.67 | 7615MC | 3 | \$9.46 | 45 | 489 |
| 2" | 2.00" | 1.29" | 0.31" | 7620SC | \$6.10 | 7620MC | 3 | \$10.80 | 25 | 270 |
| 2-1/2" | 2.50" | 1.44" | 0.29" | 7625SC | \$6.45 | 7625MC | 3 | \$11.07 | 15 | 160 |
| 3" | 3.00" | 1.65" | 0.33" | 7630SC | \$6.67 | 7630MC | 3 | \$15.77 | 10 | 108 |
| 3-1/2" | 3.38" | 1.87" | 0.33" | 7635SC | \$7.50 | 7635MC | 3 | \$18.09 | 9 | 94 |
| 4" | 3.74" | 2.00" | 0.36" | 7640SC | \$7.80 | 7640MC | 3 | \$19.86 | 6 | 65 |

FX mold

SILICONE OPEN POUR LURE MOLDS

Frogger



Curl Tail Frog



FROGGER

The FROGGER is a curl tail swimming top water frog lure. It is designed to be rigged weightless for use over and through the nastiest structure you can find. The curl tail legs create a fast swimming action on retrieve that attracts fish out of the heaviest cover for some explosive strikes

| Size | Lure Dimensions (inches) | | | Single Cavity | | Multi-Cavity | | | Lures per Pack X Cubes | Lures Per Quart Resin |
|--------|--------------------------|-------|--------|---------------|---------|--------------|---------------|---------|------------------------|-----------------------|
| | Length | Width | Height | Part Number | MSRP | Part Number | # of Cavities | MSRP | | |
| 2" | 1.75" | 1.25" | 0.24" | 8020SC | \$5.70 | 8020MC | 3 | \$10.52 | 27 | 292 |
| 2-1/2" | 2.25" | 1.38" | 0.32" | 8025SC | \$5.99 | 8025MC | 3 | \$12.37 | 18 | 195 |
| 3" | 2.72" | 1.31" | 0.35" | 8030SC | \$6.71 | 8030MC | 3 | \$13.10 | 13 | 145 |
| 3-1/2" | 3.25" | 1.70" | 0.38" | 8035SC | \$10.31 | 8035MC | 3 | \$23.18 | 7 | 79 |
| 4" | 4.04" | 1.53" | 0.42" | 8040SC | \$10.35 | 8040MC | 3 | \$20.32 | 5 | 50 |
| 4-1/2" | 4.50" | 1.68" | 0.45" | 8040SC | \$10.70 | 8040MC | 3 | \$20.57 | 4 | 49 |

FX mold

SILICONE OPEN POUR LURE MOLDS

X-Frog



Swim Leg Frog



X-FROG

The X FROG is a paddle tail top water frog lure. It is designed to be rigged weightless for use over and through the nastiest structure you can find. The paddle tail legs create a paddling action on retrieve that attracts fish out of the heaviest cover for some explosive strikes. Also works great on a buzzbait.

| Size | Lure Dimensions (inches) | | | Single Cavity | | Multi-Cavity | | | Lures per Pack X Cubes | Lures Per Quart Resin |
|--------|--------------------------|-------|--------|---------------|---------|--------------|---------------|---------|------------------------|-----------------------|
| | Length | Width | Height | Part Number | MSRP | Part Number | # of Cavities | MSRP | | |
| 2" | 2.00" | 0.88" | 0.31" | 8120SC | \$5.54 | 8120MC | 3 | \$10.24 | 21 | 228 |
| 2-1/2" | 2.71" | 0.94" | 0.28" | 8125SC | \$5.88 | 8125MC | 3 | \$10.70 | 20 | 226 |
| 3" | 2.75" | 1.00" | 0.40" | 8130SC | \$6.52 | 8130MC | 3 | \$13.66 | 14 | 146 |
| 3-1/2" | 3.68" | 1.35" | 0.38" | 8135SC | \$7.03 | 8135MC | 3 | \$13.01 | 9 | 92 |
| 4" | 4.00" | 1.34" | 0.50" | 8140SC | \$9.11 | 8140MC | 3 | \$21.07 | 6 | 67 |
| 5" | 4.75" | 1.98" | 0.53" | 8150SC | \$14.81 | 8150MC | 3 | \$30.97 | 3 | 28 |

FX mold

SILICONE OPEN POUR LURE MOLDS

X-Shrimp



Shrimp Body Lure

X-Shrimp

The X SHRIMP is a paddle tail shrimp lure. It can be rigged in many ways and is a good universal lure for numerous freshwater and saltwater species. The tail is molded as a solid paddle tail and can easily be cut into a split tail after molding to create a fork shape tail.

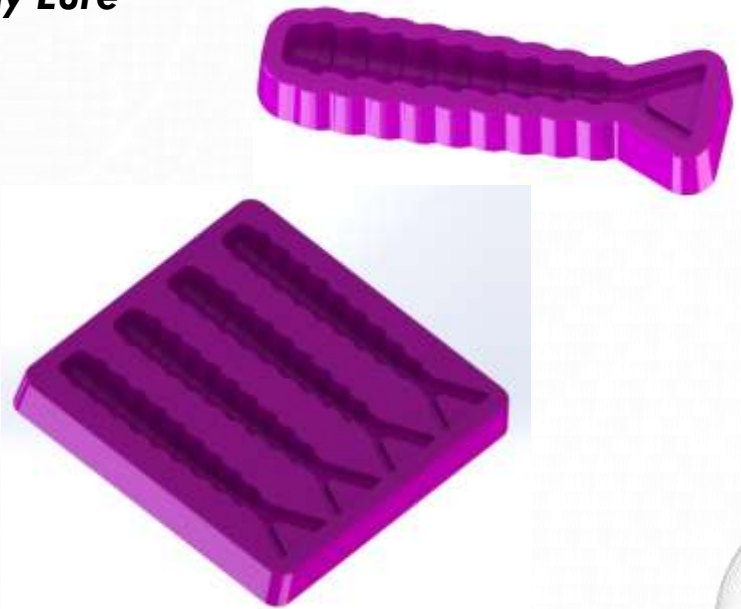

| Size | Lure Dimensions (inches) | | | Single Cavity | | Multi-Cavity | | | Lures per Pack X Cubes | Lures Per Quart Resin |
|------|--------------------------|-------|--------|---------------|---------|--------------|---------------|---------|------------------------|-----------------------|
| | Length | Width | Height | Part Number | MSRP | Part Number | # of Cavities | MSRP | | |
| 2" | 2.00" | 0.68" | 0.32" | 8220SC | \$5.65 | 8220MC | 3 | \$10.86 | 34 | 365 |
| 3" | 3.20" | 0.93" | 0.43" | 8230SC | \$6.31 | 8230MC | 3 | \$15.46 | 11 | 119 |
| 4" | 4.20" | 0.93" | 0.47" | 8240SC | \$7.01 | 8240MC | 3 | \$19.77 | 6 | 70 |
| 5" | 5.30" | 1.17" | 0.48" | 8250SC | \$7.57 | 8250MC | 3 | \$31.59 | 5 | 55 |
| 6" | 6.30" | 1.42" | 0.53" | 8260SC | \$8.02 | 8260MC | 3 | \$40.29 | 3 | 33 |
| 8" | 8.11" | 1.66" | 0.66" | 8280SC | \$10.93 | 8280MC | 3 | \$50.68 | 2 | 17 |

FX mold

SILICONE OPEN POUR LURE MOLDS

Sally

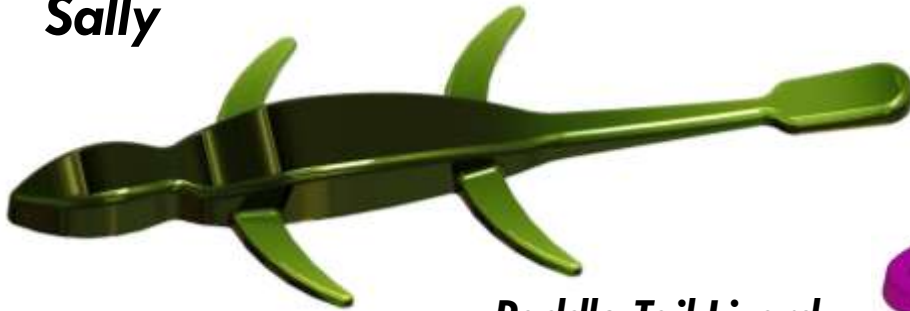

Paddle Tail Lizard

Sally The SALLY is a lizard or salamander imitation lure with a flat paddle tail for a subtle action. It is a very popular lure for catching bass during the spawning season as a lizard or salamander is seen as a threat toward the nest of a bass. It works well when rigged Texas style, Carolina, or weightless



| Size | Lure Dimensions (inches) | | | Single Cavity | | Multi-Cavity | | | Lures per Pack X Cubes | Lures Per Quart Resin |
|------|--------------------------|-------|--------|---------------|---------|--------------|---------------|---------|------------------------|-----------------------|
| | Length | Width | Height | Part Number | MSRP | Part Number | # of Cavities | MSRP | | |
| 3" | 2.75" | 1.00" | 0.30" | 8330SC | \$6.17 | 8330MC | 3 | \$11.42 | 26 | 277 |
| 4" | 4.00" | 1.50" | 0.32" | 8340SC | \$6.64 | 8340MC | 3 | \$17.34 | 13 | 138 |
| 5" | 5.00" | 1.50" | 0.32" | 8350SC | \$7.05 | 8350MC | 3 | \$22.43 | 12 | 129 |
| 6" | 6.00" | 1.75" | 0.30" | 8360SC | \$7.98 | 8360MC | 3 | \$26.31 | 7 | 72 |
| 7" | 7.00" | 2.00" | 0.45" | 8370SC | \$9.81 | 8370MC | 3 | \$53.02 | 3 | 36 |
| 8" | 8.00" | 2.00" | 0.40" | 8380SC | \$11.97 | 8380MC | 3 | \$58.35 | 2 | 24 |

FX mold

SILICONE OPEN POUR LURE MOLDS

SX Sally

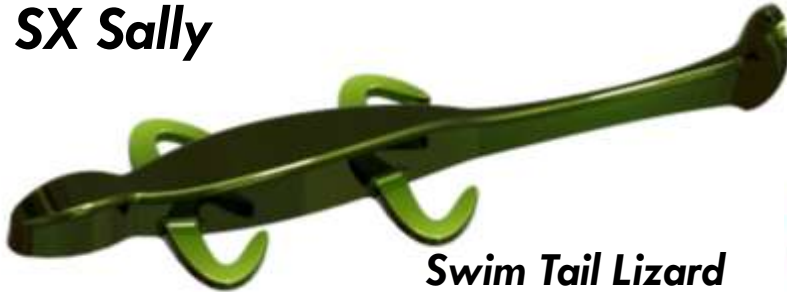

Swim Tail Lizard

SX Sally

The SX SALLY is a lizard or salamander imitation lure with a paddle type swimming tail giving it an action similar to many popular swim baits. It is a very popular lure for catching bass during the spawning season as a lizard or salamander is seen as a threat toward the nest of a bass. It works well when rigged Texas style, Carolina, or weightless



| Size | Lure Dimensions (inches) | | | Single Cavity | | Multi-Cavity | | | Lures per Pack X Cubes | Lures Per Quart Resin |
|--------|--------------------------|-------|--------|---------------|---------|--------------|---------------|---------|------------------------|-----------------------|
| | Length | Width | Height | Part Number | MSRP | Part Number | # of Cavities | MSRP | | |
| 2-1/2" | 2.25" | 0.75" | 0.25" | 8425SC | \$6.03 | 8425MC | 3 | \$10.63 | 46 | 501 |
| 3-1/2" | 3.38" | 1.00" | 0.29" | 8435SC | \$6.36 | 8435MC | 3 | \$14.36 | 27 | 287 |
| 4-1/2" | 4.47" | 1.50" | 0.27" | 8445SC | \$8.04 | 8445MC | 3 | \$22.05 | 9 | 97 |
| 5-1/2" | 6.00" | 2.00" | 0.45" | 8455SC | \$9.80 | 8455MC | 3 | \$33.88 | 6 | 66 |
| 6-1/2" | 7.00" | 2.13" | 0.40" | 8465SC | \$14.21 | 8465MC | 3 | \$67.60 | 2 | 26 |
| 7-1/2" | 8.00" | 2.25" | 0.45" | 8675SC | \$14.95 | 8675MC | 3 | \$81.17 | 2 | 25 |

FX mold

SILICONE OPEN POUR LURE MOLDS

Sally Q



Curl Tail Lizard



Sally Q The SALLY Q is a lizard or salamander imitation lure with a curled swimming tail. It is a very popular lure for catching bass during the spawning season as a lizard or salamander is seen as a threat toward the nest of a bass. It works well when rigged Texas style, Carolina, or weightless

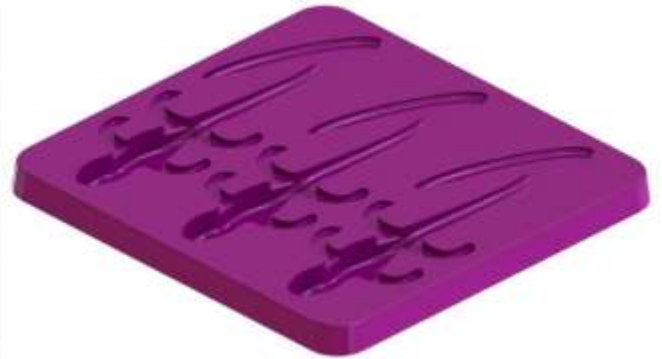

| Size | Lure Dimensions (inches) | | | Single Cavity | | Multi-Cavity | | | Lures per Pack X Cubes | Lures Per Quart Resin |
|------|--------------------------|-------|--------|---------------|---------|--------------|---------------|---------|------------------------|-----------------------|
| | Length | Width | Height | Part Number | MSRP | Part Number | # of Cavities | MSRP | | |
| 3" | 2.74" | 0.93" | 0.24" | 8530SC | \$5.81 | 8530MC | 3 | \$10.46 | 39 | 426 |
| 4" | 3.75" | 1.23" | 0.29" | 8540SC | \$6.55 | 8540MC | 3 | \$13.65 | 19 | 204 |
| 5" | 4.93" | 1.50" | 0.31" | 8550SC | \$7.31 | 8550MC | 3 | \$16.59 | 11 | 118 |
| 6" | 5.75" | 1.83" | 0.38" | 8560SC | \$9.49 | 8560MC | 3 | \$26.52 | 6 | 68 |
| 8" | 7.64" | 2.50" | 0.42" | 8580SC | \$11.29 | 8580MC | 3 | \$47.31 | 3 | 34 |

FX mold

SILICONE OPEN POUR LURE MOLDS

DOA Shad



Shad Body



DOA Shad

The DOA SHAD is a flat sided bait designed to imitate a dying or injured shad. It has a very unique and realistic erratic darting action that triggers the natural instinct to strike. When rigged weightless, Carolina rig, or Texas rig it is hard to find a more lifelike inured shad lure. Rig on a drop shot a trigger aggressive strikes from the most heavy pressured fish.



| Size | Lure Dimensions (inches) | | | Single Cavity | | Multi-Cavity | | | Lures per Pack X Cubes | Lures Per Quart Resin |
|------|--------------------------|-------|--------|---------------|---------|--------------|---------------|---------|------------------------|-----------------------|
| | Length | Width | Height | Part Number | MSRP | Part Number | # of Cavities | MSRP | | |
| 2" | 2.00" | 0.82" | 0.21" | 8620SC | \$5.48 | 8620MC | 3 | \$8.77 | 38 | 409 |
| 3" | 3.00" | 1.25" | 0.28" | 8630SC | \$6.25 | 8630MC | 3 | \$11.93 | 14 | 151 |
| 4" | 4.00" | 1.66" | 0.33" | 8640SC | \$7.15 | 8640MC | 3 | \$15.91 | 6 | 67 |
| 5" | 5.00" | 2.04" | 0.35" | 8650SC | \$8.76 | 8650MC | 3 | \$28.54 | 3 | 36 |
| 6" | 5.91" | 2.35" | 0.48" | 8660SC | \$10.72 | 8660MC | 3 | \$31.26 | 2 | 19 |

FX mold

SILICONE OPEN POUR LURE MOLDS

DOA Gill



Bluegill Body



DOA Gill

The DOA GILL is a flat sided bait designed to imitate a dying or injured bluegill. It has a very unique and realistic erratic darting action that triggers the natural instinct to strike. When rigged weightless, Carolina rig, or Texas rig it is hard to find a more lifelike injured bluegill lure. This lure is deadly on a drop shot for bedding smallmouth.

| Size | Lure Dimensions (inches) | | | Single Cavity | | Multi-Cavity | | | Lures per Pack X Cubes | Lures Per Quart Resin |
|--------|--------------------------|-------|--------|---------------|--------|--------------|---------------|---------|------------------------|-----------------------|
| | Length | Width | Height | Part Number | MSRP | Part Number | # of Cavities | MSRP | | |
| 1-1/2" | 1.47" | 0.72" | 0.21" | 8715SC | \$5.41 | 8715MC | 3 | \$8.36 | 55 | 596 |
| 2" | 2.00" | 0.93" | 0.20" | 8720SC | \$5.56 | 8720MC | 3 | \$9.17 | 31 | 339 |
| 2-1/2" | 2.50" | 1.17" | 0.27" | 8725SC | \$5.90 | 8725MC | 3 | \$11.34 | 15 | 158 |
| 3" | 2.95" | 1.61" | 0.26" | 8730SC | \$6.40 | 8730MC | 3 | \$14.76 | 9 | 102 |
| 3-1/2" | 3.46" | 1.80" | 0.30" | 8735SC | \$6.79 | 8735MC | 3 | \$15.33 | 6 | 62 |
| 4" | 3.80" | 1.85" | 0.29" | 8740SC | \$7.43 | 8740MC | 3 | \$16.15 | 5 | 53 |
| 4-1/2" | 4.23" | 2.07" | 0.39" | 8745SC | \$7.96 | 8745MC | 3 | \$24.15 | 3 | 33 |

FX mold

SILICONE OPEN POUR LURE MOLDS

X-Dawg



Goby/Sculpin Lure



X-DAWG The X-DAWG is a broad body bottom dwelling lure designed to replicate a goby or sculpin. It has a large ribbon type swimming tail that creates a realistic slow swimming action. This is an awesome lure for Great Lakes smallmouth fishing or Redfish. The X Dawg works best rigged on a jig head or Texas rigged



| Size | Lure Dimensions (inches) | | | Single Cavity | | Multi-Cavity | | | Lures per Pack X Cubes | Lures Per Quart Resin |
|------|--------------------------|-------|--------|---------------|---------|--------------|---------------|---------|------------------------|-----------------------|
| | Length | Width | Height | Part Number | MSRP | Part Number | # of Cavities | MSRP | | |
| 2" | 2.25" | 1.39" | 0.35" | 8820SC | \$6.33 | 8820MC | 3 | \$13.93 | 29 | 308 |
| 3" | 3.00" | 1.69" | 0.44" | 8830SC | \$6.88 | 8830MC | 3 | \$14.95 | 17 | 181 |
| 4" | 4.00" | 2.01" | 0.53" | 8840SC | \$8.41 | 8840MC | 3 | \$22.13 | 9 | 96 |
| 5" | 5.00" | 2.53" | 0.63" | 8850SC | \$12.87 | 8850MC | 3 | \$47.26 | 5 | 52 |
| 6" | 6.00" | 3.21" | 0.69" | 8860SC | \$16.23 | 8860MC | 3 | \$58.21 | 3 | 29 |
| 8" | 7.25" | 3.21" | 0.70" | 8880SC | \$16.88 | 8880MC | 3 | \$85.09 | 1 | 12 |

FX mold

SILICONE OPEN POUR LURE MOLDS

X-Flat



Flat Creature



X-FLAT The X-Flat is a new style lure with a flat and wide body that allows to lure to glide through the water and around heavy cover with ease. It is a very versatile lure that can be fished in and around heavy cover when rigged Texas style or can be used over heavy cover when rigged weightless. When rigged on a Texas rig with a free moving bullet weight the weight will slide away from the lure on the fall and allow the lure to flutter back down with an action no fish can refuse. When poured with floating resin use this lure to fish on top and through the heaviest cover.

| Size | Lure Dimensions (inches) | | | Single Cavity | | Multi-Cavity | | | Lures per Pack X Cubes | Lures Per Quart Resin |
|------|--------------------------|-------|--------|---------------|---------|--------------|---------------|---------|------------------------|-----------------------|
| | Length | Width | Height | Part Number | MSRP | Part Number | # of Cavities | MSRP | | |
| 2" | 2.35" | 0.88" | 0.24" | 8920SC | \$5.95 | 8920MC | 3 | \$10.25 | 28 | 304 |
| 3" | 3.33" | 1.24" | 0.33" | 8930SC | \$6.94 | 8930MC | 3 | \$15.06 | 10 | 107 |
| 4" | 3.92" | 1.47" | 0.39" | 8940SC | \$7.70 | 8940MC | 3 | \$18.87 | 6 | 66 |
| 5" | 4.90" | 1.83" | 0.49" | 8950SC | \$8.47 | 8950MC | 3 | \$29.28 | 3 | 34 |
| 6" | 5.68" | 1.91" | 0.50" | 8960SC | \$10.35 | 8960MC | 3 | \$31.95 | 2 | 26 |

COMBINATION MOLDS

Single Silicone Molds With Multiple Lures

ULTIMATE SERIES MOLDS

FX mold

SILICONE OPEN POUR LURE MOLDS

SAVE OVER BIG FROM INDIVIDUAL MOLD COSTS

Ultimate Bass

Makes 7 Different Lures

Includes One Cavity of Each Lure:



- 0560 – 6" DragonX Worm
- 4535 – 3-1/2" Xorcist Craw
- 4640 – 4" MOP Craw
- 8040 – 4" Frogger
- 7625 – 2-1/2" Craw Chunk
- 6145 – 4-1/2" Slim Drop
- 5155 – 5-1/2" Slim Critter

| | Part Number | MSRP |
|--------------------------|----------------|---------|
| Ultimate Bass Combo Mold | FX-ULTBASSMOLD | \$32.55 |

Ultimate Gamefish

Makes 11 Different Lures

- 5020 – 2" CritterX
- 6020 – 2" PX Drop
- 8725 – 2-1/2" DOA Gill
- 1030 – 3" Itchy Twitchy
- 7430 – 3" Twin Swim
- 1560 – 6" XS Twitch
- 5450 – 5" Wacky Eel
- 8830 – 3" X-Dawg
- 5935 – 3-1/2" X-Sting
- 6840 – 4" Rib Darter
- 6145 – 4-1/2" Slim Drop



| | Part Number | MSRP |
|------------------------------|--------------------|---------|
| Ultimate Gamefish Combo Mold | FX-ULTGAMEFISHMOLD | \$38.99 |

View individual lure specifications earlier on in this document using the lure numbers provided.

COMBINATION MOLDS

Single Silicone Molds With Multiple Lures

XTREME SERIES MOLDS

FX mold

SILICONE OPEN POUR LURE MOLDS

401 – Bass Essentials

Makes 7 Different Lures

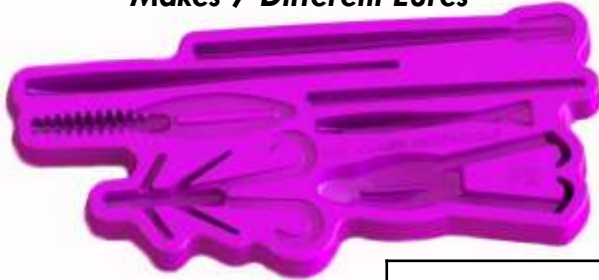

SAVE BIG FROM INDIVIDUAL MOLD COSTS

Includes One Cavity of Each Lure:

- 0260 – 6” X-Flip Worm
- 0045 – 4-1/2” Shaky FX
- 1235 – 3-1/2” XW Twitch
- 1160 – 6” Slim Twitch
- 5145 – 4-1/2” Slim Critter
- 5535 – 3-1/2” Crazy Hawg
- 8140 – 4” X-Frog

| | Part Number | MSRP |
|--------------------------------|--------------------------|---------|
| 401-Bass Essentials Combo Mold | FX-EXTBASSESSENTIALSMOLD | \$31.90 |

Includes One Cavity of Each Lure:

- 0540 – 4” DragonX Worm
- 0860 – 6” RazorZ Worm
- 1245 – 4-1/2” XW Twitch
- 4635 – 3-1/2” MOP Craw
- 5940 – 4” X-Sting
- 5540 – 4” Crazy Hawg
- 8840 – 4” X-Dawg

421 – Hot & Trendy Bass

Makes 7 Different Lures



| | Part Number | MSRP |
|------------------------------------|------------------------|---------|
| 421 – Hot & Trendy Bass Combo Mold | FX-EXTHOTANDTRENDYMOLD | \$39.33 |

423 – Bass Extreme



Makes 8 Different Lures

Includes One Cavity of Each Lure:

- 0660 – 6” CurlyX
- 0550 – 5” DragonX
- 1560 – 6” XS Twitch
- 2240 – 4” CrinkleX
- 4440 – 4” KnoX Craw
- 5340 – 4” Flippin’ Critter
- 6040 – 4” PX Drop
- 8550 – 5” SallyQ

| | Part Number | MSRP |
|-------------------------------|-----------------------|---------|
| 423 – Bass Extreme Combo Mold | FX-EXTBASSEXTRMEMMOLD | \$40.71 |

View individual lure specifications earlier on in this document using the lure numbers provided.

COMBINATION MOLDS

Single Silicone Molds With Multiple Lures

XESSENTIAL SERIES MOLDS

Finesse Bass

Makes 5 Different Lures



Includes One Cavity of Each Lure:

- 0540 – 4” DragonX – Segmented Tail Worm
- 6040 – 4” PX Drop – Paddle Tail Drop Shot
- 5130 – 3” Slim Critter – Narrow Creature Bait
- 2230 – 3” CrinkleX – Rib Body Stick Bait
- 1140 – 4” Slim Twitch – Slim Straight Tail Twitch/Jerk Bait

| | Part Number | MSRP |
|-------------------------|--------------|---------|
| Finesse Bass Combo Mold | FX-ESSFBMOLD | \$13.52 |

Xessential Bass

Makes 5 Different Lures



Includes One Cavity of Each Lure:

- 0160 – 6” ShakyX – Straight Worm
- 1160 – 6” Slim Twitch – Slim Straight Tail Twitch/Jerk Bait
- 2240 – 4” CrinkleX – Rib Body Stick Bait
- 4430 – 3” KnoX Craw – Big Claw Crawdad
- 5145 – 4-1/2” Slim Critter – Narrow Body Creature

| | Part Number | MSRP |
|---------------------------|----------------|---------|
| Xessential BassCombo Mold | FX-ESSBASSMOLD | \$20.52 |

Bass Combo

Makes 4 Different Lures



Includes One Cavity of Each Lure:

- 1350 – 5” Crinkle Twitch – Rib Body Jerk/Twitch
- 0560 – 6” DragonX – Segmented Tail Worm
- 4440 – 4” KnoX Craw – Large Claw Crawdad
- 5345 – 4-1/2” Flippin’ Critter – Creature Lure

| | Part Number | MSRP |
|-----------------------|---------------------|---------|
| Bass Combo Combo Mold | FX-ESSBASSCOMBOMOLD | \$22.16 |

View individual lure specifications earlier on in this document using the lure numbers provided.

COMBINATION MOLDS

Single Silicone Molds With Multiple Lures

XESSENTIAL SERIES MOLDS

Xessential Panfish

Makes 7 Different Lures



SAVE BIG FROM INDIVIDUAL MOLD COSTS

Includes One Cavity of Each Lure:

1020 – 2” Itchy Twitchy – Fork Tail Twitch/Jerk Bait

6420 – 2” SweepX – Sweeper Lure

5020 – 2” CritterX – Creature Lure

6020 – 2” PX Drop – Paddle Tail Drop Shot

6815 – 1-1/2” Rib Darter – Straight Tail Creature

1120 – 2” Slim Twitchy – Slim Straight Tail Twitch/Jerk Bait

3015 – 1-1/2” SX Shad – Shad Body Swim Bait

| | Part Number | MSRP |
|-------------------------------|-------------------|---------|
| Xessential Panfish Combo Mold | FX-ESSPANFISHMOLD | \$11.86 |

Xessential Freshwater

Makes 5 Different Lures



Includes One Cavity of Each Lure:

3135 – 3-1/2” Swimmy Minny – Minnow Body Swim Bait

1030 – 3” Itchy Twitchy – Fork Tail Twitch/Jerk Bait

6125 – 2-1/2” Slim Drop – Straight Tail Drop Shot

6835 – 3-1/2” Rib Darter – Straight Tail Creature

8820 – 2” X-Dawg – Curl Tail Goby/Sculpin Lure

| | Part Number | MSRP |
|----------------------------------|----------------------|---------|
| Xessential Freshwater Combo Mold | FX-ESSFRESHWATERMOLD | \$17.16 |

Xessential Gamefish

Makes 6 Different Lures



Includes One Cavity of Each Lure:

1140 – 4” Slim Twitchy – Slim Straight Tail Twitch/Jerk Bait

5125 – 2-1/2” Slim Critter – Narrow Body Creature

8830 – 3” X-Dawg – Curl Tail Goby/Sculpin Lure

8725 – 2-1/2” DOA Gill – Bluegill Lure

1030 – 3” Itchy Twitch – Fork Tail Twitch/Jerk Bait

6020 – 2” PX Drop – Paddle Tail Drop Shot

| | Part Number | MSRP |
|--------------------------------|--------------------|---------|
| Xessential Gamefish Combo Mold | FX-ESSGAMEFISHMOLD | \$16.34 |

View individual lure specifications earlier on in this document using the lure numbers provided.

COMBINATION MOLDS

Single Silicone Molds With Multiple Lures

XESSENTIAL SERIES MOLDS

Xessential Walleye & Pike

Makes 5 Different Lures



| | Part Number | MSRP |
|--------------------------------------|--------------|---------|
| Xessential Walleye & Pike Combo Mold | FX-ESSWPMOLD | \$19.22 |

FX mold

SILICONE OPEN POUR LURE MOLDS

SAVE BIG FROM INDIVIDUAL MOLD COSTS

Includes One Cavity of Each Lure:

- 1050 – 5” Itchy Twitch – Fork Tail Twitch/Jerk Bait
- 3030 – 3” SX Shad – Shad Body Swim Bait
- 5130 – 3” Slim Critter – Narrow Body Creature Bait
- 6835 – 3-1/2” Rib Darter – Straight Tail Creature
- 6145 – 4-1/2” Slim Drop – Straight Tail Drop Shot

Xessential Trending Bass

Makes 5 Different Lures



| | Part Number | MSRP |
|-------------------------------------|------------------------|---------|
| Xessential Trending Bass Combo Mold | FX-ESSTRENDINGBASSMOLD | \$29.66 |

Includes One Cavity of Each Lure:

- 0560 – 6” DragonX – Segmented Tail Worm
- 1550 – 5” XS Twitch – Wide Body Straight Tail Twitch/Jerk Bait
- 4635 – 3-1/2” MOP Craw – Paddle Claw Craw
- 5540 - 4” Crazy Hawg – Creature Lure
- 5935 – 3-1/2” X-String – Paddle Tail Creature

Xessential Saltwater

Makes 5 Different Lures



| | Part Number | MSRP |
|---------------------------------|---------------------|---------|
| Xessential Saltwater Combo Mold | FX-ESSSALTWATERMOLD | \$28.99 |

Includes One Cavity of Each Lure:

- 1550 – 5” XS Twitch – Wide Body Straight Tail Twitch/Jerk
- 3145 – 4-1/2” Swimmy Minny – Minnow Body Swim Bait
- 6745 – 4-1/2” Shaky Eel – Eel Lure
- 8240 – 4” X-Shrimp – Fork Tail Shrimp Lure
- 8830 – 3” X-Dawg – Curl Tail Goby/Sculpin Lure

View individual lure specifications earlier on in this document using the lure numbers provided.

COMBINATION MOLDS

Single Silicone Molds With Multiple Lures

XESSENTIAL SERIES MOLDS

Xessential Creature & Craw

Makes 6 Different Lures

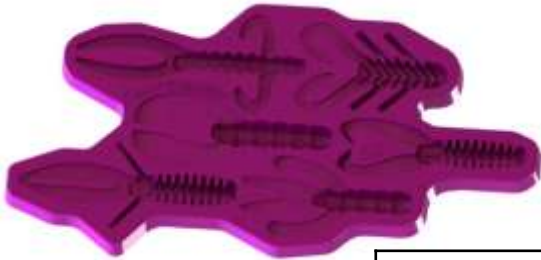

SAVE BIG FROM INDIVIDUAL MOLD COSTS

Includes One Cavity of Each Lure:

- 4440 – 4” KnoX Craw – Big Claw Crawdad
- 4535 – 3-1/2” Xorcist Craw – Swimming Creature Craw
- 4850 – 5” Creek Craw – Slim Body Creature Lure
- 4940 – 4” Flapper – Kicking Leg Creature
- 4635 – 3-1/2” MOP Craw – Paddle Claw Craw
- 5345 – 4-1/2” Flippin Critter – Bug Creature Lure

| | Part Number | MSRP |
|---------------------------------------|------------------------|---------|
| Xessential Creature & Craw Combo Mold | FX-ESSCREATURECRAWMOLD | \$32.46 |

Xessential Smallmouth Bass

Makes 6 Different Lures



Includes One Cavity of Each Lure:

- 0340 – 4” RX-Flip Worm – Rib Body Worm
- 1040 – 4” Itchy Twitchy – Fork Tail Jerk Bait
- 4730 – 3” X-Bug Curl Tail Creature
- 4635 – 3-1/2” MOP Craw – Paddle Claw Craw
- 2230 – 3” CrinkleX – Rib Body Stick Bait
- 6040 – 4” PX Drop – Paddle Tail Drop Shot

| | Part Number | MSRP |
|---------------------------------------|--------------------------|---------|
| Xessential Smallmouth Bass Combo Mold | FX-ESSSMALLMOUTHBASSMOLD | \$23.26 |

Xessential Twitch & Stick

Makes 7 Different Lures



Includes One Cavity of Each Lure:

- 1050 – 5” Itchy Twitchy – Fork Tail Jerk Bait
- 1160 – 6” Slim Twitchy – Slim Body Straight Tail Jerk Bait
- 1235 – 3-1/2” XW Twitch – Wide Body Fork Tail Jerk Bait
- 1540 – 4” XS Twitch – Wide Body Straight Tail Jerk Bait
- 2040 – 4” StiX – Standard Body Stick Bait
- 2155 – 5-1/2” Slim StiX – Slim Body Stick Bait
- 2230 – 3” CrinkleX – Rib Body Stick Bait

| | Part Number | MSRP |
|-----------------------------------|-----------------------|---------|
| Xessential TwitchStick Combo Mold | FX-ESSTWITCHSTICKMOLD | \$24.52 |

View individual lure specifications earlier on in this document using the lure numbers provided.

COMBINATION MOLDS

Single Silicone Molds With Multiple Lures

XESSENTIAL SERIES MOLDS



SILICONE OPEN POUR LURE MOLDS

SAVE BIG FROM INDIVIDUAL MOLD COSTS

Xessential Worm

Makes 5 Different Lures



Includes One Cavity of Each Lure:

- 0055 – 5-1/2" Shaky SX – Slim Body Finesse Worm
- 0350 – 5" RX Flip – Rib Body Worm
- 0560 – 6" DragonX – Segmented Tail Worm
- 0660 – 6" CurlyX – Curl Tail Worm
- 0850 – 5" RazorX – Ribbon Tail Worm

| | Part Number | MSRP |
|----------------------------|----------------|---------|
| Xessential Worm Combo Mold | FX-ESSWORMMOLD | \$17.96 |

View individual lure specifications earlier on in this document using the lure numbers provided.

SINGLE TUBE DIPPERS

Hand dipping is the most popular method to make tube lures. Simply dip into liquid resin and allow to cool. Tubes can be dipped 2-3 times to make thicker walls. After cooling tails can be cut with one of our tail slitters. It is recommended to use X-Firm resin for dipped tubes.

ROUND TUBE DIPPERS

Round aluminum tube dipper with insulated handle. Engraved marks for the most popular tube lengths.

| | Part Number | MSRP |
|----------------------------------|-------------------|--------|
| 1/8" Rod (Up to 3" Tube Length) | FX-TDIPSINGLE-125 | \$3.55 |
| 3/16" Rod (Up to 4" Tube Length) | FX-TDIPSINGLE-188 | \$3.98 |
| 1/4" Rod (Up to 5" Tube Length) | FX-TDIPSINGLE-250 | \$4.75 |
| 5/16" Rod (Up to 6" Tube Length) | FX-TDIPSINGLE-313 | \$5.65 |



FLAT TUBE DIPPERS

Flat aluminum tube dipper with insulated handle. A unique tube shape for a more erratic action.

| | Part Number | MSRP |
|-----------------------------------------|-------------------|--------|
| 3/8" x 1/16" Rod (Up to 4" Tube Length) | FX-FTDIPSINGLE-SM | \$5.38 |
| 1/2" x 1/16" Rod (Up to 5" Tube Length) | FX-FTDIPSINGLE-MD | \$6.56 |
| 5/8" x 1/16" Rod (Up to 6" Tube Length) | FX-FTDIPSINGLE-LG | \$7.25 |



WEIGHTS FOR FLAT TUBES (Contain Lead)

Unique flat lead weights slide into tube. Texas Rig with offset wide gap worm hook. Run hook through hole in weight and lock weight, hook, and tube together preventing any unwanted movement between the hook, weight, and tube.

| | Part Number | MSRP |
|-------------------------------|----------------------|--------|
| Flat Tube Weight (6 pk) | FX-FTWEIGHT-XXX-6pk | \$2.25 |
| Flat Tube Weight (20pk) | FX-FTWEIGHT-XXX-20pk | \$5.50 |
| Flat Tube Weight (Assortment) | FX-FTWEIGHT-AST1 | \$4.75 |

Available Sizes: 1/16oz (2g), 1/8oz (4g), 3/16oz (5g), 1/4oz (7g), 5/16oz (9g), 3/8oz (11g), 1/2oz (14g), 5/8oz (18g)

Assortment Includes 4 of each (1/8oz, 3/16 oz, 1/4oz, and 3/8 oz)



MULTIPLE TUBE DIPPERS

Hand dipping is the most popular method to make tube lures. Simply dip into liquid resin and allow to cool. Tubes can be dipped 2-3 times to make thicker walls. After cooling tails can be cut with one of our tail slitters. It is recommended to use X-Firm resin for dipped tubes. Makes 6 Tubes at Once

MULTIPLE ROUND TUBE DIPPERS

Round aluminum tube dipper with insulated handle. Engraved marks for the most popular tube lengths. Makes 6 tubes at a time.

| | Part Number | MSRP |
|----------------------------------|-------------------|---------|
| 1/8" Rod (Up to 3" Tube Length) | FX-TDIPSINGLE-125 | \$20.46 |
| 3/16" Rod (Up to 4" Tube Length) | FX-TDIPSINGLE-188 | \$22.31 |
| 1/4" Rod (Up to 5" Tube Length) | FX-TDIPSINGLE-250 | \$24.75 |
| 5/16" Rod (Up to 6" Tube Length) | FX-TDIPSINGLE-313 | \$25.68 |



TUBE DIPPER SIZES:

- 1/8" Rod Tube Dippers – Popular For Panfish Tubes
- 3/16" Rod Tube Dippers – For Finesse Bass Tubes & Larger Panfish Tubes
- 1/4" Rod Tube Dipper – Most Popular For Bass Tubes
- 5/16" Rod Tube Dipper – For Larger Flipping & Saltwater Tubes

epoX

Closed Pour Molds

- **HAND POURED**
- **FULL ROUND**
- **NO FLAT SIDE**
- **ECONOMICAL**
- **NO INJECTOR NEEDED**

NX Stick



Caterpillar Stick Bait

NX Stick

The NX Stick is a segmented stick bait or caterpillar worm. It has a thick body and tail to give it a stiff appearance in the water. This is a very popular design for Ned rig fishing. It works equally well as a weightless stick bait, drop shot, or shaky head lure.



| Size | Lure Dimensions (inches) | | | Single Cavity | | 3 Pack | |
|--------|--------------------------|-------|--------|---------------|--------|-----------------|---------|
| | Length | Width | Height | Part Number | MSRP | Part Number | MSRP |
| 2-1/2" | 2.50" | .46" | .44" | EPOX-2525SC | \$7.95 | EPOX-2525SC-3PK | \$19.88 |
| 3" | 3.00" | .48" | .47" | EPOX-2530SC | \$8.04 | EPOX-2530SC-3PK | \$20.10 |
| 3-1/2" | 3.50" | .51" | .51" | EPOX-2535SC | \$8.25 | EPOX-2535SC-3PK | \$20.63 |
| 4" | 4.00" | .54" | .54" | EPOX-2540SC | \$8.46 | EPOX-2540SC-3PK | \$21.15 |
| 4-1/2" | 4.50" | .58" | .56" | EPOX-2545SC | \$8.99 | EPOX-2545SC-3PK | \$22.48 |
| 5" | 5.00" | .62" | .58" | EPOX-2550SC | \$9.45 | EPOX-2550SC-3PK | \$23.63 |

epoX

Closed Pour Molds

SSX Stick



Slim Body Stick Bait

SSX Stick

The SSX Stick has a thinner body than a standard stick bait for increased action and a slower fall. It makes a great stick bait for use as a weightless stick bait, wacky rig, shaky head, Carolina rig, drop shot, or Texas rig. It has a solid side to side darting action. The SSX Stick is a great choice for shallow water and a more finesse presentation



- **HAND POURED**
- **FULL ROUND**
- **NO FLAT SIDE**
- **ECONOMICAL**
- **NO INJECTOR NEEDED**



| Size | Lure Dimensions (inches) | | | Single Cavity | | 3 Pack | |
|--------|--------------------------|-------|--------|---------------|---------|-----------------|---------|
| | Length | Width | Height | Part Number | MSRP | Part Number | MSRP |
| 2-1/2" | 2.65" | .25" | .25" | EPOX-2625SC | \$7.75 | EPOX-2625SC-3PK | \$19.38 |
| 3-1/2" | 3.50" | .32" | .32" | EPOX-2635SC | \$8.01 | EPOX-2635SC-3PK | \$20.03 |
| 4-1/2" | 4.50" | .33" | .33" | EPOX-2645SC | \$8.32 | EPOX-2645SC-3PK | \$20.80 |
| 5-1/2" | 5.50" | .34" | .34" | EPOX-2655SC | \$8.97 | EPOX-2655SC-3PK | \$22.43 |
| 6-1/2" | 6.60" | .37" | .37" | EPOX-2665SC | \$9.34 | EPOX-2665SC-3PK | \$23.35 |
| 7-1/2" | 7.50" | .40" | .40" | EPOX-2675SC | \$10.10 | EPOX-2675SC-3PK | \$25.25 |
| 8-1/2" | 8.60" | .42" | .42" | EPOX-2685SC | \$10.87 | EPOX-2685SC-3PK | \$27.18 |

epoX

Closed Pour Molds

- **HAND POURED**
- **FULL ROUND**
- **NO FLAT SIDE**
- **ECONOMICAL**
- **NO INJECTOR NEEDED**

RSX Stick



Standard Body Stick Bait

RSX

The RSX Stick is a broad body soft plastic stick bait lure made popular by lures such as the “Yamamoto Senko”. It has a thick body and makes a great stick bait for use as a weightless stick bait, wacky rig, shaky head, Carolina rig, drop shot, or Texas rig. It has a solid side to side darting action. The extra thickness gives it increased weight for fishing deeper or on windy days.



| Size | Lure Dimensions (inches) | | | Single Cavity | | 3 Pack | |
|------|--------------------------|-------|--------|---------------|---------|-----------------|---------|
| | Length | Width | Height | Part Number | MSRP | Part Number | MSRP |
| 3" | 3.00" | .34" | .34" | EPOX-2730SC | \$8.38 | EPOX-2730SC-3PK | \$20.95 |
| 4" | 4.00" | .39" | .39" | EPOX-2740SC | \$8.84 | EPOX-2740SC-3PK | \$22.10 |
| 5" | 5.00" | .40" | .40" | EPOX-2750SC | \$9.64 | EPOX-2750SC-3PK | \$24.10 |
| 6" | 6.00" | .40" | .40" | EPOX-2760SC | \$10.49 | EPOX-2760SC-3PK | \$26.23 |
| 7" | 7.00" | .44" | .44" | EPOX-2770SC | \$11.13 | EPOX-2770SC-3PK | \$27.83 |
| 8" | 8.00" | .48" | .48" | EPOX-2780SC | \$12.09 | EPOX-2780SC-3PK | \$30.23 |

epoX

Closed Pour Molds

- **HAND POURED**
- **FULL ROUND**
- **NO FLAT SIDE**
- **ECONOMICAL**
- **NO INJECTOR NEEDED**

FSX Stick



Fat Body Stick Bait

FSX Stick

The FSX Stick is a thick bodied stick bait design. It has a thick body and tail to give it a stiff appearance in the water. The extra size allows easy casting in the wind and a faster fall rate for windy days. It works equally well as a weightless stick bait, drop shot, Carolina rig, or shaky head lure.



| Size | Lure Dimensions (inches) | | | Single Cavity | | 3 Pack | |
|------|--------------------------|-------|--------|---------------|---------|-----------------|---------|
| | Length | Width | Height | Part Number | MSRP | Part Number | MSRP |
| 3" | 3.00" | .41" | .41" | EPOX-2830SC | \$8.52 | EPOX-2830SC-3PK | \$21.30 |
| 4" | 4.00" | .45" | .45" | EPOX-2840SC | \$8.98 | EPOX-2840SC-3PK | \$22.45 |
| 5" | 5.00" | .46" | .46" | EPOX-2850SC | \$10.48 | EPOX-2850SC-3PK | \$26.20 |
| 6" | 6.00" | .48" | .48" | EPOX-2860SC | \$11.17 | EPOX-2860SC-3PK | \$27.93 |
| 7" | 7.00" | .50" | .50" | EPOX-2870SC | \$11.67 | EPOX-2870SC-3PK | \$29.18 |
| 8" | 8.00" | .52" | .52" | EPOX-2880SC | \$12.05 | EPOX-2880SC-3PK | \$30.13 |

epoX

Closed Pour Molds

- **HAND POURED**
- **FULL ROUND**
- **NO FLAT SIDE**
- **ECONOMICAL**
- **NO INJECTOR NEEDED**

CRX Stick



Ribbed Body Stick Bait

CRX Stick

The CRX Stick is a broad body stick bait with the addition of ribs on the body for extra vibration and a different feel. It has a thick body and makes a great stick bait for use as a weightless stick bait, wacky rig, shaky head, Carolina rig, drop shot, or Texas rig. It has a slow side to side darting action with increased stiffness over a standard stick bait for a very unique action. The extra thickness gives it increases weight for fishing deeper or on windy days



| Size | Lure Dimensions (inches) | | | Single Cavity | | 3 Pack | |
|------|--------------------------|-------|--------|---------------|---------|-----------------|---------|
| | Length | Width | Height | Part Number | MSRP | Part Number | MSRP |
| 3" | 3.00" | .42" | .38" | EPOX-2930SC | \$8.99 | EPOX-2930SC-3PK | \$22.48 |
| 4" | 4.00" | .46" | .40" | EPOX-2940SC | \$9.83 | EPOX-2940SC-3PK | \$24.58 |
| 5" | 5.00" | .48" | .42" | EPOX-2950SC | \$11.35 | EPOX-2950SC-3PK | \$28.38 |
| 6" | 6.00" | .50" | .45" | EPOX-2960SC | \$12.13 | EPOX-2960SC-3PK | \$30.33 |
| 7" | 7.00" | .52" | .48" | EPOX-2970SC | \$12.36 | EPOX-2970SC-3PK | \$30.90 |
| 8" | 8.00" | .54" | .50" | EPOX-2980SC | \$12.90 | EPOX-2980SC-3PK | \$32.25 |

Drop Us A Line - Email

@

GoFish@FusionXFishing.com

ADDITIONAL INFORMATION

Proudly



FX_{mold}



PREMIUM SILICONE HAND POUR MOLDS

OVER 400 PROPRIETARY LURE DESIGNS

From 1" to 14" Lures All Available in Single or Multi-Cavity Molds.



injex

MACHINED RESIN LURE MOLDS



Fusion[®] Fishing Lures

INNOVATION THROUGH THE
FUSION OF ART & SCIENCE
www.FUSIONXFISHING.com

epox

AVAILABLE IN 5 POPULAR LURE STYLES

IN 2" to 8" LURE LENGTHS

- HAND Poured
- FULL ROUND
- NO FLAT SIDE
- ECONOMICAL



X_{cube}

**SOFT PLASTIC
LURE MAKING CUBES**

JUST HEAT AND POUR INTO
YOUR FAVORITE LURE MOLD

The "Clean & Easy" way to make soft
plastic lures.

- OVER 300 COLORS
- CHOOSE YOUR COLOR,
SCENT, WEIGHT, AND
HARDNESS LEVEL
- SINGLE, 3, 5, 10, 25, and
50 PACK SIZES



EFEX

COLOR BLENDS

Soft Plastic Lure Making Pigment

Just add dry blend to liquid plastisol prior to heating

AVAILABLE IN OVER 300 COLORS

NON-PHTHALATE FORMULA

X_{SOL} PLASTISOL

LIQUID PLASTISOL

FOR MAKING SOFT PLASTIC FISHING LURES

PINTS, QUARTS, GALLONS

ADDITIONAL INFORMATION



WARNING!

Molten Plastisol is HOT and will cause SEVERE BURNS if proper safety precautions are not taken. Fusion X Fishing assumes no liability for personal injury or property damage resulting from the use of Fusion X products.

Warranty

FusionX Fishing Lures warranties all products to be free of defects in materials and workmanship for a period of 30 days from purchase. FusionX Fishing will replace defective product free of charge for qualifying warranty returns. Products must be returned to FusionX Fishing at the expense of the customer. If a warranty claim is accepted a replacement item will be shipped to the customer at the full expense of the product and shipping. Damage from misuse, neglect, or failure to follow instructions will not be covered under warranty. FusionX Fishing assumes no responsibility for property damage or injury related to the use of FusionX Fishing products. It is the responsibility of the user to understand all safety and health risks associate with the product and its use including taking the appropriate safety precautions to protect property and health of the user as well as those nearby. When in question customers can research additional health and safety concerns prior to using the product. When in doubt do not use the product. FusionX Fishing provides safety and health information that is available at the time of publishing. FusionX Fishing assumes no liability for health and safety concerns discovered after publishing of the documents provided with the products.

Warranty Does Not Cover The Following Items:

Mold Damage From Clamps, Mold Breakage From Dropping, Mold Damage From Prying Mold Open, Mold Damage From Overheating, Mold Damage From Using harsh Chemicals, Mold Damage From Not Using Mold Release

Intellectual Property Notification

FusionX Fishing reserves rights to the FusionX Fishing Name, X-Cube name, FusionX Kit names, as well as all FusionX lure names and any names protected by trademark or copyright being held by Impulsive Innovations (dba. FusionX Fishing). By purchasing a mold from FusionX Fishing customers of FusionX have full use of the FusionX lure mold for recreational or commercial uses. Replication of molds or lures without the consent of FusionX Fishing may violate copyright, patent, and trademark laws. FusionX Fishing holds no responsibility for copyright, trademark, patent, or other intellectual property violations committed by customers using FusionX Fishing products. It is the responsibility of customers of FusionX Fishing to understand and adhere to all applicable intellectual property laws. Intellectual property laws vary when products are used for personal use verses commercial use.

PROPOSITION 65 WARNING: FusionX Fishing products can expose you to chemicals, including silica, which are known to the State of California to cause cancer. For more information, go to www.P65Warnings.ca.gov

FusionX Fishing Lures Assumes NO responsibility for injury and/or property damage from the use of FusionX Fishing products.

Copyright 2017,2018, 2019, 2020, 2021 Impulsive Innovations LLC (dba Fusion X Fishing) All rights reserved