



AFGRO
FARM EQUIPMENT

PRODUCT *Catalogue*

Innovative and affordable farm machinery for enhanced productivity and efficiency.

PRODUCT RANGE

- Remote Equipment
- Crop Sprayers
- Steel Structures
- Ploughs
- Seed PLanters
- Rotary Tillers
- Wood Chippers
- Road Scrapers
- Animal Feed Pelletisers
- Grass Balers



www.afgro.co.za



+27 62 859 7336



chris@afgro.co.za

Index

LOVOL-TRACTORS	3-14
DISC PLOUGHS	15-19
DISC HARROWS	20-26
CULTIVATOR	27-32
RIPPER AND ROTAVATOR	33
FERTILIZER SPREADER	34-35
MOWERS	36-38
HARVESTER AND SEEDERS	39-41
SPRAYERS	42
SPARE PARTS	43-50
POTATO IMPLEMENTS	51-62
IRRIGATION SOLUTIONS	63-65
WOOD CHIPPERS	66-71
SKID STEER LOADER	72-76
REMOTE MOWERS - SPRAYERS	77-80
STEEL STRUCTURES, FENCING, SOLAR	81-84



E SERIES

Euro V model 25-40HP



FEATURES OF E-SERIES EURO V MODEL

- The Doosan three-cylinder engine meets StageV/Tier 4F emission requirements, with unique speed stability control technology and high-efficiency combustion patent, strong engine power, full combustion, able to effectively reduce oil consumption in operation.
- The double-shaft gearbox has a compact structure to effectively reduce power transmission loss, and is equipped with standard 8-speed forward and 8-speed reverse reciprocating gear synchronizer, with small operating force, comfortable operation experience, and a suspension pedal to facilitate operation.
- The optional four-pillar luxury cab can effectively prevent dust and reduce noise, with side-mounted control handle, large internal space, and optimized ergonomic layout, bringing comfortable driving experience.
- The standard position control lifter has fast lifting speed and can adapt to different operating conditions.
- Optional radial tires, lawn tires, engineering tires, and paddy tires can meet different operation requirements.
- The whole vehicle has been certified to meet the requirements of EU 167/2013.





PRODUCTS INFORMATION

Model		M254	M404		
Power system					
Engine Model		KM385	Doosan D18	Doosan DM01-MFA02	DEF20CHF4
Emission standard		Stage V	Stage V / EPA4F	Stage V	
Rated power(kW/HP)		18.4/25	29.41/40	29.3/39.85	29.5/40.12
Rated rotating speed(r/min)		2350			2400
Maximum Torque (N·m)		86	160		152.6
Displacement(L)		1.53	1.8		2
Air intake way		Built-in dry type			
Oil tank capacity(L)		26	38		
Transmission system					
Drive type		4WD			
Clutch type		dry,single action	10 inch,dry,dual action	10 inch, dry,single action	
Gearbox shift mode		Sliding gear/synchronizer with shutle gear			
Gear quantity		8+8			
Creeper gear		N/A			
Speed range	Forward(km/h)	1.88-28.3	1.97-29.67	2.0-30.0	
	Reverse(km/h)	1.66-25.11	1.74-26.33	1.7-25.6	
Final transmission		Built-in Type, Single Straight Cylindrical Gear			
Differential lock		Mechannical			
Brake type		wet,disc type			
Parking brake		hand brake			
Hydraulic system					
Hydraulic output flow(L/min)		24	38		
Multi-way hydraulic spool valve Quantity		2 pairs			
Lift control mode		Position Control,floating adjustment	Position control		
Lifting capacity	at distance of 610 mm from lower links balls(kN)	5.4	8.5		
Working device					
towing device		U-type hook			
Traction		Swing drawbar			
PTO type		Rear-mounted independent PTO 540/1000			
PTO gears		6 splines	9 splines		
Standard tires					
Front tire		260/70R16	7.5-16		
Rear tire		280/85R24	12.4-24		
Machine body					
Safety Roll Over Protection System		●	●	●	●
Cab	Cab with heater	●	●	●	●
	Cab with AC	N/A	N/A	●	●
Overall dimensions					
Length*Width*Height(mm)		CAB:3300X1550X2420 ROPS:3245X1565X2610	CAB: 3558X1550X2415 ROPS: 3558X1550X2450	CAB: 3930X1590X2280 ROPS: 3930X1590X2420	CAB: 3930X1590X2280 ROPS: 3930X1590X2420
Wheel base		1680	1800	1900	
Track(mm)	Front wheels	1270	1263	1200	
	Rear wheels	1200-1400			
Ground clearance(mm)	Min. ground clearance	270			
Tuning Radius(m)	With side braking	3.00±0.3	3.00±0.3	3.40±0.3	
	Without side braking	3.50±0.3	3.50±0.3	3.90±0.3	
Weight(kg)	Structure weight	1594/1703(CAB)	1624/1715(CAB)	1720/1830(CAB)	
	Minimum service weight	1660/1761(CAB)	1744/1835(CAB)	1875/1975(CAB)	
Counterweight(kg)	Front counterweight	80		60	
	Rear counterweight	124		112	

B SERIES

3rd Gen. 40-75HP



FEATURES OF B SERIES

- Gearbox: Standard configuration: 8F+8R synchro shift; options: 12F+12R synchro shift and 8F+8R collar gearshift. 12F+12R main speed synchronized shift is optional and it has features like energy saving, reliable and comfortable.
- Driving Cab: Standard configuration is ROPS and cab with EC and OECD certifications, and compatible configurations are third generation car body with European design, fully-wrapped interior, steering wheel adjustable fore and aft, car air conditioning system and luxurious seat which fully improves the control comfort.
- Engine : B series standard configuration engine has passed European and North America certification .
- Clutch : Standard configuration 10-11 inch dual clutch is equipped with a friction disk made of special ceramic material with high reliability.
- Tires : Paddy land tires, OTR tires, meadow tires are optional.
- Electronic system: Taking rainy and humid environments into consideration, it is equipped with electrical wirings and connectors with high sealing performance so as to extend the service life of the electronic system.
- Floor: flat floor, side-placed operating lever and suspension pedal are optional, which improves control comfort.

KEY FEATURES



Enclosed mudguard and rear wall inner trims



Saloon-car air conditioner



Adjustable steering wheel



Luxurious seat



Waterproof connector



PRODUCTS INFORMATION

Model		B404	B454	B504	B554	B604	B754	
Power system								
Engine Model		C490BT	A495BT	A498BT	A4K41T55	A4K41T60	A4K43T75	
Emission standard		Stage II	Stage II	Stage II/Stage IIIA	Stage II	Stage II	Stage II	
Rated power(kW/HP)		29.4/40	33.1/45	36.8/50	40.4/55	44/60	55.5/75	
Rated rotating speed(r/min)		2400	2400	2400	2400	2400	2400	
Maximum Torque (N·m)		143	162	180	200	225	260	
Displacement(L)		2.672	2.977	3.168	4.09	4.09	4.32	
Air intake way		External type, Optional built-in type						
Oil tank capacity(L)		60						
Transmission system								
Drive type		2WD/4WD						
Clutch type		10inch,dry,double action				11 inch,dry,double action		
Gearbox shift mode		synchronizer/ sliding sleeve gearshift						
Gear quantity		12+12						
Creeper gear		N/A						
Speed range	Forward(km/h)	2.37-38.46				2.34-38.10		2013-37.61
	Reverse(km/h)	2.07-33.71				2.05-33.40		1.87-32.97
Final transmission		Planetary gear						
Differential lock		Mechannical						
Brake type		Disc brake						
Parking brake		Independent hand brake						
Hydraulic system								
Hydraulic output flow(L/min)		32				35	34	
Multi-way hydraulic spool valve Quantity		Simple hydraulic output 1 pair/2 pairs						
Lift control mode		Separated control for position and draft						
Lifting capacity	at distance of 610 mm from lower links balls(kN)	≥7.4	≥8.3	≥9.1	≥9.5	≥11.5	≥11.5	
Working device								
towing device		U-type hook						
Traction		Swing drawbar						
PTO type		Rear Semi-detached PTO 540/760 ,optional 540/1000						
PTO gears		6 splines,optional 8 splines						
Standard tires								
Front tire		8.3-20						9.5-24
Rear tire		12.4-28				14.9-28		14.9-30
Machine body								
Safety Roll Over Protection System		●	●	●	●	●	●	
Cab	Cab with heater	●	●	●	●	●	●	
	Cab with AC	●	●	●	●	●	●	
Overall dimensions								
Length*Width*Height (mm)		3986X1670X2807				4186X1730X2854		4256X1786X2877
Wheel base		1990				2040		2070
Track(mm)	Front wheels	1250				1250		1412
	Rear wheels	1300				1312		1312
Ground clearance(mm)	Min. ground clearance	310						325
Tuning Radius (m)	With side braking	3.8±0.3						3.2±0.3
	Without side braking	4.3±0.3						4.3±0.3
Weight(kg)	Structure weight	2320/2525(Cab)				2545/2750(Cab)		2910/3070(CAB)
	Minimum service weight	2490/2695(Cab)				2715/2920(Cab)		3025/3180(CAB)
Counterweight (kg)	Front counterweight	144						
	Rear counterweight	270						

H SERIES

3rd Gen. 70-90HP



FEATURES OF H SERIES

- Many gears and high speed: Equipped with 12+12 shifting synchronizer, which can realize fast, continuous and smooth shifting operation and improve the operating efficiency.
- Heavy chassis, fast operating speed: Equipped with an enhanced chassis; the rear axle, gearbox, front axle and suspension are upgraded, the chassis is enlarged and enhanced; the curb mass is increased, the chassis strength is increased, to greatly improve the reliability and better meet the job requirements.
- High ground clearance and fast crossing ability: Lovol front axle is equipped with a two-way steering cylinder, without steering dead point, with small steering force and larger steering angle. Higher ground clearance is and better passability compared with competition products.
- Adoption of an oil system shared by transmission, hydraulic steering and lifting to achieve high safety and reliability and also facilitate subsequent maintenance. Full hydraulic steering with high reliability. Adoption of 24° cone seals and O-seal rings; adoption of an oil system shared by hydraulic steering, lifting and chassis to achieve high safety and reliability and also facilitate subsequent maintenance.
- Lovol product is equipped a lower-mounted fuel tank with a large capacity and long operating hours.





PRODUCTS INFORMATION

Model		H754	H804	H854	H904
Power system					
Engine Model		A4K43T75	4D35ZT	4D35ZT	4D35ZT
Emission standard		Stage II			
Rated power(kW/HP)		55.5/75	58.8/80	62.5/85	66.2/90
Rated rotating speed(r/min)		2400			
Maximum Torque (N·m)		280	330	340	360
Displacement(L)		4.32	3.47	3.47	3.47
Air intake way		Built-in type			
Oil tank capacity(L)		120			
Transmission system					
Drive type		4WD			
Clutch type		Single, dry, dual -action clutch			
Gearbox shift mode		synchronizer			
Gear quantity		12+12			
Creeper gear		N/A			
Speed range	Forward(km/h)	1.95-34.13			
	Reverse(km/h)	1.71-29.92			
Final transmission		Planetary gear			
Differential lock		Mechannical			
Brake type		Wet, disc			
Parking brake		hand/foot parking brake			
Hydraulic system					
Hydraulic output flow(L/min)		50			
Multi-way hydraulic spool valve Quantity		1/2/3 pairs			
Lift control mode		Separated control for Position and draft/High pressure lifter			
Lifting capacity	at distance of 610 mm from lower links balls(kN)	24			
Working device					
towing device		U-type hook(Optional)			
Traction		Swing drawbar (Optional)			
PTO type		Rear-mounted independent			
PTO gears		6, Optional 8			
Standard tires					
Front tire		12.4-24			
Rear tire		16.9-34/ 18.4-30			
Machine body					
Safety Roll Over Protection System		●	●	●	●
Cab	Cab with heater	●	●	●	●
	Cab with AC	●	●	●	●
Overall dimensions					
Length*Width*Height (mm)		CAB:4795X1980X2835 ROPS:4795X1980X2870			
Wheel base		2270			
Track(mm)	Front wheels	1580			
	Rear wheels	1560			
Ground clearance(mm)	Min. ground clearance	390			
Tuning Radius(m)	With side braking	4.5			
	Without side braking	5			
Weight(kg)	Structure weight	3050/3250(CAB)			
	Minimum service weight	3210/3410(CAB)			
Counterweight(kg)	Front counterweight	360			
	Rear counterweight	320			

D SERIES

3rd Gen. 90-130HP



FEATURES OF D SERIES

- Cab: Standard configuration safety shelf and cab with OECD certifications, and compatible configurations are third generation car body with European design, fully-wrapped interior, steering wheel adjustable fore and aft, car air conditioning system and Grammer seat which fully improve manipulation comfort.
- Gearbox: Standard configuration: 16F+8R syncro shift, options: 16F+8R shuttleshift and 16F+8R creeper shift. 16F+8R main speed synchronized gears shift which are reliable, energy saving and comfortable.
- Fuel tank: Standard configuration main and auxiliary double fuel tanks have the capacity of up to 145L.
- Lifting system: The standard configuration is location independently adjusting lifter. Power lifter is for option whose maximum lifting force may reach up to 2300kg.
- Instrument cluster: Adoption of new U.S.A ACTUANT instrument cluster gives advantages of high sealing performance and multi-information integrated display.
- Engine: Huafeng 4-cylinder in-line engine adopts turbo-charging system, so it has reliable performance and strong power.

KEY FEATURES



Dynamic and fashionable appearance



Human-orientated arrangement



Beautiful and elegant headlamp



Enclosed mudguard and rear wall inner trims



Saloon-car air conditioner



PRODUCTS INFORMATION

Model		D904	D1004	D1054	D1104	D1304	
Power system							
Engine Model		4-cylinder				6-cylinder	
Emission standard		Stage II				Stage II	Stage III
Rated power(kW/HP)		66.2/90	73.5/100	77.2/105	81/110	95.6/130	
Rated rotating speed(r/min)		2200					
Maximum Torque (N·m)		420	460	469	485	609	600
Displacement(L)		Huafeng 4.67L Optional Shangchai 4.3L				6.44L	4.58L
Air intake way		Built-in dry type,optional External wet type				Built-in dry type/External dry type	
Oil tank capacity(L)		145				200/255	255
Transmission system							
Drive type		4WD					
Clutch type		12 inch, dry, doub e action				14 dry,doub e action	
Gearbox shift mode		synchronizer,optional meshing sleeve gear-shifting					
Gear quantity		8+4/16+8				16+8	
Creeper gear		Optional					
Speed range	Forward(km/h)	0.4-33.3(Creeper gear)/1.5-33.2(Shuttel shift)/1.7-33.3(synchronizer)				1.65-35.44	
	Reverse(km/h)	0.6-10.3(Creeper gear)/2.3-33.2(Shuttel shift)/2.4-21.4(synchronizer)				2.46-22.68	
Final transmission		Single stage planetary gear type					
Differential lock		Mechannical					
Brake type		wet, disc type					
Parking brake		Independent hand brake					
Hydraulic system							
Hydraulic output flow(L/min)		51				60/71	63
Multi-way hydraulic spool valve Quantity		2 pairs/3 pairs					
Lift control mode		Separated control for Position and draft,float ing adjustment/High pressure lifter: Height adjustment,float ing adjustment					
Lifting capacity	at distance of 610 mm from lower links balls(kN)	≥20				≥23	
Working device							
towing device		adjustable towing device(up and down)					
Traction		Swing drawbar(optional)					
PTO type		Rear-mounted independent PTO 540/1000, 540/540E, 760/1000, 760/850					
PTO gears		6 splines /8 splines/21 splines					
Standard tires							
Front tire		11.2-24、 12.4-24				14.9-26	
Rear tire		16.9-34、 18.4-30				18.4-38	
Machine body							
Safety Roll Over Protection System		●					
Cab	Cab with heater	N/A					
	Cab with AC	●					
Overall dimensions							
Length*Width*Height (mm)		4670×2150×2900				5060X2285X3100	
Wheel base		2405				2700	
Track(mm)	Front wheels	1610~1950				1700~2080	
	Rear wheels	1608~1996				1673~2352	
Ground clearance(mm)		Min. ground clearance 405				470	
Tuning Radius(m)	With side braking	4.2±0.3	4.6±0.3(Front wheels: 13.6-24)			4.7±0.3	
	Without side braking	4.9±0.3	5.2±0.3(Front wheels: 13.6-24)			5.2±0.3	
Weight(kg)	Structure weight	3860/4060(CAB)				5110/5230(CAB)	
	Minimum service weight	3961/4261(CAB)				5380/5570(CAB)	
Counterweight(kg)	Front counterweight	352 Optional 440				440	
	Rear counterweight	320 Optional 480				240 Optional 480	

R SERIES

3rd Gen. 150-220HP



FEATURES OF R SERIES

- Heavy chassis, fast operating speed: an enhanced chassis; the rear axle, gearbox, front axle and suspension are upgraded, the chassis is enlarged and enhanced; the chassis strength is increased by 25%, to greatly improve the reliability and better meet deep soil preparation operations.
- American Donaldson dry air filter, with improved intake efficiency and fuel consumption.
- The independent hydraulic oil steering gear has a low steering force and high reliability; the chassis heat dissipation system can keep the chassis temperature between 80-90°C, the service life of key components such as bearings, gears and oil seals is greatly extended, and the reliability of the drive system is improved by 50%.





PRODUCTS INFORMATION

Model		R1504	R1804	R2004	R2204
Power system					
Engine Model		SC7H160G2	SC7H200.2G2	SC7H200.2G2	SC7H220.2G2
Emission standard		Stage II			
Rated power(kW/HP)		110.3/150	132.4/180	147/200	162/220
Rated rotating speed(r/min)		2200			
Maximum Torque (N·m)		677	755	840	860
Displacement(L)		6.44			
Air intake way		Built-in dry type+external pre-filter			
Oil tank capacity(L)		350			
Transmission system					
Drive type		4WD			
Clutch type		14inch、dry, double action			
Gearbox shift mode		synchronizer			
Gear quantity		16+16			
Creeper gear		N/A			
Speed	Forward(km/h)	2.8-33.42			
range	Reverse(km/h)	2.75-32.87			
Final transmission		Single stage planetary gear type			
Differential lock		Mechannical			
Brake type		wet,disc type			
Parking brake		Independent hand brake			
Hydraulic system					
Hydraulic output flow(L/min)		75			
Multi-way hydraulic spool valve Quantity		4 pairs(OP:Power-Beyond)			
Lift control mode		High pressure lifter: Height adjustment, floating adjustment			
Lifting capacity	at distance of 610 mm from lower links balls(kN)	35	45		
Working device					
towing device		Up and down adjustable towing device			
Traction		Swing drawbar			
PTO type		Rear-mounted independent PTO 540/1000			
PTO gears		6splines/8splines/21splines			
Standard tires					
Front tire		14.9-28	16.9-28		
Rear tire		18.4-38(Option Double Rear Tire)	20.8-38(Option Double Rear Tire)		
Machine body					
Safety Roll Over Protection System		N/A	N/A	N/A	N/A
Cab	Cab with heater	N/A	N/A	N/A	N/A
	Cab with AC	●	●	●	●
Overall dimensions					
Length*Width*Height(mm)		5300X2410(single rear tire)/3550(dual rear tire) X3010	5300X2600(single rear tire)/3600(dual rear tire)X3150		
Wheel base		2727			
Track(mm)	Front wheels	1997			
	Rear wheels	2030	2500		
Ground clearance (mm)		450			
Tuning Radius(m)	With side braking	5.0±0.3	5.3±0.3		
	Without side braking	5.5±0.3	7.0±0.3		
Weight(kg)	Structure weight	5650	7050		
	Minimum service weight	6150	7500		
Counterweight (kg)	Front counterweight	800	1280		
	Rear counterweight	480/960			

N SERIES

3rd Gen. 240-260HP



FEATURES OF N SERIES

- N series tractors, covering 240-280 horsepower. Applicable working conditions of the product: farmland plowing, sowing, subsoiling, and transportation operations.
- It adopts Shangchai 6-cylinder 8.8L large-displacement engine, 18+6 synchronizer shifting, reinforced chassis, CARRARO front axle, gearbox rear axle all-round upgrade, chassis strength increased by 25%, and reliability is greatly improved; the chassis is enlarged Heavy weight, large traction force and fast plowing, can be equipped with subsoilers, hydraulic turning plows, combined land preparation machines, combined seeders and other large-scale equipment, which can meet the requirements of subsoiling and deep plowing operations in different situations; matching air brakes can meet non-farmland such as short-distance transportation The operation requirements bring more efficient operation solutions to users.





PRODUCTS INFORMATION

Model			N2404	N2604
Power system				
Engine Model			SC9DK270.1G3	SC9DK280G3
Emission standard			Stage III	
Rated power(kW/HP)			176/240	191.5/260
Rated rotating speed(r/min)			2200	
Maximum Torque (N·m)			1025	1070
Displacement(L)			8.82	
Air intake way			Built-in dry+Tebo pre-filtration	
Oil tank capacity(L)			480	
Transmission system				
Drive type			4WD	
Clutch type			16.5 inch, dry, single action	
Gearbox shift mode			synchronizer	
Gear quantity			18+6	
Creeper gear			N/A	
Speed	Forward(km/h)		3.37-31.96	
range	Reverse(km/h)		5.17-29.52	
Final transmission			Single stage planetary gear type	
Differential lock			Electrically controlled	
Brake type			wet,disc type	
Parking brake			Independent hand brake	
Hydraulic system				
Hydraulic output flow(L/min)			100/140(optional)	
Multi-way hydraulic spool valve Quantity			4 pairs(Power-Beyond)	
Lift control mode			Draft control、 Position control、 Position and draft control、 floating adjustment(Electric control)	
Lifting capacity	at distance of 610 mm from lower links balls(kN)		65	
Working device				
towing device			Up and down adjustable towing device	
Traction			Swing drawbar	
PTO type			Rear-mounted independent PTO 540/1000	
PTO gears			20splines	
Standard tires				
Front tire			16.9R30(dual)	540/65R30 (single)
Rear tire			20.8R42(dual)	650/65R42(single)
Machine body				
Safety Roll Over Protection System			N/A	N/A
Cab	Cab with heater		N/A	N/A
	Cab with AC		●	●
Overall dimensions				
Length*Width*Height(mm)			5610×3000(single rear tire)/3700(dual rear tire)X3260	
Wheel base			3010	
Track(mm)	Front wheels		1860	
	Rear wheels		1900	
Ground clearance (mm)	Min. ground clearance		485	
Tuning Radius(m)	With side braking		6±0.5	
	Without side braking		7±0.5	
Weight(kg)	Structure weight		7668	
	Minimum service weight		8406	
Counterweight (kg)	Front counterweight		1120	
	Rear counterweight		480	

DISC PLOUGHS



Model	Number of discs	Diameter of disc (mm)	Working width (mm)	Working depth (mm)	Weight (kg)	Matched Tractor (hp)
AFILY-315	3	460	450	180	170	25-30
AFILY-320	3	510	600	200	190	30-50
AFILY-322	3	560	660	220	316	45-55
AFILY-225	2	660/710	500	250-300	305-315	50-60
AFILY-325	3	660/710	750	250-300	430-450	75-90
AFILY-425	4	660/710	1000	250-300	500-525	90-100
AFILY-525	5	660/710	1250	250-300	600-630	100-120
AFILY-625	6	660/710	1500	250-300	700-740	130-160



Model	Number of discs	Diameter of disc (mm)	Working width (mm)	Working depth (mm)	Weight (kg)	Matched Tractor (hp)
AFILY-2	2	660	500-600	250	350	50-60
AFILY-3	3	660	750-900	250	400	75-90
AFILY-4	4	660	1000-1200	250	470	90-100
AFILY-5	5	660	1250-1500	250	560	100-120



Model	Number of discs	Diameter of disc (mm)	Working width (mm)	Working depth (mm)	Weight (kg)	Matched Tractor (hp)
AFILYD-230	2	660	500-600	250	300	50-60
AFILYD-330	3	660	750-900	250	390	75-90
AFILYD-430	4	660	1000-1200	250	490	90-100
AFILYD-530	5	660	1250-1500	250	575	100-120

SOLID BEAM DISC PLOUGH



Model	Number of discs	Diameter of disc (mm)	Working width (mm)	Working depth (mm)	Weight (kg)	Matched Tractor (hp)
AFILYZ-325	3	660X6	750	250-300	420	75-90
AFILYZ-425	4	660X6	1000	250-300	526	90-100
AFILYZ-525	5	660X6	1250	250-300	650	120-130
AFILYZ-625	6	660X6	1500	250-300	755	130-160

REVERSIBLE DISC PLOUGH



Model	Number of discs	Size of disc (mm)	Working width (mm)	Weight (kg)	Working depth (mm)	Matched tractor (hp)
AFILYS-325	3	660-710	750-900	626-650	250-300	75-90
AFILYS-425	4		1000-1200	758-790		90-100
AFILYS-525	5		1250-1500	1050-1100		100-120
AFILYS-625	6		1500-1800	1300-1350		120-130
AFILYS-725	7		1750-2100	1450-1520		150-180
AFILYS-825	8		2000-2400	1600-1680		180-220

SEMI-MOUNTED DISC PLOUGH



Model	Number of discs	Size of disc (mm)	Working width (mm)	Working depth (mm)	Weight (kg)	Matched tractor (hp)	Overall size (mm)
AFILY-635	6	710x8	2100	250-300	1600	125-160	1500x4800x1100
AFILY-735	7	710x8	2450	250-300	1700	160-200	1500x5500x1100
AFILY-835	8	710x8	2800	250-300	1800	180-220	1500x6200x1100

AF1BQX SERIES HANGING LIGHT DUTY DISC HARROW



Model	AF1BQX-1.1	AF1BQX-1.3	AF1BQX-1.5	AF1BQX-1.7	AF1BQX-1.9	AF1BQX-2.1
Number of disc	12	14	16	18	20	22
Size of disc (mm)	460x3	460x3	460x3	460x3	460x3	460x3
Working width (mm)	1100	1300	1500	1700	1900	2100
Working depth (mm)	50-150	50-150	50-150	50-150	50-150	50-150
Weight (kg)	200	220	256	270	310	326
Matched tractor (hp)	15-20	15-20	20-35	30-50	50-60	50-60

AF1BJTX OFFSET TRAILED OR MOUNTED MEDIUM-SIZED DISC HARROW



Model	AF1BJTX-2.6	AF1BJTX-2.8	AF1BJTX-3.0
Number of disc	24	26	28
Diameter of disc(mm)	560	560	560
Working width(mm)	2600	2800	3000
Working depth(mm)	150-200	150-200	150-200
Weight (kg)	900	950	1000
Tractor(hp)	70-90	80-100	100-120

AF1BQDX HANGING PAIR SETTING LIGHT DUTY DISC HARROW



Model	Number of discs	Size of disc (mm)	Working width (mm)	Working depth (mm)	Weight (Kg)	Matched power (HP)
AF1BQDX-1.25	16	460X4	1250	50-150	301	35-40
AF1BQDX-1.6	20	460/510X4	1600	50-150	364-380	44-50
AF1BQDX-1.95	24	460/510X4	1950	50-150	407-430	50-60
AF1BQDX-2.3	28	460/510X4	2300	50-150	459-487	60-75
AF1BQDX -2.65	32	460/510X4	2650	50-150	487-519	75-85
AF1BQDX-3.0	36	460/510X4	3000	50-150	530-600	85-100

HANGING MEDIUM-SIZED DISC HARROW

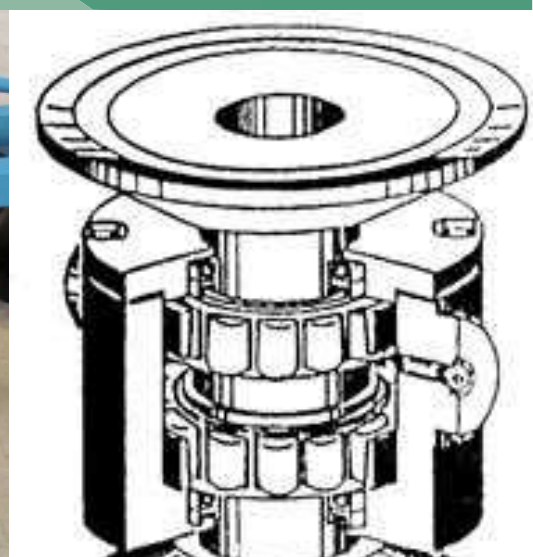

Model	AF1BJX-1.6	AF1BJX-1.8	AF1BJX-2.0	AF1BJX-2.2	AF1BJX-2.4	AF1BJX-2.6	AF1BJX-2.8
Number of disc	14	16	18	20	22	24	26
Diameter of disc(mm)	560	560	560	560	560	560	560
Working width(mm)	1600	1800	2000	2200	2400	2600	2800
Working depth(mm)	150-200	150-200	150-200	150-200	150-200	150-200	150-200
Weight (kg)	418	445	472	540	650	680	800
Tractor (hp)	50-60	50-60	55-75	55-75	70-80	70-80	80-100

AF1BQDX-G SERIES HANGING SQUARE TUBE PAIR SETTING LIGHT DUTY DISC HARROW

LIGHT DUTY "X" TYPE DISC HARROW

Standard Features - High tensile, heat treated notched discs.
Easy gang adjustment with locking device. Light duty grease bath
bearings per gang. Adjustable disc scrapers(optional).



Model	AF1BQDX-1.25G	AF1BQDX-1.6G	AF1BQDX-1.95G	AF1BQDX-2.3G
Number of disc	16	20	24	28
Working width (mm)	1250	1600	1950	2300
Working depth(mm)	50-150	50-150	50-150	50-150
Disc spacing (mm)	175	175	175	175
Dia. of disc	18"	18"	20"	20"
Weight (kg)	390	450	520	540
Tractor power (hp)	30-40	40-50	50-60	60-75

AF1BJDX SERIES MIDDLE-DUTY PAIR SETTING DISC HARROW

Model	AF1BJDX-2.2	AF1BJDX-2.6	AF1BJDX-3.0	AF1BJDX-3.4
Number of disc	20	24	28	32
Dia. of disc	22"	22"	22"	22"
Thickness of disc(mm)	4	4	4	4
Working width(mm)	2200	2600	3000	3400
Working depth(mm)	150-200	150-200	150-200	150-200
Disc spacing (mm)	225	225	225	225
Square tube size (mm)	80x80x8	80x80x8	80x80x8	100x100x8
Weight (kg)	750	830	910	1065
Tractor power (hp)	60-70	70-80	90-100	100-120

AF1BJ HYDRAULIC PRESSURE OFFSET MEDIUM-SIZED DISC HARROW



Model	Number of disc	Size of disc	Working width (mm)	Working depth (mm)	Weight (kg)	Matched tractor (hp)
AF1BJY-4.0	36	560x4	4000	150-200	1900	100-120

AF1BZ HYDRAULIC PRESSURE OFFSET HEAVY DISC HARROW



Model	AF1BZ-1.8	AF1BZ-2.0	AF1BZ-2.2	AF1BZ-2.5	AF1BZ-3.0	AF1BZ-3.5
Number of disc	16	18	20	24	28	32
Size of disc (mm)	660*5					
Working width (mm)	1800	2000	2200	2500	3000	3500
Linkage	Tractor trailed					
Working depth (mm)	180-220					
Weight (kg)	1100	1200	1380	1510	1650	1890
Tractor (hp)	70-80	80-90	100-120	120-150	150-180	180-250

AF1BZX HYDRAULIC PRESSURE OFFSET HEAVY DISC HARROW



Model	AF1BZX-2.0	AF1BZX-2.2	AF1BZX-2.35	AF1BZX-2.5	AF1BZX-3.0	AF1BZX-3.5
Number of disc	18	20	22	24	28	32
Diameter of disc(mm)	660*6					
Working width (mm)	2000	2200	2350	2500	3000	3500
Weight (kg)	1740	2050	2150	2250	2450	2950
Tractor (hp)	85-95	95-100	100-130	130-160	140-180	180-250
Disc spacing	9"(230mm)					
Axle size	Square or round 1.4/7"(40mm)					
Depth cut	7"-8.5/8"(180-220mm)					
Bearing assembly	Grease or oil bath					

AF1BZY HYDRAULIC PRESSURE OFFSET HEAVY DISC HARROW



Model	Number of disc	Size of disc	Working width (mm)	Working depth (mm)	Weight (kg)	Matched tractor (hp)	Note (Bearing Assembly)
AF1BZY-1.8	16	610x6	1800	150-200	1420	70-85	Grease or oil bath
AF1BZY-2.0	18	660x6	2000	180-220	1580	85-100	Grease or oil bath
AF1BZY-2.2	20	660x6	2200	180-220	1660	100-120	Grease or oil bath
AF1BZY-2.5	24	660x6	2500	180-220	2100	125-150	Grease or oil bath
AF1BZY-3.0	28	660x6	3000	180-220	2300	150-180	Grease or oil bath
AF1BZY-3.5	32	660x6	3500	180-220	2850	150-180	Grease or oil bath
AF1BZY-4.0	36	660x6	4000	180-220	3100	180-220	Grease or oil bath

AF1BZZ HYDRAULIC PRESSURE OFFSET HEAVY DISC HARROW



Model	Number of disc	Size of disc	Working width (mm)	Working depth (mm)	Weight (kg)	Matched tractor (hp)	Overall size (mm)
AF1BZZ-16	16	760X8	2800	200-280	3600	150-180	7800X3500X1300
AF1BZZ-20	20	760X8	3400	200-280	3920	180-200	7900X4100X1300
AF1BZZ-24	24	760X8	4000	200-280	4420	200-240	8200X5000X1300
AF1BZZX-20	20	810X10	3300	200-300	4250	180-220	7900X4100X1300
AF1BZZX-24	24	810X10	3900	200-300	4800	200-300	8200X5000X1300
AF1BZZX-28	28	810X10	4500	200-300	5300	200-300	8500X5900X1300
AF1BZZX-32	32	810X12	5000	200-300	9600	350-500	8800X6800X1300

AF1BZD HYDRAULIC PRESSURE PAIR SETTING HEAVY DUTY DISC HARROW



Model	AF1BZD-2.7	AF1BZD-3.2	AF1BZD-3.5
Number of disc	24	28	32
Diameter of disc(mm)	660	660	660
Working width(mm)	2700	3200	3500
Working depth (mm)	200-220	200-220	200-220
Weight (kg)	2100	2500	3000
Tractor(hp)	100-120	100-120	120-150

AF1BZD HYDRAULIC FOLDING HEAVY DUTY DISC HARROW



Model	AF1BZD-6.5	AF1BZD-7.5	AF1BZD-8.5	AF1BZD-9.0	AF1BZD-9.5
Number of disc	64	72	80	84	88
Diameter of disc (mm)	660				
Working width (mm)	6500	7500	8500	9000	9500
Working depth (mm)	180-220				
Weight (kg)	7000	7200	7500	7650	8300
Tractor (hp)	300	350	400	400	500

AF1BQD HYDRAULIC PRESSURE CONTRAPOSITION FOLDING LIGHT HARROW



Model	Number of disc	Diameter of disc (mm)	Working width (mm)	Working depth (mm)	Weight (kg)	Tractor (hp)
AF1BQD-7.2	84	460	7200	100-150	2917	120-150

AF3ZT FIELD CULTIVATOR



Model	AF3ZT-5	AF3ZT -7	AF3ZT -9	AF3ZT-11	AF3ZT-15
No. of tine	5	7	9	11	15
Working depth (mm)	200-250	200-250	200-250	200-250	200-250
Working width (mm)	1200	1500	2100	2850	3000
Matched power(hp)	30-40	50-65	60-80	60-80	80-110
Weight (kg)	200	255	315	370	520

AF3ZTZ USBOILER CULTIVATOR



Model	No. Of tines	Workin width (mm)	Working depth (mm)	Weight (kg)	Matched power (hp)	Overall size (mm)
AF3ZTZ-5	5	2000	200-400	750	100-125	2200X2400X1350
AF3ZTZ-7	7	3000	200-400	950	130-150	3400X2400X1350
AF3ZTZ-9	9	4000	200-400	1150	160-180	4400X2400X1350

AF1LHST SPRING SUBSOILER PLOW



Model	No. Of tines	Working width (mm)	Working depth (mm)	Weight (kg)	Matched power (hp)	Overall size (mm)	No of wheel
AF1LHST-5-2	5	2000	300-500	1146	800-100	3000X3000X1350	2
AF1LHST-7-2	7	3000	300-500	1467	100-120	4000X3000X1350	2
AF1LHST-9-2	9	4000	30-500	1856	140-160	5000X3000X1350	2
AF1LHST-11-2	11	5000	300-500	2186	160-200	6000X3000X1350	2
AF1LHST-11-4	11	5000	300-500	2300	160-200	6000X3000X1350	4
AF1LHST-13	13	6000	300-500	2710	200-240	7000X3000X1350	4

AF1LHS CHISEL PLOW



Item	No. of tine(pc)	Working depth (mm)	Working width (mm)	Weight (kg)	Matched power (hp)
AFILHS -5	5	200-350	1200	200	55-75
AFILHS -7	7	200-350	1500	260	80-100
AFILHS -9	9	200-350	1800	350	110-150

ROOT RAKE



Type	AFIBDR-92-8-5X5	AFIBDR1-110-9-6X6	AFIBDR2-140-10-6X6
Tube	5"X5" 1/2" WALL	6"X6" 1/2" WALL	6"X6" 1/2" WALL
Tooth thickness	1 1/4"	1 1/2"	2"
Width	92"	110"	140"
No. of tooth	8 teeth	9 teeth	10 teeth
Spacing	11 3/4"	11 3/4"	13 3/8"
Max penetration	14"	18"	21"

REAR BLADE



Model	AFBXH-7	AFBXH-8	AFBXH-10
Working width (mm)	2100	2400	3000
Bucket height (mm)	600	600	600
Overall dimension (mm)	2200x1550x2200	2500x1550x2200	3000x1550x2200
Weight(kg)	310	340	360
Matched power (hp)	50-60	50-60	60-80
Packing dimension (mm)	2300*800*600	2600*800*600	3100*800*600

BOX SCRAPER



Item	Overall depth(mm)	Working width (mm)	Weight (kg)	Matched power (hp)
AFSBX-4	547	1220	135	18-25
AFSBX-5	547	1530	170	25-30
AFSBX-6	547	1830	205	40-50
AFSBX-7	547	2135	240	50-60
AFSBX-8	547	2440	270	50-60

AF1LX SHARE PLOW



Model	Number of Share	Working Depth (mm)	Working Width (mm)	Weight (kg)	Tractor (hp) Required
AFILX-325	3	250-300	750	374	50-60
AFILX-425	4		1000	480	70-90
AFILX-525	5		1250	580	100-120
AFILX-330	3		900	632	80-100
AFILX-430	4		1200	736	120-140

AF1L FURROW PLOW



Model	No. of ploughshare	Working width of ploughshare	Working width (mm)	Working depth (mm)	Weight (kg)	Tractor (HP)
AFIL-220	2	200	400	150-240	66	15-24
AFIL-320	3	200	600	150-240	118	25-35
AFIL-420	4	200	800	150-240	148	30-35
AFIL-325	3	250	750	150-240	158	30-45
AFIL-425	4	250	1000	150-240	195	40-50
AFIL-525	5	250	1250	150-240	255	55-80
AFIL-330	3	300	900	200-350	260	50-80
AFIL-430	4	300	1200	200-350	360	60-80
AFIL-530	5	300	1500	200-350	470	90-120
AFIL-335	3	350	1050	200-350	320	55-80
AFIL-435	4	350	1400	200-350	410	60-80

AF1LF SWIVEL PLOUGH



Model	No of plowshare	Series of plowshare	Working width of one plowshare (mm)	Total working width (mm)	Working depth (mm)	Way of reversed	Matched power (HP)	Weight (kg)
AFILF-320	3	20	200	600	150-240	Hydraulic	25-35	260
AFILF-327	3	27	270	810	150-240	Hydraulic	40-60	420
AFILF-427	4	27	270	1080	150-240	Hydraulic	55-80	520
AFILF-527	5	27	270	1350	150-240	Hydraulic	80-100	780
AFILF-627	6	27	270	1620	150-240	Hydraulic	80-120	900
AFILF-727	7	27	270	1890	150-240	Hydraulic	90-140	1200
AFILF-330	3	30	300	900	200-350	Hydraulic	50-80	680
AFILF-430	4	30	300	1200	200-350	Hydraulic	60-80	880
AFILF-530	5	30	300	1500	200-350	Hydraulic	90-120	1200
AFILF-630	6	30	300	1800	200-350	Hydraulic	130-200	1500
AFILF-335	3	35	350	1050	200-350	Hydraulic	50-80	750
AFILF-435	4	35	350	1440	200-350	Hydraulic	90-155	920
AFILF-535	5	35	350	1750	200-350	Hydraulic	120-155	1230
AFILF-635	6	35	350	2100	200-350	Hydraulic	130-200	1550
AFILF-735	7	35	350	2450	200-350	Hydraulic	160-240	1900

AF1K SERIES FURROWER (RIPPER FURROWER)



Model	Unit	AFIK-1	AFIK-2	AFIK-3	AFIK-4	AFIK-5
Number of Coulter		1	2	3	4	5
Working width	mm	1000	1800	2700	3700	4700
Working depth	mm	300	300	300	300	300
Space of coulter	mm	600-900 adjustable	600-900 adjustable	600-900 adjustable	600-750 adjustable	600-750 adjustable
Tractor power	hp	20-30	30-50	50-70	80-120	120-180
Rough weight	kg	100	190	280	370	450

AF1GQN ROTAVATOR



Model	Working width (mm)	Working depth (mm)	Speed (r/min)	Overall Dimensions (mm)	Weight (kg)	Matched power (HP)
AF1GQN-125	1250	Dry working:100—140 Water working120—160	540/720/1000	960×1456×1096	260	18–30
AF1GQN-140	1400			960×1656×1096	270	30–40
AF1GQN-150	1500			960×1756×109	285	45–55
AF1GQN-160	1600			960×1856×1096	380	50–60
AF1GQN-180	1800	Dry working: 140—160 Water working 160—180		2100×1020×1150	400	60–80
AF1GQN-200	2000			2300×1020×1150	410	70–90
AF1GQN-230	2300			2650×1020×1150	428	80–100
AF1GQN-250	2500			2850×1020×1150	450	100–120
AF1GQN-300	3000			3350×1020×1150	480	120–150

AFCDR FERTILIZER SPREADER



Model	Capacity (L)	Spreading Width (m)	Net Weight (kg)	Tractor Required (hp)
AFCDR-400	260	10-16 (Adjustable)	75	25-50
AFCDR-600	400	10-16 (Adjustable)	85	25-50

AF2CDRX DOUBLE DISC SPREADER



Model	Capacity (L)	Spreading Width (m)	Weight (kg)	Matched Power (hp)
AF2CDRX-800	800	16-24 (Adjustable)	320	60-80
AF2CDRX-1100	1100	16-24 (Adjustable)	445	80-100
AF2CDRX-1400	1400	16-24 (Adjustable)	470	80-120

AF3ZFZ CULTIVATOR WITH FERTILIZER DISTRIBUTOR



Model	Overall size (LxWxH)(mm)	Weight (kg)	Workin width (mm)	Rows No. (row)	Rows distance (mm)	Fertilizer box capacity (L)	Matched power (hp)	Work efficiency (Mu/h)
AF3ZFZ-6	1800x4500x1750	920	4500	6	600-800	510	130-180	101.2
AF3ZFZ-8	1800x4500x1750	1300	6000	8	600-800	510	180-220	120.6

AF3ZF CULTIVATOR WITH FERTILIZER DISTRIBUTOR



Model	AF3ZF-4	AF3ZF-6	AF3ZF-8
No. of rows	4	6	8
Working depth (mm)	100-150	100-150	100-150
Working width (mm)	2000	2800	3600
Working height (mm)	400-600	400-600	400-600
Matched power (hp)	50-70	60-80	90-100
Overall size (mm)	2190*900*1150	2800*900*1150	3600*900*1150
Weight (kg)	220	300	400

AF9G MOWER



Model	Overall Dimension			Cutting Width	Cutting Height	Weight	Linkage	Matched Power
	width	length	height					
Unit	mm	mm	mm	mm	mm	kg	3 point mounted	Hp
AF9G-1.0	1200	1400	800	1000	100-300	260		18-30
AF9G-1.5	1700	1900	900	1500	100-300	362		25-55
AF9G-1.8	2000	2200	960	1800	100-300	442		55-75
AF9G-2.1	2300	2500	960	2100	100-300	594		70-100

AF9GY MOWER



Model	Overall Dimension			Cutting Width	Cutting Height	Weight	Linkage	Matched Power
	width	length	height					
Unit	mm	mm	mm	mm	mm	kg		hp
AF9GY-4.5	4700	4900	600	4500	100-300	2000	Traction	100-150

AF9GD SERIES MOWER



Model	Overall Dimension w*I*h(mm)			Cutting Width (mm)	Cutting Height	Weight (kg)	Linkage	Matched Power (hp)
AF9GD-1.5	1550	2300	850	1500	100-300	436	3 point mounted	30-70
AF9GD-1.8	1850	2500	850	1800	100-300	528		70-100

AF9GH MOWER



Model	Cutting width (mm)	Cutting height (mm)	Number of blades	Blade turn speed (rpm)	Size L*W*H (mm)	Weight (kg)	Matched power
AF9GH-3.0	3000	40-140	4	810	2850X3300X1230	880	70hp or above

AFEM FINISHING MOWER



EM series mower is made with advanced American technologies. Mainly applicable for grazing harvesting. finishing of golf courses and other large lawn, with compact structure and advanced performance.

AF9GB RECIPROCATING LAWN MOWER



Item	Unit	AF9GB-1.4	AF9GB-1.6	AF9GB-1.8	AF9GB-2.1
Working width	mm	1400	1600	1800	2100
Cutting heigh	mm	60-80	60-80	60-80	60-80
Matched power	Hp	12-22	12-22	18-45	25-55
Working speed	Km/h	6-8	6-8	6-8	6-8

Model		AF7CP-5
Capacity (Ton)		5
No. of wheels		4
Box size(Length X Width X Height) (mm)		5500X1500
Tow bar length (mm)		1500
Overall size(Length X Width) (mm)		7000X1500
Net weight (kg)		2000
Length(mm)		4600
Width(mm)		2150
Weight(kg)		1200

AF4UM-2 CASSAVA HARVESTER



Model	Unit	AF4UM-2
Size	mm	2320*1616*1350
Net Weight	Kg	260
Number of rows	row	2
Row space of harvest	m	0.82-1.1
Matched Power	HP	80-100
Working Speed	Km/h	3-5
Efficiency	hm ² /h	0.4-0.6

AF2BXF WHEAT SEEDER



Model:		AF2BXF-9	AF2BXF-12	AF2BXF-14	AF2BXF-16	AF2BXF-20	AF2BXF-24
Seeding Rows		9	12	14	16	20	24
Overall Dimensions (mm)	L	1630	1630	1630	1630	1955	1955
	W	1750	2250	2450	2800	3486	3800
	H	1100	1100	1100	1100	1550	1550
Weight	kg	290	350	400	450	1200	1500
Power required	Hp	12-18hp	20-50hp	28-55hp	45-80hp	70-120hp	100-150hp
Rows spacing	mm	160	150	160	155	150	150
Opening share of seeding and fertilizing		Double-disc types					
Depth of seeding		20-50mm(adjustable)					
Fertilizing depth		60~80mm(adjustable)					
Linkage		Three-point rear suspension					
Fertilizer rate(kg/Acre)		0-420(adjustable)					
Working efficiency (Acre/hour)		0. 60-1. 0	1.20-1.50	1.40-1.70	1. 60-1.80	4.0-7.5	4.0-7.5

AF2BYF CORN FERTILIZER SEEDER



Model	Unit	AF2BYF-3	AF2BYF-4	AF2BYF-5	AF2BYF-6	AF2BYF-7
Variety crop		maize ,beans , peanut				
Adjusting mode of seeding		Suspension type automatic adjustment				
Seeding and fertilizer rows	row	3	4	5	6	7
Overall size	cm	180*140*98	250*140*98	320*150*120	390*150*120	460*150*110
Drilling width	mm	1500	2100	2800	3500	4200
Rows spacing	mm	500-670(adjustable)				
Plant spacing	mm	80-300(adjustable)				
Fertilization depth	mm	60-80	60-80	60-80	60-80	60-80
Drilling depth	mm	30-50	30-50	30-50	30-50	30-50
Seeding case capacity	kg	24	32	40	48	56
Fertilizer case capacity	kg	75	100	125	150	175
Working speed	Km/h	5-8	5-8	5-8	5-8	5-8
productivity	Ha/h	0.5-0.7	0.5-0.8	0.67-1	1-1.2	1.2-1.6
weight	kg	200	260	320	380	480
Matched power	HP	25-45	50-70	60-80	80-120	100-120

AF3W SPRAYER MOUNTED TYPE



Model	AF3W-400-6	AF3W-500-8	AF3W-800-12	AF3W-1000-12	AF3W-1200-18
Capacity (L)	400	500	800	1000	1200
Boom Width (m)	6	8	12	12	18
No. of sprayers	12	16	24	24	36
Spray-head Spacing (mm)	500	500	500	500	500
Flow rate of the working speed (L/min)	80	80	120	120	150
Matched Power (HP)	30-40	40-50	55-75	80-100	120-150

SPRAYER TRAILED TYPE



Model	AF3W-1500-18	AF3W-2000-18	AF3W-3000-21
Matched power (hp)	55-120	55-120	70-120
Capacity (L)	1500	2000	3000
Boom width (m)	18	18	21
No. of spray-head	36	36	42
Liquid pump rate (L/min)	200	200	200
Net weight (kg)	1100	1150	1290
Linkage	Traction	Traction	Traction
Overall dimension (mm)	3200*3500*2600	3600*3500*2600	4000*3500*2600

DISC BLADES AND PARTS

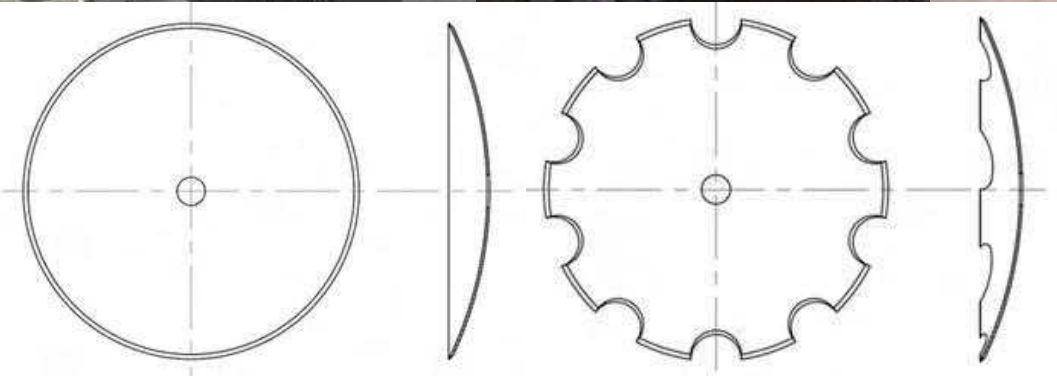

DIAMETER		THICKNESS		WEIGHT PLAIN		WEIGHT NOTCHED	
MM	INCH	MM	INCH	KG	LBS	KG	LBS
300	12"	3	1/8"	1.6	3.5	1.1	2.4
330	13"	3	1/8"	1.8	4	1.2	2.6
360	14"	3	1/8"	2.3	4.9	1.9	4.1
410	16"	3	1/8"	3.2	7	2.7	5.9
460	18"	3	1/8"	4.3	9.5	3.8	8.4
460	18"	3.5	1/7"	4.6	10.2	4.1	9
510	20"	3.5	1/7"	5.8	12.7	5.6	11.5
510	20"	4	2/13"	6.5	14.4	5.8	12.7
560	22"	4	2/13"	8.1	18	7.5	16.5
560	22"	4.5	2/11"	9	20	8.5	18.7
560	22"	5	1/5"	9.5	21.6	9	19.8
560	22"	6	15/64"	12	26.5	11	24.2
610	24"	5	1/5"	11.3	25	10.5	23.1
610	24"	6	15/64"	14.2	31.5	13	28.6
660	26"	5	1/5"	14.1	31	13	28.6
660	26"	6	15/64"	17	37.5	15.8	34.8
660	26"	7	9/32"	20	43.5	18.5	40.7
660	26"	8	5/16"	23	51	21	46
710	28"	6	15/64"	20	44	18.5	40.7
710	28"	7	9/32"	23	50.6	21.5	46
710	28"	8	5/16"	26	57.2	24	52.1
760	30"	8	5/16"	29	64	28	61.5
760	30"	10	3/8"	35	77	33.5	73.7
810	32"	8	5/16"	35	77	33	75
810	32"	10	3/8"	43	95	40	68
910	36"	12	1/2"	68	150	60	132
960	38"	12	1/2"	77	170	70	154
1016	40"	12	1/2"	82	180	77	169.4
1116	44"	12	1/2"	89	196	84	184.8

BEARING ASSEMBLY

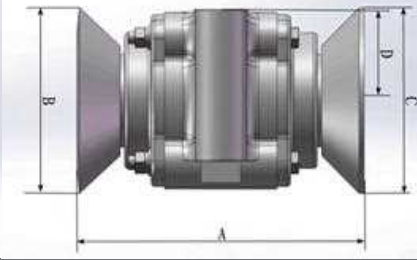
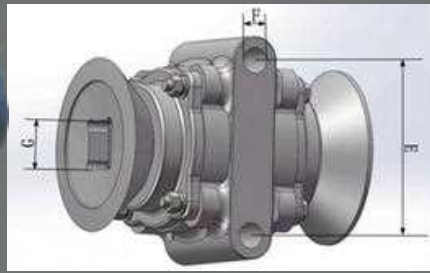

Model	A (mm)	B (mm)	C (mm)	D (mm)	E (mm)	F (mm)	G (mm)	H (mm)	Lubricant
AFYT-100	235	158	139	76.5	162	φ20	42.5	Φ40-55	Grease
AFYT-115	235	158	139	75	162	φ20	42.5	Φ40-55	Grease
AFYT-120	230	135	135	84.5	163	φ25.5	44	Φ40-60	Grease
AFYT-140	230	143	140	86	154	φ22	44	Φ40-60	Grease
AFYT-155	232	178	158	84	155	φ22	42.5	Φ40-55	Grease
AFYT-160	234	158	138	73	153	φ22	42	Φ40-55	Grease
AFYT-165	234	158	138	72.5	150	φ22	41	Φ40-55	Grease
AFZH-170	230	158	138	76	170	φ22	41	Φ40-55	Grease
AFZH-QB-165	165	110	110	57	125	Φ19	28		Grease
AFZH-QB-175	175	110	110	57	125	Φ19	28		Grease
AFZH-QB-195	195	110	110	57	125	Φ19	28		Grease
AFZH-225	225	162	140	68	155	Φ26	32	Φ30-45	Grease
AFZH-230	230	180	160	89.5	156	Φ24*30		Φ30-45	oil bath
AFZH-182	182	140	130	80.6	112	Φ19*25		Φ30-45	oil bath
AFZH-225A	225	140	130	80.6	112	Φ19*25		Φ30-45	oil bath
AFZH-225	225	180	160	93.6	148	Φ24*30		Φ40-50	oil bath
AFZH-262	262	180	160	93.6	148	Φ24*30		Φ40-50	oil bath
AFZH-364	364	200	180	108	230	Φ26*35		Φ50-65	oil bath

BEARING ASSEMBLY



Items	Weight (kg)	Dia. of hub (mm)	Dia. Of Hole (mm)	Axle (mm)	Bearing
AFYT-R12	12	160	120	45	32208/3209

SPACER



Length (mm)	Sq. (mm)	Round (mm)	Material
165	□28		Nodular cast iron
175	□28		Nodular cast iron
195	□28		Nodular cast iron
225	□32-40	Φ30-40	Nodular cast iron
237	□32-40	Φ30-40	Nodular cast iron
250	□32-40	Φ30-40	Nodular cast iron
270	□32-40	Φ30-40	Nodular cast iron
340	□32-45	Φ40-60	Nodular cast iron
364	□32-45	Φ40-60	Nodular cast iron

INNER/OUTER WASHER



Sq. (mm)	Round (mm)
28	Φ30
32	Φ40
38	Φ45
40	Φ60
42	

SQUARE/ ROUND AXLE



Length X ϕ 25 mm

Length X 22mm

Length X ϕ 28 mm

Length X 25 mm

Length X ϕ 32 mm

Length X 28 mm

Length X ϕ 38 mm

Length X 32 mm

Length X ϕ 40 mm

Length X 38 mm

Length X ϕ 60 mm

Length X 40 mm

Length X 60 mm

Length X 42 mm

HARROW TINE

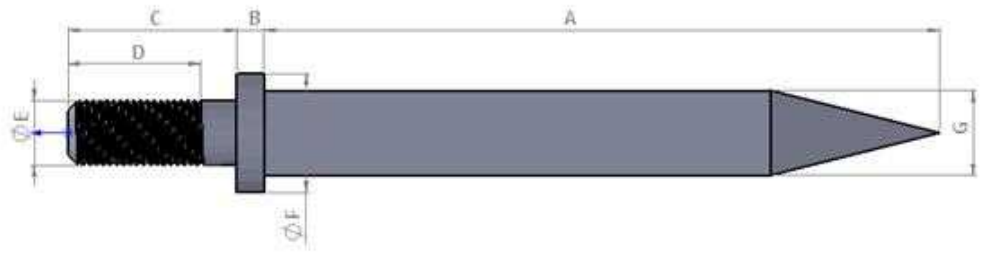

Model	A (mm)	B (mm)	C (mm)	D (mm)	E (mm)	F (mm)	G (mm)
AFSDYT-16	As need	8	As need	As need	M16	As need	□16
AFSDYT-19	As need	8	As need	As need	M19	As need	□19
AFSDYT-22	As need	8	As need	As need	M20	As need	□22
AFSDYT-25	As need	8	As need	As need	M24	As need	□25
AFSDYT-32	As need	8	As need	As need	M27	As need	□32
AFSDYT-40	As need	8	As need	As need	M30	As need	□40

SUGARCANE BLADE



Items	Length (mm)	Width (mm)	Thickness (mm)
305x63.5x25	305	63.5	25
337x57x25	337	57	25
311x50x25	311	50	25

MOWER BLADE



Items ms	Length (mm)	Width (mm)	Thickness (mm)
419.4-20	788	76	12
430.4-02	700	76	12
410.10-03	720	76	12
409.0-02	470	76	12
9G1.0	300	60	10
9G1.5	500	60	10
9G1.8	600	60	12
9G1.0	300	60	10
260*90*4	260	60	4
260*90*5	260	90	5
260*90*6	260	90	6

ROTARY WHEEL

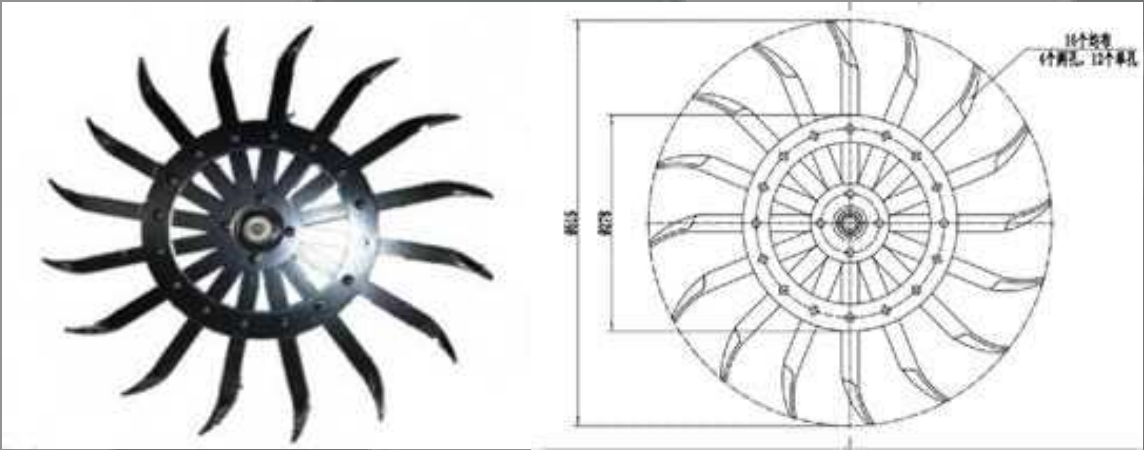

Items	Diameter (mm)
Wheel-1	500
Wheel-2	515
Wheel -3	540

PLOUGH TINE



Items	Length (mm)	Width (mm)	Thickness (mm)	Material	Weight (kg)
460*50*16	460	50	16	60Si2Mn	3.4
400*60*16	400	60	16	60Si2Mn	3.4
300*60*12	300	60	12	60Si2Mn	1.8
200*40*6	200	40	6	60Si2Mn	0.45

BREAK SHOVEL



Model	A (mm)	B (mm)	C (mm)	D (mm)	E (mm)	F (mm)
AFSDYT-C01	145	70	157	42	/	□11
AFSDYT-C02	148	112	280	73	50	□13
AFSDYT-C03	152	94	165	52	45	□13
AFSDYT-C04	185	85	183	63	45	□13
AFSDYT-C05	205	90	225	50	36	□13
AFSDYT-C06	240	105	270	68	45	□13

PARTS FOR OX PLOUGH

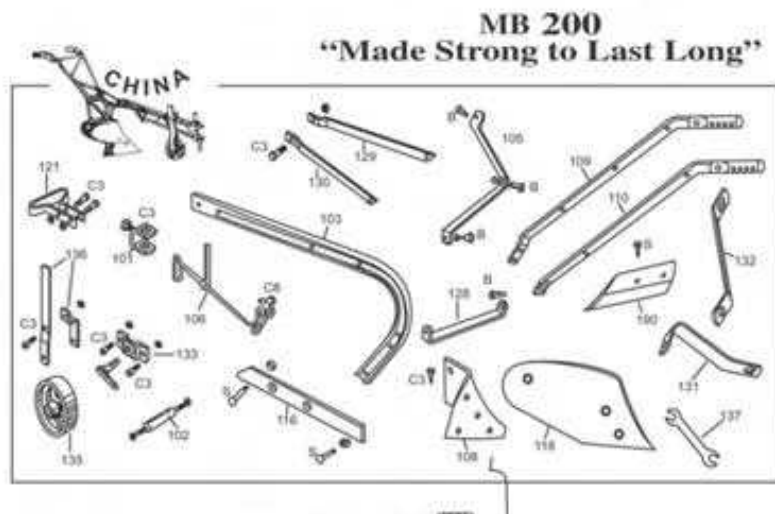

Item	Name	Quantity for a set	Weight (kg)
109	Handle bar	2	2.15
128	Spreader bar	1	0.5
105	Cross brace	1	0.85
129	Handle	2	0.35
118	Mouldboard	1	3
190	Plow point	1	1.35
108	Frog	1	3.2
116	Landside plain	1	1.3
131	Stay beam to mouldboard	1	0.4
132	Stay handle to mouldboard	1	0.4
103	Beam	1	9.5
135	Wheel	1	1.15
136	Lift assembly to regulate	1	1.25
133	Fixing assembly to regulate	1	0.3
106	Drawn bar assembly	1	2.3
121	Regulator	1	1.1
101	Adjusting bar hold	1	0.25

POTATO PLANTER



The potato planters researched and produced by STAR have the high complexity, high accuracy, high adaptation and other advanced characteristics, and are able to complete a series of operations at one time, such as ditching, planting, ridging, fertilization and spraying. The Company adopts advanced vibration and tensioning seeding unit technology, with a low seed leakage rate and repeated seeding rate and a high seeding accuracy for those planters. In the meantime, it uses precise planting unit and accurate control planting depth technologies to increase the adaptation of products. Each performance index and quality index passes the verification by Shandong Provincial agricultural machinery test and verification and various products meet relevant quality standards and obtain an agricultural machinery promotion and verification certificate. The new model of potato planters are used to greatly facilitate the planting and production of potatoes, reduce labor strength, increase productivity ratio, and decrease production cost with its comprehensive benefit enhanced obviously.

AF2CM-4 Potato Planter



POTATO PLANTER

AF2CMX-4/2 Potato Planter



▲ 2CMX-4



▲ 2CMX-2

AF2CMX-4Q Potato Planter



POTATO PLANTER

AF2CMX-1/2 / 2CMXQ-2 Potato Planter



AF2CMX-1/2



2CMXQ-2

AF5ZB-5B Seed Mixer (Mix powder/farm chemicals)



AF5ZT Potato seed cutter



POTATO PLANTER

AF3WP-1500-21/24 Mounted Boom Sprayer



AF3WP-21/120 Front-mounted Sprayer



AF3WP-3000-24 Trailed Boom Sprayer



POTATO HAULM CUTTER



The potato haulm cutter is used to cut haulm before the harvest of potatoes, and able to complete the cutting, sorting and shunting operation of haulm at one time. Also, haulm are cut to return to fields for the purpose of increasing the organic contents of soils. The machine is in a trifilar suspension type and can be mounted at the rear of tractor to operate independently, for the convenience of adjusting ridge spacing. The positions of long and short cutter in different ridge spacing are mainly adjusted by virtue of moving the positions of cutter and top bushing, effectively enlarge the adjustment scope of ridge spacing.

AF4JM-180/360B Potato Haulm Cutter



AF4JM-180



AF4JM-360B

POTATO HARVESTER

POTATO MECHANIZATION



The potato harvester is a machine to replace the manual digging and laying of potatoes. The potato planting areas in China are extensive and scattered. STAR has developed various specifications of potato harvesters according to different harvest needs of different places. Potato harvester produced by the company have the characteristics of low bruising rate and damage rate, high harvesting efficiency exposed rate. Ensure the harvest quality of potatoes and saving production cost.

AF4UL-170Z/4UL-170C Potato Combine Harvester



AF4UL-170Z



AF4UL-170C

POTATO HARVESTER

AF4UL-170D/170E Potato Harvester with Bagging

AF4UL-170D



AF4UL-170E

AF4UQ-170A/4UX-170G Potato Harvester



AF4UQ-170A



AF4UX-170G

POTATO HARVESTER

AF4UX-165 /170A /180B Potato Harvester



AF4UX-160 Potato Harvester



POTATO HARVESTER

AF4UZ-100 Self-propelled Potato Digger



AF4UX-100/100D/120 Potato Digger



SORTING & HANDLING EQUIPMENT

AF5SY-8 Trailer



AF5XF-80 Receiving Hopper



AF5XF-40/60 Receiving Hopper



AF5XF-40



AF5XF-60

SORTING & HANDLING EQUIPMENT

AF5S1-40 Single-layer conveyor



AF5S2-40 Double-layer conveyor



AF5XW-40 Handling Platform (mesh sieve type)



AF5SZ-40/60 Sooper



▲ AF5SZ-40



▲ AF5SZ-60

SORTING & HANDLING EQUIPMENT

AF5SD-40/80/60 Piler



AF5SD-40/80



AF5SD-60

AF5SG-40 Loading Conveyor



AF5SZC-40 Loading Conveyor



IRRIGATION SOLUTION

To meet the needs of our customers and dealers, we produce irrigation equipment of the highest quality and with the highest cost-effectiveness. In accordance with high standards of irrigation equipment. We use high-quality components from such companies as UMC, Komat, Schneider, American Eagle, Omron and Chaoyang. We design and manufacture custom irrigation equipment according to the specifics and needs of our clients.



ELEMENTS OF IRRIGATION MACHINES

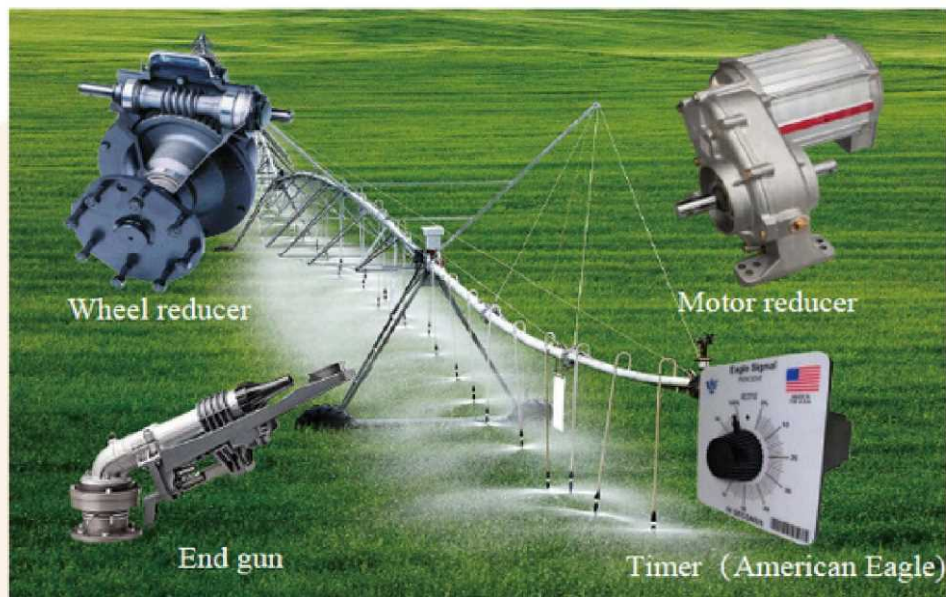

DETAILS SHOW



Water pipe



Tire



Collector Ring



Tower



Coupler



Coupler



Remote control system



IRRIGATION EQUIPMENT



Center Pivot Irrigation machinery



Four-Wheel Linear
Irrigation machinery



Two-Wheel Linear
Irrigation machinery



Reel Irrigation Machinery

WOOD CHIPPERS

Model# AFD 160

6INCH
(16CM)



Length	3.36 m / 11 ft ; 3.17m /10.5 ft while transport
Width	1.39 m / 4.6 ft
Height	2.18 m / 7.15 ft
Weight	730kg / 1610 lbs

Feeding		Chipping	
Hopper	1.24m /4.1 ft wide, foldable with bracket	System	Disk with open top
Throat (w*h)	30*16 cm / 11.8*6.3 inch	Dia.	67cm / 26.5 inch
Feeding	iFS no-stress system	Blade	2 reversible blades
Roller	Single on top with teeth combi.	Anvil	Bottom and side anvils

Output		Trailer	
Output	360 degree rotatable	Speed limits	60 mph/ 96 kmph
Deflector	90 degrees deflectable		

Work spec.		Hydraulic	
Load	12-16 cbm/hour	Hydraulic oil tank	25L
Chips	5-15mm		

Power			
Gasoline	35hp, V-twin engine	Fuel tank	25 L
Diesel	Yanmar, 25hp, 3 cylinders, water cooled	Fuel tank	25 L

Model# AFR 130



5INCH
(13CM)

Length	2.74 m / 8.98 ft
Width	1.25 m / 4.1 ft
Height	1.75 m / 5.74 ft
Weight	383kg / 844 lbs

Feeding	
Hopper	Gravity feeding with panic bar
Throat (w*h)	36*18.7cm / 14.2*7.4 inch

Output	
Output	360 degree rotatable
Deflector	90 degree deflectable



Chipping	
System	Drum with impeller on both sides
Blade	2 reversible blades
Anvil	One reversible anvil

Power			
Gasoline	23hp, V-twin engine	Fuel tank	12 L
Diesel	20hp, 2 cylinders, air cooled	Fuel tank	6 L

COMMERCIAL

Model# AFR 180 PTO

**7INCH
(18CM)**



Technical specification

Length : 2370 mm / 7.8 ft

Width : 1400 mm / 4.6 ft

Height : 2000 mm / 6.6 ft

Weight : 612 kg / 1349 lbs

Output: 12-16 m³/hour

Recommended max diameter : 180 mm / 7 inch

Chip system

Type: Drum with impeller on both sides

Blades : 2 reversible

Feeding system

Throat size (W×H) :

450 x 370 mm / 17.7*14.6 inch

Single roller with Variteeth

Hopper

Width : 1240mm / 48.8 inch

Operate height: 750mm / 29.5 inch

Tractor hitch

3-point linkage Category 1

Power PTO 45hp+ (70hp+ for 7 inch)

PTO 540 rpm

Electrical system 12V

Safety elements

Safety bar, emergency stop

Accessories

Cardan shaft L= 900 mm (6-6)

Accessories options

iFS control system / catagory 2 coupler

Model# AFL 22



Technical specification

Length: 1600 mm / 5.25 ft

Width: 1100 mm / 3.6 ft

Height: 1800 mm / 5.9 ft

Weight: 235 kg / 518 lbs

Impeller

Diameter: 400 mm / 15.7 inch

Width: 160 mm / 6.3 inch

Number of impellers: 4 with precut

Intake hose

Lenth: 3.5 m / 11.5 ft

Diameter: 220 mm / 8.7 inch

Engine

Power output: 8.8 kW

Fuel tank capacity: 6 L

Start electric

Accessories

Nozzle with wheels Ø 220 mm

Tailgate hang kit

Connector



Model# AFM 100 WD

Technical specification

Length: 1500 mm / 4.92 ft
Width: 765 mm / 2.5 ft
Height: 1720 mm / 5.65 ft
Weight: 220 kg / 485 lbs
Output: 3-5 m³/per hour
Max. diameter: 100 mm / 4 inch

Chip system

Type: drum
Width: 300 mm / 12 inch
Number of blades: 2 reversible

Hopper

Throat size: 510 x 420 mm / 20*16.5 inch
Timer included

Discharge

360 degree rotatable

Power options

Option#1. Gasoline engine, single cylinder
Power output: 8.8 kW @ 3600 rpm
Fuel tank capacity: 6.5 l

Option#2. Diesel engine, single cylinder
Power output: 7.7 kW @ 3600 rpm
Fuel tank capacity: 6.0 l

Self propell chassis

Speed FWD - 2 Stage
Max speed: stage one/ 3km/h
stage two/ 6km/h
REV Speed
Max speed: 5km/h
Work time: 90 mins at full speed
Climbing capacity: 15 degree max

Tyre

16 6.5-8 tubeless



SEMI-COMMERCIAL

Model# AFM 100



Technical specification

Length: 1400 mm / 4.6 ft
Width: 800 mm / 2.6 ft
Height: 1650 mm / 5.4 ft
Weight: 185 kg / 407 lbs.
Output: 4-6 m³ per hour
Max. diameter: 100 mm / 4 inch

Chip system

Type: drum
Width: 300 mm / 12 inch
Number of blades: 2 reversible

Hopper

Throat size: 510 x 420 mm / 20* 16.5 inch

Discharge

with lower discharging window
360 degree rotatable optional

Chassis

Three wheels chassis

Power options

Option#1. Gasoline engine, single cylinder

Power output: 8.8 kW @ 3600 rpm

Fuel tank capacity: 6.5 l

Option#2. Diesel engine, single cylinder

Power output: 7.7 kW @ 3600 rpm

Fuel tank capacity: 6.0 l

Option#3. Electric motor, 3 phases

Power output: 7.5 kW (control unit included)

Tyre

16 6.5-8 tubeless

Model# AFM 100 PTO



Technical specification

Length: 1250 mm / 4.1 ft
Width: 780 mm / 2.6 ft
Height: 1500 mm / 4.9 ft
Weight: 180 kg
Output: 4-8 m³ per hour
Max. diameter: 100 mm / 4 inch

Chip system

Type: drum
Width: 300 mm / 12 inch
Number of blades: 2 reversible

Hopper

Throat size: 510 x 420 mm / 20*16.5 inch

Discharge

with lower discharging window
360 degree rotatable optional

Drive

Power PTO 15 - 45 HP

PTO 540 rpm

Hitch system: three-point category 1

Accessories

6-6 shaft

RESIDENTIAL

Model# AFM 80



Technical specification

Length: 2125 mm / 6.97 ft
Width: 695 mm / 2.28 ft
Height: 1200 mm / 3.94 ft
Weight: 150 kg / 330 lbs
Output: 3-5 m³ per hour
Max. diameter: 100 mm / 4 inch

Chip system

Type: drum
Width: 210 mm / 8.3 inch
Number of blades: 2 reversible

Hopper

Operate height: 920 mm / 36 inch
Throat size: 520 x 475 mm / 20.5*18.7 inch

Discharge

3 directions turn able

Chassis

ATV towable

Engine

Gasoline engine, single cylinder
Power output: 8.8 kW @ 3600 rpm
Fuel tank capacity: 6.5 l
Start electric optional

Tyre

16" 4.5-8 tube

Model# AFM 60



Technical specification

Length: 1760 mm / 5.8 ft
Width: 600 mm / 1.97 ft
Height: 1100 mm / 3.6 ft
Weight: 85 kg / 187 lbs
Output: 3 m³ per hour
Max. diameter: 80 mm / 3 inch

Chip system

Type: drum
Width: 210 mm / 8.3inch
Number of blades: 2 reversible

Hopper

Operate height: 850 mm / 33.5 inch
Throat size: 520 x 460 mm / 20.5*18 inch

Engine

Gasoline engine, single cylinder
Power output: 4.9 kW @ 3600 rpm
Fuel tank capacity: 3.5 l

Tyre

13" 5.0-6 solid

Model# AFM 40



Technical specification

Length: 1600 mm / 63 ft
Width: 500 mm / 19.7 ft
Height: 1050 mm / 41.3
Weight: 55 kg / 120 lbs
output: 2-3 m³ per hour
Max. diameter: 60 mm

Chip system

Type: drum
Width: 105 mm / 4.1 inch
Number of blades: 2 reversible

Hopper

Operate height: 750 mm / 29.5 inch
Throat size: 395 x 330 mm / 15.6*13 inch

Power option

Option#1. Gasoline engine, single cylinder
Power output: 4.4 kW @ 3600 rpm
Fuel tank capacity: 3.1 l

Tyre

10" 3.5-4 solid

AFYF320

SKID STEER LOADER



Parameter	Metric	U.S.
Max working height	2479 mm	97.59 inch
Max pin height	1926 mm	75.82 inch
Max dumping height	1398 mm	55.03 inch
Max dumping distance	100 mm	3.94 inch
Max dumping angle	53°	53°
Rollback of bucket on ground	32°	32°
Departure angle	18°	18°
Total height	1185 mm	46.65 inch
Ground clearance	1100 mm	43.30 inch
Wheel base	653 mm	25.71 inch
Overall length without bucket	1552 mm	61.1 inch
Total width	990 mm	38.97 inch
Bucket width	1080 mm	42.52 inch
Total length with bucket	1992 mm	78.43 inch
Turn radius forward turning	1205 mm	47.44 inch
Engine	Briggs stratton	
Rated Power (KW)	10KW(13.5HP)	13.5Hp
Rotating speed (rpm)	3600	
Noise (Db)	<_95	
Pressure (Mpa)	17	
Raise	4	
Dump	1.3	
Lower	3.2	
Operating Load	260 Kg	573.2 Lb
Bucket capacity	0.08 m ³	3 ft ³
Max lifting force	300 Kg	661.39 Lb
Travel speed	0 - 6 Km/h	3.73 mile/h
Operating Weight	1000 Kg	2204.62 Lb

DOUBLE PUMP DOUBLE VALVE

It adopts double pump and double valve design, with larger flow rate

MULTIPLE CHOICES

There are two options for vehicle width: 1050mm and 820mm, as well as tracked and wheeled.

FOUR-WHEEL DRIVE

Four-wheel drive, more power and more flexible steering.

AUTOMATIC LEVELING

The bucket can be automatically leveled

HIDDEN OIL CYLINDER

The hidden design of the boom cylinder makes the appearance more beautiful.

AFYF480

SKID STEER LOADER



PARAMETER	METRIC	U.S.
Max working height	2474 mm	97.4 inch
Max pin height	1977 mm	77.83 inch
Max Dumping height	1275 mm	50.2 inch
Max Dumping distance	175 mm	6.89 inch
Max Dumping Angle	70°	70°
Rollback of bucket on ground	25°	25°
Departure angle	23°	23°
Total height	1300 mm	51.18 inch
Ground clearance	120 mm	4.72inch
Wheel base	890 mm	35.04 inch
Overall length without bucket	1767 mm	69.57 inch
Total width	1030 mm	40.55 inch
Bucket width	1070 mm	42.13 inch
Total width	1030 mm	40.55 inch
Bucket width	1070 mm	42.13 inch
Total length with bucket	2319 mm	91.3 inch
Turn radius forward turning	1440 mm	56.69 inch
Overall length without the bucket after folding the pedal.	1633 mm	64.29 inch
Rated Power	18.2KW(23HP)	
Rotating speed	3600	
Noise	95	
Pressure	17	
Raise	4	
Dump	1.3	
Operating Load	390 Kg	859.8 Lb
Bucket Capacity	0.13 m3	4.59 ft3
Max Lifting Force	450 Kg	992 Lb
Travel Speed	0-4.5Km/h	2.8 mlie/h
Operating Weight	960 Kg	2116 Lb

ENGINE

Using a top brand high-power EPA engine, lower fuel consumption brings more powerful power output.

HYDRAULIC SYSTEM

Equipped with high-end brand hydraulic main pump, main valve, rotary motor and traveling motor, ensuring the high reliability of the hydraulic system.

OPERATION PANEL

Mini skid steers feature intuitive levers, buttons and control panels that allow operators to effortlessly learn to operate the machine.

MATERIAL

The chassis of a mini skid steer loader is usually made of steel or cast iron for excellent strength and stability.

AFYF1000

SKID STEER LOADER



PARAMETER	METRIC	U.S.
Max working height	2420 mm	95.3 inch
Max pin height	2099 mm	82.7 inch
Max dump height	1617 mm	63.7 inch
The highest point discharge distance	615 mm	24.2 inch
Bucket swing angle	79°	79°
Bucket unloading angle	36°	36°
Opening-closing angle	43°	43°
Angle of departure	30°	30°
Total height	1607 mm	63.3 inch
The height from the ground	300 mm	11.8 inch
Wheelbase	1065 mm	41.9 inch
No bucket length	2200 mm	86.6 inch
Total width	1033 mm	40.7 inch
Bucket width	1140 mm	44.9inch
Total length (L) (with bucket)	2752 mm	108.4 inch
Turning radius (R)	2198 mm	86.5 inch

Engine	Model	D1105-EF02	
	Rated power	18.2KW/25HP	
	Rotating speed	3000	
		95	
Hydraulic System	Hydraulic pressure	20Mpa	
	Cycle time (s)	Raise	Dump Lower
		3.89	1.6 3.65
Performance parameters		Metric	Inch
	Load weight (kg)	300 Kg	667 Lb
	Bucket capacity	0.14 m³	4.95 ft³
	Max lifting power	1258Kg	2795.6 Lb
	speed	0-8Km/h	0-4.972mlie/h
	Operating weight	1775kg	3944lb
Main pump		Qty: 2+1	
Flow of main pump		67.2L/min	
Valve		Qty :2	

AFYF1000

SKID STEER LOADER



CUSHION

Engineering outdoor comfortable cushion, waterproof and corrosion-resistant.



OPERATING

PLATFORM Lufthansa Italian hydraulically operated valve.



QUICK CONNECTOR

Universal accessory connector.



HYDRAULIC SYSTEM

Closed pump valve system imported from Italy.



HYDRAULIC OIL PIPE

German Continental brand oil pipe, hidden design.

PARAMETER	METRIC	U.S.
Rated Power (KW)	18.4(25Hp)	18.4(25Hp)
Operating Weight	1538 Kg	3390 Lb
Rated Operating Capacity	454 kg	1000 Lb
Ground Pressure (Rubber)	2800 Kg/ m2	3.98 Psi
Auxiliary Std Flow	45 L/Min	12 Gal/Min
Rotating speed (Rpm)	2800	
Noise (Db)	95	
Tipping Load	1315 KG	2898 Lb
Travel Speed	5.8 Km/h	3.52 Mph
Travel Speed – Reverse	3.9 Km/h	2.4 Mph
Fuel Tank	25 L	6.6 Gal
Hydraulic oil tank capacity	22 L	5.8 Gal
Pump Capacity	45 L/ Min	12 Gal/Min
System Relief @ Quick Couplers	200 Bar	2900 Psi

PARAMETER	METRIC
Engine model	Perkins 403J-11
Emissions Tier	EU NRM 97/68/EC Stage 5EPA Tier 4 Final
Engine Cooling	Liquid
Engine Fuel	Diesel
Displacement	1.131 L
Number of Cylinders	69 in3

AFYF30-125

SKID STEER LOADER



PARAMETER	JC30
Operating load (kg)	300
Max Speed (km/h)	9
Rated flux (L/min)	50
High Flow Flux (L/min)	/
Tire (track) model	23*8.5-15
Rated power (Kw)	18.4
Fuel tank capacity (L)	25
self weight bucket (kg)	1500
Bucket capacity (m ³)	0.2
Overall operating height (mm)	3590
Height to bucket hinge pin (mm)	2650
Hheight to top of cab (mm)	2050
Height to bottom of level bucket(mm)	2470
Without bucket length (mm)	2430
Overall length with bucket(mm)	3170
Dumping angle at maximum height(0)	40
Dumping height(mm)	1920
Dumping reach(mm)	720
Rollback o bucket on ground(*)	30
Rollback of bucket at full height(0)	104
Wheelbase(mm)	801
Ground clearance(mm)	180
Angle of departure(0)	20
Front turning radius without bucket(mm)	971
Front tuning radius(mm)	1681
Rear tuning radius(mm)	1371
Rear axle to bumper (mm)	940
Tread width (mm)	882
Width (mm)	1110
Bucket width (mm)	1150

AFLM500 PRO

LAWN MOWER

Integrated circuit controller; one-button emergency stop, safer. Steel push rod motor, more reliable. The coil of the walking motor is thicker, the power is increased, and it is more stable. 24V40A "Chaowei" enhanced battery, longer working hours. Spiral mulchers, made of boron steel, can adapt to high, dense and strong mowing environments, and are more efficient.

REMOTE CONTROL



PARAMETER	METRIC
Overall size	930*900*640
Package Size	990*990*810
Total Weight	150KG
Package weight	186KG
cutting width	500mm
cutting height	20-150mm
Walking speed	4KM/H
voltage power	24V40A
climbing	45°
Cutter adjustment	remote lift
power	9.5 HP
fuel tank capacity	1.2L
fuel consumption	1.2L/H
oil capacity	0.6L
mowing efficiency	1500m ² /H

AFLM500A

LAWN MOWER



REMOTE CONTROL



PARAMETER	METRIC
Overall size	900*930*520
Package Size	950*980*670
Total Weight	140kg
Package weight	170kg
cutting width	500mm
cutting height	20-150mm
Lifting method	Manual (remote control)
Walking speed	4km/h
voltage power	24V24AH
Start mode	Remote control start and stop
Climb 45°	45°
Self-generating system	
integrated circuit controller	
Standard power	RV225 Euro 5
fuel tank capacity	1.2L
Fuel consumption	1.2L/H
Oil capacity	0.6L

AFLM800

LAWN MOWER



REMOTE CONTROL



PARAMETER	METRIC
Machine size	1100*1240*660
Package size	1150*1290*840
Machine weight	255KG
Packing weight	310KG
Cutting width	800mm
Cutting height	20-150mm
Walking speed	5KM/H
climbing	45°
Cutter adjustment	remote lift
Power	16HP
Fuel tank capacity	7.1L
Oil capacity	1.2L
Mowing efficiency	3800M2/H

Install the starter battery

Remote start, remote stop, wireless integrated control system. One-button emergency stop, safer; steel push rod motor, more reliable. The coil of the walking motor is thickened, the power is increased, and it is more stable; the 24V40A "Chaowei" enhanced double battery makes the working time longer. Spiral lawn mower, made of boron steel, suitable for high-density and strong mowing environment, with higher efficiency.

Crawler walking, suitable for harsh and uneven terrain, strong climbing ability, applicable environment: orchards, parks, gardens, road maintenance, villa gardens, pioneering, etc.

AFLM800PRO

LAWN MOWER



A single operator's productivity with the LM800 PRO can be compared to the productivity of 10+ operators with the mower.

PARAMETER

Engine type	25hp gasoline engine 764cc V-twin cylinder
Starting system	electric startup and remote startup
Walking speed	0-8km/h
Cutting system	flying blades
Cutting width	80cm
Max slope	50 degrees
Machine weight	330kg
Size	1300*1160*700mm

Main features:

1. Power supply: Equipped with a powerful Loncin twin-cylinder 26-horsepower engine, it can cut small strips and shrubs up to 30 mm in diameter.
2. Excellent slope mowing capability: Effectively and quickly mows grass on slopes up to 50 degrees.
3. Passability: The unique shape and structure enable the Black Shark to penetrate hard-to-reach places.
4. High-performance, high-power motors: 2 powerful high-torque traveling motors ensure strong driving force even on rugged terrain and slopes.
5. The vehicle structure adopts high-strength steel pipe welding, double-row wheel design and track shock absorption system to ensure stable operation on any road surface.
6. Comes with 4 eyebolts for secure anchoring and lifting.
7. 3 sets of high-efficiency cooling systems.
8. Emergency stop: If the machine loses the radio control signal, the machine will stop immediately. There is also an emergency stop button on the fuselage. When you stop using these emergency buttons, you will need to repeat the startup procedure to get back to work.
9. Double rows of support rollers, crawler walking, high-intensity mowing, suitable for harsh and uneven terrain, and strong climbing ability.

AFGRO CONSTRUCTION & FENCING

AFGRO – design, supply and construct various steel construction units through our subsidiary (PREFABSA), these include: warehouse (storage areas), workshops, chicken units, hydro/aqua-ponics, abattoirs, housing, schools and clinics and other prefabricated buildings and alternative power solutions.

Our Building Concepts

1. Warehouses

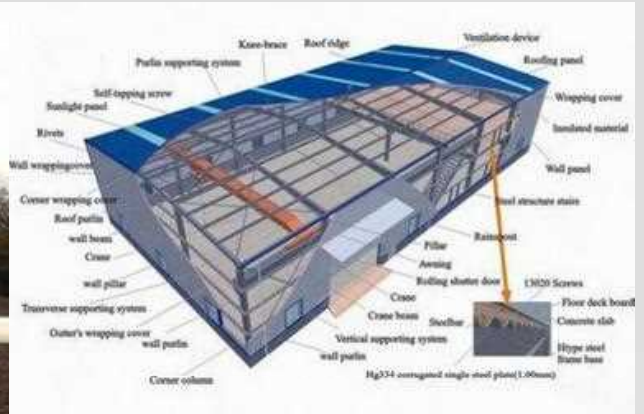

2. Workshops (with overhead crane)



3. Housing units



Worker Houses



4. Chicken Units



5. Schools and Clinics



5. Hydro / Aqua - ponics



7. FENCING AND ANIMAL HANDLING

AFGRO fencing and animal handling division will do a turn-key solution for the farmer, and will trailer the fences and kraal to the individuals needs.

Electric fencing



Clear View - fence / security fence and gates



Cattle handling facilities



8. Solar power and lighting

AFGRO has a solar division that do solar power, solar lighting as well as solar CCTV systems.

Solar power



Solar Lighting





AFGRO

FARM EQUIPMENT



www.afgro.co.za



+27 62 859 7336



chris@afgro.co.za