

HX



3



LONDON

HARBOUR EXCHANGE - E14

REFURBISHED AIR-CONDITIONED OFFICES WITH SPECTACULAR VIEWS

3 HARBOUR EXCHANGE HAS UNDERGONE A COMPREHENSIVE REFURBISHMENT INCLUDING A NEW RECEPTION, ENHANCED COMMON AREAS AND REFURBISHMENT OF THE AVAILABLE OFFICE FLOOR



DESCRIPTION

3 Harbour Exchange is an impressive glass clad building, providing bright and efficient office floors which are wrapped around an off-set core. The building offers high quality office accommodation, with stunning views towards the O2 at Greenwich Peninsular, together with the iconic towers of Canary Wharf.

The area benefits from an exciting mix of local coffee bars and restaurants. The South Quay DLR station is adjacent to the entrance of the site, whilst the Canary Wharf estate, which benefits from the Jubilee line and extensive retail amenities, is only a 10 minute walk away.

The estate has been comprehensively re-landscaped adding improved amenities which helps contribute to a tranquil business environment.

SPECIFICATION

- Refurbished entrance hall
- VAV air-conditioning
- Clear floor to ceiling height of 2.7m
- Metal tiled suspended ceiling
- Fully accessible raised floor with 100mm clear void
- 3 Passenger lifts
- Standby generation
- Shower facilities & cycle storage
- 24 hour access and security
- On-site management team
- Generous supply of car parking
- EPC rating – E (111)
- 1:10 sq m occupational density existing
- 1:8 sq m occupational density with enhancements
- Attractive and tranquil waterside environment

AVAILABILITY

FLOOR	SQ FT	SQ M
9th	8,437	783
TOTAL	8,437	783

9TH FLOOR SUGGESTED OPEN PLAN LAYOUT 8,437 SQ FT (783 SQ M)

92 Open Plan Desks
1 x 14 Person Meeting Room
2 x 12 Person Meeting Rooms
1 x 4 Person Meeting Room

92 TOTAL HEADCOUNT
91.7 sq ft / 8.5 sq m per occupant

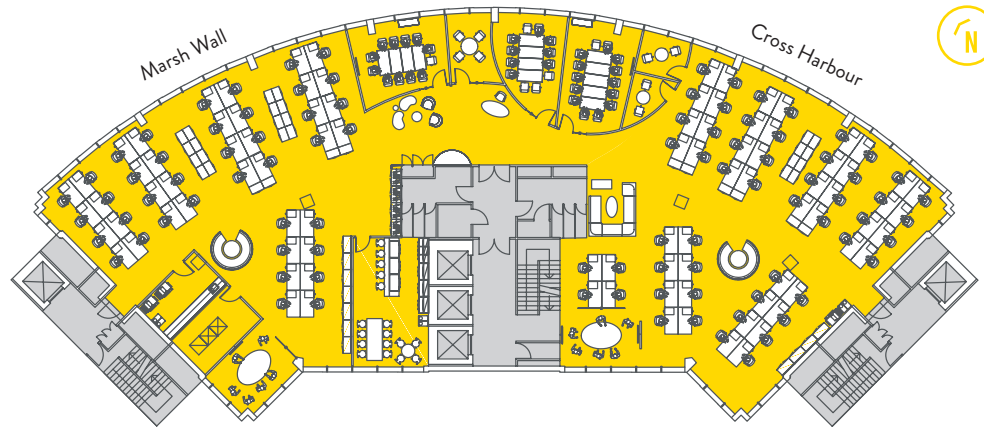

Harbour Exchange Square

9TH FLOOR CELLULAR LAYOUT 8,437 SQ FT (783 SQ M)

33 Open Plan Desks
12 x 1 Person Offices
9 x 2 Person Offices
2 x 12 Person Meeting Rooms
2 x 6 Person Meeting Rooms

63 TOTAL HEADCOUNT
133.9 sq ft / 12.4 sq m per occupant

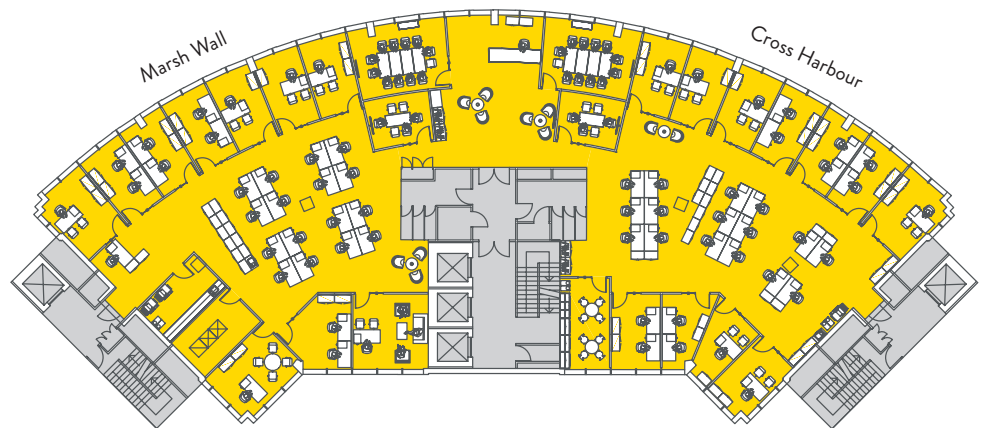

Harbour Exchange Square

For indicative purposes only (not to scale) and subject to on-site verification.



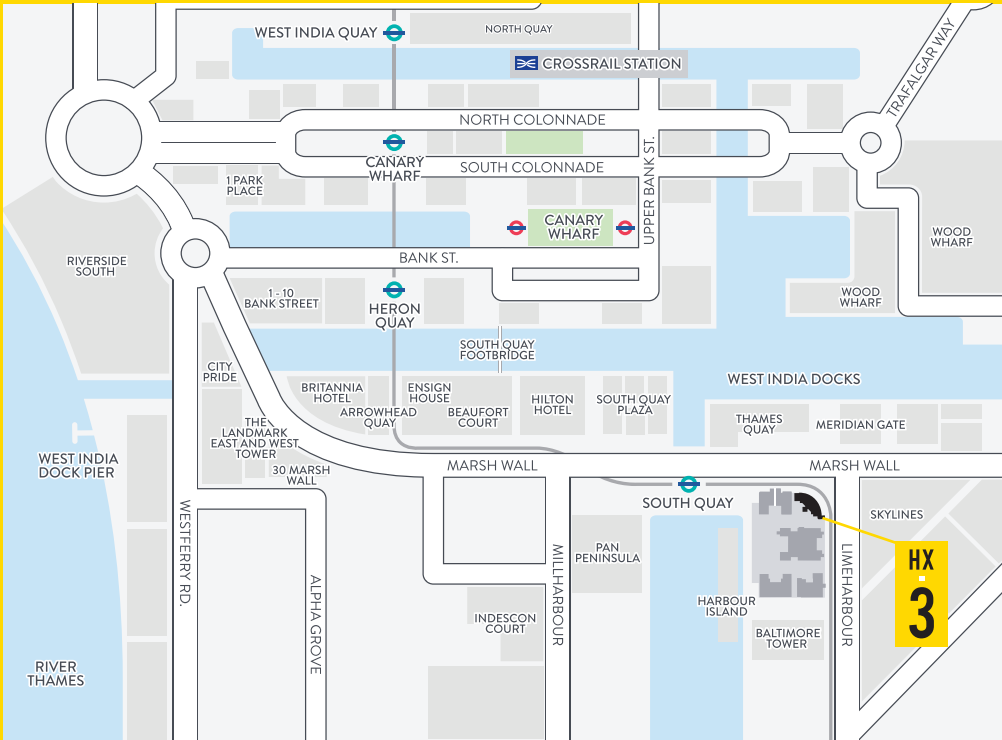

JOURNEY TIMES

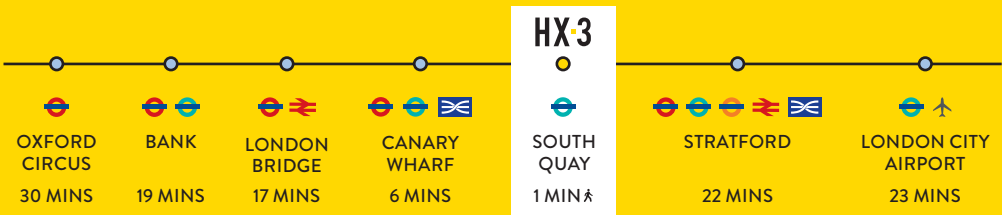

Source: TFL

VIEWING

Viewing by appointment through joint sole letting agents:

GRYPHON PROPERTY PARTNERS

JEREMY TRICE
020 3440 9802
jeremy.trice@gryphonpropertypartners.com

COLIN HARGREAVES
020 3440 9804
colin.hargreaves@gryphonpropertypartners.com

TERMS

Upon application.

KNIGHT FRANK

TOBY PRITCHARD-DAVIES
020 7861 5212
toby.pritchard-davies@knightfrank.com

LARA SAMWORTH
020 7861 1397
lara.samworth@knightfrank.com

DAN GAUNT
020 7861 1314
dan.gaunt@knightfrank.com

WWW.HX3LONDON.COM

IMPORTANT NOTICE Gryphon Property Partners & Knight Frank give notice to anyone who may read these particulars as follows: 1. These Particulars are prepared for the guidance only of prospective purchasers. They are intended to give a fair overall description of the property but are not intended to constitute part of an offer or contract. 2. Any information contained herein (whether in the text, plans or photographs) is given in good faith but should not be relied upon as being a statement or representation of fact. 3. Nothing in these particulars shall be deemed to be a statement that the property is in good condition or otherwise nor that any services or facilities are in good working order. 4. The photographs appearing in this brochure show only certain parts and aspects of the property at the time when the photographs were taken. Certain aspects may have changed since the photographs were taken and it should not be assumed that the property remains precisely as displayed in the photographs. Furthermore no assumptions should be made in respect of parts of the property which are not shown in the photographs. 5. Any areas, measurements or distances referred to herein are approximate only. 6. Where there is reference in these particulars to the fact that alterations have been carried out or that a particular use is made of any part of the property this is not intended to be a statement that any necessary planning, building regulations or other consents have been obtained and these matters must be verified by any intending purchaser. 7. Descriptions Of a property are inevitably subjective and the descriptions contained here in are used in good faith as an opinion and not by way of statement of fact. February 2016.