

MIXTEC

FOR MIXING TECHNOLOGY

*Equipment and
Product Line*

Top Entry Mixers - Open Tank

Flat Base Plate Mounting
1000 Series from .25 HP – 120 HP
4000 Series from 60 HP – 500 HP
CS, SS, Exotic Matls, Rubber Lined

Top Entry Mixers - Closed Tank

2000 Series from 1 HP – 500 HP
Raised Baseplate Mount
Vapor Seals
Mechanical Seals
CS, SS, Exotic Matls, Rubber Lined
2500 Series from 1 HP – 50 HP
ANSI Flange Pedestal Mount
High Shear, Low Retention Time
CS, SS, Exotic Matls, Rubber Lined

Side Entry Mixers

5000 Series from 1 HP – 150 HP
Gear Driven
Single & Double Mechanical Seals
Packed Gland
CS, SS, Exotic Materials
5500 Series from 5 HP – 75 HP
Belt Driven
Shut Off Device
Single & Double Mechanical Seals
Packed Gland
CS, SS, Exotic Materials

Portable Mixers

250 Series from 0.25 HP – 3 HP
Direct Drive or Gear Drive
Angle Bracket Mounting
Clamp Mounting
Angle Riser
Stainless Steel

Inline Static Mixers

Rates from 4 gpm – 7,000 gpm and up
Sizes from 2" – 36" Dia.
Carbon Steel
Stainless Steel
PVC
Poly – P
Exotics

Inline Flash Mixers

Sizes from 8" – 36" Dia. and up
Carbon Steel
Stainless Steel

Specialty Mixers

HS700-High Shear Disc
AS700-Anti Snag Impeller
Anchor Mixer
Ribbon Mixer

Impeller Technology

Hydrofoils
HA700-Efficient
HA715-Standard
HA720-Down Pumping
HA800-Up Pumping
Axial and Radial Flow
HA710-High Pumping
HA725-5 Blade
HA732-Pitched Blade 32°
HA735-BX04
HA736-4 Blade Course Solids
HA745-Pitched Blade 45°
HA757-3 Blade Course Solids
HA790-Rushton Turbine
HA791-4 Blade Radial
HA792-Solvent Extraction
HA793-Curved Blade Turbine
HA794-Curved Blade Anti Vortex
Endless Customized Impellers Available

MIXTEC

FOR MIXING TECHNOLOGY

SHEAR

FLOW

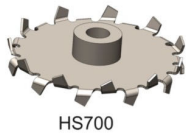

HS700



HA793



HA790

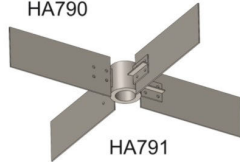

HA791

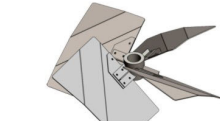

HA736



HA792



HA794

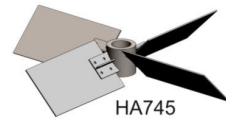

HA745

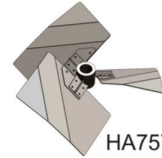

HA757

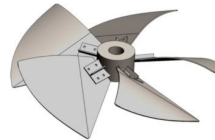

HA725

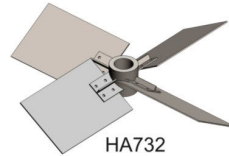

HA732

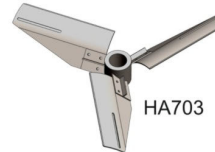

HA703

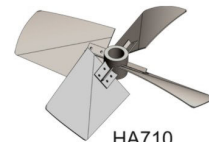

HA710



HA720

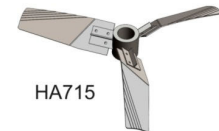

HA715

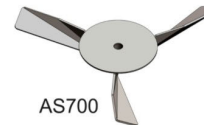

AS700

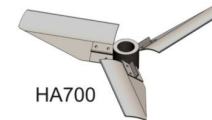

HA700



HA701

LARGE VARIETY
OF IMPELLERS
FOR THE BEST
PROCESS RESULTS