

POT FEEDER

GENERAL WATER SYSTEMS

THIS DRAWING IS FOR SPATIAL CONSIDERATION ONLY, AND SUBJECT TO
CHANGE W/O PREVIOUS NOTICE, DO NOT PRE-PLUMB TO THESE DIMENSIONS

DB-2-GE-316-A			
Operating Point		Up to 500 Gallon System Volume	
Pot Feeder - Size & Style		Dome Bottom 2 Gallon Grooved End	
Construction		316 Stainless Steel	
PROCESS INLET			
Connection - Type & Size		NPT 3/4"	
PROCESS OUTLET			
Connection - Type & Size		NPT 3/4"	
PRESSURE - Maximum Operating			
Vessel		600 psi (41.4 bar)	
TEMPERATURE - Maximum Operating			
System		34°F - 250°F (1°C - 121°C)	
WEIGHTS	DRY	SHIPPING	OPERATING
lbs (kg)	61	63	77

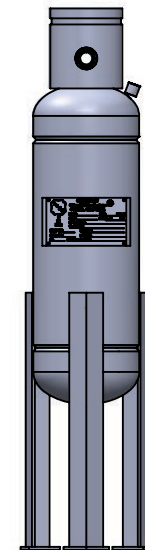
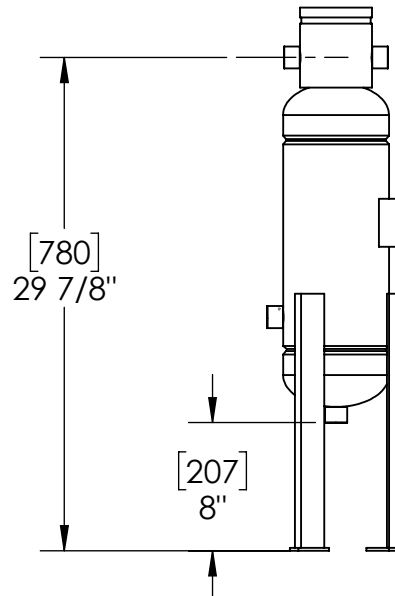
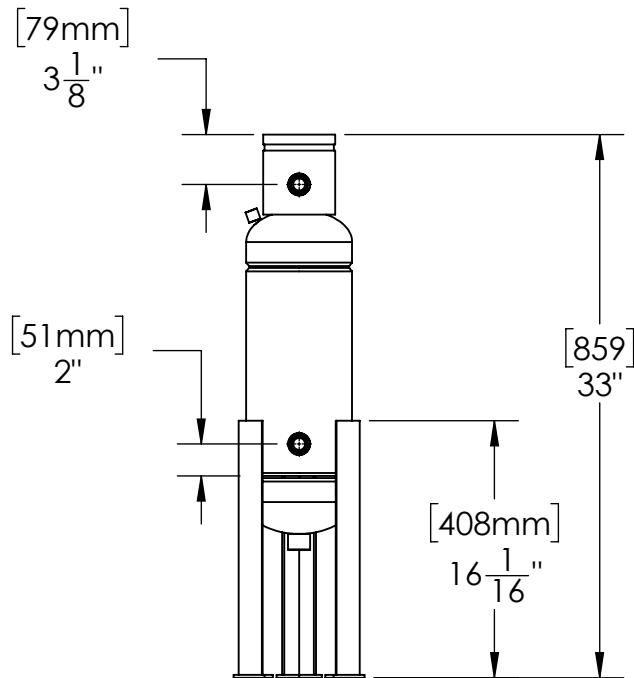
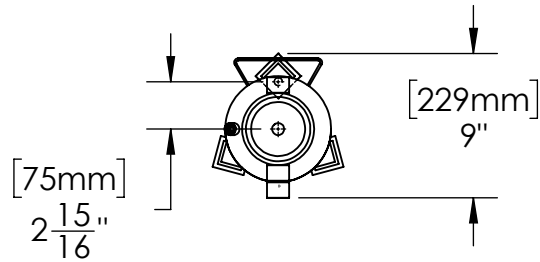

PREPARED BY:
HECTOR J. GUZMAN

REV

A

RELEASED BY:

TIM BOYLEN

DATE:

1/16/2024



General Water Systems | 1525 East 6th Street | CA | 92879

www.gwslp.com | info@gwslp.com | 951.278.8992

*UNLESS OTHERWISE SPECIFIED -
ALL DIMENSIONS ARE IN INCHES

DB-2-GE-316-A