

POT FEEDER

GENERAL WATER SYSTEMS

THIS DRAWING IS FOR SPATIAL CONSIDERATION ONLY, AND SUBJECT TO
CHANGE W/O PREVIOUS NOTICE, DO NOT PRE-PLUMB TO THESE DIMENSIONS

DB-5-SB-316-Z

Operating Point	Up to 5000 Gallon System Volume
Pot Feeder - Size & Style	Dome Bottom 5 Gallon Safety Bar
Construction	316 Stn. Stl. (Welded)

PROCESS INLET

Connection - Type & Size	NPT 3/4"
--------------------------	----------

PROCESS OUTLET

Connection - Type & Size	NPT 3/4"
--------------------------	----------

PRESSURE - Maximum Operating

Vessel	380 psi (26.2 bar)
--------	--------------------

TEMPERATURE - Maximum Operating

System	34°F - 250°F (1°C - 121°C)
--------	----------------------------

WEIGHTS

	DRY	SHIPPING	OPERATING
lbs (kg)	45	47	85

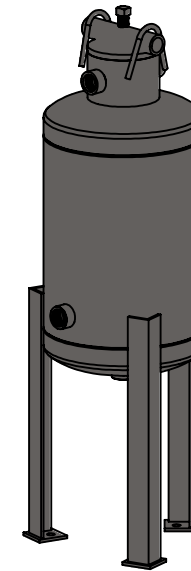
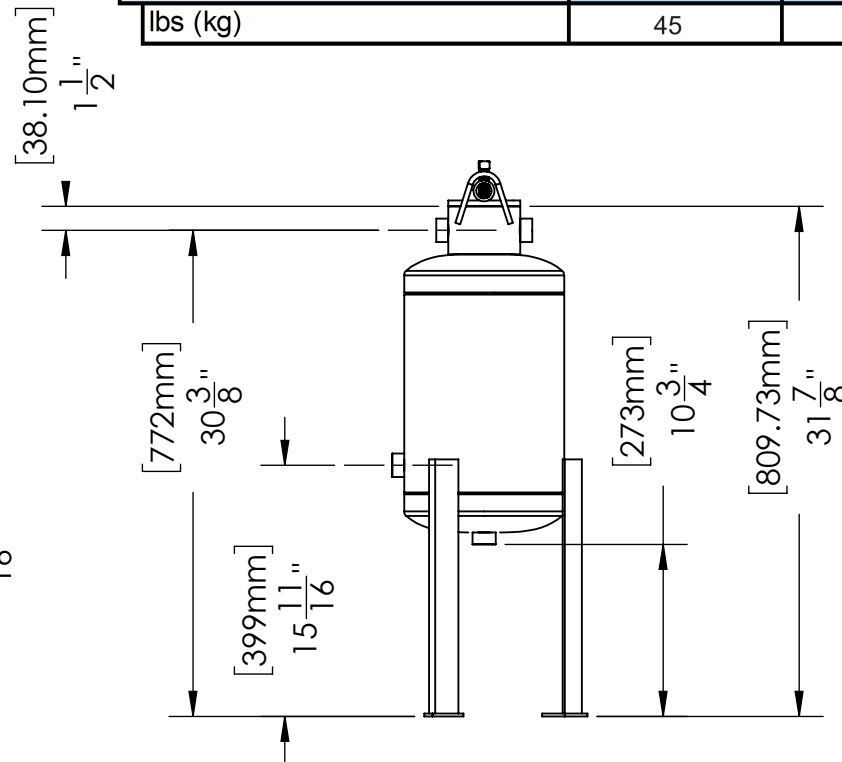
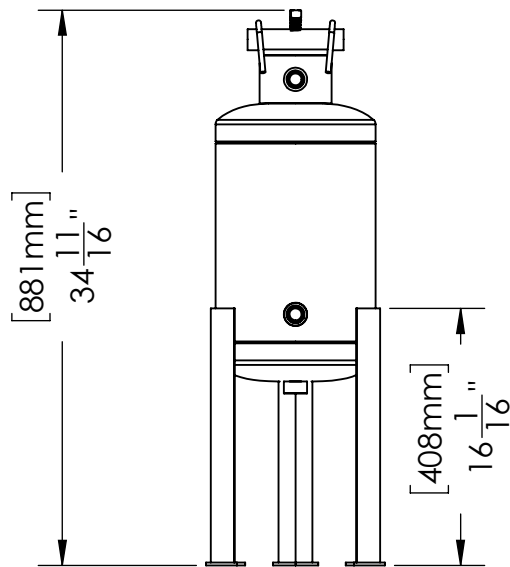
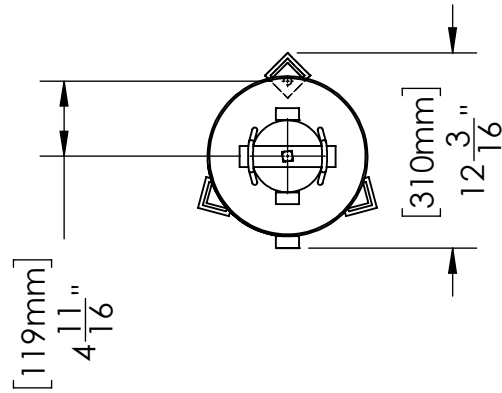

PREPARED BY:
HECTOR J. GUZMAN

REV

A



RELEASED BY:

TIM BOYLEN

DATE:

10/4/2023

General Water Systems | 1525 East 6th Street | CA | 92879
www.gwslp.com | info@gwslp.com | 951.278.8992

*UNLESS OTHERWISE SPECIFIED -
ALL DIMENSIONS ARE IN INCHES

DB-5-SB-316-Z