



ZHEJIANG LIUTONG PLASTIC CO.,LTD.

Address: 6# Gongxin Road
Huangyan
Taizhou City
Zhejiang Province

www.chinapipes.com



SINCE 1994



COMPANY PROFILE

Zhejiang Liutong Plastic Co.,LTD was established in 1994,Through many years development and innovation, now, As the one of the largest manufacturers in East-South of China, Liutong Plastics specialized in pipe and fitting products, such as PVC-U (Unplasticizde polyvinyl chloride) drainage pipe and fittings, PVC-U water-supply pipe and fittings, electrical conduit and fittings,PP-R water-supply pipe and fittings, CPVC tube for high voltage electric power cable protection, PVC resin, plastic valve and fittings, and various injection & extrusion moulds.

Liutong plastics,located in Huangyan city, Zhejiang province, a famous place for plastic products and plastic injection mould in China, with superior geographical location and convenient transport conditions. Especially, company owns many excellent employees in different department. Liutong Plastics ranks the leading position among so many competitors due to product quality, competitive price and product variety. Moreover, it possesses some patent products in different area.

In the past years, its products have been salable all over the domestic market and have entered international market to compete with competitors all over the world.

Our goal is to earn our customers' loyalty and repeat business by:

Supplying the highest quality products at competitive prices.

Maintaining the highest possible level of customer service.

Providing timely delivery for all order.

CONTENTS

Conduit System(UL651).....	01
DWV Pipes & Fittings(ASTM-D-1785 ASTM-D-2665).....	06
Water Supply (ASTM-D-1785 ASTM-D-2466).....	13
NSF Certificate.....	20
UPC Certification.....	20



Conduit System

(UL651)

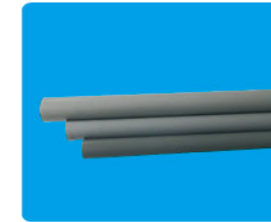

Conduit

Part Number	Trade size of Conduit	Average Outside diameter(Inch)	Average Outside diameter(MM)	Average wallthickness (Inch)	Average wallthickness (MM)
CA01050	1/2"	0.84	21.34	0.12	3.05
CA01075	3/4"	1.05	26.67	0.124	3.15
CA01100	1"	1.315	33.4	0.144	3.65
CA01125	1-1/4"	1.66	42.16	0.152	3.85
CA01150	1-1/2"	1.9	48.26	0.156	3.95
CA01200	2"	2.375	60.32	0.163	4.15
CA01250	2-1/2"	2.875	73.02	0.217	5.5
CA01300	3"	3.5	88.9	0.23	5.85
CA01400	4"	4.5	114.3	0.25	6.35
CA01500	5"	5.563	141.3	0.276	7
CA01600	6"	6.625	168.28	0.299	7.6



90° ELBOWS-one Bell END
90° ELBOWS-Plain END
90° ELBOW-Bell END

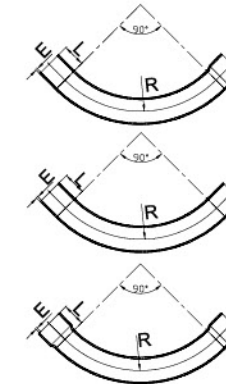

Size	Nom	E	L	R	Part Number
1/2"	3.05	38.1	101.6		CA11050
3/4"	3.15	38.1	114.3		CA11075
1"	3.65	47.63	146.05		CA11100
1-1/4"	3.85	50.8	184.15		CA11125
1-1/2"	3.95	50.8	209.55		CA11150
2"	4.15	50.8	241.3		CA11200
2-1/2"	5.5	76.2	266.7		CA11250
3"	5.85	79.38	330.2		CA11300
4"	6.35	86.73	406.4		CA11400
5"	7	92.08	609.6		CA11500

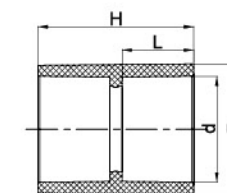

Couplings

Size(Inch)	D	d	L	H	Part Number
1/2"	27.8	21.64	16.6	36.3	CPL-50
3/4"	33.3	27.02	18.3	39.7	CPL-75
1"	41.3	33.78	22.7	48.6	CPL-100
1 1/4"	49.9	42.6	24.3	51.8	CPL-125
1 1/2"	57.2	48.72	27.5	58.2	CPL-150
2"	69.9	60.78	29.1	61.4	CPL-200
3"	100	89.28	41	86.8	CPL-300
4"	127	114.68	50	106.4	CPL-400
6"	184.2	169.11	76.2	160	CPL-600

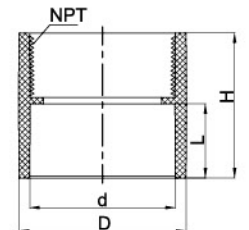

Female Adaptors

Size(Inch)	D	d	L	H	NPT	Part Number
1/2"	27.8	21.64	16.6	36.1	1/2"	FA-50
3/4"	33.3	27.02	18.3	39.7	3/4"	FA-75
1"	41.3	33.78	22.7	50.8	1"	FA-100
1 1/4"	49.9	42.6	24.3	52.4	1 1/4"	FA-125
1 1/2"	57.2	48.72	27.5	55.6	1 1/2"	FA-150
2"	69.9	60.78	29.1	57.2	2"	FA-200
3"	100	89.28	41	77.8	3"	FA-300
4"	127	114.68	50	79.4	4"	FA-400
6"	184.3	169.11	59	103.2	6"	FA-600

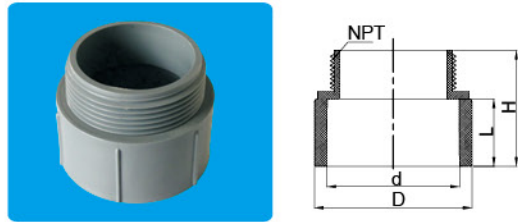

Male Adaptors

Size(Inch)	D	d	L	H	NPT	Part Number
1/2"	27.8	21.64	16.6	33.4	1/2"	FA-50
3/4"	33.3	27.02	18.3	34.9	3/4"	FA-75
1"	41.3	33.78	22.7	46.1	1"	FA-100
1 1/4"	49.9	42.6	24.3	47.2	1 1/4"	FA-125
1 1/2"	57.2	48.72	27.5	50.7	1 1/2"	FA-150
2"	69.9	60.78	29.1	52.4	2"	FA-200
3"	100	89.28	41	67.5	3"	FA-300
4"	127	114.68	50	73.1	4"	FA-400
6"	184.3	169.11	59	98.5	6"	FA-600

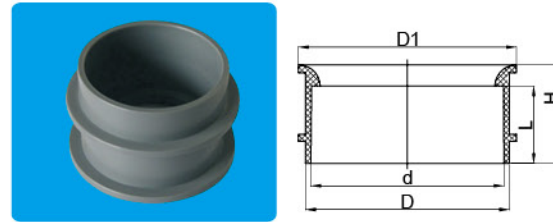

END BELLS

Size(Inch)	D	d	L	H	D1	Part Number
1/2"	26.4	21.64	20.7	24.5	31.8	EB-50
3/4"	31.8	27.02	22.2	26.7	36.8	EB-75
1"	38.7	33.78	23.6	32.5	44.3	EB-100
1 1/4"	47.9	42.6	25.1	33.3	54.4	EB-125
1 1/2"	54	48.72	31.5	39.4	63.5	EB-150
2"	66	60.78	33	39.5	71.9	EB-200
3"	94.5	89.28	42.7	52.1	102.2	EB-300
4"	121	114.68	45.8	58.4	129.5	EB-400
6"	176.2	169.11	56.5	71.8	186.9	EB-600

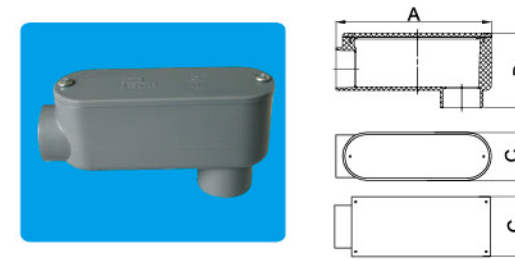

Conduit Bodies and covers Type LB

Size(Inch)	A	B	C	Part Number
1/2"	109.3	58.3	33.5	LB-50
3/4"	126.6	66.5	38	LB-75
1"	152	79.5	44	LB-100
1 1/4"	195	91.1	63.4	LB-125
1 1/2"	219.4	104.1	66.5	LB-150
2"	252.8	120.3	78.2	LB-200
2 1/2"	381.2	174.5	118.7	LB-250
3"	381.2	174.5	118.7	LB-300
4"	129.3	114.68	56.8	LB-400

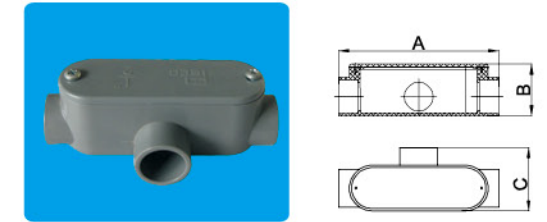

Conduit Bodies and covers Type T

Size(Inch)	A	B	C	Part Number
1/2"	118	41	50.5	T-50
3/4"	137.3	46.7	56.5	T-75
1"	166.2	54.6	68	T-100
1 1/4"				T-125
1 1/2"	235.1	75.5	93	T-150
2"				T-200
3"				T-300
4"				T-400

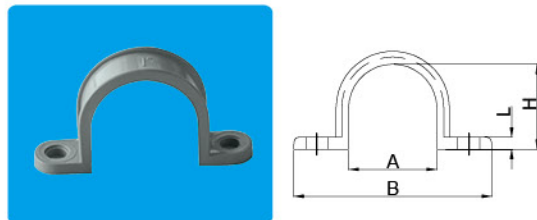

PIPE STRAPS

Size(Inch)	D	B	L	H	Part Number
1/2"	21.3	54.1	3.8	21.2	PS-50
3/4"	26.7	60.2	3.8	26.5	PS-75
1"	33.4	70.4	3.8	33.3	PS-100
1 1/4"	42.2	82.3	3.8	42.0	PS-125
1 1/2"	48.3	91.4	4.1	48.1	PS-150
2"	60.3	106.6	4.5	60.2	PS-200

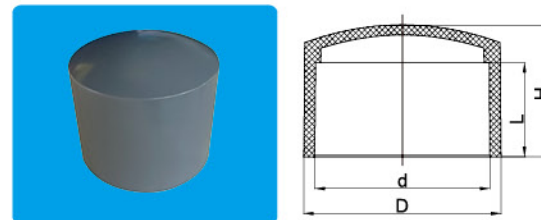

END CAPS

Size(Inch)	D	d	L	H	Part Number
1/2"	26.7	21.64	18.4	25.2	EC-50
3/4"	33.5	27.02	21.8	31.5	EC-75
1"	42	33.78	25.3	36.8	EC-100
1 1/4"	49.1	42.6	26	36.5	EC-125
1 1/2"	55.2	48.72	28.8	41	EC-150
2"	60.76	60.78	32.8	46.2	EC-200
3"	100.7	89.28	48	67.4	EC-300
4"	129.3	114.68	56.8	66	EC-400

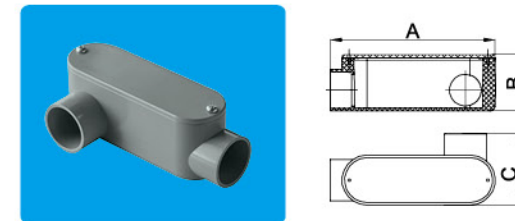

Conduit Bodies and covers Type LR

Size(Inch)	A	B	C	Part Number
1/2"	109.3	41	50.7	LR-50
3/4"	126.6	46.5	57.8	LR-75
1"	152	54.6	68.9	LR-100
1 1/4"	195.2	67.1	88.8	LR-125
1 1/2"	235.4	75.6	95.5	LR-150
2"	253.4	92.3	107.3	LR-200
3"				LR-300
4"				LR-400

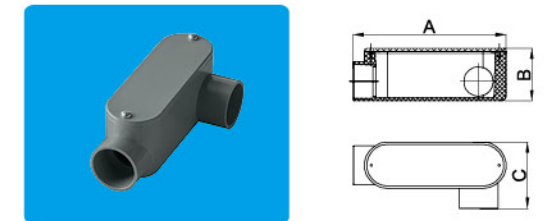

Conduit Bodies and covers Type LL

Size(Inch)	A	B	C	Part Number
1/2"	109.3	41	50.7	LL-50
3/4"	126.6	46.5	57.8	LL-75
1"	152	54.6	68.9	LL-100
1 1/4"	195.2	67.1	88.8	LL-125
1 1/2"	235.4	75.6	95.5	LL-150
2"	253.4	92.3	107.3	LL-200
3"				LL-300
4"				LL-400

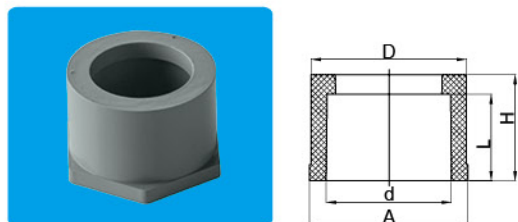

BUSHINGS

Size(Inch)	A	d	L	H	D	Part Number
1x3/4"	36.4	27.03	23.8	30	33.4	RB-601
1-1/4x1"	44.5	33.78	25.8	34.4	42	RB-801
1-1/2x2"	61.7	48.72	33.8	41.4	60.32	RB-902

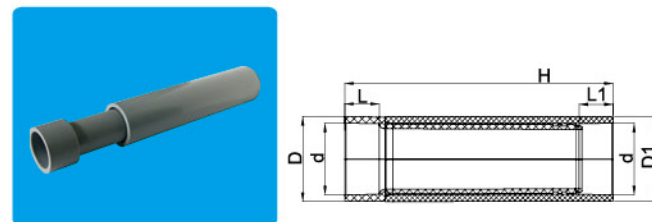

Expansion Couplings

Size(Inch)	D	d	D1	H	L	L1	Part Number
3/4"	33.7	27.02	33.7	203.9	22.2	22.2	EJ-75
1"	42.5	33.78	42.6	208.1	25.6	25.4	EJ-100
2"	72.2	60.78	72.5	228.7	29.5	28.9	EJ-200