

Product Description

This 8CH remote operates in the 900MHz band, this small remote has a transmission range of over a ½ mile depending on controller antenna placement and surrounding environment. The red LED indicator at the front top center of the remote flashes when the remote and the controller unit are communicating.



Pairing a Remote to Controller

The remote is paired with the controller unit using the pair button near the top of the controller front panel and on the back of the handheld remote. To pair press and release the pair button on the controller, the blue PAIR LED will do a double flash and continue until pairing is complete or has timed out. Now, press the pair button on the remote using a small object such as a paper clip the blue PAIR LED above it will start a single flash. When the units pair the blue LEDs will flash together indicating the units have paired.

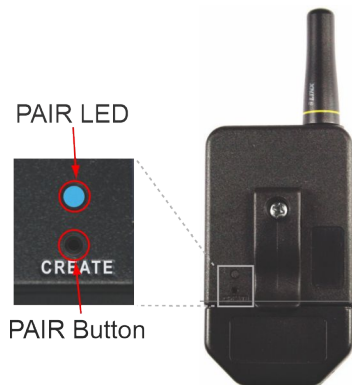
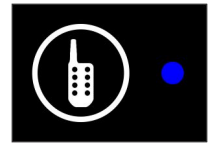

*If the controller is only doing a single flash it is in slave mode and you must put it in administrator mode. To do this, hold down the pair button for 30 seconds at which time you will see a series of flashes from the blue pair LED. Now, when you press the pair button it should be doing a double flash indicating it is in administrator mode and ready to pair.

*If the remote is doing a double flash it is in administrator mode and you must put it in slave mode. To do this, hold down the pair button for 30 seconds at which time you will see a series of flashes from the blue PAIR LED. Now, when you press the pair button it should be doing a single flash indicating it is in slave mode and ready to pair.

Battery Replacement

The handheld remote utilizes a CR2032 lithium coin cell. To replace the battery, remove the access cover by pressing firmly on the label area and sliding it off. Once the unit is open, remove the battery by sliding it from beneath the holder. Replace it with the same type of battery while observing the polarity shown. Risk of fire, explosion or damage to the device if the battery is replaced by the wrong type.

Considerations

It is important to understand that even though the SCM-800US and remote uses a frequency hopping protocol, it is still possible for interference to interrupt the transmissions. If two remotes are activated at the same time and on the same frequency, then the signals will interfere with each other and the controller will not take any action.

Optional Accessories

- Black Grip Case, Extended Belt Clip with Attachment Points, and Lanyard - **SRM-100AP-BLK**
- Gray Grip Case, Extended Belt Clip with Attachment Points, and Lanyard - **SRM-100AP-GRY**

FCC / IC NOTICES

This product contains **FCC ID: OJM900MCA / IC: 5840A-900MCA**.

This device complies with Part 15 of the FCC rules and Industry Canada license-exempt RSS standards. Operation of this device is subject to the following two conditions:

1. This device may not cause harmful interference, and
2. this device must accept any interference received, including interference that may cause undesired operation.

This equipment has been tested and found to comply with the limits for a Class B digital device, pursuant to Part 15 of the FCC Rules. These limits are designed to provide reasonable protection against harmful interference in a residential installation. This equipment generates, uses and can radiate radio frequency energy and, if not installed and used in accordance with the instructions, may cause harmful interference to radio communications. However, there is no guarantee that interference will not occur in a particular installation. If this equipment does cause harmful interference to radio or television reception, which can be determined by turning the equipment off and on, the user is encouraged to try to correct the interference by one or more of the following measures:

- Reorient or relocate the receiving antenna.
- Increase the separation between the equipment and receiver.
- Connect the equipment into an outlet on a circuit different from that to which the receiver is connected.
- Consult the dealer or an experienced radio/TV technician for help.

Any modifications could void the user's authority to operate the equipment.

Le présent appareil est conforme aux CNR d'Industrie Canada applicables aux appareils radio exempts de licence. L'exploitation est autorisée aux deux conditions suivantes:

1. l'appareil ne doit pas produire de brouillage, et
2. l'utilisateur de l'appareil doit accepter tout brouillage radioélectrique subi, même si le brouillage est susceptible d'en compromettre le fonctionnement

Simplified Control Solutions, LLC
Indianapolis, IN 46218

Visit our website at: www.SimConSol.com
Email our technical support at: Support@SimConSol.com