

T - SHORT DURATION TORQUE¹
 - INVOLUTE SPLINES DIN5480
 - FEMALE SLIP RILSAN COATED

NOTES:

1. THIS DESIGN TO BE USED FOR PRODUCTION 8.5C SERIES DRIVESHAFTS. DISTANCE IN COLLAPSED FROM F-F=270MM-170MM (xxxx" - xxxx"). TO OBTAIN CORRECT LENGTH FROM F-F CUT MALE-Lm, FEMALE-Lf AND Lds ACCORDINGLY TO THE LENGTH SHOWN IN TABLE.

2. DUST SHIELD NOT WELDED

Lg - DISTANCE FROM FACE TO FACE IN COLLAPSED POSITION
 La - LENGTH COMPENSATION
 Lg + La - MAXIMUM OPERATING LENGTH
 Lml - LENGTH OF MALE
 Lfm - LENGTH OF FEMALE
 Lds - LENGTH OF DUST SHIELD
 β - MAXIMUM DEFLECTION ANGLE

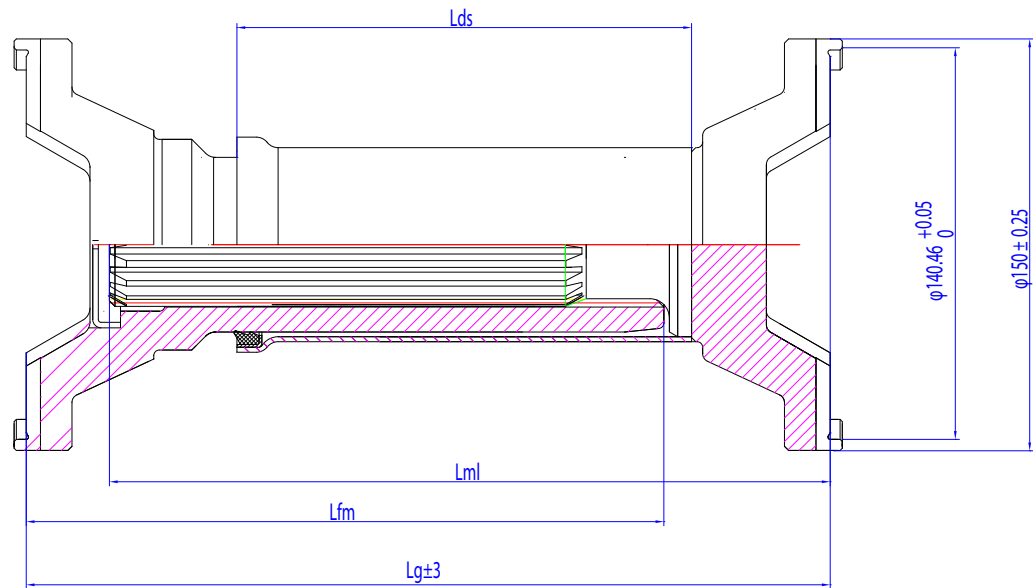

8.5C SHORT COUPLE

CUSTOM BUILD PROGRAM

T=1595NM (1175 lb-ft)

Part Number	F-F Collapsed		Male Length		Female Length		Dust Shield Length		Compensation Length		Angle	Spline Dia - No. of Splines
	Lg ± 3mm		Lml		Lfm		Lds		La		β°	
	mm	inch	mm	inch	mm	inch	mm	inch	mm	inch		
8.5 SHORT COUPLED SHAFT												
DPI-8.5C-SC-306 ² /270 ²	306	12.04	274	10.78	251	9.88	187	7.36	100	3.94	25°	SAE 3/16"
DPI-8.5C-SC-296	296	11.65	264	10.39	241	9.49	177	6.97	90	3.54		
DPI-8.5C-SC-286	286	11.26	254	10.00	231	9.09	167	6.57	80	3.15		
DPI-8.5C-SC-270 ³	276	10.87	244	9.60	221	8.70	157	6.18	70	2.72		
DPI-8.5C-SC-270 ² /220 ²	270	10.63	241	9.49	221	8.70	161	6.34	70	2.76	25°	Ø78-38
DPI-8.5C-SC-260	260	10.24	231	9.09	211	8.31	151	5.94	60	2.36		
DPI-8.5C-SC-250	250	9.84	221	8.70	201	7.91	141	5.55	50	1.97		
DPI-8.5C-SC-240	240	9.45	211	8.31	191	7.52	151	5.94	40	1.57		
DPI-8.5C-SC-230	230	9.06	201	7.91	181	7.13	141	5.55	30	1.18		
DPI-8.5C-SC-220 ³	220	8.66	191	7.52	171	6.73	131	5.16	20	0.79		
8.5C SUPER SHORT COUPLED SHAFT												
DPI-8.5C-SSC-218 ² /158 ²	218	8.58	187	7.36	159	6.26	101	3.98	77	3.03	25°	Ø78-38
DPI-8.5C-SSC-210	208	8.19	177	6.97	149	5.87	91	3.58	67	2.64		
DPI-8.5C-SSC-200	198	7.80	167	6.57	139	5.47	81	3.19	57	2.24		
DPI-8.5C-SSC-190	188	7.40	157	6.18	129	5.08	71	2.80	47	1.85		
DPI-8.5C-SSC-180	178	7.01	147	5.79	119	4.69	61	2.40	37	1.46		
DPI-8.5C-SSC-170	168	6.61	137	5.39	109	4.29	51	2.01	27	1.06		
DPI-8.5C-SSC-158 ³	158	6.22	127	5.00	99	3.90	41	1.61	17	0.67		
DPI-8.5C-SSC-170 ² /117 ²												

ALSO AVAILABLE

WING BEARING
 UNIVERSAL JOINT

8.5C SERIES

PART NUMBER
 114-8516

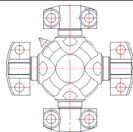

¹ - SHORT DURATION TORQUE FOR OFF-HIGHWAY CYCLING OPERATIONS. EXCEEDING THIS VALUE CAN REDUCE BIO LIFE AND MATING COMPONENTS BE INADEQUATE

² - IN STOCK SHAFTS

³ - MINIMUM LENGTH, CONTACT DRIVE PRODUCTS FOR SHORTER LENGTHS

T - SHORT DURATION TORQUE¹
 - INVOLUTE SPLINES DIN5480
 - FEMALE SLIP RILSAN COATED

NOTES:
 1. THIS DESIGN TO BE USED FOR PRODUCTION 9C SERIES DRIVESHAFTS. DISTANCE IN COLLAPSED FROM F-F=265MM-170MM (xxxx" - xxxx"). TO OBTAIN CORRECT LENGTH FROM F-F CUT MALE-Lm, FEMALE-Lf AND Lds ACCORDINGLY TO THE LENGTH SHOWN IN TABLE.

2. DUST SHIELD NOT WELDED

Lg - DISTANCE FROM FACE TO FACE IN COLLAPSED POSITION
 La - LENGTH COMPENSATION
 Lg + La - MAXIMUM OPERATING LENGTH
 Lml - LENGTH OF MALE
 Lfm - LENGTH OF FEMALE
 Lds - LENGTH OF DUST SHIELD
 β - MAXIMUM DEFLECTION ANGLE

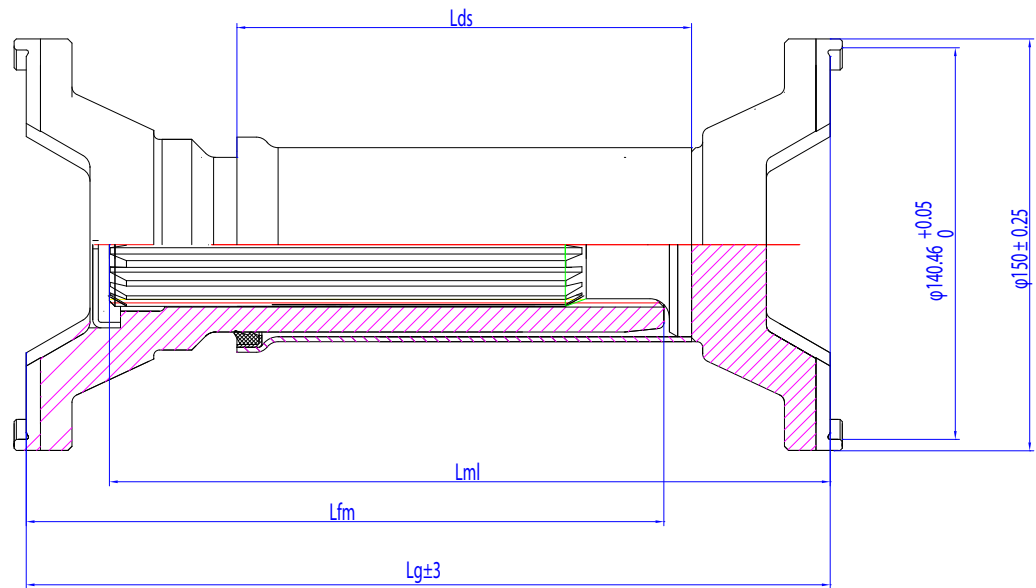

9C SHORT COUPLE

CUSTOM BUILD PROGRAM

T=2442NM (1800 lb-ft)

Part Number	F-F Collapsed		Male Length		Female Length		Dust Shield Length		Compensation Length		Angle	Spline
	Lg ± 3mm		Lml		Lfm		Lds		La		β°	
	mm	inch	mm	inch	mm	inch	mm	inch	mm	inch		
9C SHORT COUPLED SHIFT												
DPI-9C-SC-325²/265²	325	12.80	300	11.81	264	10.39	189	7.44	120	5.00	25°	SAE 3/16"
DPI-9C-SC-315	315	12.40	290	11.41	254	10.00	179	7.04	110	4.72		
DPI-9C-SC-305	305	12.00	280	11.02	244	9.60	169	6.65	100	4.33		
DPI-9C-SC-295	295	11.61	270	10.62	234	9.21	159	6.26	90	3.54		
DPI-9C-SC-285	285	11.22	260	10.23	224	8.81	149	5.87	80	3.14		
DPI-9C-SC-275	275	10.83	250	9.84	214	8.42	139	5.47	70	2.76		
9.5C SUPER SHORT COUPLED SHAFT												
DPI-9C-SSC-210²/170²	210	8.27	180	7.09	160	6.30	220	8.66	50	1.97	25°	Ø78-38
DPI-9C-SSC-200	200	7.87	170	6.69	150	5.91	210	8.27	40	1.57		
DPI-9C-SSC-190	190	7.48	160	6.30	140	5.51	200	7.87	30	1.18		
DPI-9C-SSC-180	180	7.09	150	5.91	130	5.12	190	7.48	20	0.79		
DPI-9C-SSC-170 ³	170	6.69	140	5.51	120	4.72	180	7.09	10	0.39		

ALSO AVAILABLE

WING BEARING
UNIVERSAL JOINT

9C SERIES

PART NUMBER
114-9016

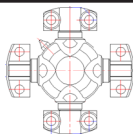

¹ - SHORT DURATION TORQUE FOR OFF-HIGHWAY CYCLING OPERATIONS. EXCEEDING THIS VALUE CAN REDUCE BIO LIFE AND MATING COMPONENTS BE INADEQUATE

² - IN STOCK SHAFTS

³ - MINIMUM LENGTH, CONTACT DRIVE PRODUCTS FOR SHORTER LENGTHS