

St Louis Herding Club
American Herding Breed Association Trials



Friday Oct. 31, Saturday Nov. 1, and Sunday Nov.2, 2025

2 RLF Trials on Friday

HRD courses, Saturday & Sunday

Sheep & Ducks HTD courses, Saturday & Sunday

Sheep & Ducks HTAD courses, Saturday & Sunday

Judges: Robin Reasoner, Jenn Patton, Tracy Parciak

Event Secretary: Jennifer Jones

niferj14@gmail.com

Purina Farms Herding Fields, 200 Checkerboard Dr, Gray Summit, MO 63039

Event Hours: 7 am to 6 pm each day

Event will be held outside regardless of weather

**Permission has been granted by the American Herding Breeds Association (AHBA) to hold the
Trials under the AHBA Rules and Regulations.**

Open to all Dogs of the Herding Breeds and Multi -Purpose Breeds with Herding Background, as listed in the AHBA Breeds List (Dogs must be 9 months or older for trial)

Friday, Oct 31, 2025

Trial #1

Judge: Robin Reasoner

RLF I, II, III Sheep (30) – 8 Runs

Trial #2

Judge: Jenn Patton

RLF I, II, III Sheep (30) – 8 Runs

Saturday, Nov 1, 2025

HRD - 16 Runs

HTD/HTAD - 50 Combined Runs

Sunday, Nov 2, 2025

HRD - 16 Runs

HTD/HTAD - 50 Combined Runs

Judge: Robbin Reasoner

HRD I, II, and III Sheep (15) – 16 Runs

Judge: Jenn Patton

HRD I, II, and III Sheep (15) – 16 Runs

Judge: Jenn Patton

HTD I, II and III Sheep & Ducks

Sheep (5) – Ribbon Pull

Ducks (5) – Shed

Judge: Robin Reasoner

HTD I, II and III Sheep & Ducks

Sheep (5) – Ribbon Pull

Ducks (5) – Shed

Judge: Jenn Patton

HTAD I, II, and III Sheep & Ducks

Sheep (5) – Course 4, Take Pen, Gate Sort (2)

Ducks (5) – Course 2, Take Pen, Gate Sort (2)

Judge: Robin Reasoner

HTAD I, II, and III Sheep & Ducks

Sheep (5) – Course 4, Gather, Gate Sort (2)

Ducks (5) – Course 2, Take Pen, Gate Sort (2)

Test/Trial Committee

Chairman	Renee Schnur
Test/Trial Secretary	Jennifer Jones
Course Director	Bettie Kinsley
Chief Stock Handler	Tracy Parciak
Veterinarian (on call)	John Stolz, DVM Veterinarian Clinic Washington, MO 636-239-5445
Emergency	911

Livestock

Katahdin and Cross Breed Sheep (Value \$150 per head)
Call Ducks (Value \$50 per head)

Entry Fees

\$40.00 for each Trial Class
\$50.00 for each RLF Class

Entries

There must be a separate entry form for each dog entered. Entries must be signed. Mail entries with fees to the trial secretary. You must waive the signature requirement for delivery services, if applicable. Entries will be accepted until the trial levels are full. Entries will be accepted in order received.

You may either obtain an AHBA registration number or use your dog's registration number from another organization.

Make checks payable to the **St Louis Herding Club**. Mail entry and check, payable in US Funds, to: Jennifer Jones, 21 Homewood Dr., Kirkwood MO, 63122

Awards

Ribbons will be awarded for 1st – 4th place in each class. Qualifying ribbons will be awarded to all dogs receiving a qualifying score. HIT and RHIT ribbons will be awarded for each event/ trial as listed below (8).

Friday Trial #1 - RLF

Friday Trial #2 - RLF

Saturday – HRD; HTD/HTAD Sheep combined;
HTD/HTAD Ducks combined.

Sunday – HRD; HTD/HTAD Sheep combined; HTD/HTAD Ducks combined.

Notice to Exhibitors

Please CLEAN UP AFTER YOUR DOG AND YOURSELF. We ask for the cooperation of exhibitors in helping to keep the test/trial location as clean as possible in order for us to retain the use of this facility for future events.

Entry fees will not be refunded in the event that a dog is absent, disqualified, excused by a veterinarian or judge, or barred from competition by action of the test/trial committee. Entry fees will not be refunded if the test/trial cannot open or be completed by reason of riot, civil disturbance, fire or act of God, public emergencies, act of public enemy, strike or any other cause beyond the control of the club.

Entries must be made on Official AHBA entry forms or copies and must include the Release Form. Owners are responsible for any errors in making out entry forms.

There is a \$25 returned check fee.

Dogs need to be present only for scheduled judging. Judges need not wait for any dog holding up a class. Owners or agents alone are responsible for the presence of the dog in the ring. ALL DOGS MUST BE ON LEAD EXCEPT WHEN BEING JUDGED IN THE ARENA.

Dogs may wear only plain buckle or snap-lock collar (no tags) or may work without a collar at trial levels.

Bitches in season are permitted to run.

Exhibitors should follow their veterinarians' recommendation to ensure their dogs are free of internal and external parasites and any communicable diseases and have appropriate vaccinations.

The St Louis Herding Club, its Board, Officers and Members, the test/trial chair, secretary, committee, and Purina Farms and its employees will not be liable for any loss or injury which may be sustained through disappearance, loss, theft, communicable disease, parasites, injury and/or death of dogs entered in this event.

Directions to Purina Farms:

Take I-44 to Gray Summit (Exit 253). Go north two blocks on Missouri Highway 100 to County Road MM. Turn left on MM and go west about 3/4 miles to Purina Farm's herding field on left. Parking lot is just before the white barn.

AHBA Sanctioned Herding Trials
St Louis Herding Club – Entry Form

Please make checks/money orders payable to the **St Louis Herding Club**. Mail completed, signed entry form and payment to Jennifer Jones, 21 Homewood Dr., Kirkwood MO 63122

Dog's Name: _____ Call name: _____

Registry: _____ Reg Number: _____ Date of birth: _____

Breed: _____ Sex: _____

Sire: _____ Dam: _____

Breeder: _____

Owner: _____

Address: _____

Phone: _____ Email: _____

Check the row for the class you want to enter. You can only enter one class (I, II or III) per event (column).

Trial class entered	RLF Sheep		HRD Sheep		HTD Sheep		HTD Ducks		HTAD Sheep		HTAD Ducks	
	Fri 1	Fri 2	Sat	Sun	Sat	Sun	Sat	Sun	Sat	Sun	Sat	Sun
I												
II												
III												

Entry form must be returned with the release form signed. Any entries received without the signed release will not be accepted.

RELEASE FORM

In consideration for participation in an event sanctioned by the American Herding Breed Association (AHBA), I agree to assume all responsibility for any claim, loss or damage, of whatever kind or nature, whether to person or property, which may be caused at or near this event, either directly or indirectly, by me or the dog or dogs I have entered in or brought to this event. I further agree that I will hold the AHBA, its officers, directors, agents and members harmless and defend them from any and all liability for any injury, claim, damage or loss, of whatever kind or nature, whether to person or property, caused at or near this event, whether directly or indirectly, by me or any dog I have entered in or brought to this event. I agree to indemnify the AHBA, its officers, directors, agents and members for any loss, cost or expense including attorney's fees and costs, to which the AHBA, its officers, directors, agents or members might be subject as a result of any claim, suit, loss or damage caused in any way by any act or negligence on my part or on the part of any dog or dogs I have entered in or brought to this event. I acknowledge that while the AHBA may provide sanctioning for this event with regard to the issuing of titles, it does not have and does not exercise control over the conduct of the event or those present. I certify and represent that the dog or dogs I have entered in or brought to this event is/are not a hazard to other dogs, other animals, or to people.

I (we) will pay for injuries or replacement value in the event of the death of any livestock by my (our) dog. If injury to any stock is caused by my (our) dog entered or brought to this Herding Test/Trial, I (we) assume full responsibility for any damage. I (we) agree to pay full market value of the injured animal in case of injury or the veterinary bill for the injury, whichever is agreed to by the Livestock Owner.

Signature of Entrant

Date

2025 SLHC AHBA RANCH DOG COURSE
(TEAM REFERS TO DOG AND HANDLER UNLESS SPECIFIED OTHERWISE)
15 HEAD OF STOCK WILL BE USED

Course Description: Throughout the course, the emphasis should be on smooth, calm, practical work, the sheep should move steadily and quietly, without rushing, lagging or weaving. Except as otherwise specified on certain parts of the course, the dog and handler may take various positions relative to the sheep throughout the course. Each group will have 4 marked sheep.

The time limit for the course is 20 minutes for HRD I, 25 minutes for HRD II and 30 minutes for HRD III.

1. **Exit from Pen/Barn Lot (10 Points).** Stock is taken from Pen A-E as directed by the judge and allowed to enter sorting pen. Exercise finished when all (15) exited, and gate is closed.
HRD III - Handler remains outside/at gate. **HRD II** - Handler can enter pen and go 1/2 way to stock. **HRD I** - Handler may enter pen and assist dog in any position as needed.
2. **Sorting/chute alleyway/scale (15/10/10 Points).** Stock is directed to Gate #7 and (10) sheep are sorted into the small pen. **HRD III** - At least 3 marked sheep must be sorted. **HRD II** - At least 1 marked sheep must be sorted. **HRD I** - Any 10 sheep may be sorted.
The 10 sorted sheep are placed into pen F. All Teams return through Gate #7 and gather remaining (5) head, moving stock along pens through Gate #8 into fenced area adjacent to wooden alley, squeeze chute and scale. Gate #8 is closed leaving dog and 5 head of stock in pen while handler opens sliding gate at entrance of wooden alley. Dog is directed to move stock through alley. Handler closes sliding gate and directs dog to hold stock until scale door is opened allowing stock to exit into the small pen. Scale door is closed (all others remain open). (Dog should not harass stock in alley, scale or small pen). Exercise is finished when stock and dog exit scale and door is closed.
3. **Load Trailer (10 Points).** Handler proceeds to Gate #9 and moves (5) sheep through Gate #9 along pens through Gate #10 into pen.
HRD III and II - Five head of stock are loaded into trailer, closing trailer gate to prevent escape. **HRD I** - Stock is penned but not trailered. Exercise is finished when stock is loaded or in pen (HRD I).
4. **Take From Pen, Bridge, Narrow Chute (10 Points).** Team returns through Gates #10 and 9, opening gate to pen (F) and Gate #6. Dog is sent to gather stock from pen F moving them down 14x100- alley to Gate #2.
HRD III - Dog is sent from concrete bridge (slab) to gather stock (10 head). **HRD II** - Dog is sent from outside F pen gate. **HRD I** - Team can enter F pen and gather stock.
Dog holds stock from returning up alleyway to barn while handler opens Gate #2. Stock enters 50x50 pen. Team moves stock across pen through Gate #3 and into alley. Team takes stock through the alley making a left turn to Gate #5. Stock is allowed to enter the 100x200 arena through Gate #5. Exercise is finished when stock and Team are in the arena and Gate #5 is closed.
5. **Gather (10 Points).** Dogs should gain control of stock immediately upon entering the 100x200 arena. Team performs a controlled hold to settle stock in the middle of the arena near Gate #5. Handler calls dog off and proceeds to the handler's post/cone. Dog is sent to gather stock to the handler's post, passing counterclockwise. Exercise finished when last head of stock turned the handler's post. **HRD III** - Handler remains at post for gather. **HRD II** - Dog remains at post, handler may go 1/2 way to stock. **HRD I** - Dog can be placed 1/2 way between handler's cone and stock. Handler can move to a position within 15ft. of stock.
6. **Panel Obstacle, 2 Obstacle, Free Standing Pen. (30/25/25 Points).** The stock is fetched/driven from the handler's post through panel obstacle. Once stock has passed through panel obstacle, they are turned right (East) toward the board fence then back (South) toward the #2-Y-chute Obstacle. (The stock should pass through the #2 Obstacle (Y-chute) from the North end). Once stock exit the #2 Obstacle, they are taken across the arena and put into the free-standing pen. (All levels pen stock).
HRD III - Handler remains at cone until stock has entered the #2 obstacle. **HRD II** - Handler drives stock to Panel obstacle, then may fetch/drive to #2 Obstacle & freestanding pen. **HRD I** - Handler may fetch to #2 Obstacle & Freestanding pen.
Stock is removed from the freestanding pen. **HRD III** - Stock is taken to the area near the handler's post to touch a marked sheep, then to Gate #4. **HRD II and I** - Proceed to Gate #4. Exercise is finished when the sheep is touched, and stock is in the area of Gate #4.
7. **Regroup, Bridge, Re-pen (15 Points).** Team and stock proceed through Gate #4 to Gate #2. Dog holds stock off Gate #2, while handler opens Gate #2 and returns to pen F to close gate. Team directs stock into alleyway returning to barn. Dog holds stock while handler closes Gate #6. Team leaves stock in small pen and moves through Gates #9 and 10. Team gathers stock from trailer/pen returning through Gates #10 and 9 to re-unite stock in small pen. Team moves all 15 head of stock through Gate #7 into sorting pen and re-pens them in their original pen A-E.

Exercise finished.

TOTAL POINTS: 100/90/90 TIES BROKEN AS FOLLOWS: EXERCISE # 2 EXERCISE # 6 COURSE TIME

2025 SLHC AHBA Ranch Dog Course



Lower Arena 100'x200'	Triangle Pen 50'x50'	Pens A-E 20'x70' Each
Upper Arena 130'x200'	Holding Pens along Lower Arena 5'x7'	Stock Pen Area 100'x30'
B Field 4.5 Acres	Corner Holding Pen 12'x30'	Wooden Chute & Scale 70'x3'
Alley (Lower Arena to Barn) 14'x100'	Low Water Bridge 10'x18'x4'	Control Pen 60' Diameter
		Sorting Area (near barn) 30'x40'

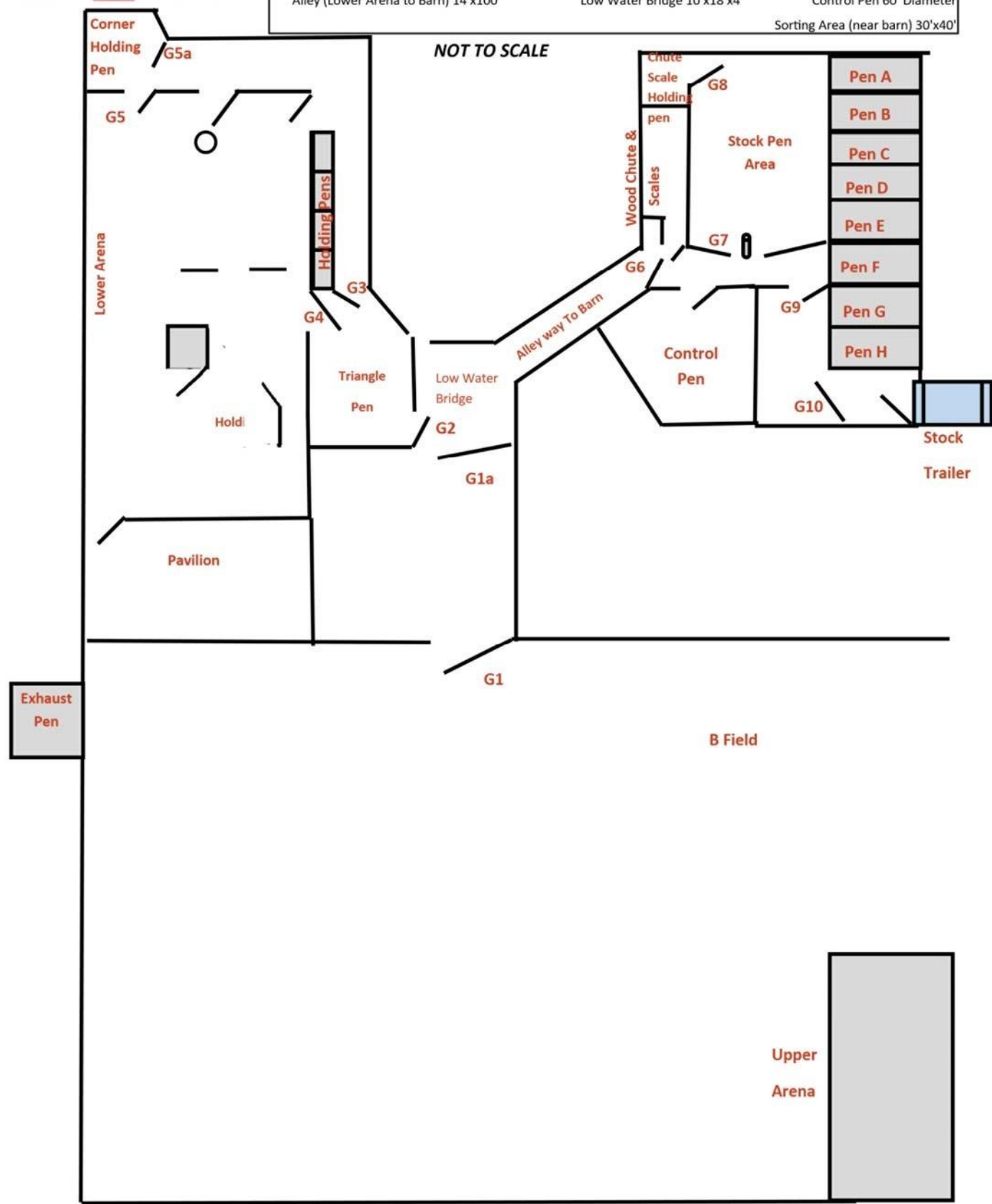



2025 SLHC AHBA RANCH LARGE FLOCK (RLF)

Sheep 30 minutes allowed

Notes: Close all gates when passing through, unless otherwise stated.

Three head of sheep are marked with ribbons for III & II teams.

Sec on 1 **Gather, Free Standing Obstacle, & Settle** 20 pts Gather 30 head of sheep from Upper A field (150). (RLFIII) Handler should stay at gate and send dog to gather. (RLFII) Team may walk into the arena and up to the drive panels. (RLF) Team to fetch sheep and Handler may assist dog as needed. Move sheep into B field. Proceed down the field moving sheep through 1st set of HTD Drive Panels. Se le Sheep at or near handler's cone.

Sec on 2 **Sort & Pen** 25/20/20 pts Proceed to fetch/drive sheep to Gate 1. Dog should hold sheep off Gate 1 for handler to open. Move sheep along gravel path through Gate 1a & 2 (set of 2 red gates). If sheep drift up alley, gather and proceed through Gate 2 into Triangle Holding Pen. Sort 8 head using Gate 3 into second holding pen; (RLFIII) sort should include at least one marked sheep. Sort another 8 head into third holding pen.

Sec on 3 **Take Pen** 5pts Handler & dog go to Gate 4, gather remaining 14 sheep from Triangle Holding Pen and move all into A field. Leave Gate 3 open, close Gate 4.

Sec on 4 **Drive & Locate Marked Sheep** 10 pts (RLFIII) Handler moves to North cone. Gather sheep to vicinity of cone and drive sheep through panels and allow to se le. (RLFII) Handler moves to middle cone. Gather sheep to vicinity of cone and drive sheep through panels and allow sheep to se le. (RLF) Drive/fetch sheep through panels and allow sheep to se le. (RLFIII & RLFII) Remove a ribbon from marked sheep in vicinity of panels. (RLF) Se le and hold sheep in vicinity of cone.

Sec on 5 **Gather & Alley** 15/10/10 pts (All) Fetch/Drive sheep through Gate 5 into Corner Holding Pen. Sheep are then moved through small gate into and through L shaped Chute on outside of A Field. Sheep will go pass sheep in pens and go through Gate 3 into Triangle Pen. Sheep in side pens should be collected along the way in a safe manner. Sheep should not be allowed to turn back in Chute. All 30 sheep are now in Triangle Holding Pen.

Sec on 6 **Sort, Chute & Scales** 15 pts Team will move sheep through Gate 2 and allow sheep to move up alley to F Pen Gate. Close Gate 6. Sort 5 head of sheep through Gate 7 into Stock Pen Area. Move remaining 25 sheep into Round Pen. Team returns to Stock Pen Area and moves 5 sheep through Gate 8 into Chute & Scales.

Sec on 7 **Re-pen** 10 pts Dog will hold 5 sheep off F Pen Gate, to allow Handler to open gate. Sheep are allowed to drive into F Pen (or pushed, as needed). Leave F Pen Gate open. Team moves to Round Pen Gate and sheep are gathered and allowed to settle in F Pen. Close Round Pen & F Pen gates.

Course complete!

Total Points 100/90/90

TIE BREAKERS in order of use:

Step 1. Gather & Settle – 20 pts

Step 2. Sort & Pen – 25/20/20 pts

Step 5. Gather & Alley – 15/10/10 pts

2025 SLHC AHBA Ranch Large Flock (RLF)

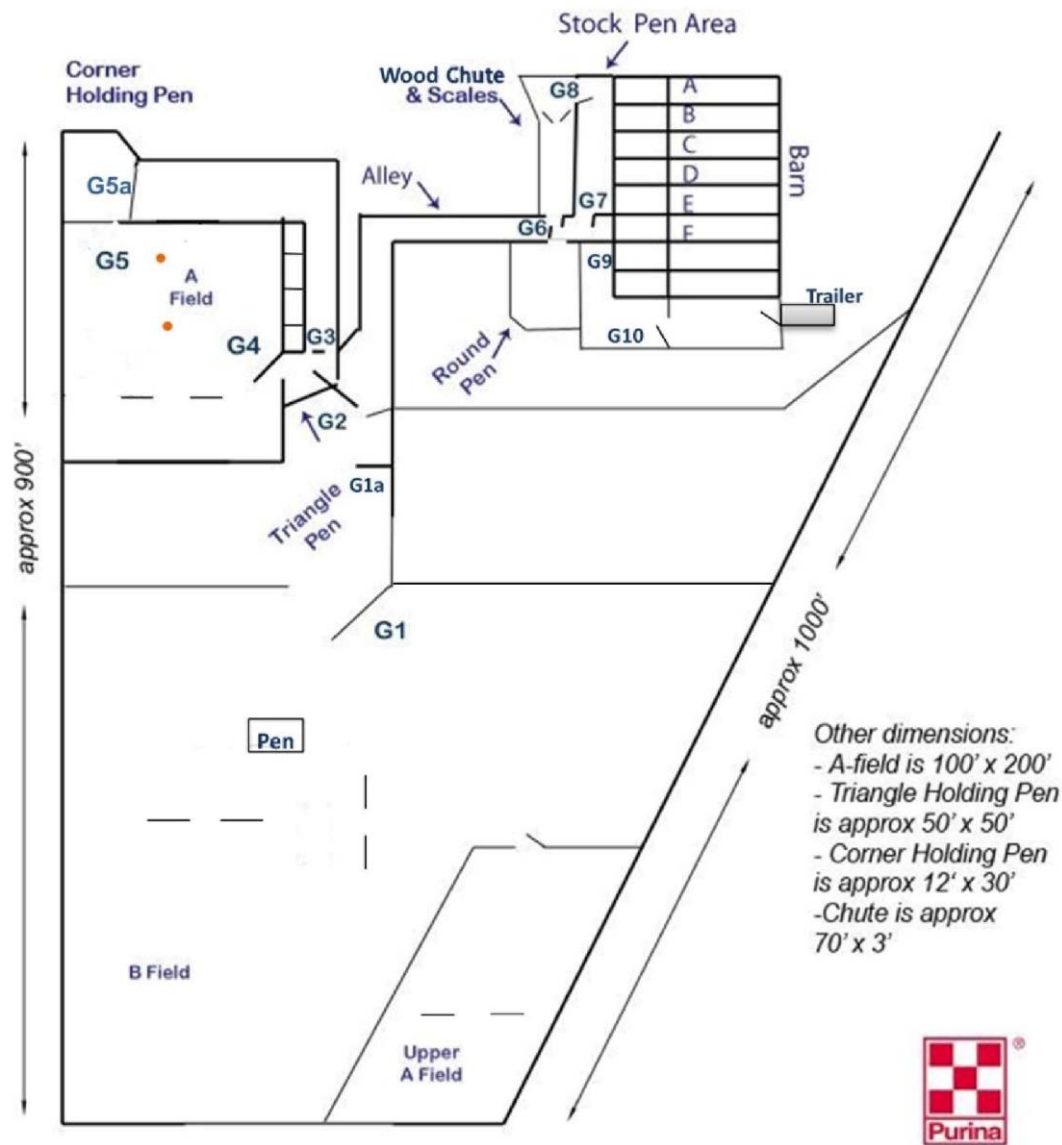

Field, Pen & Obstacle Dimensions

A Field 100'x200' Alley ~14'x100'	Triangle pen ~50'x50'	Pens A-E ~20'x70' each
Upper A Field 130'x200'	Holding pen (along A field) ~5'x7'	Stock pen area ~100'x30'
B Field ~4.5 acres	Corner holding pen ~12'x30'	Wooden chute & scale ~70'x3'
Alley (A Field to barn) ~14'x100'	Footbath (in A Field) ~8'x14'	Round pen ~60' diameter
	Low water bridge ~ 10'x18'x4'width	Sorting area (near barn) ~30'x40'