

INDUSTRIAL BUILDING FOR SALE

27,238 SF ON 1.38 ACRES

31088 SAN CLEMENTE STREET, HAYWARD, CA 94544



FOR SALE

JR COMMERCIAL REAL ESTATE
www.jr-commercial.com



PRESENTED BY:

JAMES RANDLEMAN
Broker
office: (408) 549-1780
cell: (408) 314-8888
jim@jr-commercial.com
BRE# 00860359, California

The calculations and data presented are deemed to be accurate, but not guaranteed. They are intended for the purpose of illustrative projections and analysis. The information provided is not intended to replace or serve as substitute for any legal, accounting, investment, real estate, tax or other professional advice, consultation or service.

PROPERTY SUMMARY

31088 SAN CLEMENTE STREET



Property Summary

Price:	\$7,925,000
Building SF:	27,238
Price / SF:	+/- \$291
Lot Size:	1.38 acres
Warehouse:	+/- 80%
Dock Doors:	0
Grade Doors:	3
Clear Height:	+/- 19'
Power:	2000A 480/277v 3p
Year Built:	1977
Roof:	Asphalt
Sprinklers:	yes
Yard:	60' x 65" fenced yard
Zoning:	Industrial
sprinkler	yes

Property Overview

Single tenant 27,238 square foot industrial building on 1.38 acres of land built in 1977. Power is rated at 2000 amps at 480/277 volts. The property has entry and exit on two streets (San Clemente Street and San Bento Street) and is zoned industrial. Perfect owner occupier building.

Location Overview

This East Bay property is a sub-region of the San Francisco Bay Area and is in the city of Hayward in the county of Alameda. The property is in the well-established Huntwood Industrial Park with easy access to the 880 Freeway, less than 4 miles to Highway 92 (north) and Highway 84 (south) each leading to the San Francisco Peninsula. The site is approximately 20 miles from San Francisco and 20 miles from San Jose. This is a very centralized and strategic location.

FLOOR PLAN

31088 SAN CLEMENTE STREET

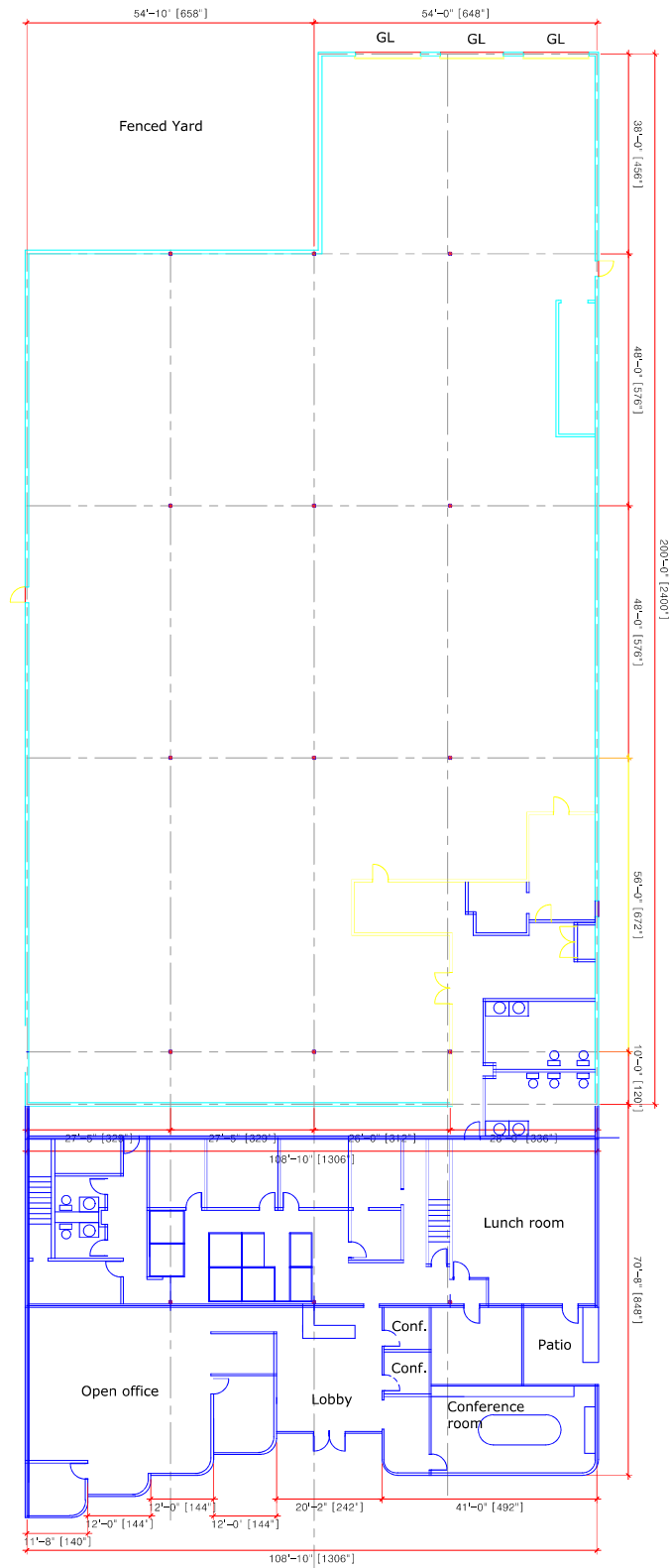

These dimensions and layout are approximate, They are not absolutely accurate or guaranteed.

JR COMMERCIAL REAL ESTATE
www.jr-commercial.com



JAMES RANDLEMAN
Broker
O: (408) 549-1780
C: (408) 314-8888
jim@jr-commercial.com
BRE# 00860359, California

LOCATION MAPS

31088 SAN CLEMENTE STREET

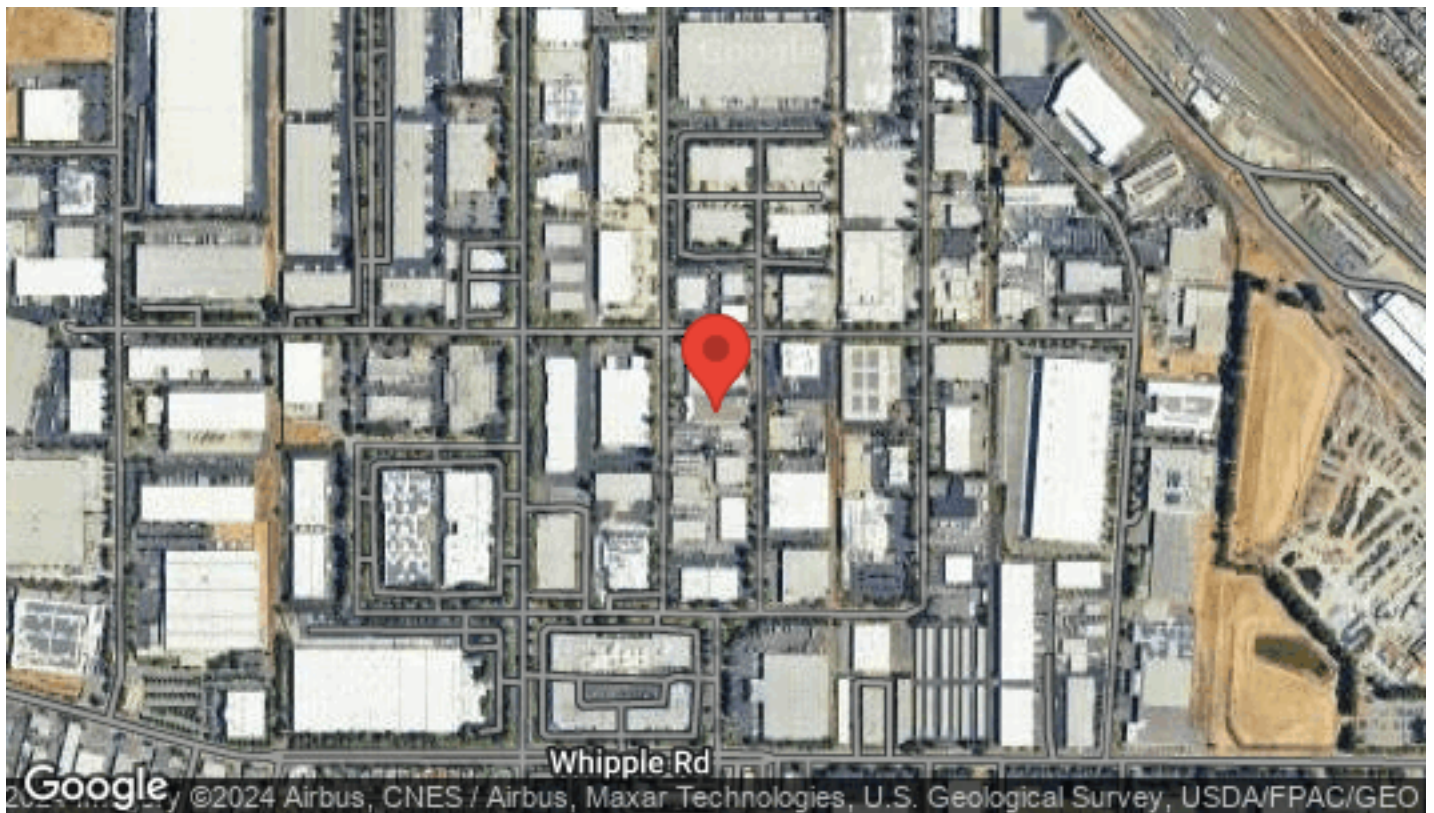

JR COMMERCIAL REAL ESTATE
www.jr-commercial.com

JAMES RANDLEMAN
Broker
O: (408) 549-1780
C: (408) 314-8888
jim@jr-commercial.com
BRE# 00860359, California

DISCLAIMER

31088 SAN CLEMENTE STREET



All materials and information received or derived from JR Commercial Real Estate its directors, officers, agents, advisors, affiliates and/or any third party sources are provided without representation or warranty as to completeness, veracity, or accuracy, condition of the property, compliance or lack of compliance with applicable governmental requirements, developability or suitability, financial performance of the property, projected financial performance of the property for any party's intended use or any and all other matters.

Neither JR Commercial Real Estate its directors, officers, agents, advisors, or affiliates makes any representation or warranty, express or implied, as to accuracy or completeness of the any materials or information provided, derived, or received. Materials and information from any source, whether written or verbal, that may be furnished for review are not a substitute for a party's active conduct of its own due diligence to determine these and other matters of significance to such party. JR Commercial Real Estate will not investigate or verify any such matters or conduct due diligence for a party unless otherwise agreed in writing.

EACH PARTY SHALL CONDUCT ITS OWN INDEPENDENT INVESTIGATION AND DUE DILIGENCE.

Any party contemplating or under contract or in escrow for a transaction is urged to verify all information and to conduct their own inspections and investigations including through appropriate third-party independent professionals selected by such party. All financial data should be verified by the party including by obtaining and reading applicable documents and reports and consulting appropriate independent professionals. JR Commercial Real Estate makes no warranties and/or representations regarding the veracity, completeness, or relevance of any financial data or assumptions. JR Commercial Real Estate does not serve as a financial advisor to any party regarding any proposed transaction.

All data and assumptions regarding financial performance, including that used for financial modeling purposes, may differ from actual data or performance. Any estimates of market rents and/or projected rents that may be provided to a party do not necessarily mean that rents can be established at or increased to that level. Parties must evaluate any applicable contractual and governmental limitations as well as market conditions, vacancy factors and other issues in order to determine rents from or for the property. Legal questions should be discussed by the party with an attorney. Tax questions should be discussed by the party with a certified public accountant or tax attorney. Title questions should be discussed by the party with a title officer or attorney. Questions regarding the condition of the property and whether the property complies with applicable governmental requirements should be discussed by the party with appropriate engineers, architects, contractors, other consultants, and governmental agencies. All properties and services are marketed by JR Commercial Real Estate in compliance with all applicable fair housing and equal opportunity laws.

JR COMMERCIAL REAL ESTATE
www.jr-commercial.com



PRESENTED BY:

JAMES RANDLEMAN
Broker
O: (408) 549-1780
C: (408) 314-8888
jim@jr-commercial.com
BRE# 00860359, California

The calculations and data presented are deemed to be accurate, but not guaranteed. They are intended for the purpose of illustrative projections and analysis. The information provided is not intended to replace or serve as substitute for any legal, accounting, investment, real estate, tax or other professional advice, consultation or service.