

MAIMIN®

CYCLON GEAR UNIT

(see Maimin Round Knife Instructions & Parts List Catalog for all other parts)

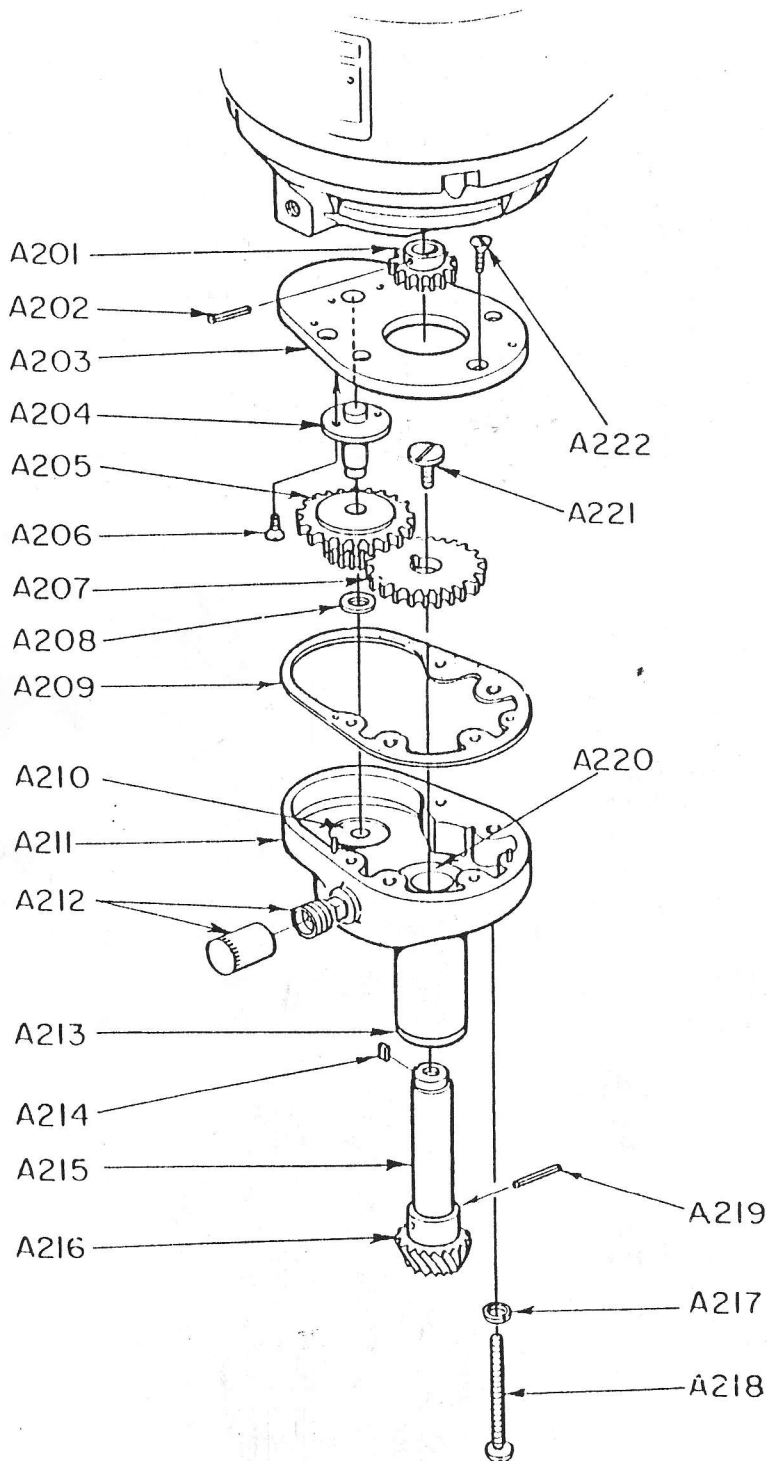
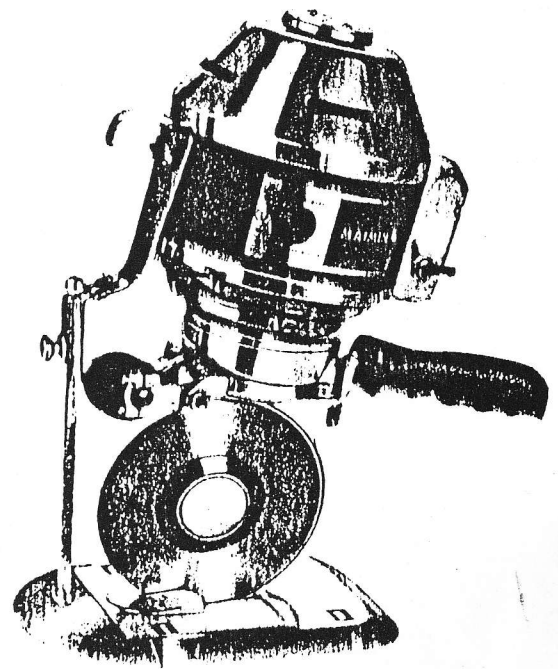

KEY NO.	PART NO.	DESCRIPTION
A201	375S	Pinion - 13 Teeth
	375M	Pinion - 16 Teeth
	375F	Pinion - 24 Teeth
A202	805P	Rollpin
A203	378	Gear Box Cover (sold only with 371)
A204	377	Gear Stud
A205	374S	Gear - 35/13 Teeth
	374M	Gear - 32/16 Teeth
	374F	Gear - 24/16 Teeth
A206	436I	Screw, 6 x 3/16 Flat Hd.
A207	373S	Gear - 35 Teeth
	373M	Gear - 32 Teeth
A208	839W	Washer
A209	376	Gasket
A210	377W	Washer, Gear Stud
A211	371A	Gear Box - 54
	371D	Gear Box - 59
	371E	Gear Box - 86
	371H	Gear Box - 87
	371I	Gear Box - 87
A212	311G	Grease Cup
A213	370	Thrust Washer
A214	373K	Gear Key
A215	372A	Main Shaft - 54
	372D	Main Shaft - 59
	372E	Main Shaft - 86
	372H	Main Shaft - 87
	372I	Main Shaft - 87
A216	323J	Pinion - 54 (#6)
	323H	Pinion - 59 (#9)
	323M	Pinion - 59 (#248)
	323C	Pinion - 86 and 87 (#5)
A217	311W	Lock Washer
A218	379	Screw, 12 x 1/8 Rnd. Hd.
A219	323P	Pinion Pin
A220	372W	Washer, Gear
A221	351	Screw for Gear
A222	378S	Screw, 8 x 1/2 Flat Hd.

For maintenance and repair instructions see Maimin Round Knife Instructions & Parts List Catalog. The Cyclon Gear Unit should be greased twice each month by turning the Grease Cup (A212) one complete revolution.

ALWAYS GIVE MACHINE SERIAL NUMBER WHEN ORDERING PARTS. ORDER BY PART NUMBER - NOT KEY NUMBER.

PRINTED IN U.S.A.

PARTS NOT ILLUSTRATED
 376N Cyclon Armature Nut with Lock Screw
 378B Oilite Bushing for Gear Box

CS10795C