

MAIMIN MINI-SHERE INSTRUCTIONS & PARTS LIST

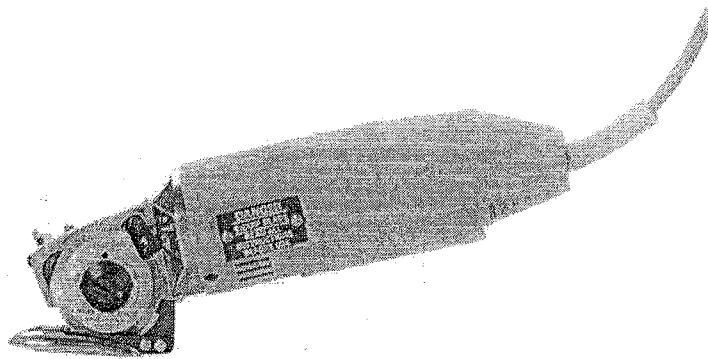

I. DESCRIPTION

1-1 GENERAL

The Maimin Mini-Shere electric shears is a compact, efficient tool for easily cutting various materials. The Mini-Shere uses a hexagonal knife with either a baseplate or a cutting guide for different cutting purposes as listed below. Lubrication by the rear felt (10390) behind the knife greatly increases life of the gear retainer (10313) and improves the cutting action.

1-2 KNIFE

The hexagonal knife (30312) is excellent for cutting all materials such as cloth, synthetics, leather, and plastics.

1-3 BASEPLATE/CUTTING GUIDE

- a) The baseplate (10345) is used for general cutting.
- b) The cutting guide (10340) is used for trimming, angle cutting, and slitting or cutting knitwear.

II. OPERATION

2-1 TO START

Connect male plug at end of power supply cable to electrical outlet of same voltage as stamped on nameplate. To operate machine, press switch lever (10411). Release lever to stop machine.

The Mini-Shere is double-insulated and requires no grounding. Therefore, it comes equipped with only a two wire electrical cord. The Stretch Mini-Shere is equipped with a three wire electrical cord as it is not double-insulated and must be grounded to the proper electrical outlet.

2-2 TO CUT

Maximum cutting height is 5/16" (8mm) but lays should be no higher than machine can cut without strain.

2-3 TO SHARPEN KNIFE

Press sharpener (10370) *lightly* for sharpener stone (10378) to grind rotating knife. Always keep knife sharp for clean, accurate cutting.

III. CARE & MAINTNANCE

3-1 MAINTENANCE SCHEDULE

- a) Daily: Use Mini-Shere oil (10442) to saturate rear felt (10390) whose oil hole is marked in back of gear case (10306).
- b) Weekly: Grease gears with Mini-Shere grease. Grease hole is in back of gear case(10306).
- c) Monthly: Blow out air inlets and outlets of motor. Always keep Mini-Shere free of dirt and grease.

3-2 TO CHANGE KNIFE

Turn knife until its hole is opposite recess for sharpener, and insert a hex key into hole. Unscrew knife lock screw (10433) with screw driver. Lift knife out. Slip new knife between counter-cutting blade (10341) and cutting guide (10340), and seat it firmly on shoulder of gear (10310). Lock knife with knife lock screw. Clean cutting requires counter-cutting blade brush only edge of knife.

3-3 TO CONVERT BASEPLATE TO CUTTING GUIDE

To expose the cutting guide (10340), remove the baseplate (10345) by unscrewing the two screws (10347) holding the baseplate to the cutting guide. Be careful to keep the two screws with the baseplate for reassembly later if desired.

3-4 TO CHANGE SHARPENING STONE

Remove knife then sharpening stone (10378) from shaft by unscrewing stone screw (10373). Insert new sharpening stone, and reassemble.

3-5 TO CHANGE CARBON BRUSHES

Check carbon brushes (10401) after 200 hours use. Using screwdriver, remove the three Screws (10423) holding motor case (10410). Slide off motor case. Remove brush caps (10413) from the exposed motor, and replace old carbon brushes.

CAUTION: Disconnect machine from electrical outlet before making adjustments or repairs!

SEE OTHER SIDE FOR PARTS LIST

MINI-SHERE PARTS LIST

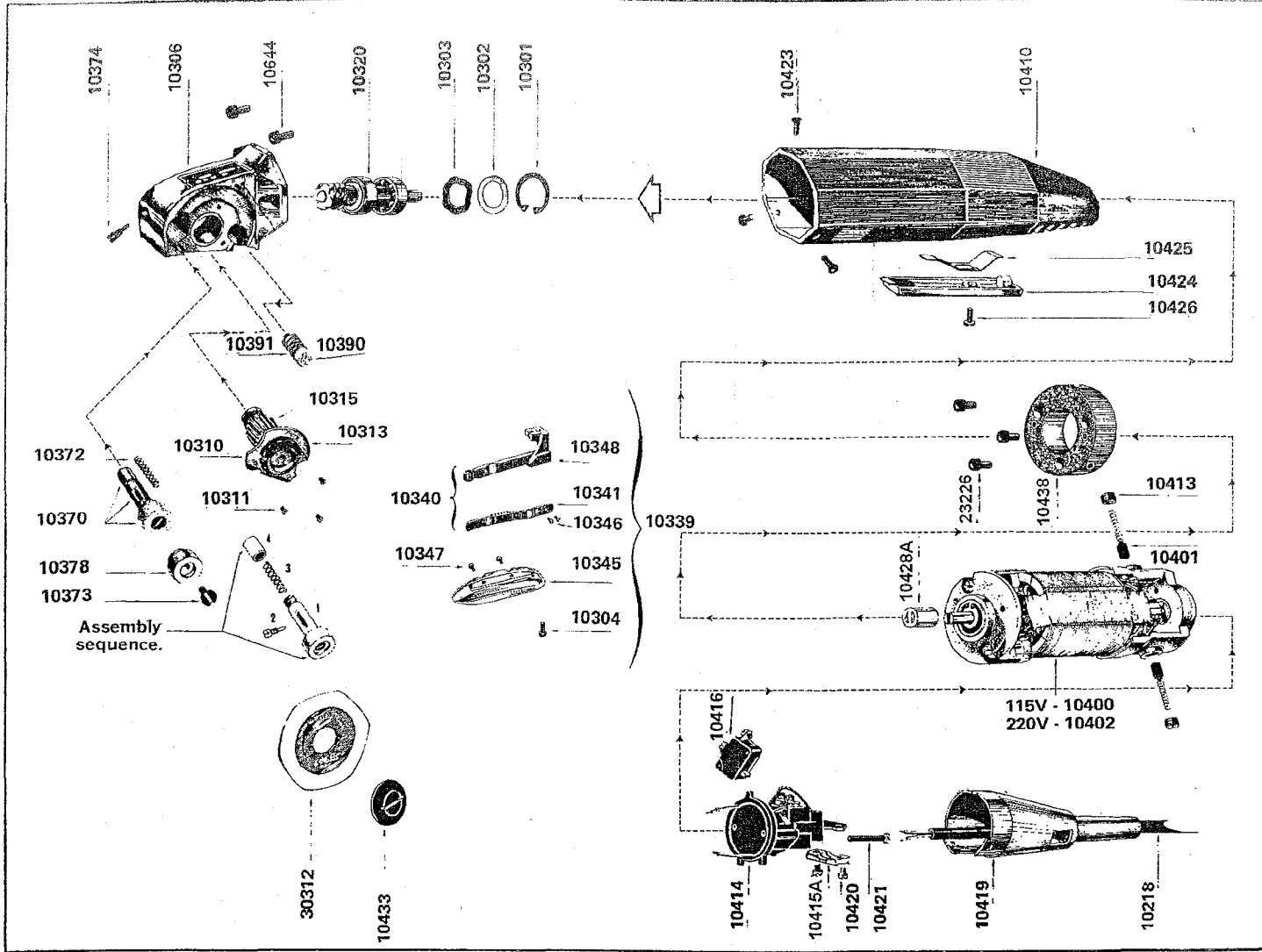

| Part No. | Description | Part No. | Description | Part No. | Description |
|----------|------------------------|----------|---------------------|----------|-------------------|
| 10218 | Power Supply Cable | 10372 | Spring | 10442 | Oil |
| 10250 | Motor Bearing Front | 10373 | Stone Screw | 10443 | Grease |
| 10251 | Motor Bearing Back | 10374 | Shaft Screw | 10644 | Screw M4 X 10 Cap |
| 10301 | Retaining ring | 10375 | Cap | 30312 | Hexagonal Blade |
| 10302 | Washer | 10378 | Sharpening Stone | | |
| 10303 | Undulated Washer | 10390 | Rear felt | | |
| 10304 | Screw, M4 X 8 Cap | 10391 | Spring | | |
| 10306 | Gear Case | 10400 | Motor Assembly 110V | | |
| 10310 | Gear Assembly | 10401 | Carbon Brush, Each | | |
| 10311 | Screw, M2.6 X 3 | 10402 | Motor Assembly 220V | | |
| 10313 | Gear Retainer | 10410 | Motor Case | | |
| 10315 | Gear Only | 10411 | Switch Lever | | |
| 10320 | Worm Assembly | 10413 | Brush Cap | | |
| 10324 | Rollpin 2 X 10 | 10414 | Holder Only | | |
| 10325 | Retaining Ring | 10415A | Clip | | |
| 10339 | Cutting Guide Assembly | 10416 | Switch | | |
| 10340 | Cutting Guide w/Blade | 10419 | Sheath | | |
| 10341 | Counter Cutting Blade | 10420 | Screw 4 X 5/16 | | |
| 10345 | Baseplate | 10421 | Screw 3 X1-1/16 | | |
| 10346 | Screw, M2.6 X 3 | 10423 | Screw M3 X 8 | | |
| 10347 | Screw, M3 x 6 | 10425 | Spring | | |
| 10348 | Cutting Guide Only | 10426 | Screw M3 X 4 | | |
| 10349 | Clamp (Not Shown) | 10428A | Shaft Coupling | | |
| 10370 | Sharpener Assembly | 10433 | Knife Lock Screw | | |
| | | 10438 | Disc | | |
| | | 10441 | Hex Key M3 | | |

Stretch Minishere

| | |
|--------|------------------------------|
| 10328 | Motor Adapter Flange |
| 10329 | Gear Case Adaptor Flange |
| 10331 | Motor Shaft |
| 10333 | Screw (Switch Box) |
| 10334 | Grip |
| 10336D | Motor Shaft Housing Assembly |
| 10352 | Screw, Socket, Cone Pt. |
| 10361 | Switch Box |
| 10362 | Switch Box Bracket |
| 10407B | Motor Assembly 110V |
| 10409B | Motor Assembly 220V |
| 10428A | Coupling |
| 10717A | Switch |
| 824T | Screw (Switch Box Bracket) |