

Gatewise Module Wiring

Gatewise Staging:



Wire Prep:



Keep Wire Length Around 4 ft



Wire Strippers

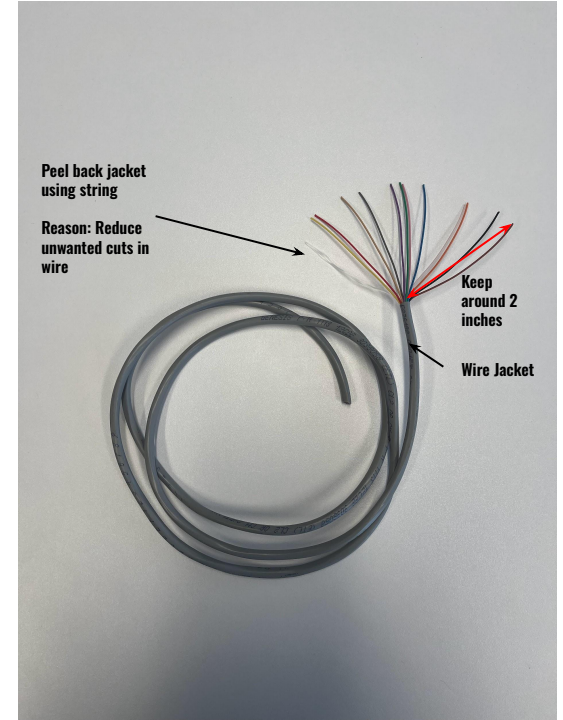

Peel back jacket
using string

Reason: Reduce
unwanted cuts in
wire

Keep
around 2
inches

Wire Jacket

Stripping Tips on Wire:

Peel back jacket using string.

Reason: Reduce unwanted cuts in wire.

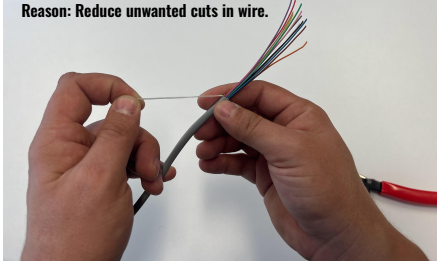

Gather all of your wires in one hand.

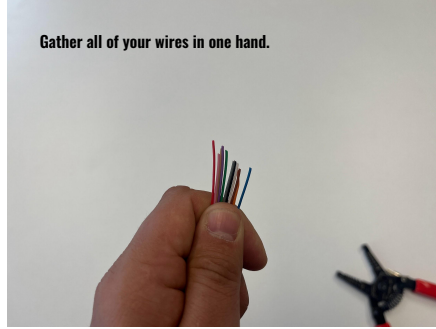

Cut off the tips to even the wire ends.

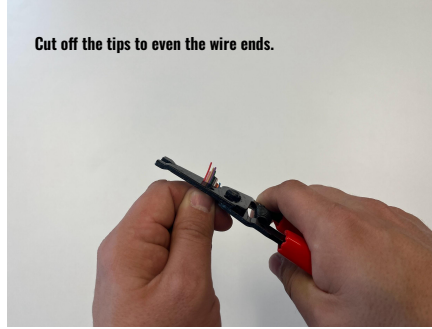

Keep holding the wires in one hand and with your forefinger and thumb grab individually each wire to cut.

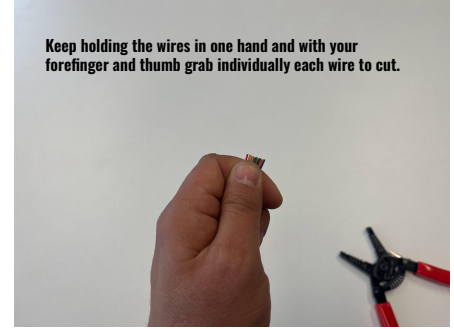

Grab your wire cutters with your other hand. Rest the wire cutters on your thumb and hold the wire ON 20/22 gauge wire slot.

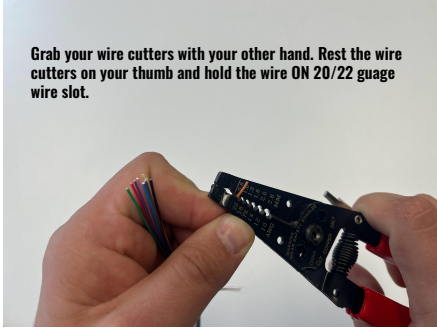

With the wire cutters in your hand peel back the jacket off the copper between ¼ in and ½ in



With your forefinger and thumb twist the copper end lightly.



Between ¼ in to ½ inch Copper Exposed

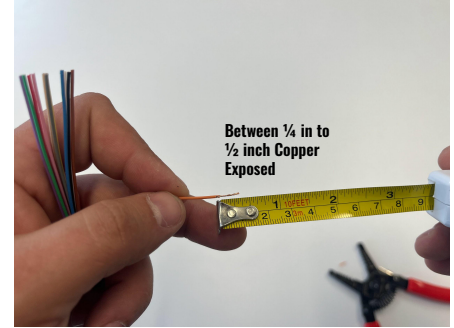

Attaching Battery and Sim Card:

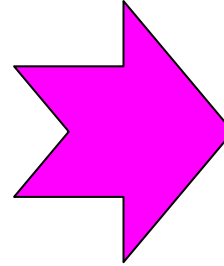
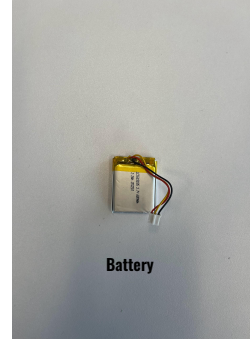
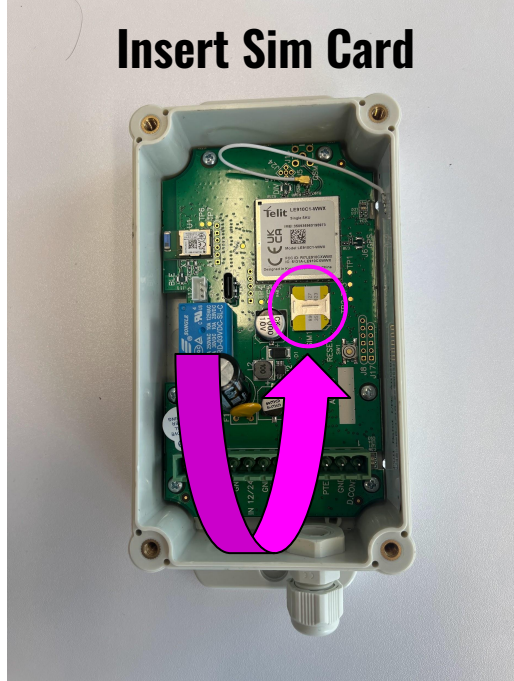
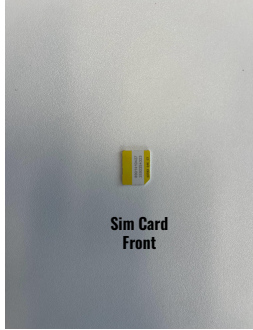

With Battery and Sim Card:

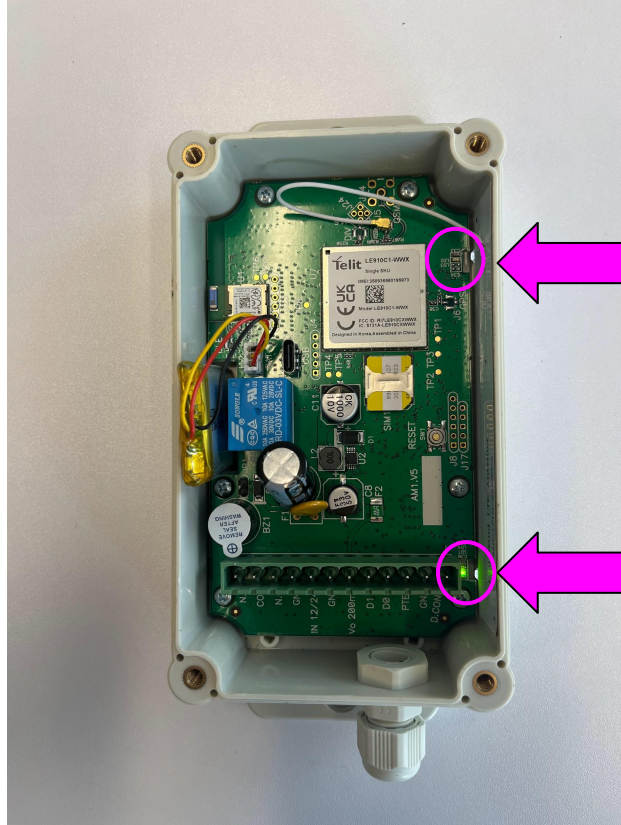

Communication LED: (When powered ON)

- 1: LED OFF - No Sim Card Inserted
- 2: LED Blinking - Normal Condition
- 3: LED Solid - Not Communicating

Top Command LED: 1 Pulse - Triggered Solid Amber (Yellow) - Schedule Engaged

Bottom Power LED:

- Solid - (Not Applicable)
- Ver. V5 - V6 Blinking - Boot Up
- OFF - Normal Condition

Terminating Wire to Terminal Blocks:

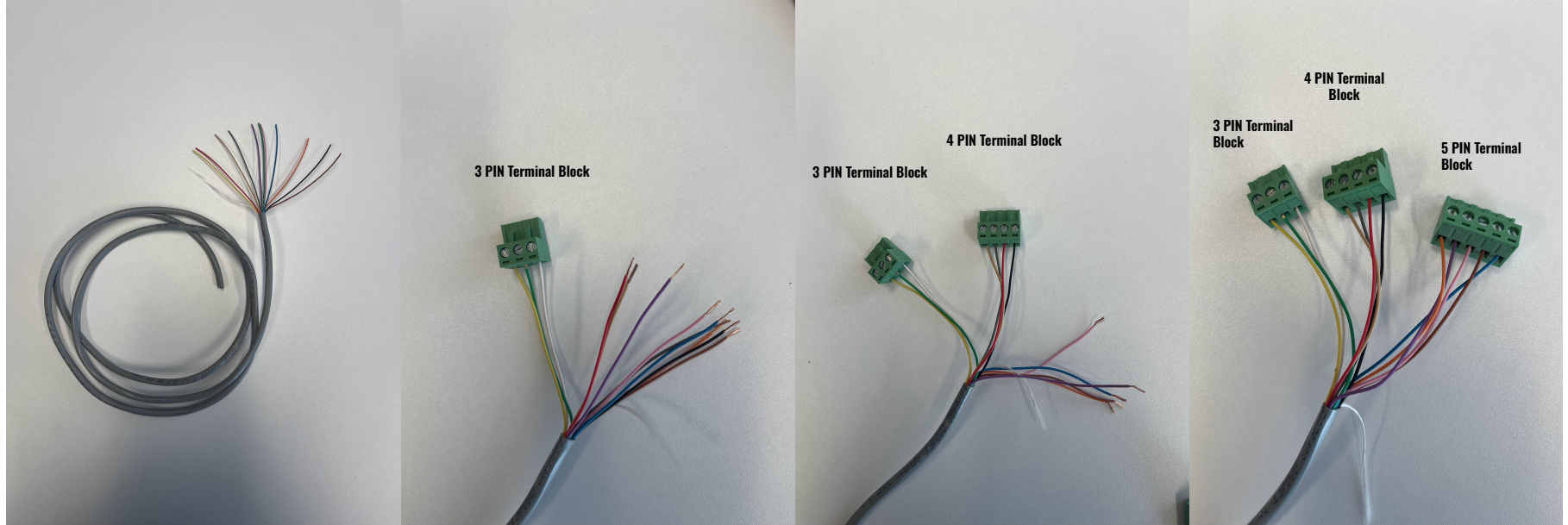

Wire to Gatewise Module: Phase 1

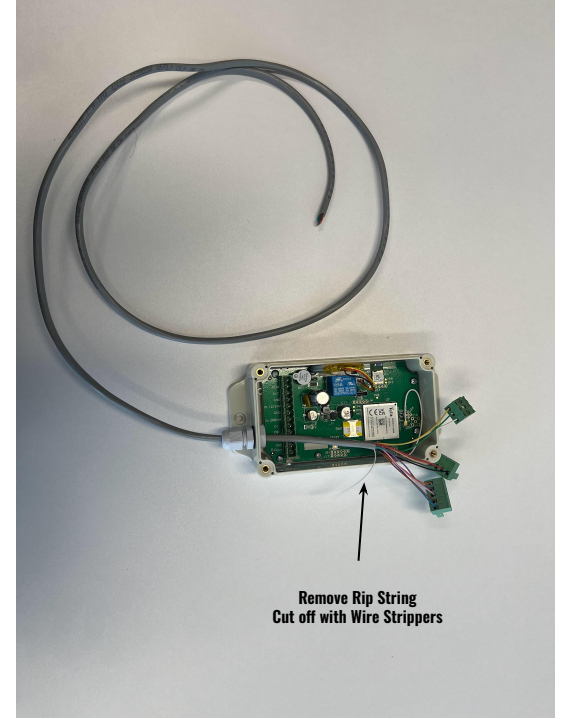
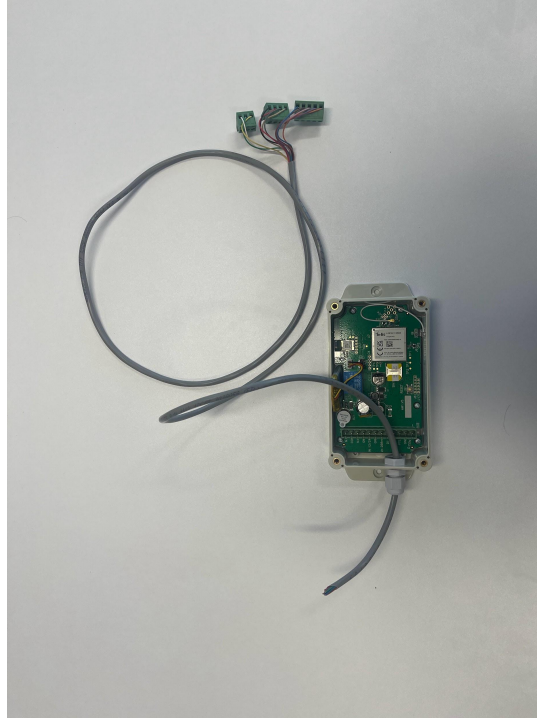
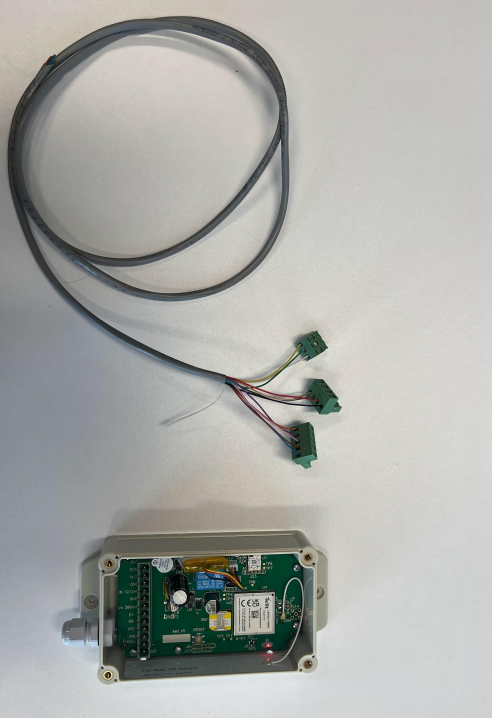

Wire to Gatewise Module: Phase 2

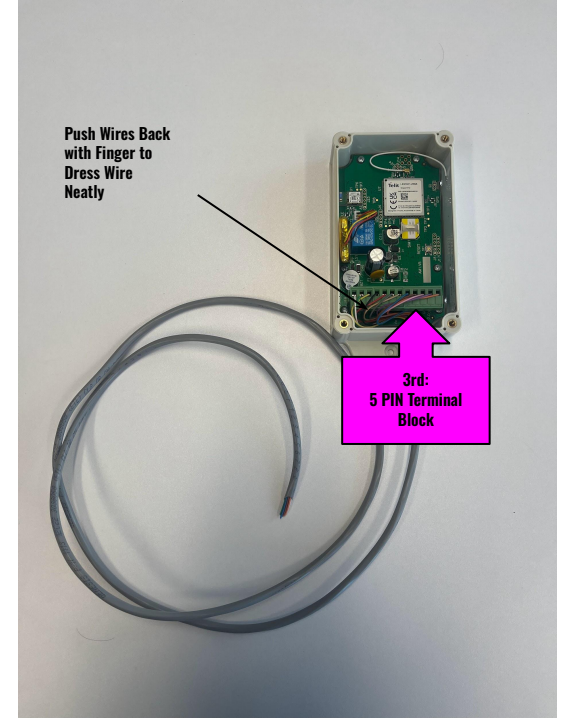
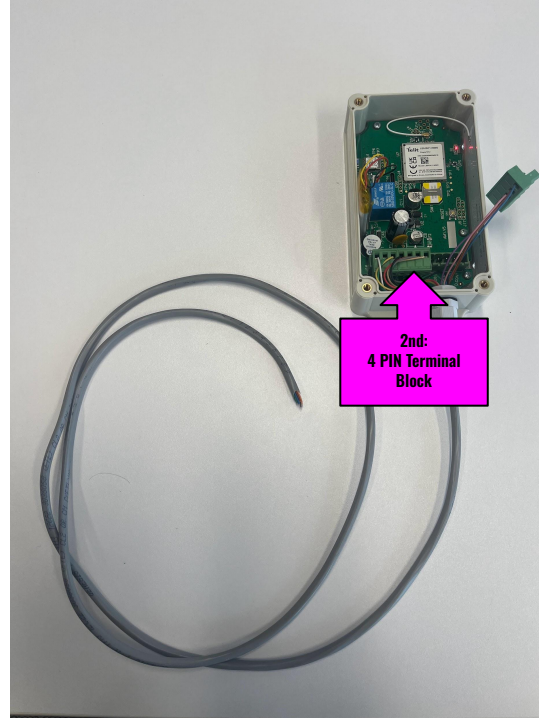
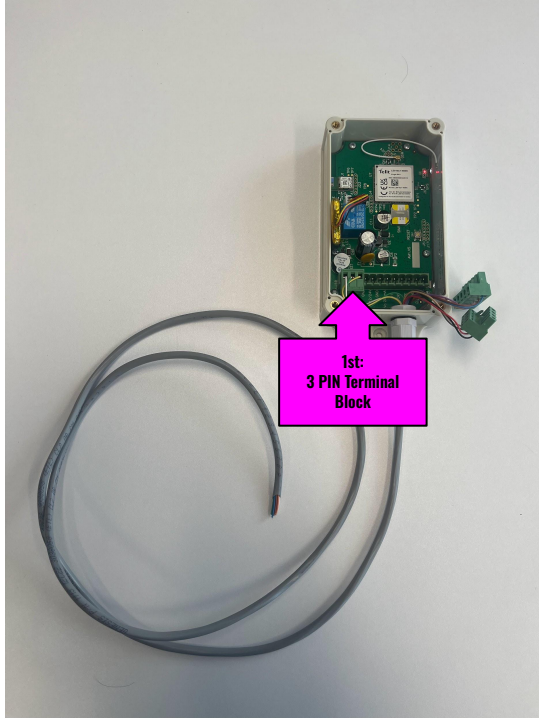

Adding Back Sticker:



Adding Front Sticker:

Remove
clear film



Make
sure
edges
Do Not
seap
over



Ready for Shipping:



Wrap the Wire a couple
time around the coil as the
last preparation before
putting gatewise module
inside bag.



END.