

Deck Plan w/ Roof Submittal

Drawings and Details

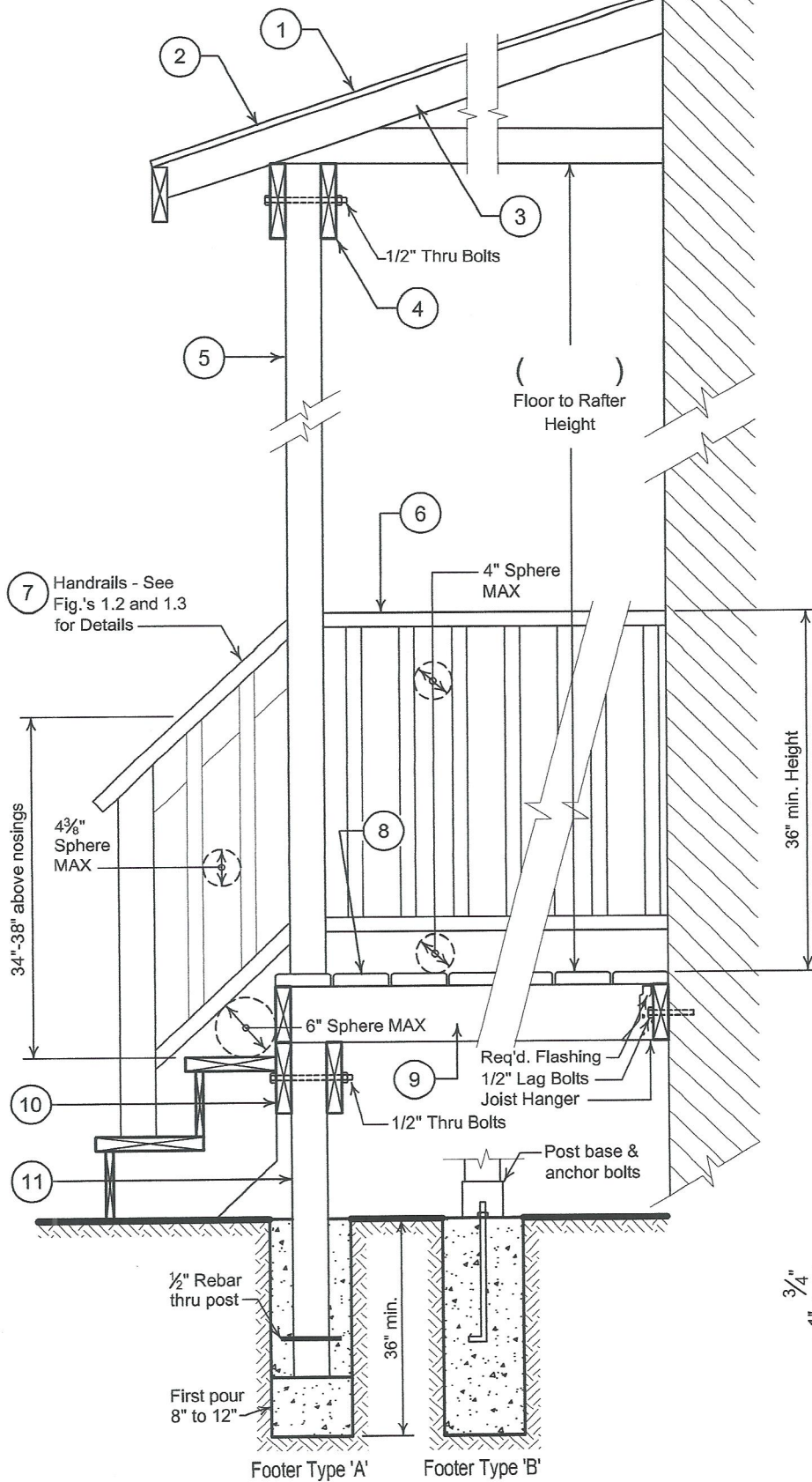

Typical Section
Figure 1.1

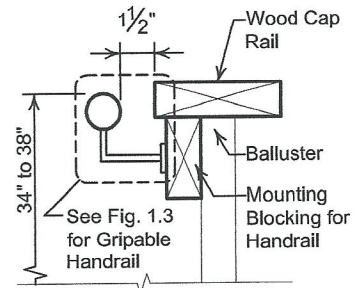

Handrail Details
Figure 1.2

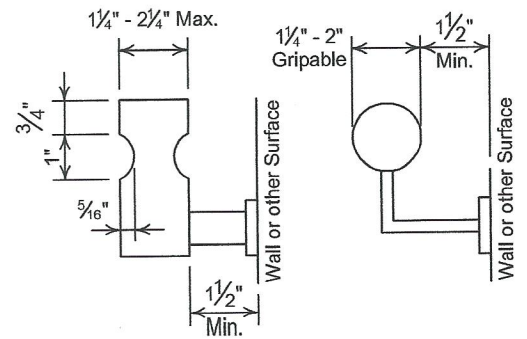

Acceptable Handrail Grips
Figure 1.3

Deck Plan w/ Roof Submittal

- Provide Plans for Roof (looking down from above) and Plan of Deck, indicate Existing Structure, and New Construction. All drawings must include types, sizes and spans of all materials used such as Posts, Beams, Joists, Trusses and Rafters.
- See Drawings and Details Figures 1.1, 1.2 and 1.3 for Item locations and additional information.

Roof Type:

- Select one: Shed ___ Gable ___ Hip ___ Other ___

Roof Size (overall dimensions):

- Length: _____ Width: _____

① Roof Covering:

- Type: _____

② Roof Sheathing:

- Type: _____ Thickness: _____

③ Rafters or Trusses: (circle one)

- Type: _____ Pitch: _____
- Span: _____ Spacing: _____

④ Carrier Beam (roof):

- Material: _____
- Size (nominal): _____ X _____
- Spacing Center to Center: _____
- Clear span distance: _____

⑤ Support Post (roof):

(n/a if post runs thru to footer)

- Material: _____
- Size (nominal): _____ X _____
- Post Length: _____

⑥ Guardrail:

- Required if floor is 30" or more above ground.
- Constructed so no opening will allow 4³/₈" sphere to pass thru.
- ✱ See note

Stairs (where applicable):

- No. of Treads (9" min.): _____
- No. Risers (8¹/₄" max.): _____
- Min. 4" high toe Kick.

⑦ Handrail:

- Constructed so no opening will allow 4³/₈" sphere to pass thru.
- See Figure 1.2 for Acceptable Handrail Details
- ✱ See note

Deck Size (overall dimensions):

- All Fasteners MUST be exterior grade.
- Length: _____ Width: _____

⑧ Flooring:

- Material: _____
- Size (nominal): _____ X _____

⑨ Floor Joists:

- Material: _____
- Size (nominal): _____ X _____
- Spacing Center to Center: _____
- Clear span distance: _____

⑩ Carrier Beam (floor):

- Material: _____
- Size (nominal): _____ X _____
- Spacing Center to Center: _____
- Clear span distance: _____

⑪ Support Post (deck):

- Material: _____
- Size (nominal): _____ X _____
- Post Length: _____

Footer:

(Select one or provide drawing if other)

- Type 'A': _____
- Type 'B': _____

✱Note:

- Handrail assemblies and guards shall be able to resist a single concentrated load of 200lbs. applied in any direction at any point along the top.

DECK PLAN WITH CANTILEVER

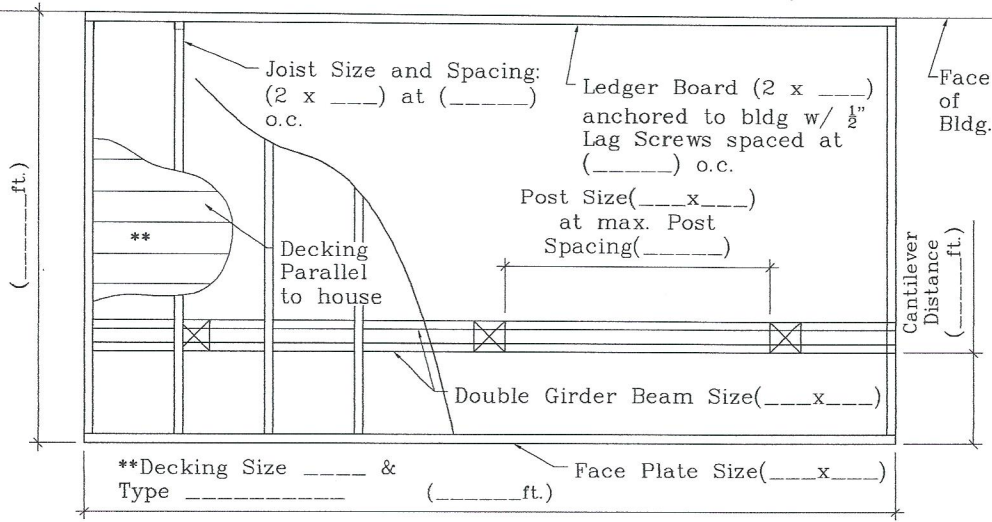

DECK PLAN WITHOUT CANTILEVER

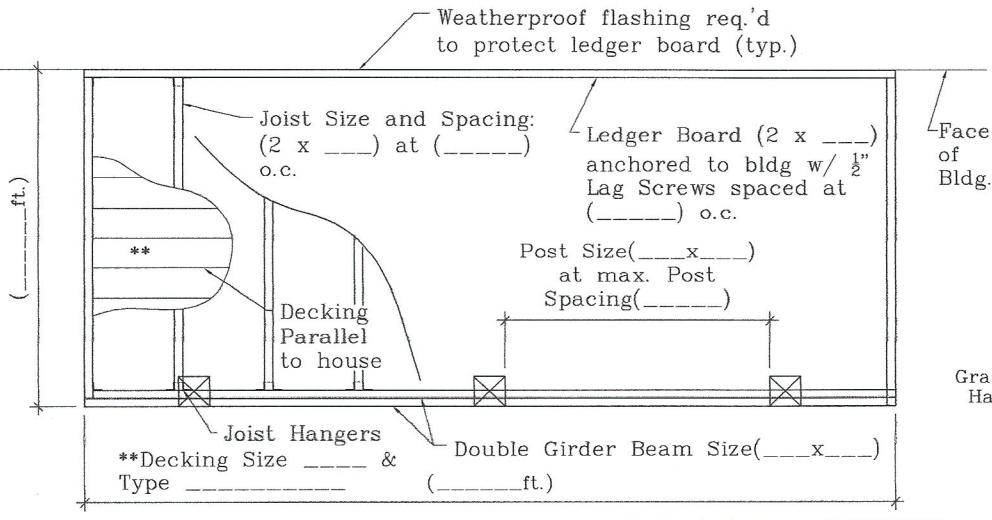

DECK PLAN WITH DECKING PERPENDICULAR TO HOUSE

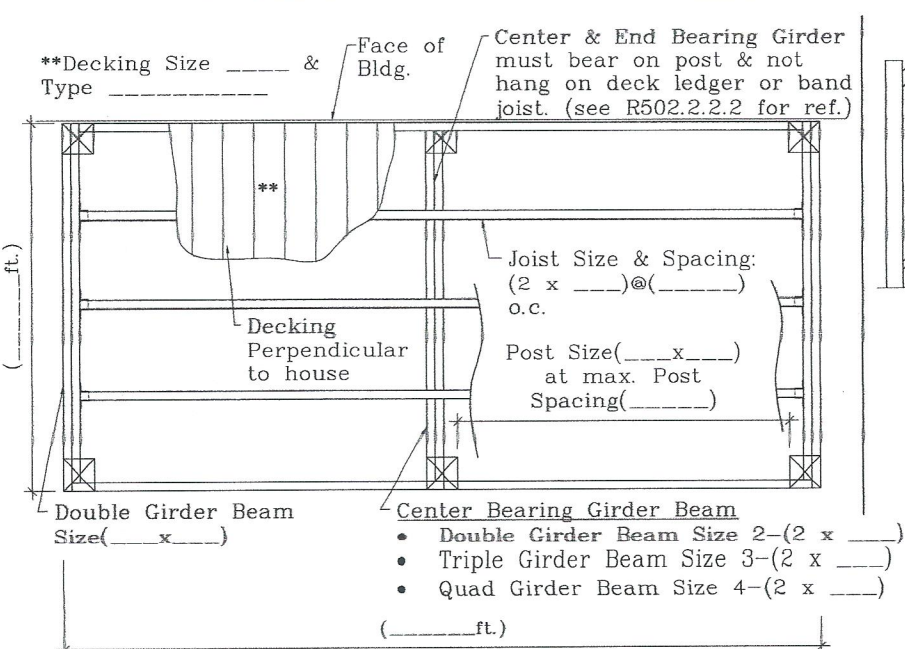

GRASPABLE HANDRAIL DETAILS

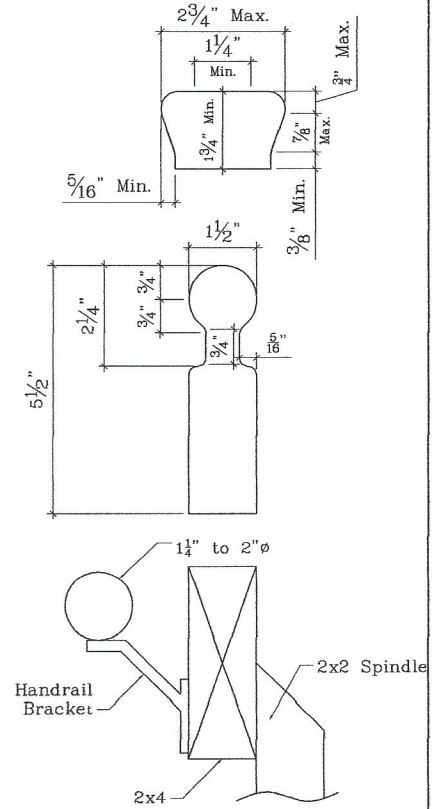

TYPICAL PORCH & LANDING SECTION

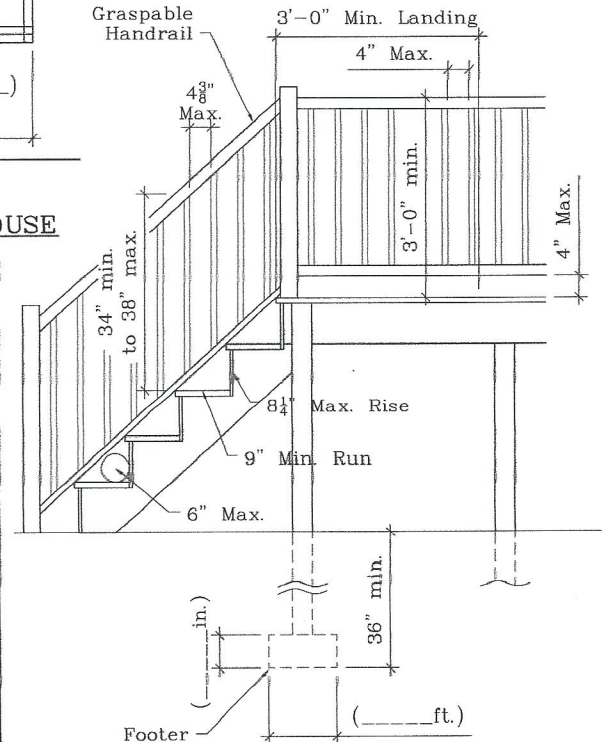

DECK DETAILS