

REVISIONS			
REV.	DESCRIPTION	DATE	APPROVED
X1	AS ISSUED		

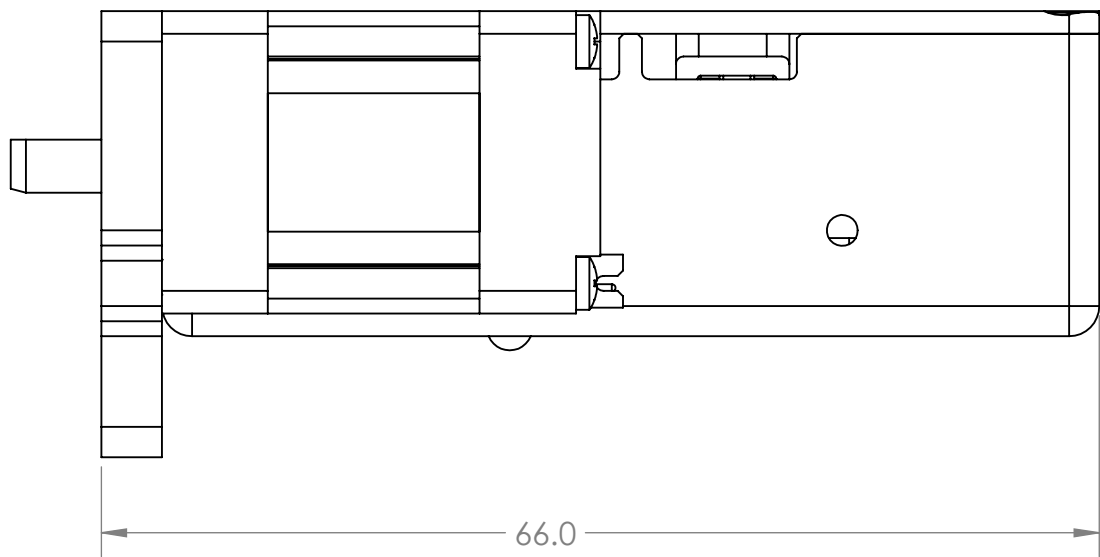
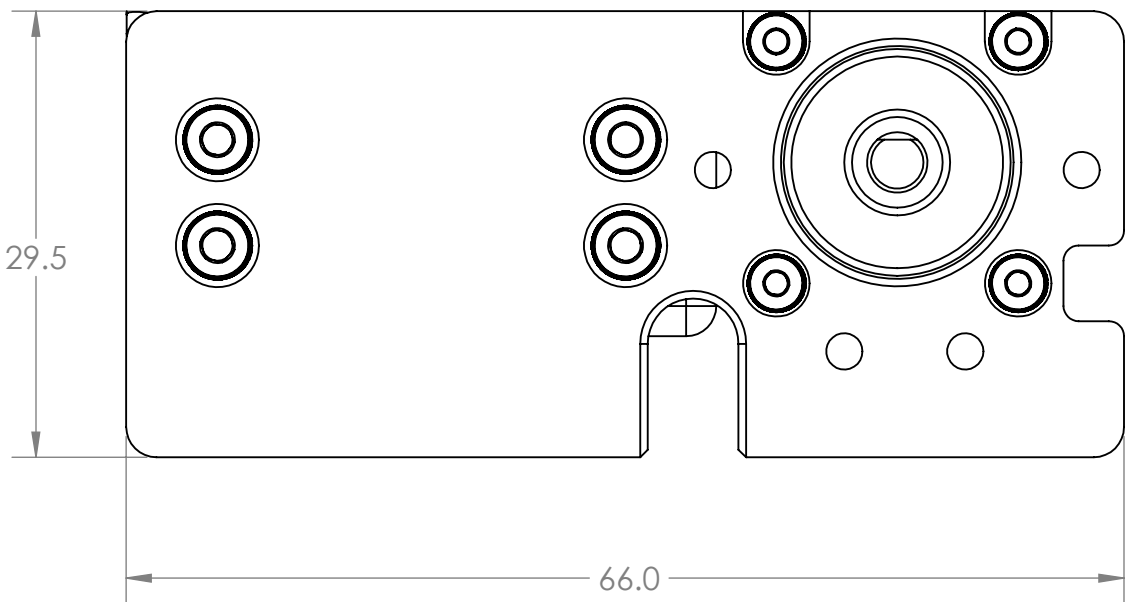
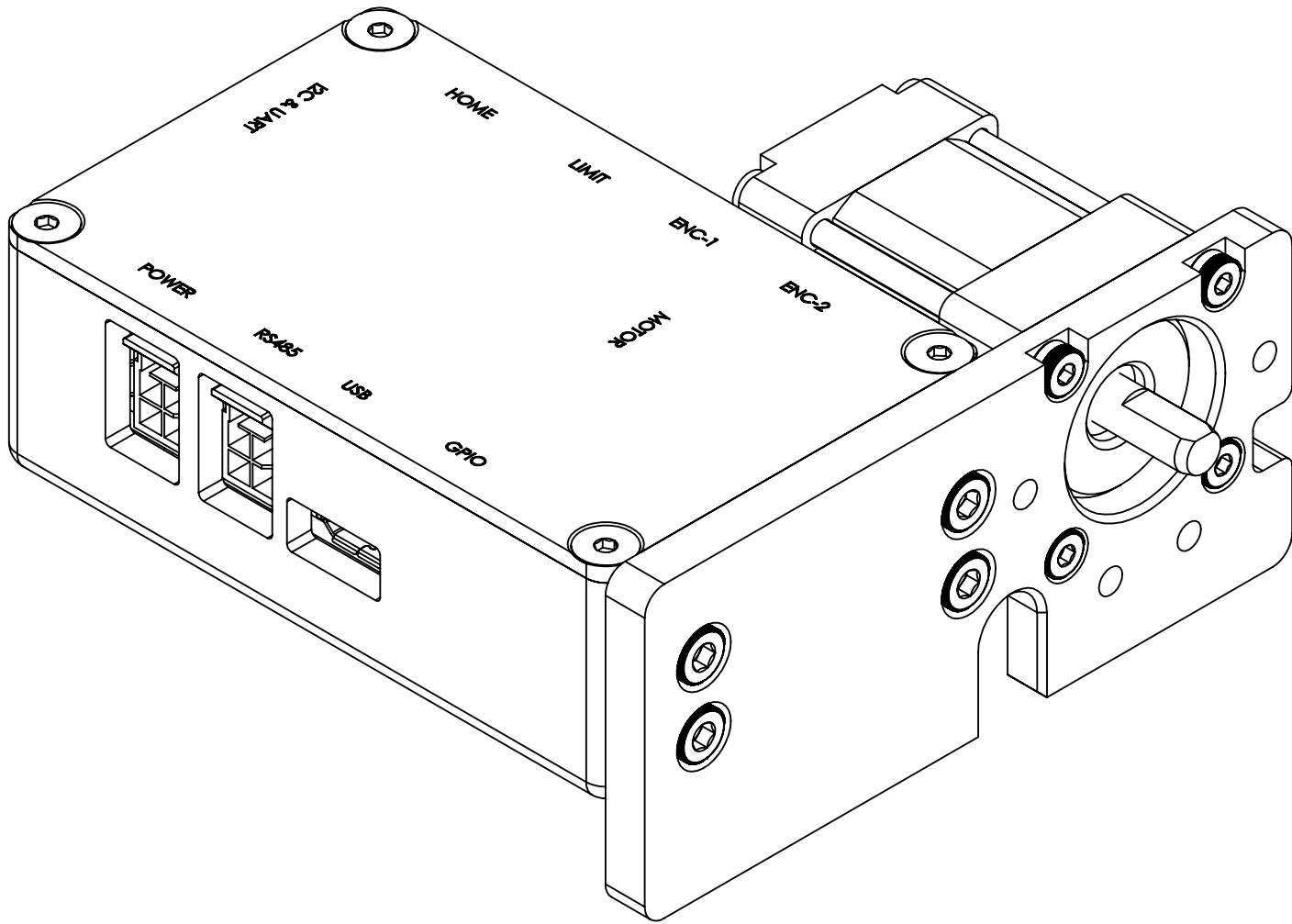
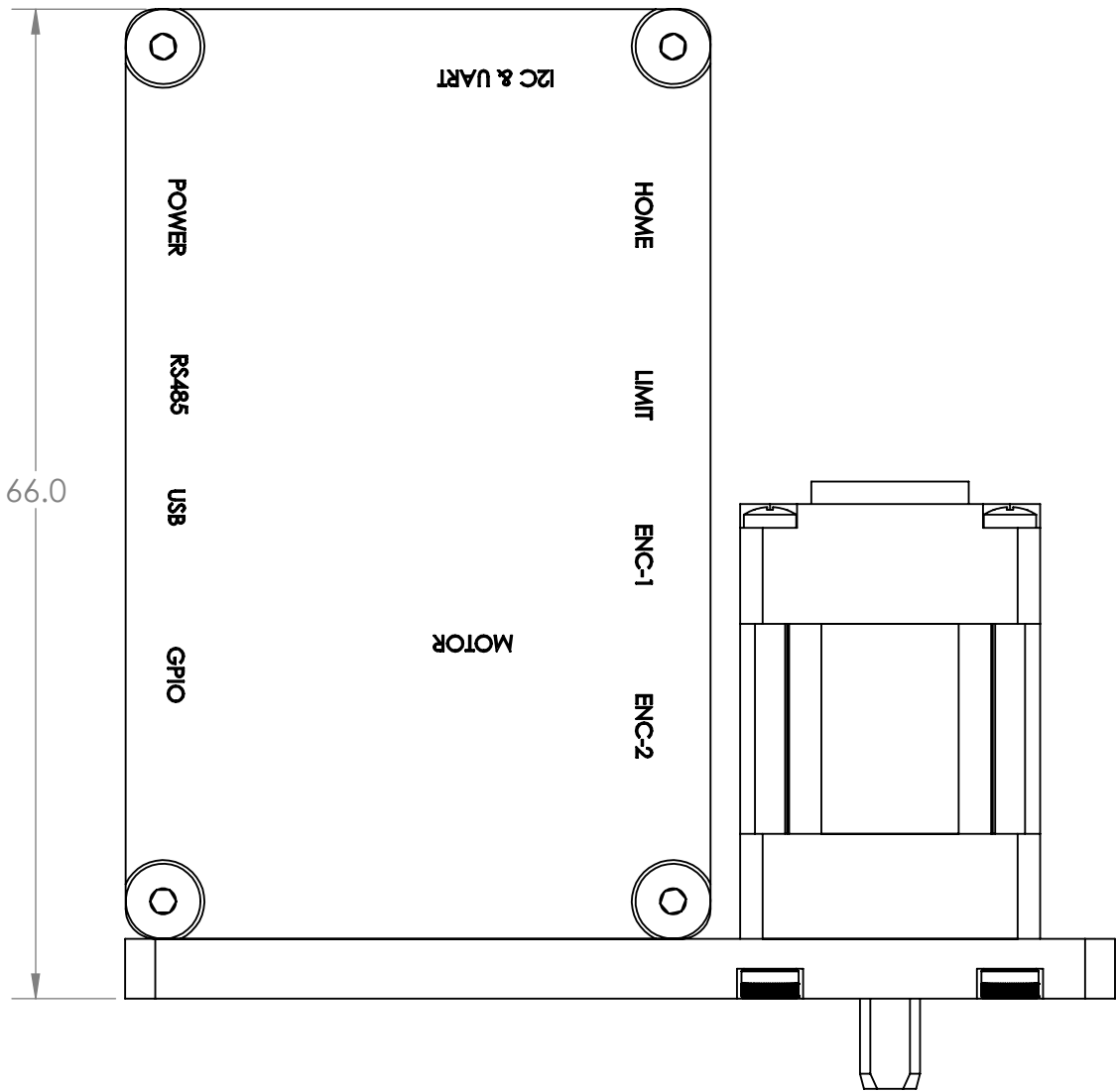

NOTES: UNLESS OTHERWISE SPECIFIED.

1. PERMANENTLY MARK WITH VENTURE PART NUMBER AND REVISION APPROX WHERE SHOWN.
2. DIMENSIONS APPLY AFTER ASSEMBLY
3. INSTALL PER MANUFACTURER'S SPECIFICATIONS
4. 3D CAD MODELS ARE SUPPLIED FOR REFERENCE ONLY.
5. INDICATES CRITICAL TO FUNCTION DIMENSION AND DESIGNATOR NUMBER.
6. RoHS COMPLIANT TO 2011/65/EU AND AMENDMENTS.
7. INDICATES A REVISION CHANGE.

3D MODEL REV AND CAD FILE NAME	
X1	PRECISION MOTION ACTUATOR, NEMA-8

INTERPRET DRAWING PER ASME Y 14.5 - 2009		UNLESS OTHERWISE SPECIFIED: DIMENSIONS ARE IN MILLIMETERS INTERPRET SHEET PER ASME Y14.5-2009 DIMENSIONS APPLY TO FINAL DELIVERED PARTS		DO NOT SCALE DRAWING			
THIRD ANGLE PROJECTION 		ALL UNTOLERANCED SURFACES: 1 A B C ALL UNTOLERANCED ANGLES: $\pm 1^\circ$ ALL UNTOLERANCED TORQUES: 6 %		APPROVALS	DATE	PART DESCRIPTION	
MATERIAL --		DRAWN SHIVA		ENG	01/23/24	PRECISION MOTION ACTUATOR, NEMA-8	
FINISH --		CHECKED --		MFG ENG	mm/dd/yy	SIZE C	PART NO. VMA1008
		QUAL ENG		mm/dd/yy		SCALE 2:1	SHEET PRECISION MOTION ACTUATOR, NEMA-8 1 OF 1