



LUXURY DUAL LIVING RETREAT WITH IDYLIC HINTERLAND VIEWS

Tightly held and rarely available, this is a golden opportunity to secure one of Tamborine Mountain's most enviable addresses. Perfectly positioned on the peaceful south side, just 5 minutes from town, this stunning acreage offers everything buyers are searching for.

Features you will love:

- ✓ Beautifully usable, elevated 2.96-acre block
- ✓ House size total area 662m²
- ✓ Dual living, built 2004
- ✓ Panoramic rural outlook of rolling hills
- ✓ Unique design, ideal for entertaining or exceptional dual living
- ✓ Two storey –with multiple living areas
- ✓ Ducted air-conditioning
- ✓ Two main entries
- ✓ Manicured grounds
- ✓ Green house
- ✓ Double bay shed
- ✓ Stable
- ✓ Prime location - southern side of Tamborine Mountain
- ✓ Location, location, location

Reasons to love the area:

Minutes to Main Street, Gallery Walk, kindergarten, schools, wineries, cafes, restaurants and local IGA. 60 minutes to Brisbane, 20 minutes to the Gold Coast.



GOODWIN REAL ESTATE

Lana Goodwin
Principal & Sales Agent
+61 488 798 878
lana@goodwinrealestate.com.au
www.goodwinrealestate.com.au

★★★★★ Perfect 5 Star Reviews
realestate.com.au sellers & buyers



**List your property
with us**

- 1.5% commission
- List now, pay later

SITE PLAN LEGEND

- 1. Driveway | 2. Double Bay Shed
- 3. Main House | 4. Second Dwelling
- 5. Fountain | 6. Green House
- 7. Water Tank | 8. Stable

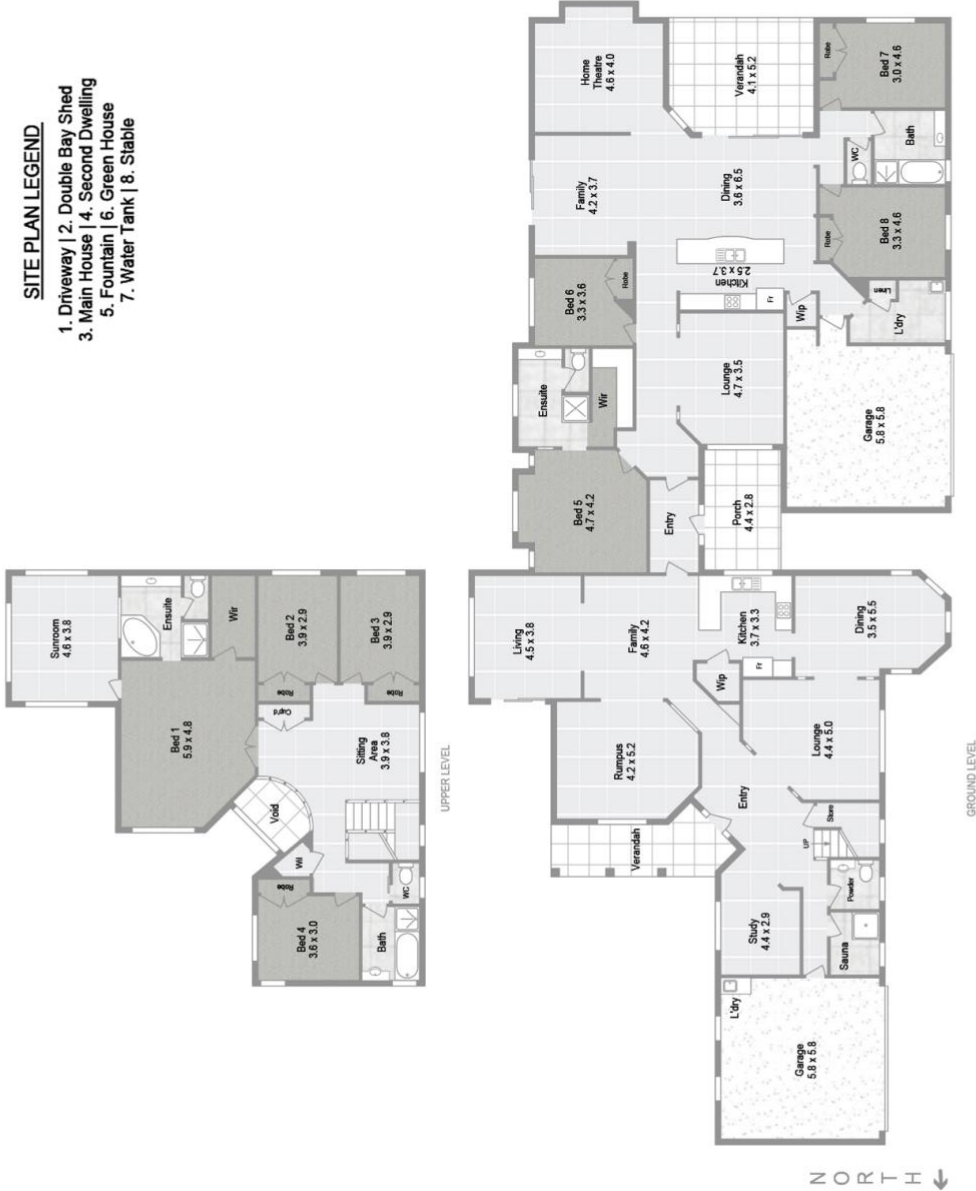

2.96

acres



8 Bed | 5 Bath | 4 Car + Off Street

Internal 615m² | External 47m² | Total 662m²

734 Main Western Road TAMBORINE MOUNTAIN



This diagram is for illustrative purpose only. All reasonable care has been taken in the preparation, but no warranty is given to the accuracy of the information. This document does not constitute any part of any offer of contract. Dimensions shown are approximate only. Prospective purchasers must rely on their own enquiries.