

1. Site Context and Design Approach

The primary design challenge was to honor and integrate the site's natural terrain. Characterized by a gentle yet intricate slope, the site required a strategic approach that minimizes excavation and earthwork. Our goal was to implement thoughtful, low-impact interventions using simple yet imaginative design elements.

In response to the topography, the proposed trail network follows the site's major contour lines, creating a seamless connection between built structures and the landscape. Given the size of the area and the location of the basin, three trails are proposed around the basin—excluding the southern section—to ensure minimal disruption while maximizing accessibility.

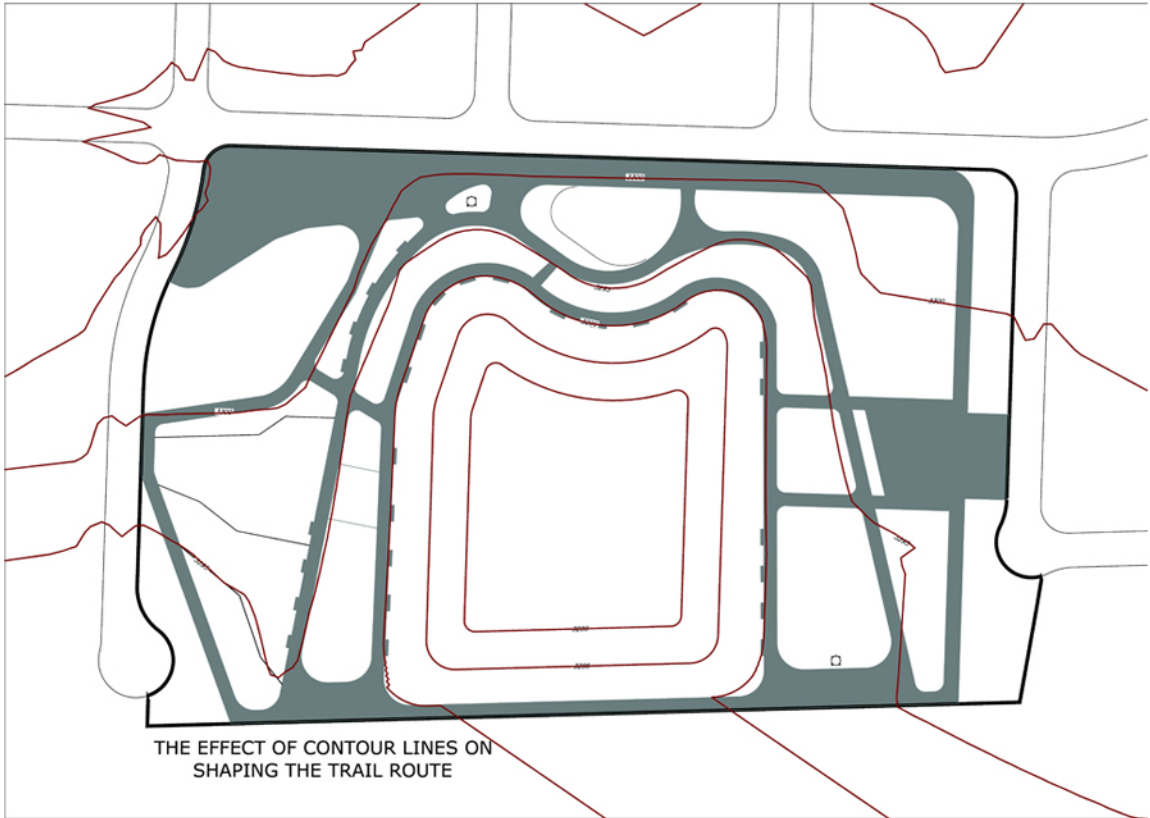

2. Community Icons: The Barns

The barns are envisioned as the park's central architectural and symbolic elements, providing both functional spaces and visual identity. Rather than a traditional gate, the entry barn serves as a welcoming structure and community hub—adaptable for meetings, exhibitions, and festivals based on evolving needs.

We propose four barns, each with a unique purpose:

Barn 01 - Entry Gate: A multifunctional entry pavilion acting as the main gateway



Barn 02 – The Heart of the Harvest: A semi-enclosed space offering panoramic views of the basin and surrounding landscape.



Barn 03 – The Art of the Harvest: A compact arts center for workshops, exhibitions, and community creativity.



Barn 04 – The Meeting Hall: A flexible event venue located on the eastern side of the site.

All barns share a uniform footprint of 28' x 60'. The entry barn reaches a height of 14', while the others stand at 12'. A contemporary design language is employed throughout, blending traditional rural character with modern expression through varied materials, colors, and façade treatments.



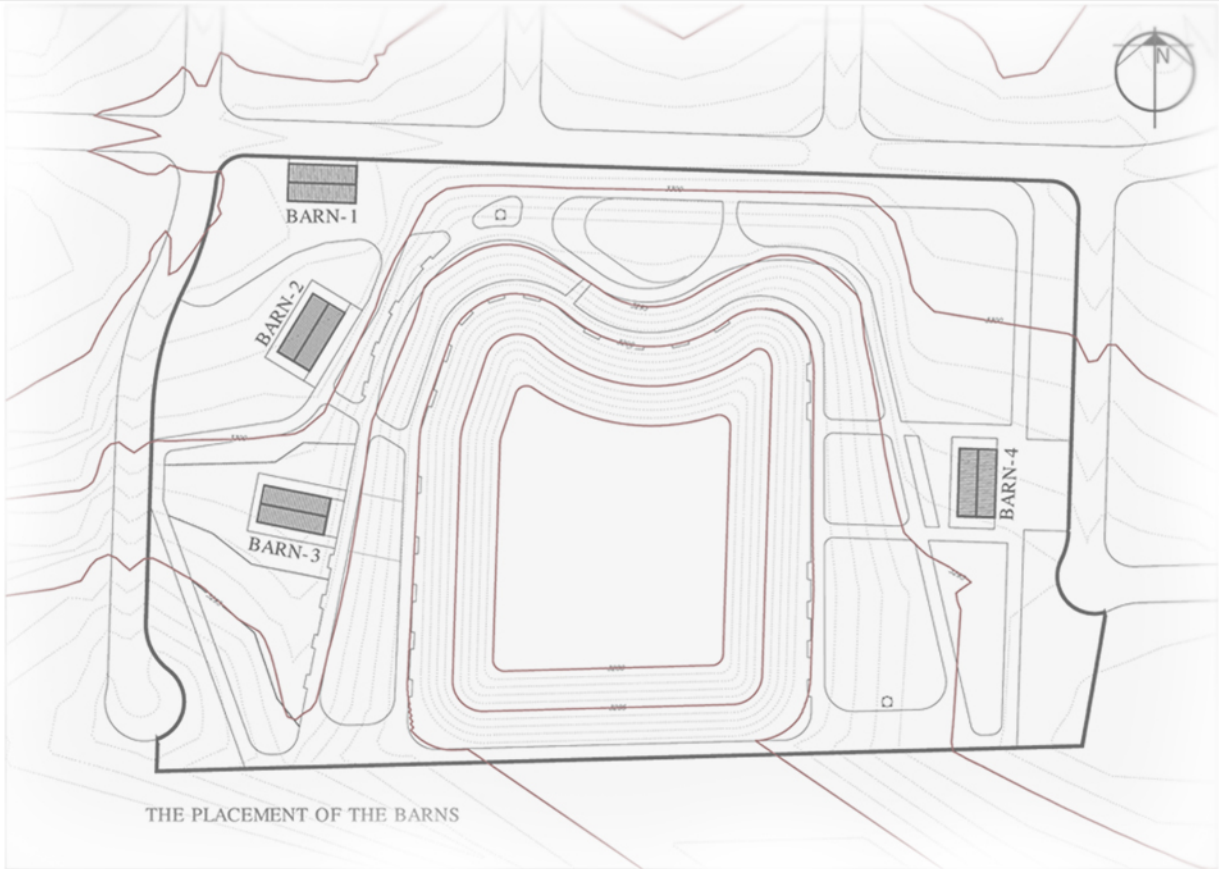

3. Site Layout and Orientation

The siting of the barns is informed by both topographic and climatic considerations. Due to the steep northern slope, the entry barn is positioned in the northwest to ensure visibility and accessibility. The remaining barns are strategically placed to frame views, enhance spatial experience, and reduce western sun exposure—providing shade and comfort during hot summer afternoons.

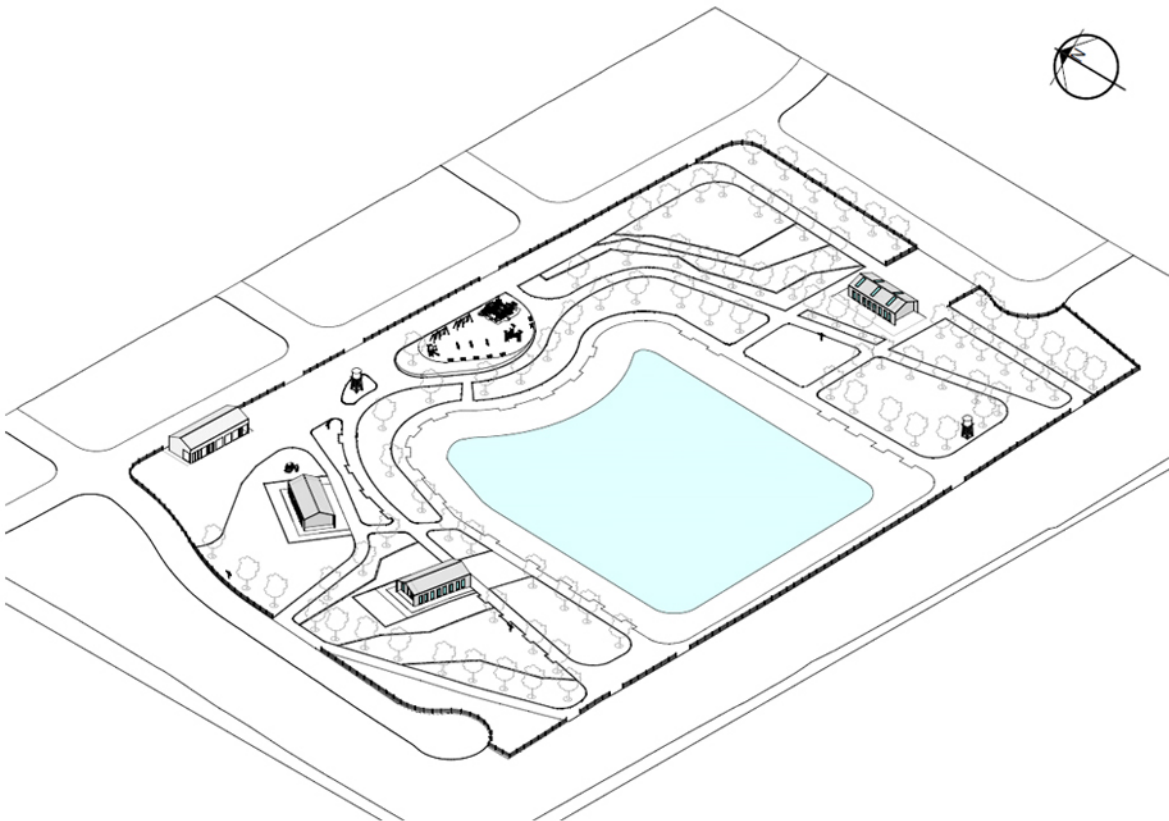



#### 4. Landscape Strategy and Rural Character

To celebrate and preserve the site's rural heritage, the landscape incorporates iconic elements such as water towers, a vintage tractor, scarecrows, and ranch-style fencing. The planting strategy emphasizes wild grasses and native trees, ensuring ecological harmony and visual continuity with the natural surroundings.



This design concept represents a balanced integration of functionality, environmental stewardship, and community engagement. The park celebrates the region's rural identity while offering flexible, inclusive spaces for gathering, creativity, and recreation.

Through the deliberate placement of community barns, a trail network aligned with the land's natural contours, and the use of local materials and native plantings, Basin Park emerges as a place of belonging and beauty. It is envisioned as a sustainable, culturally resonant destination—one that fosters connection to nature and to each other for generations to come.