

KCD



Karter's
Cabinet
Depot



PREMIER PRODUCT
2023 CATALOG

Our Vision

We provide thoughtful products and exceptional service to inspire spaces where people love to live.

Table of Contents

Cabinet Lines.	4
Product Comparison.	11
Product Specifications.	13
Wall Cabinets	14
Base Cabinets	17
Tall Cabinets	21
Vanity Cabinets	22
Moldings & Trim.	24
Fillers & Panels.	25
Accessories.	26
Decorative Hardware.	29
Products By Line.	35

Cabinet Lines

Our Premier Series offers distinctive touches and superb craftsmanship, satisfying either the traditional or modern design palette with a look to fit any lifestyle.



SHAKER SAND (SS)



SHAKER GREY (SG)

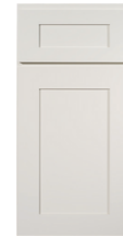

SHAKER DESIGNER WHITE 5PC (SW)

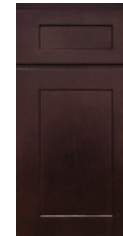

SHAKER ESPRESSO (SE)



SHAKER KODIAK (SK)



SHAKER BLACK (SB)



BROOKLYN MODERN GRAY (BG)

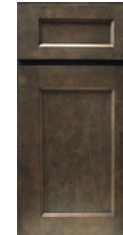

BROOKLYN SLATE (BS)



BROOKLYN BRIGHT WHITE (BW)



BROOKLYN FAWN (BF)



SHAKER BROWN (SBN)



SHAKER NATURAL (SN)

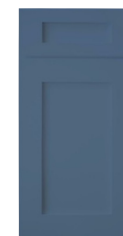

SHAKER BLUE (SB)



Shaker Sunny Maple (SM)

Shaker

Bright, crisp, and modern, this cabinet has a versatile appeal. The design incorporates the architectural shaker style with pleasing proportions. Shaker White is available with a slab or 5-piece drawer front yielding a contemporary or classic display.

- Full overlay doors provide a seamless aesthetic
- Soft-close doors and drawers prevent slamming
- Dovetail drawer craftsman construction
- Full extension drawers ensure easy access
- Durable solid wood cabinet box and drawers
- Premium Sherwin-Williams® finish delivers a lifetime of beauty
- Full line of accessories and upgrades available



Shaker Natural

Shaker Brown

Shaker Designer Black

Shaker Sunny Maple

Shaker Sunny Maple

Shaker Designer Grey

Shaker Designer White

Shaker Sand

Shaker Kodiak

Shaker Espresso



Brooklyn

This transitional door complements a range of style from modern to vintage to traditional. The selection of color options within the Brooklyn line offers a solution for many design needs. Find modern charm in Brooklyn Gray or install a Slate island for the perfect kitchen accent that your guests will love. Brooklyn's classic Bright White finish provides a timeless backdrop for a space that will become a gathering spot for years to come.

- Full overlay doors provide a seamless aesthetic
- Soft-close doors and drawers prevent slamming
- Dovetail drawer craftsman construction
- Full extension drawers ensure easy access
- Solid wood cabinet box and drawers provide exceptional durability
- Premium Sherwin-Williams® finish delivers a lifetime of beauty
- Available with a full line of accessories and upgrades



Brooklyn Fawn

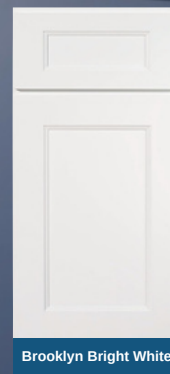

Brooklyn Bright White

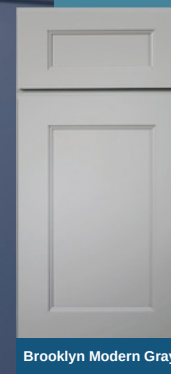

Brooklyn Modern Gray



Brooklyn Midnight

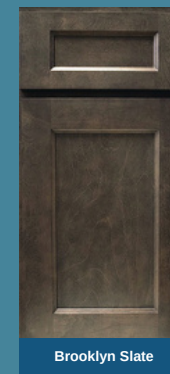

Brooklyn Slate

Product Specifications

Wall Cabinets - Base Cabinets - Tall Cabinets - Vanity Cabinets

Molding & Trim - Fillers & Panels - Decorative Accessories



CREATIVE OPTIONS
FOR ANY SPACE

Wall Cabinet Coding

Standard (12" Deep)

W	30	36
CABINET CODE	CABINET WIDTH	CABINET HEIGHT

Refrigerator

W	36	18	24
CABINET CODE	CABINET WIDTH	CABINET HEIGHT	CABINET DEPTH

Notes:

- Standard wall cabinets are 12" deep. Refrigerator cabinets are 24" deep. • Add door thickness for total cabinet depth.
- Please refer to the Products by Cabinet Line chart to determine which products are carried for each cabinet line.

24" High Double Door Wall



Item Code	Outer Dimensions		
	W	H	D
W3024	30 24	12	
W3324	33 24	12	
W3624	36 24	12	

15" Wall Stacking Cabinets with Glass



Item Code	Outer Dimensions		
	W	H	D
WS2415-2	24 15		1
WS2715-2	27 15		1
WS3015-2	30 15		2
WS3315-2	33 15		2
WS3615-2	36 15		1

*Door comes pre-routed with glass insert and finished interior

24" Deep Wall (Refrigerator Cabinet)



Item Code	Outer Dimensions		
	W	H	D
W331824	33 18	24	
W332424	33 24	24	
W361824	36 18	24	
W362424	36 24	24	

*331824 and 361824 do not have a shelf

15" Wall Stacking Cabinets with Glass



Item Code	Outer Dimensions		
	W	H	D
WS1215	12 15	12	
WS1515	15 15	12	
WS1815	18 15	12	
WS2115	21 15	12	

*Door comes pre-routed with glass insert and finished interior

30" Microwave Wall Cabinet

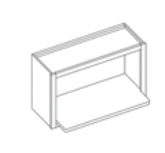

Item Code	Outer Dimensions		
	W	H	D
MWC3018	30 18	12	

15" Corner Wall Stacking Cabinet with Glass



Item Code	Outer Dimensions		
	W	H	D
CWS2415	24 15	12	
CWS2715	27 15	12	

*Door comes pre-routed with glass insert and finished interior

30" - 36" High Single Door Wall

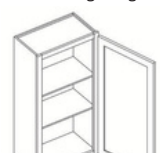

Item Code	Outer Dimensions		
	W	H	D
W930	9 30	12	
W1230	12 30	12	
W1530	15 30	12	
W1830	18 30	12	
W2130	21 30	12	
W936	9 36	12	
W1236	12 36	12	
W1536	15 36	12	
W1836	18 36	12	
W2136	21 36	12	

12" - 21" High Double Door Wall



Item Code	Outer Dimensions		
	W	H	D
W3012	30 12	12	
W3612	36 12	12	
W3015	30 15	12	
W3312	33 12	12	
W3315	33 15	12	
W3615	36 15	12	
W3018	30 18	12	
W3318	33 18	12	
W3618	36 18	12	
W3021	30 21	12	

30" - 36" High Double Door Wall

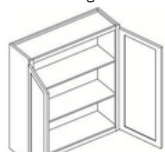

Item Code	Outer Dimensions		
	W	H	D
W2430-2	24 30	12	
W2730	27 30	12	
W3030	30 30	12	
W3330	33 30	12	
W3630	36 30	12	
W3930	39 30	12	
W2436-2	24 36	12	
W2736	27 36	12	
W3036	30 36	12	
W3336	33 36	12	
W3636	36 36	12	
W3936	39 36	12	



Installing a Blind Wall Cabinet

Proper installation ensures that the doors will open and show correct reveal

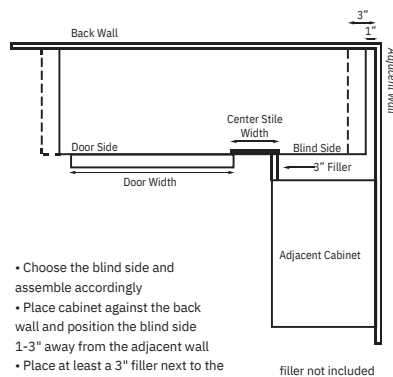

- Choose the blind side and assemble accordingly
- Place cabinet against the back wall and position the blind side 1-3" away from the adjacent wall
- Place at least a 3" filler next to the adjacent cabinet

filler not included

Wall Tower with 3 Drawers



Item Code	Outer Dimensions		
	W	H	D
DWR1548	15	48	15
DWR1554	15	44	15
DWR1560	15	40	15

*Works great with a vanity

Wine Rack

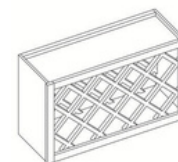

Item Code	Outer Dimensions		
	W	H	D
WR3018	30	18	12

30" - 36" High Double Door with Center Stile

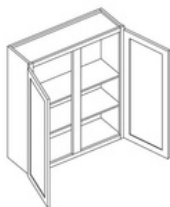

Item Code	Outer Dimensions		
	W	H	D
W4230	4	4	
W4236	3	4	
	1	2	
	42	36	12

42" High Double Door Wall



Item Code	Outer Dimensions		
	W	H	D
W2442-2	24	42	12
W2742	27	42	12
W3042	30	42	12
W3342	33	42	12
W3642	36	42	12
W3942	39	42	12

30" - 36" High Corner Wall



Item Code	Outer Dimensions		
	W	H	D
CW2430	24	30	12
CW2436	24	36	12
CW2736	27	36	15

42" High Single Door Wall



Item Code	Outer Dimensions		
	W	H	D
W942	9	42	12
W1242	12	42	12
W1542	15	42	12
W1842	18	42	12
W2142	21	42	12

42" High Double Door Wall with Center Stile

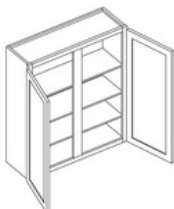

Item Code	Outer Dimensions		
	W	H	D
W4242	4	2	
	4	2	
	1	2	

42" High Corner Wall



Item Code	Outer Dimensions		
	W	H	D
CW2442	24	42	12
CW2742	27	42	15



30" - 36" High Blind Wall

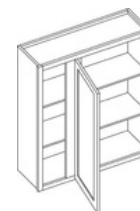

Item Code	Outer Dimensions		
	W	H	D
BW2430	24	30	12
BW3030	30	30	12
BW3630	36	30	12
BW2436	24	36	12
BW3036	30	36	12
BW3636	36	36	12

*Image shown is hinge left

42" High Blind Wall



Item Code	Outer Dimensions		
	W	H	D
BW3042	30	42	12
BW3642	36	42	12

*Image shown is hinge left

Base Cabinet Coding



- Notes:
- Standard base cabinets are 24" deep and 34.5" high.
 - Add door thickness for total cabinet depth.
 - Please refer to the Products by Cabinet Line chart to determine which products are carried for each cabinet line.
 - Napa White has a single drawer on all sizes.

Microwave Base Cabinet



Item Code	Outer Dimensions		
	W	H	D
MBC30	30	34.5	24

*Finished interior

Single Door Full Height Base



Item Code	Outer Dimensions		
	W	H	D
B09	9	34.5	24

Single Door Standard Base



Item Code	Outer Dimensions		
	W	H	D
B12	12	34.5	24
B15	15	34.5	24
B18	18	34.5	24
B21	21	34.5	24

Double Door Standard Base with Center Stile



Item Code	Outer Dimensions		
	W	H	D
B42	42	34.5	24

Double Door Standard Base



Item Code	Outer Dimensions		
	W	H	D
B24-2*	24	34.5	24
B27	27	34.5	24
B30	30	34.5	24
B33	33	34.5	24
B36	36	34.5	24
B39	39	34.5	24

*B24-2 has one drawer and two doors
*Napa White has a single drawer front on all sizes.

Easy Reach

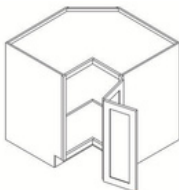

Item Code	Outer Dimensions		
	W	H	D
ER33	33	34.5	24
ER36	36	34.5	24

Trash Can Base (Full Height)

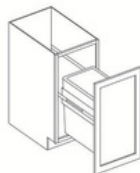

Item Code	Outer Dimensions		
	W	H	D
TRB-1*	18	34.5	24
TRB-2**	18	34.5	24

*Includes one 50 QT can
**Includes two 35 QT cans

Sink Base



Item Code	Outer Dimensions		
	W	H	D
SB30	30	34.5	24
SB33	33	34.5	24
SB36	36	34.5	24

Desk Drawer Base



Item Code	Outer Dimensions		
	W	H	D
DOB18	18	27.5	24

Cooking Center



Item Code	Outer Dimensions		
	W	H	D
CC30	30	34.5	24

Drawer Base



Item Code	Outer Dimensions		
	W	H	D
DB12-3	12	34.5	24
DB15-3	15	34.5	24
DB18-3	18	34.5	24
DB21-3	21	34.5	24
DB24-3	24	34.5	24
DB27-3	27	34.5	24
DB30-3	30	34.5	24
DB33-3	33	34.5	24
DB36-3	36	34.5	24

Drawer Base - 2 Drawer



Item Code	Outer Dimensions		
	W	H	D
DB30-2	30	34.5	24
DB36-2	36	34.5	24



Sink Base with Center Stile



Item Code	Outer Dimensions		
	W	H	D
SB42	42	34.5	24
SB48	48	34.5	24

36" Farm Sink Base



Item Code	Outer Dimensions		
	W	H	D
FSB36	36	34.5	24

*Height of sink inset is 13.5"

Corner Sink Front

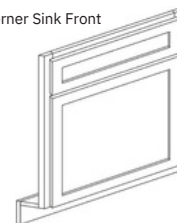

Item Code	Outer Dimensions		
	W	H	D
CSF42	27	34.5	24
CSF-FLOOR*	48	34.5	48

*Sink floor not pictured and sold separately
*Back of face frame measures 27" wide
NOTE: Hinges not included, to use as a workable door corner hinges are recommended.

36" Blind Base



*Image shown is hinge left

Item Code	Outer Dimensions		
	W	H	D
BB36	30	34.5	24

42" - 48" Blind Base

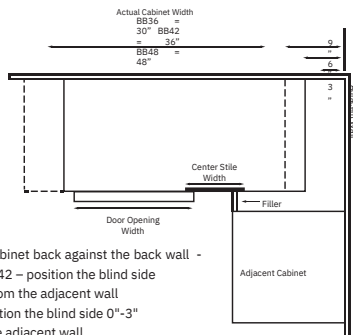

*Image shown is hinge left

Item Code	Outer Dimensions		
	W	H	D
BB42	36	34.5	24
BB48	48	34.5	24

Installing a Blind Base Cabinet

Proper installation ensures that the drawer will clear hardware, and doors will open, and show correct reveal



- Place the cabinet back against the back wall - BB36 and BB42 - position the blind side 6"-9" away from the adjacent wall
- BB48 - position the blind side 0"-3" away from the adjacent wall
- Place at least a 3" filler next to adjacent cabinet

*Filler not included



Tall Cabinet Coding



- Notes:
- Standard tall cabinets are 24" deep.
 - Add door thickness for total cabinet depth.
 - Please refer to the Products by Cabinet Line chart to determine which products are carried for each cabinet line.

Single Door Pantry

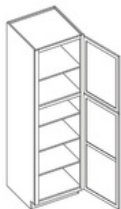

Item Code	Outer Dimensions		
	W	H	D
P1884*	18 8/8	24	
P1890*	18 9/8	24	
P1896**	18 9/8	24	

*Includes four shelves
**Includes five shelves

24" and 30" Double Door Pantry



Item Code	Outer Dimensions		
	W	H	D
P2484*	24 8/8	24	
P2490*	24 9/8	24	
P2496**	24 9/8	24	
P3090*	30 8/8	24	
P3096**	30 9/8	24	

*Includes four shelves
**Includes five shelves

Oven Cabinet (Includes One Drawer)



Item Code	Outer Dimensions		
	W	H	D
OC3390	33 9/8	24	
OC3396	33 9/8	24	

*Includes one drawer



Oven Cabinet Drawer



Item Code	Outer Dimensions		
	W	H	D
OCD337	32.5	6.75	24

Oven Cabinet Overlay Panel

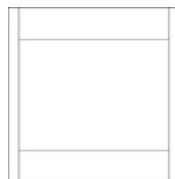

Item Code	Outer Dimensions		
	W	H	D
OP3353	32.5	33.0	24

Vanity Cabinet Coding



- Notes:
- Standard vanity cabinets are 21" deep.
 - Add door thickness for total cabinet depth.
 - Please refer to the Products by Cabinet Line chart to determine which products are carried for each cabinet line.
 - Napa White has a single drawer on all sizes.

Vanity Combo Cabinet 36"

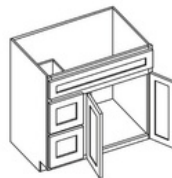

Item Code	Outer Dimensions		
	W	H	D
VSBD36	36	34.5	21
VSDL36	36	34.5	21

*Pictured is the VSDL36

Vanity Combo Cabinet 30"

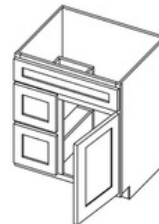

Item Code	Outer Dimensions		
	W	H	D
VSBD30	30	34.5	21
VSDL30	30	34.5	21

*Pictured is the VSDL30

Single Door Vanity

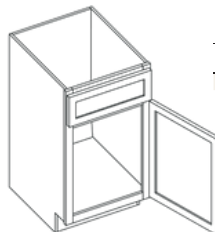

Item Code	Outer Dimensions		
	W	H	D
V21	21	34.5	21



36" Open Shelf Vanity Sink Base



Item Code	Outer Dimensions		
	W	H	D
VSBOS36	36	34.5	21

*Includes adjustable feet
*Total height does not account for adjustable foot height

Double Door Vanity



Item Code	Outer Dimensions		
	W	H	D
V24-2*	24	34.5	21
V27	27	34.5	21
V30	30	34.5	21
V33	33	34.5	21
V36	36	34.5	21

*Has a single drawer front.
Note: Napa White has a single drawer front on all sizes.

Vanity Drawer Base



Item Code	Outer Dimensions		
	W	H	D
VDB12	23.4	21	
VDB15	34.5	21	
VDB18	45.5	21	
VDB24	66.5	21	

Vanity Sink Base



Item Code	Outer Dimensions		
	W	H	D
VSB36	34.5	21	
VSB42	45.5	21	
VSB48	66.5	21	

Single Door Vanity Base



Item Code	Outer Dimensions		
	W	H	D
VB12	12.34	21	
VB15	15.34	21	
VB18	18.34	21	

24" Vanity Drawer



Item Code	Outer Dimensions		
	W	H	D
KD24	23.5	7.75	21

*Drawer box height is 2"
NOTE: All drawer fronts will have a slab profile.

36" Vanity Drawer



Item Code	Outer Dimensions		
	W	H	D
KD36	29.5	8.75	21

*Drawer box height is 2"
* Sides Trimmable to 30"
NOTE: All drawer fronts will have a slab profile.



Toe Kick - TKS8

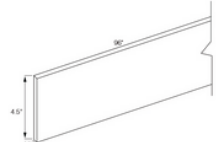

Large Crown Molding - BCM8

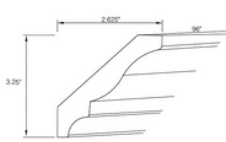

Outside Corner Molding - OCM8

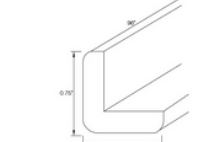

Scribe - SCRIBE

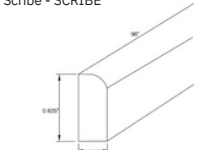

Royal Crown Molding - RCM8

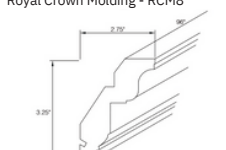

Traditional Light Rail Molding - LRM8

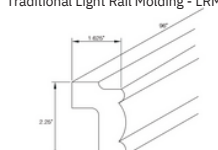

Shoe - SHOE

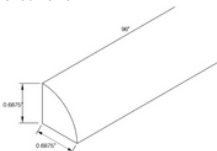

Shaker Crown Molding - SCM8

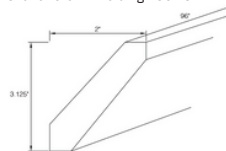

Bottom Edge Molding - BEM8

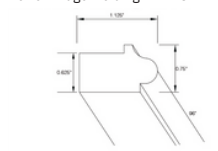

Furniture Base Molding - FBM8

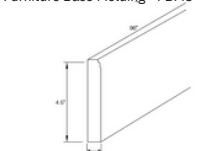

Cove Crown Molding - COM8

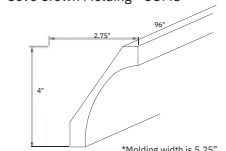

*Molding width is 5.25"

Traditional Crown Molding - CM8

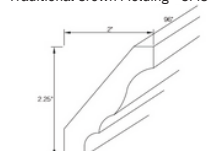

Batten Molding - BAM8

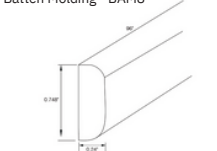



1/2" Thick Finished Plywood Panel

Item Code	Outer Dimensions		
	W	H	D
PSP4896	96.48	0.5	

*Finished one side, natural UV back

Back Panel - Long Grain Plywood

Item Code	Outer Dimensions		
	W	H	D
BPLG4896	48.96	0.25	

*Finished one side, raw back

Bead Board

Item Code	Outer Dimensions		
	W	H	D
BBP4842	48.42	0.25	

*Finished one side, raw back

Filler

Item Code	Outer Dimensions	
	W	D
F396	3.96	0.75
F696	6.96	0.75

*All four edges finished

Overlay Filler

Item Code	Outer Dimensions		
	W	H	D
OLF330	2.5	38.75	0.75
OLF336	2.5	40.75	0.75
OLF342	5.5	38.75	0.75
OLF630			

*All four edges finished
NOTE: Sizes do not measure true.

Fluted Filler

Item Code	Outer Dimensions		
	W	H	D
FF396	3.96	0.75	

*All four edges finished

Dishwasher End Panel

Item Code	Outer Dimensions		
	W	H	D
DWR3	33.45	24	

*0.5" panel thickness
*Finished one side, natural UV back

Tall End Panel

Item Code	Outer Dimensions	
	W	D
TEP3096	1.5	36.30

*0.5" panel thickness
*Finished one side, natural UV back

Bookcase End

Item Code	Outer Dimensions		
	W	H	D
BCE1596	1.5	36.15	

*Requires shelf
*Shelf clips available
*0.5" panel thickness

Shelf

Item Code	Outer Dimensions		
	W	H	D
**SHELF1296	96.04	25.12	
***SHELF2496	96.04	52.24	

*3/4" plywood construction
**Available in natural or painted
***Available in natural only

Corbel - Basic Medium

Item Code	Outer Dimensions		
	W	H	D
CORSM	3	10.5	7.5

Corbel - Transitional

Item Code	Outer Dimensions		
	W	H	D
CORT	3.5	10.5	7

Turned Post

Item Code	Outer Dimensions		
	W	H	D
TPOSTP3	3	35.5	3
TPOSTP5	5	35.5	5

Bunfoot - Transitional

Item Code	Outer Dimensions		
	H Top	Bottom	D
TBUNFOOT2	4.5	3.5	2

Bunfoot

Item Code	Outer Dimensions		
	W	H	D
TBUNFOOT3	4.5	3	3

Decorative Base/Wall Panels

Item Code	Outer Dimensions		
	W	H	D
DWP1215	11.5	43.75	0.75
DWP2415	23.5	43.75	0.75
DWP1230	11.5	28.75	0.75
DWP2430	23.5	28.75	0.75
DWP1236	11.5	34.75	0.75
DWP1242	11.5	40.75	0.75

Furniture Valance

Item Code	Outer Dimensions		
	W	H	D
VFUNR37	37	4.5	0.75



Soft Close Roll Out Tray

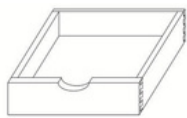

Item Code	Outer Dimensions			D
	W	H	D	
ROT15-SC	10.125	4		2
ROT18-SC	13.125	4		1
ROT21-SC	16.125	4		2
ROT24-SC	19.125	4		1
ROT27-SC	22.125	4		2
ROT30-SC	25.125	4		1
ROT33-SC	28.125	4		2
ROT36-SC	31.125	4		2

*Includes two trays & four tracks

Lazy Susan Kit



Item Code	Outer Dimensions		
	W	H	D
LSK	29	1.5	2

*Includes two trays for shelf mounting
*Birch plywood construction

Trash Can Insert for B18



Item Code	Outer Dimensions		
	W	H	D
TCCK*	14.625	1.125	19.75

● Dovetail, solid wood construction
● Undermount, full extension, soft close slides *Includes two 35 QT cans

Spice Rack Insert



Item Code	Outer Dimensions		
	W	H	D
SR19-SC	5.75	24	20.5

*Fits in the B09

Cutlery Drawer Insert

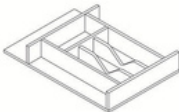

Item Code	Outer Dimensions		
	W	H	D
CDI1	13.375	2.87	19.75
4	19.75	2.87	19.75
CDI2	0	0	0

Roll Out Tray Usage Guide

Item Code	Designed to Fit
ROT15-SC	B15
ROT18-SC	B18, P1884, P1890, P1896
ROT21-SC	B21
ROT24-SC	B24, P2484, P2490, P2496
ROT27-SC	B27
ROT30-SC	B30, SB30, P3084, P3090,
ROT33-SC	P3096 B33, SB33
ROT36-SC	B36, SB36

Spice Rack Door Attachment



Item Code	Outer Dimensions		
	W	H	D
SRD12	11.5	24	4
SRD15	14.5	24	4

Spice Tray Insert



Item Code	Outer Dimensions		
	W	H	D
ST11	13.375	1.094	19.75
4	19.75	1.094	19.75
ST12	0	0	0

Stemware Rack



Item Code	Outer Dimensions		
	W	H	D
SWR3012	28.5	1.5	10.5



Accessories displayed on this page can be installed on assembled orders

PERFECT

 PAIRINGS





















Discover The
 Perfect Pairing







Over 200+ Options



Introducing KCD's Decorative Hardware Collection, designed to provide the perfect complement to our cabinet door styles. The expansive assortment of possibilities will make it easy to find the perfect pair.

<p>Bar Pull Shown in Satin Nickel</p> 	<p>Bar Pull Knob Shown in Rubbed Oil Bronze</p> 	<p>Charleston Cup Pull Shown in Matte Black</p> 	<p>Charlotte Pull Shown in Rubbed Oil Bronze</p> 
<p>Charlotte Square Knob Shown in Rose Gold</p> 	<p>Colorado Knob Shown in Polished Chrome</p> 	<p>Colorado Square Knob Shown in Satin Nickel</p> 	<p>Colorado Pull Shown in Matte Black</p> 
<p>Diecast Knob Shown in Dark Pewter</p> 	<p>Madison Pull Shown in Rubbed Oil Bronze</p> 	<p>Manhattan Pull Shown in Rose Gold</p> 	<p>Miami Pull Shown in Dark Pewter</p> 
<p>Milan Pull Shown in Satin Nickel</p> 	<p>Modern Square Pull Shown in Matte Black</p> 	<p>Round Flat Top Knob Shown in Dark Pewter</p> 	<p>Rectangular Knob Shown in Polished Chrome</p> 
<p>Square Knob - Flat Shown in Rose Gold</p> 	<p>Square Knob Shown in Matte Black</p> 	<p>Vail Pull Shown in Polished Chrome</p> 	

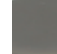
Available Finishes

- 
 Rose Gold
- 
 Satin Nickel
- 
 Matte Black
- 
 Polished Chrome
- 
 Dark Pewter
- 
 Brushed Bronze













Appliance Pulls



KCD's Decorative Appliance Collection is designed to provide the perfect complement to our cabinet door hardware.

<p>Miami Appliance Pull <i>Shown in Matte Black</i></p> 	<p>Charlotte Appliance Pull <i>Shown in Rose Gold</i></p> 	<p>Manhattan Appliance Pull <i>Shown in Satin Nickel</i></p> 
<p>Colorado Appliance Pull <i>Shown in Matte Black</i></p> 	<p>Vail Appliance Pull <i>Shown in Rose Gold</i></p> 	<p>Modern Square Appliance Pull <i>Shown in Satin Nickel</i></p> 
<p>Monaco Appliance Pull <i>Shown in Matte Black</i></p> 	<p>Milan Appliance Pull <i>Shown in Rose Gold</i></p> 	

It's smart to match your hardware FINISH throughout the kitchen. This choice creates a coordinated look even when your knobs and handles are different.

Available Finishes





Floating Shelves



Decorative Hardware Collection offers Floating Shelves for accents to add beauty and function to your kitchen or bathroom.

Choose from three finishes and five different size options with our Floating Shelves. Create the clutter free look giving you the perfect balance of spontaneity and class.



White Oak

Available Finishes



White Oak Walnut Maple



Walnut

Available Widths

12", 24", 30", 36", 42"



Maple

Brackets



Brackets (2/pkg) included with all floating shelves.

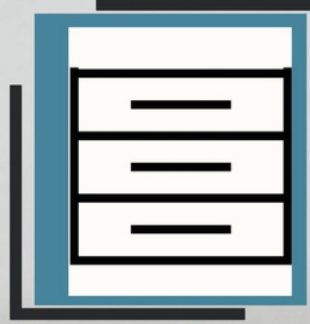

Karter's
Cabinet
Depot



Missouri
228 State Hwy Z,
Cape Girardeau MO,
63701