

Pathfinder Lodge layout and Assignment Sheet

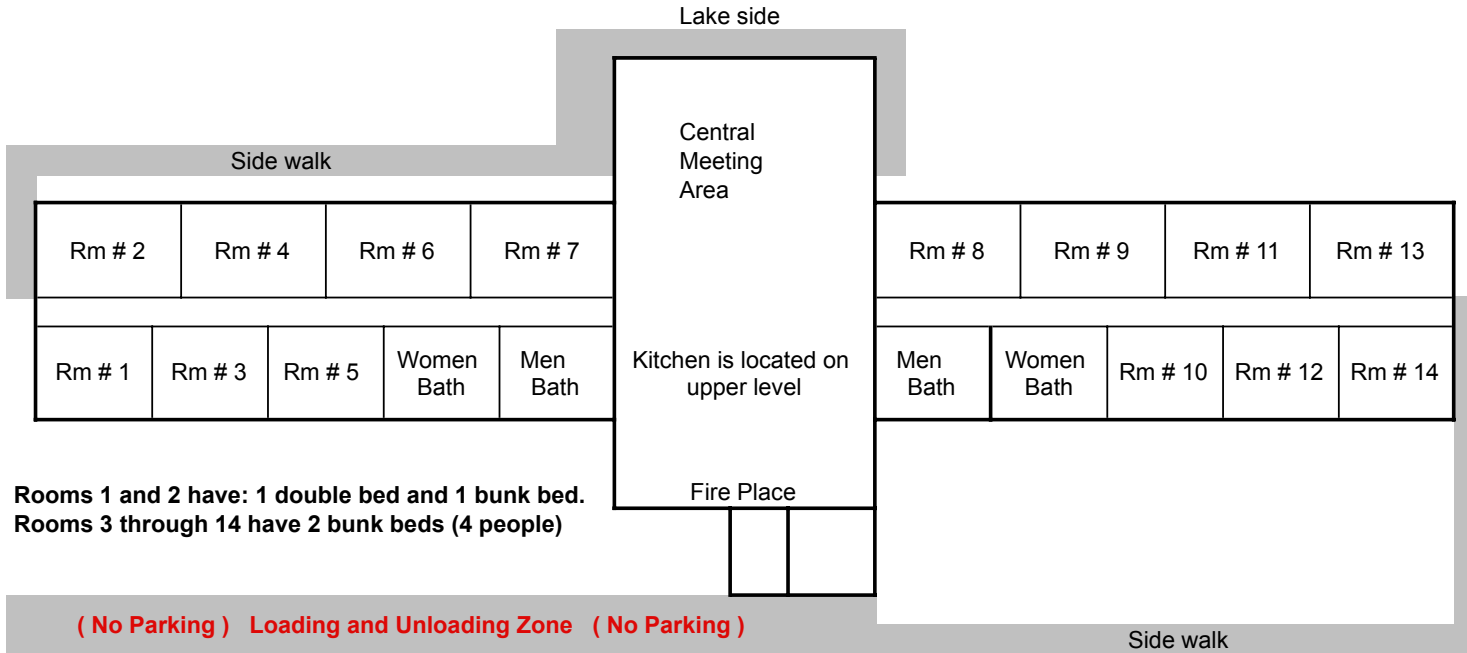

Rooms 1 and 2 have: 1 double bed and 1 bunk bed.
 Rooms 3 through 14 have 2 bunk beds (4 people)

Rm #	Bed # 1 / Bottom Bunk	Bed # 2 / Top Bunk	Bed # 3 / Bottom Bunk	Bed # 4 / Top Bunk
1				
2				
3				
4				
5				
6				
7				
8				
9				
10				
11				
12				
13				
14				